

Dallas Harvest Festival Sunday, Sept. 14 1-6 p.m.

Entertainment • Vendors • Farmer's Market • Auction
Food • Petting Zoo • Pony Rides, activities for children

Main Street Participants

(See map on facing page)

- | | |
|-------------------------------|---|
| A1 Dallas Visioning Committee | Information, Raffle Chances & T-Shirts |
| A2 College Misericordia | Admissions & Mascot |
| A3 Penn State 4H's | Hamburgers & Hot Dogs |
| A4 Mary Kay Cosmetics | Display, Recruiting, Hosting Parties & Taking Orders |
| A5 Penn State Wilkes-Barre | Admissions & Mascot |
| A6 Dallas Family Practice | Blood Pressure Screenings, etc. |
| B1 Bamboo Designs | Bamboo Plants in Pottery |
| B2 College Misericordia | Face Painting & Soda |
| B3 Lioness of West Pittston | Chocolate covered Marshmallows, Oreos & Pretzels |
| B4 Penn State Master Gardener | Questions & Answers - Information |
| B5 Penn State Coop. Ext 4-H | 4-H Activities - Plant Science |
| B6 Apple Tree Bakery | Different Kinds of Bread & Coffee |
| C1 Princess House Crystal | Information, Raffle, Schedule dates to host parties, etc. |
| C2 Tastefully Simple | Information, Samples to taste, Schedule dates to host parties |
| C3 North Branch Land Trust | Information & Display |
| C4 PNC Bank | Information |
| C5 Kiwanis of Dallas | Information |
| C6 Pizza Hut | Pizza, Pasta & Beverages |
| D1 Boy Scouts & Cub Scouts | Information & Applications |
| D2 Citizen's Bank | Information |
| D3 Lion's Club | Information |
| D4 John O'Connell | Sketches of Individuals |
| D5 Master Travel | Information |
| D6 Dallas Hardware | Hardware sales |
| E1 Gate of Heaven Church | Youth Group School Information & Calendars |
| E2 Style By Pat | Jewelry, Miscellaneous Gifts & 4-H Ornaments |
| E3 Kimberly's Floral | Fresh & Silk Flowers - Flower Cart |
| E4 Rita Busch | One Stroke Tole Painting on a variety of surfaces |
| E5 The Dallas Post | Information, Subscriptions, etc. |
| E6 Arlene Daily | Handcrafted Jewelry |
| F1 Cathy's Breads | All kinds of Breads |
| F2 Outrageous | Jewelry & Glassware |
| F3 Back Mt. Memorial Library | Information, Membership Registrations, Mem Bricks & Books |
| F4 Ochman Coin & Jewelry | Coins & Jewelry |
| F5/F6 The Country Frog | Wheat Weaving Demonstration. Homemade Crafts |
| DB1 Hillside Farms | Ice Cream |
| DB2 Joe Perugino | Potato Pancakes & Lemonade |
| PL1 Dallas Post Office | Stamp Cancellation, Stamps & FREE Raffle |
| PL2 Rotary Club of Dallas | Snow Blower Raffle, Bottles Water, Bratwurst & Sauerkraut |
| PL3 igourmet.com | Cheeses from all over the world, Oils - Samples to taste |

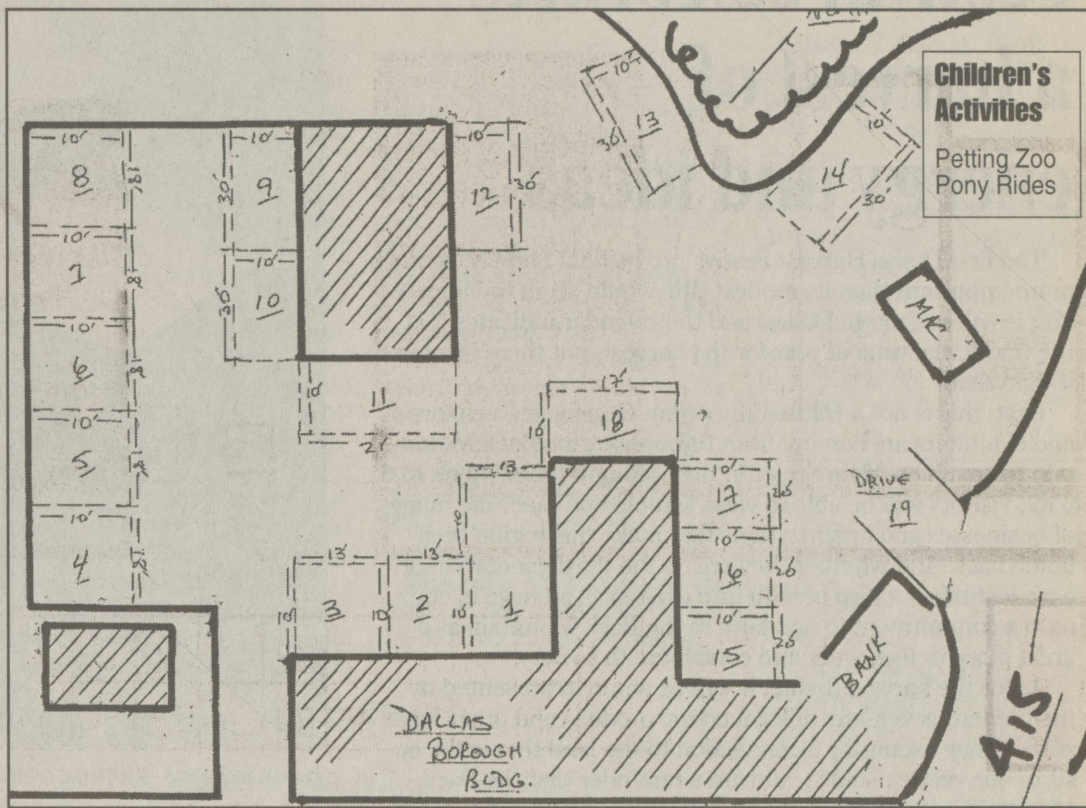

Farmer's Market's Area

- | | |
|----------------------------------|--|
| 1 Zekoski Farms | Tomatoes, Vegetables |
| /3 Endless Mountains Mustard Co. | Mustard Sales |
| 4 Discovery Toys | Play area for children and display of toys |
| 5 Weaver's Farm | Garlic - loose & by the pound, herbs - fresh, gourds, pumpkins, garlic decorative items - dolls, braids, wreaths, etc. |
| 6 Wreaths by Virginia | Wreaths/Crafts |
| 7/8 Dallas Agway | Plants, feeds, clothing, boots, other items from their store |
| 9 Hilbert's Equipment | Cub Cadet riding mower |
| 10 Susan Najder | Demonstrating Glad Wrap - Free Coupons |
| 11 Covered Wagon Produce | Produce |
| 12 Ayers Orchard | Vegetables |
| 13 Brace's Orchard | Candied Apples, Lollipops, Fruits & Cider |
| 14 Charney Farms | Jams, Jelly, Fruit, Vegetables, Popcorn on the cob |
| 15 Rick's Picks | Pickles |
| 16/17 Darling's Farms | Produce |
| 18 Yost's | Jams and Produce |
| 19 Dallas Fire & Ambulance, Inc | Emergency Services and Educational |

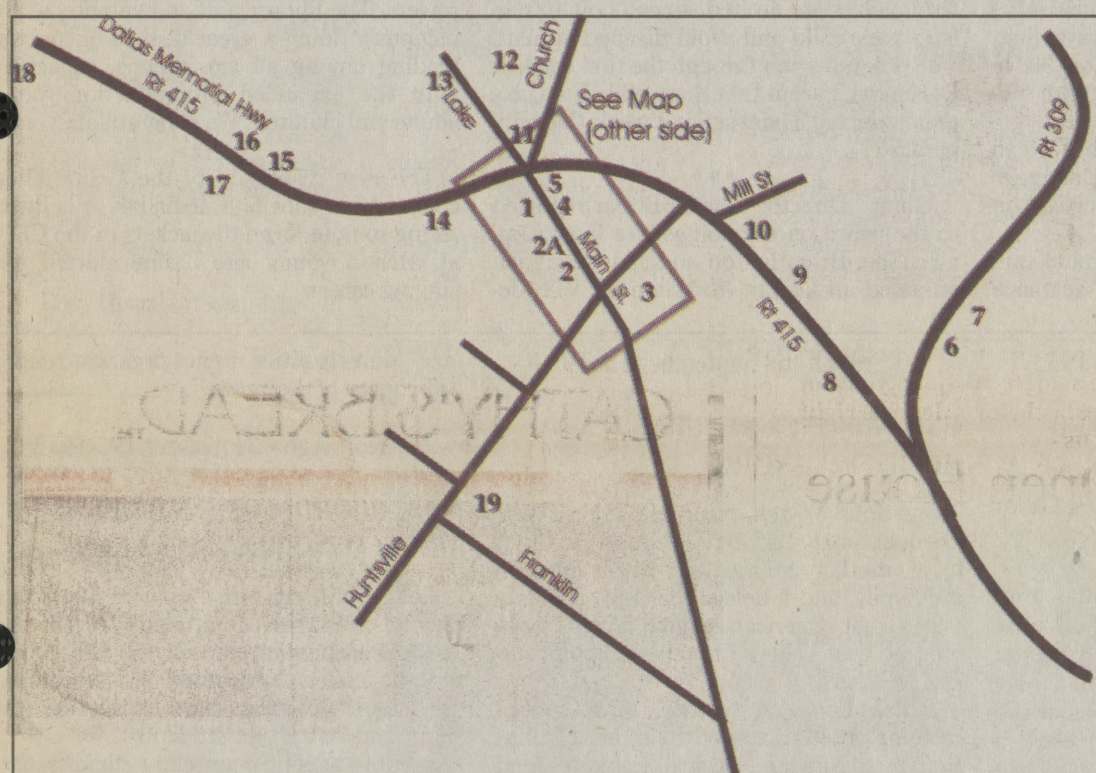

Entertainment

- 1 p.m. - Joan Harris Dancers
 - 1:45 p.m. - Sarah Henderson
 - 2:45 p.m. - Back Mountain Dance Studio
 - 3:45 p.m. - Gary Cutter
 - 4:45 p.m. - Gina Major Studio
 - 5:20 p.m. - Sister Act
- DJ service provided by Chuck Hayes

Kiss the Pig contest

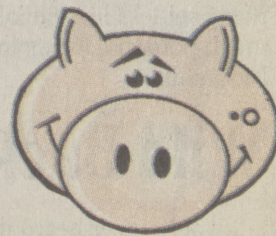

Capture a classic moment by voting for your favorite Dallas celebrity to kiss the pig! Contestants are: Dr. Karen Boback - Elementary Teacher; Tim Carroll - Dallas Mayor; Nancy Eckert - Real Estate Guru; Dr. Durelle Scott, MD Extraordinaire; Dr. John Shaskas - Vet and Library Auctioneer.

Free Parking and Shuttle

Park at any of the participating businesses off Main Street, or at Twin Stacks Center. Shuttle buses will be making regular trips to the Festival and the Library Auction

- Kiss the Pig voting boxes are at these locations:
- Jersey Shore Restaurant • J & J Deli
 - Mark II • Penn State University
 - College Misericordia • Pickett's Charge
 - Dr. Durelle Scott's Office
 - Back Mountain Library • Citizen's Bank

Votes will be accepted the day of the festival at the Dallas Visioning Committee table. Winner announced at 4:30. Kissing with Frank to commence immediately afterward!

Participating Merchants

- 1 Dallas Borough Building
- 2 Sue Hand's Imagery Art Shop
- 3 Dallas Centre Hardware Hardware & Other Specialty Items
- 4 Buffalino Law Offices Attorneys
- 5 Besecker Realty Real Estate
- 6 The Dough Company Special Today! Homemade Lasagna & Salad \$4.99. Drawing for Gift Certificates
- 7 Valentine's Jewelry Jewelry Specialists
- 8 Pizza Hut Pizza & Other Specialties
- 9 Dallas Photo Shop Photography Supplies & Cameras
- 10 Wendy's
- 11 Dave's Favorite Eatery
- 12 Ochman Coin & Jewelry Coins & Jewelry
- 13 Dallas Methodist Church Evening Organ Concert 7 PM Featuring Scott Flinchbaugh (Moravian College)
- 14 Old House Cafe Open for business
- 15 China King Chinese Restaurant Hunan, Mandarin & Cantonese Cuisine
- 16 J & J Deli Specials! PRIZES! See Marquee
- 17 Dallas Agway Open for business
- 18 Dallas Auto Parts Open for business
- 19 Farm Basket Produce, Canned Goods, Jams, Jellies, Flowers, Crafts and Lawn Ornaments
- 19 Back Mountain Memorial Library 1-Day Mini-Auction 1 - 6 PM
- 19 Back Mtn Lib Used Book Shop open for business

OUTRAGEOUS

The Center of Contemporary Design

Unique Furniture, Lighting, Accent Pieces & Sterling Silver Jewelry

www.outrageousonline.com

4 South Main Street
Shavertown • 696.6856

Hours: Mon, Wed, & Fri 11am-6pm/Tues & Thurs 11am-7pm/Sat 10:30-5pm/Sun Noon-4pm

Trunk Show

FRIDAY, SATURDAY & SUNDAY

NOMINATION

THE ORIGINAL

Introducing

hot-diamonds

STERLING SILVER AND DIAMONDS

Drawing & Giveaways
Everyone has a chance to win!

Valentine's

Open This Sunday
During Harvest Fest 1 pm to 6 pm with Refreshments

Rt 309, Dallas Phone: 675-6945 ValentinesJewelry.com Store Hours: Mon-Fri 10-6, Thur 10-8, Sat 10-5

Since 1990

The Area's Most Complete Youth Performing Arts Center
Offering Programs for Beginners through Advanced Levels
Ages 3 and Up

TAP - JAZZ - BALLET - POINTE
VOICE - THEATRE - KINDERMUSIC

Two YOUTH THEATRE COMPANIES On Site

Specialized Pre-School and Kinder Level Combination Classes
8 "TRY-ME" Classes

Just \$40
With This Ad!

Major Performing Arts Center
Now Open For 2003-04 Season

OPEN HOUSE
REGISTRATION

Walk In September 15, 17, 18
5 to 7 p.m.

Call (570) 696-4755 To Register

Carverton Road, Trucksville
(Easy Access from all of the Wyoming Valley on Rt. 309 and All Back Mountain Communities)

Major Performing Art Center Performs
Sunday, September 14th at 4:45
at the Dallas Harvest Festival