



Roads

(continued from page 1)

be lengthened to accommodate more vehicles, about 16 total. Northbound traffic will have a green light unless a vehicle is turning out of the used car business at the intersection.

The left turn from Hillside onto Rt. 309 has been prohibited for some months because "it takes away green time on Rt. 309."

A previous plan that would have installed a "jug handle" turn northbound had to be abandoned because the former Harter's Dairy and a home next to it are under consideration to be in the historic register.

Shimko said construction on the \$600,000 project will take place during non-peak hours to avoid traffic jams.

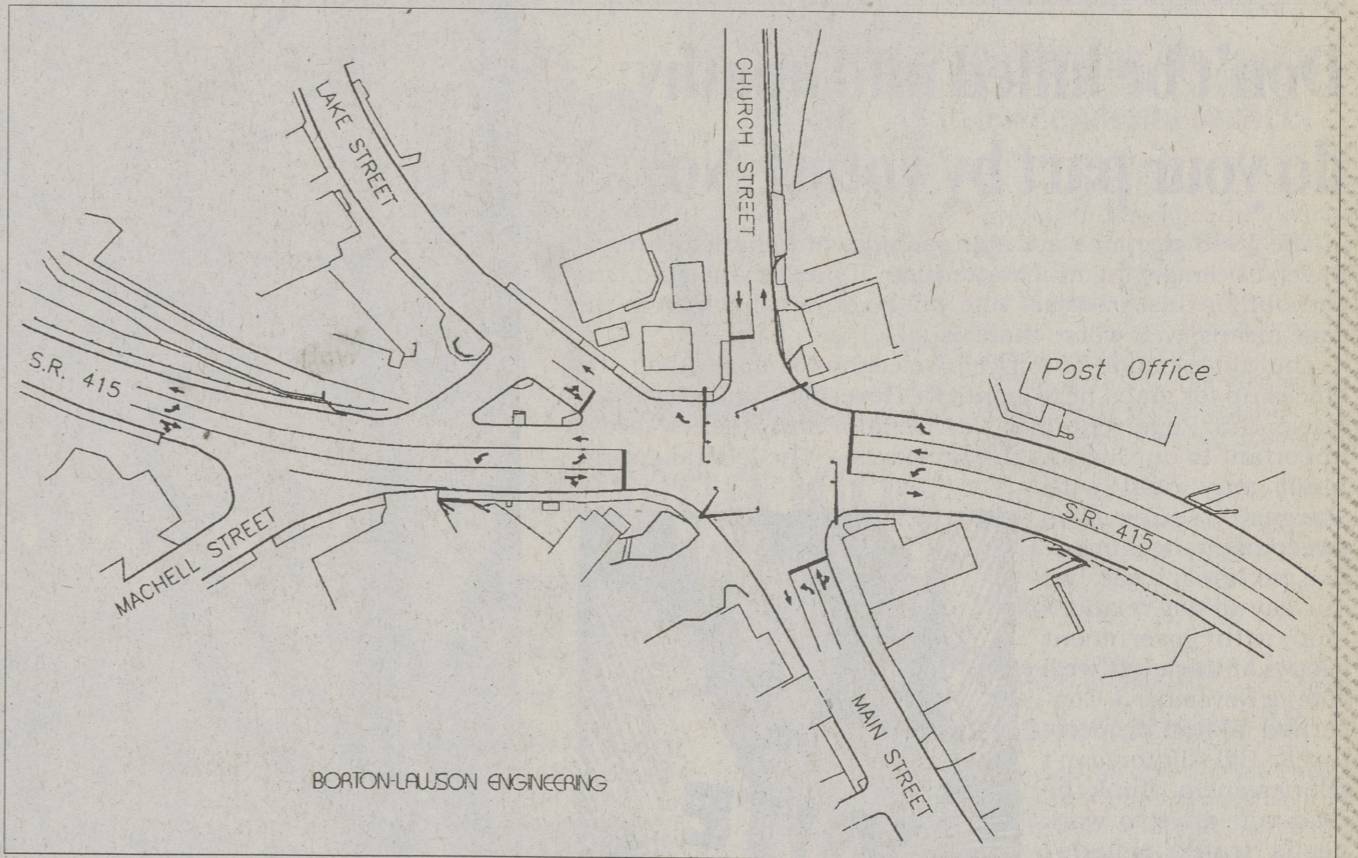

Drawing shows the arrangement of lanes at Dallas center when construction is completed. At left, Cy Boris of Sweet Valley glanced at the in-progress new post office entrance Monday morning.

Preliminary plan for Lake-Lehman Middle School

Drawings of renovations to Ross Elementary and the high school were shown to the public at last week's Lake-Lehman school board meeting. William Price, superintendent, said the drawings are preliminary steps in a long process. At last month's meeting he said he wanted to get the ball rolling and find out what the district needs and how it could facilitate those needs. Price did not estimate project costs. In the preliminary plans, Ross Elementary in Sweet Valley would have about twice its current number of classrooms. Renovations to the high school include adding the middle school on to the front of it. The district would probably close the current middle level building.

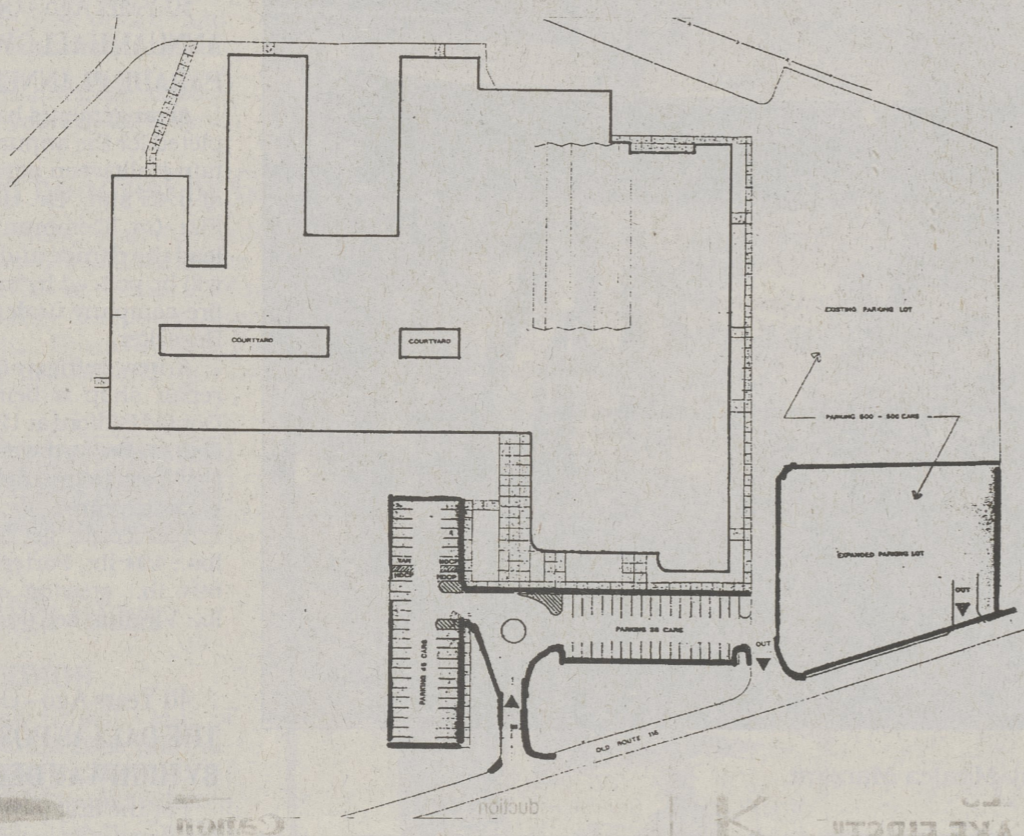

Dallas High School Soccer Club

P.O. Box 189, Dallas, PA 18612



Would like to thank all those who contributed to the success of our Annual Fall Craft Show

Food Contributors

Ranch Wagon
Subway
Big Apple Bagel
Curry Donut
Herr's
Mr. Z's
J&J Deli
Dymonds
Braces Orchard
Domino's
Carr's Beverage
Holsum

Raffle Contributors

Llewellyn & McKane, Inc.
Networked Education Technologies
The Lion Brewery
Appletree Terrace
Burger King
Sports Plus
The Cottage Gift Shoppe
Pickett's Charge Restaurant
Valentine's Fine Jewelry

Raffle Contributors

Peking Chef
Friendly's Restaurant
Tovon & Company
Hogan's Heroes & Pizza
The Dough Company
Oliver's Cafe
Country Traditions

Also Thanks To All Our Vendors and Patrons
See You In The Spring!

Remember Your Vote is Important!

Return
George C.
HASAY
117th
Legislative
District

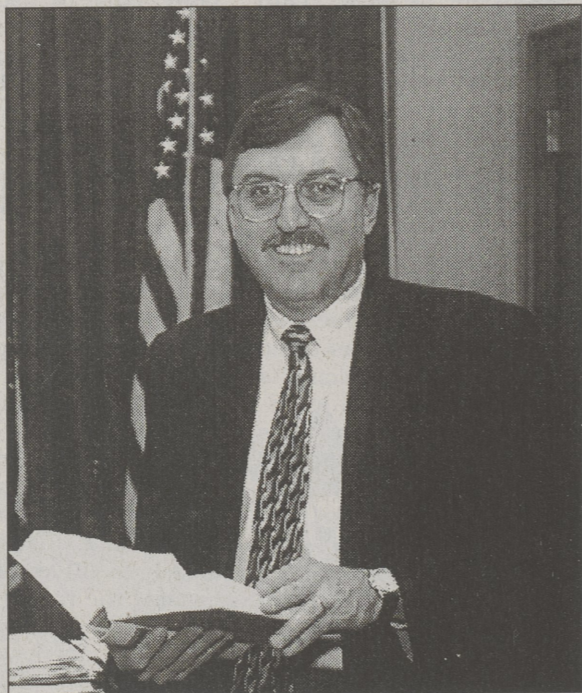

- ★ Secured much needed grant money to help the Luzerne County Fair Association
- ★ Acquired state grants for our Local Volunteer Fire Companies.
- ★ Helped our local Police Departments obtain grants that help their ability to protect our safety.
- ★ Assisted our local townships with many equipment grants.
- ★ Keeps a vigilant eye on our rural roads – making sure we get our fair share of the tax money from Harrisburg.

Remember You Can't Buy Experience!

Paid for by the Committee to Re-elect George C. Hasay, Chairman Gary Bakor

C.B. Scott is "The Source" for . . .



First Name in Innovation
THOMAS
LIGHTING

C. B. Scott is the largest Thomas Lighting Distributor in the Northeast. Our Lighting "Showrooms of Quality" feature inspiring displays of Thomas Lighting.

Features include solid and cast brass, lead crystal, etched glass, white porcelain, and other quality details.



"The Light Source"

395 Coal Street, Wilkes-Barre
Phones: 824-9812 or 1-800-257-1525

AUTO PARTS

4 PC CARPETED FLOOR MATS
Choose blue, black, gray or red
#823-2490 thru 93

\$7⁹⁹

/SET

NAPA MOTOR OIL
•5W30 • 10W30 • 10W40
• 20W50 • SAE 30 • SAE40

SALE PRICE.....84¢
LESS MAIL-IN REBATE.....25¢

After mail-in rebate

59¢

/QT.

PRESTONE SUPER FLUSH
(22 oz.) #AS107
— OR —
PRESTONE SUPER SEALER
(14.5 oz) #AS127

YOUR CHOICE

\$1⁹⁹

Additional \$1.50 Mail-In Rebate Available!

BUDGE LITE SEMI-CUSTOM CAR COVERS
(Large — Fits Up to 16'8") #730-3986
(X-Large — Fits Up to 19") #730-3987

YOUR CHOICE

29⁹⁹

DALLAS AUTO PARTS
668 MEMORIAL HIGHWAY • DALLAS

675-2143