

State To Study Alcohol Problem

55,000 Alcoholics Estimated In State

(By Pennsylvania News Service) Harrisburg, February 5—It may be hard for some people to believe, but it has been estimated that there are approximately 219,000 excessive drinkers saturating the Commonwealth of Pennsylvania.

This estimate has been given by a legislative committee of the Joint State Government Commission currently studying the problem of alcoholism in this State with a view towards recommending remedial legislation to the 1949 Legislature.

Additionally the committee figures there are probably 55,000 alcoholic sippers who could be classified in the more stringent terms of "alcoholics".

Furthermore, it has been estimated that excessive drinking in the Keystone State costs in the neighborhood of \$53,000,000 a year.

These few facts have prompted the committee to intensify its efforts to work out a plan for the control of alcoholism if at all possible.

Public hearings are planned in the near future in order that suggestions may be offered by public spirited groups such as the Women's Christian Temperance Union, church and civic organizations, Alcoholics Anonymous and others that may be interested, including the liquor industry.

In terms of winning the family bread, it is estimated that excessive drinking costs the wage earner about \$31,000,000 a year, with the cost in crime set at \$14,000,000 annually.

Coincidentally the State Liquor Board reported that in 1947 profits from the sale of alcoholic beverages in Pennsylvania reached the all-time high of more than \$61,500,000.

Methodists Select New Committees

(Continued from Page One)

Audit: James Huston, Harold Payne.

Records: Mrs. Ralph Brown, Mrs. Stanley Davies.

Ranch-Style House for City or Country

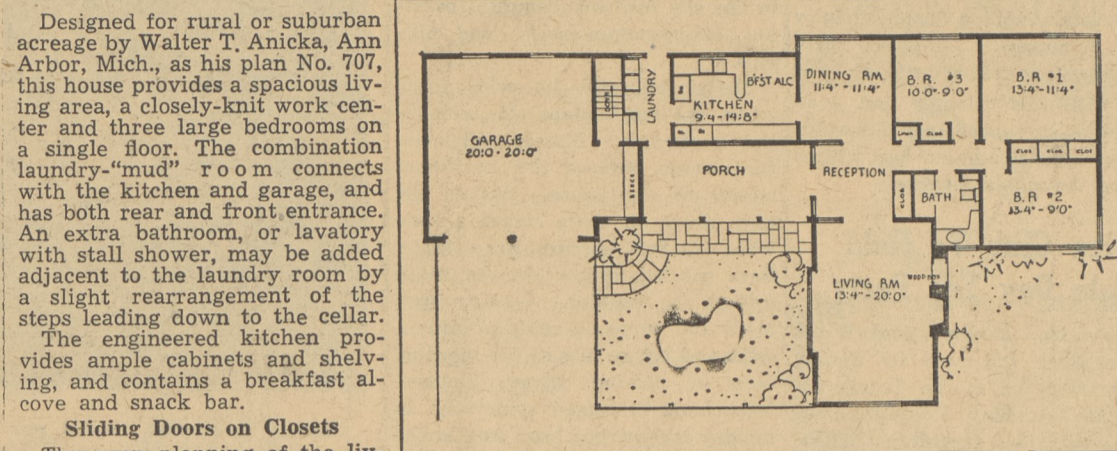
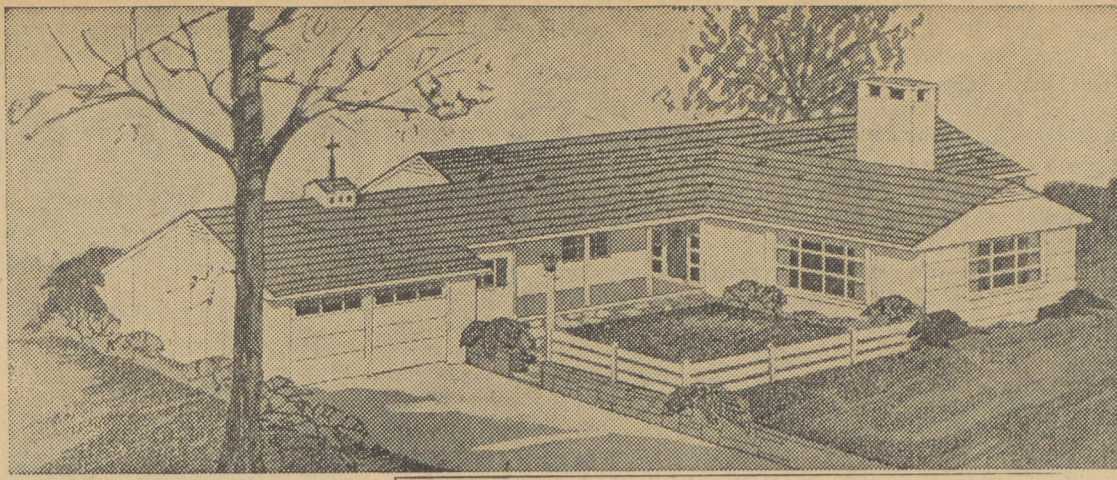

Designed for rural or suburban acreage by Walter T. Anicka, Ann Arbor, Mich., as his plan No. 707, this house provides a spacious living area, a closely-knit work center and three large bedrooms on a single floor. The combination laundry-"mud" room connects with the kitchen and garage, and has both rear and front entrance. An extra bathroom, or lavatory with stall shower, may be added adjacent to the laundry room by a slight rearrangement of the steps leading down to the cellar. The engineered kitchen provides ample cabinets and shelving, and contains a breakfast alcove and snack bar.

Sliding Doors on Closets
The open planning of the living room, reception hall and dining room, gives spaciousness to the living area and serves to separate the work center from the three-bedroom unit. The four bedroom closets have sliding doors. There is an extra-large closet in the reception hall for heavy coats.

The house is frame construction and the architect has specified a roof of dark asphalt shingles to give a pleasing contrast with the wide white siding. Fire-resistant asphalt shingles were selected for the roof, not only for attractiveness but to give added protection from the threat of chimney sparks and windblown firebrands.

Exclusive of land, building costs for most localities are estimated at \$10,000 to \$13,000. Blue prints and building specifications may be obtained from the architect, Walter T. Anicka, DHU Warren Road, Ann Arbor, Mich., by reference to plan No. 707.

- Hospitals and Homes: Mrs. S. B. Davies, Mrs. J. Benner, Mrs. Ray Shiber.
 Temperance: Mrs. C. J. LaBar, Mrs. C. S. Hildebrand, Mrs. C. Reed, Mrs. D. A. Waters, Mrs. E. Weidner.
 Music: L. W. LeGrand, Mrs. W. Baker, Mrs. C. J. LaBar, Mrs. Ethel Oliver, Mrs. Richard Robins, The Minister.
 Literature: Mrs. S. Machell, Miss E. Goldsmith, Mrs. W. Higgins, Mrs. Charles James, Mrs. D. A. Waters.
 Education: L. W. LeGrand, Mrs. A. Bisbing, C. A. James, Mrs. R. Kuhnert, Mrs. O. Trumbower, D. Evans, Mrs. Z. E. Garinger, W. Waters, C. Grose.

57th ANNIVERSARY

Another big event in our March of Progress. A celebration that emphasizes our consistent policy of reducing your food costs by our "producer to consumer" program of food distribution. This big event means much to you as we are

Featuring Hundreds of **OUTSTANDING FOOD VALUES**

Owned and Operated by **AMERICAN STORES COMPANY**

Acme MARCHES ON! **51 NEW MODERN ACMES OPENED LAST YEAR**

Your Favorite Fresh Fruits and Vegetables

Extra Large, Juicy, Florida—Size 176

ORANGES

 doz. **29c**
 A Real Outstanding Value—Compare This Low Price—Buy Now

SOLID RIPE SLICING Large, Thin-Skin, Florida

TOMATOES cello 29c **GRAPEFRUIT** each 5c
 pkg.

Penna. Blue Label Rome or Staymen

POTATOES Full Peck 61c **APPLES** 3 lbs. 29c
 (15 lbs.)

Crisp, Calif. Iceberg Fancy Northwestern

LETTUCE 2 large heads 19c **ANJOU PEARS** 3 lbs. 25c

Quality Meats, Poultry and Sea Foods at Low Prices

STEAKS

 Round, Sirloin, Porterhouse Cut from Western Beef lb. **75c**

Headquarters for Finest Fresh Sea Foods

Haddock Fillets lb. 45c Dressed Whiting lb. 19c Redfish Fillets lb. 39c
 Pollock Fillets lb. 25c Boston Mackerel lb. 25c Standard Oysters pt. 73c

Nucoa **OLEOMARGARINE** Low Price lb. **42c**

ASCO Oleomargarine lb. 39c
 Glendale Cheese Food 2 lb. loaf 99c
 Rich Sharp Cheese lb. 65c

Supreme Enriched **BREAD** large loaf **13c**
 SUPREME RAISIN BREAD loaf 17c

Large Coconut-Iced Gold Layer Cake ea. 69c Frankfurter Rolls pkg. of 8 16c
 Chow Mein Noodles can 14c Large Orange-Iced Choc. Loaf Cake ea. 39c Pecan Rings ea. 49c
 Bean Sprouts can 13c Coffee Rings ea. 31c

GRISCO 3 lb. can 1 lb. can **\$1.25 43c**

Staley's Cream **CORN STARCH** 1 lb. pkg. **13c**

Save! For Enjoyment and Economy—Make It Your Daily Bread.

KIRKMAN PURE WHITE FLAKES SAFE FOR FINE FABRICS... THRIFTY FOR DISHES large pkg. **39c**

KIRKMAN GRANULATED large pkg. **39c**

BORAX SOAP 3 cakes **28c**

SOAP POWDER large pkg. **24c**

COMPLEXION TOILET SOAP 3 cakes **27c**

National **DRIED FRUIT** Week

Rob Ford, Large **PRUNES** lb. pkg. **19c**

Rob Ford, Evaporated **Apricots** 11 oz. pkg. **32c**

Rob Ford, Evaporated **Peaches** 11 oz. pkg. **19c**

Saratoga Fancy **Mixed Fruit** 11 oz. pkg. **21c**

with **CAKE-IMPROVER** 3 lb. can 1 lb. can **\$1.25 43c** for LIGHTER, FINER CAKES

Campfire **Marshmallows** 1 lb. 29c pkg.
 Cracker Jack 6 pkgs. 25c
 Angelus **Marshmallows** 10 oz. 18c

Top Coffee Flavor—Saving Prices
 ASCO Coffee Rich, Tasty, Full-Bodied lb. **43c**
 Wincrest Coffee Mild, Mellow lb. **40c**
 Ideal Coffee Vacuum Packed lb. **49c**

Nabisco Premium Crackers 1 lb. 25c **ASCO White Vinegar** pt. 8c
 Nabisco 100% Bran Ige. 24c **Gevaert Films—Size G27** roll 25c

WIN A FORD HURRY! Enter Chiffon's \$100,000 Prize Contests! Write a simple 2-line jingle about Chiffon. 120 Photo cards, 120 Phonograph records, 3300 cash awards! Get details here.

Chiffon **SOAP FLAKES** Ige. 39c pkg.

HERSHEY Cocoa Butter Toilet Soap 3 cakes **29c**

Staley's **Laundry Starch CUBES** For Easier Ironing 12 oz. pkg. **13c**

TRY THE GREAT NEW CLEANSER BY SWIFT & COMPANY In the Port Polka-Dot Package 2 cans **23c**

A LAMP?

Did you see our lamp to be given away April 1st? Every dollar purchase gives you an opportunity toward obtaining this beautiful hand-painted lamp with washable shade.

EDMONDSON GIFT SHOP

exclusive, but not expensive

Next to the Postoffice, Dallas
 MAIN STREET — DALLAS

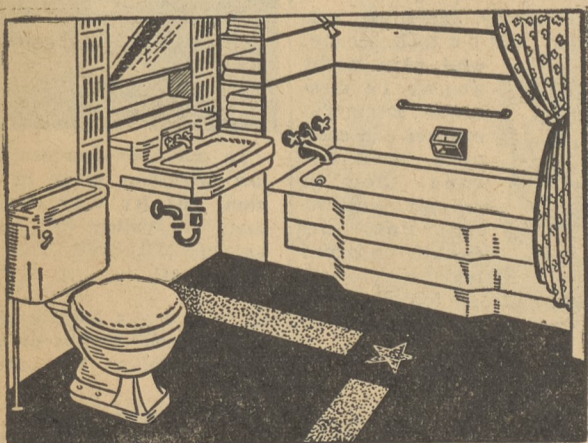

Now is the time to MODERNIZE OR INSTALL THAT NEW BATHROOM

We have complete BATHROOM OUTFITS, TUBS, TOILETS AND LAVATORIES

Also beautiful TILE BOARD—WHITE, BLUE, CREAM AND PEACH. BLACK BASE AND CAP AND CHROME MOLDINGS TO COMPLETE A MODERN BATHROOM OR KITCHEN.

Shavertown Builders Supply



Because of the building shortage, I'm in small space; but that doesn't mean that I can't give you service, economical prices, and some beautiful merchandise.

We've got some dandy 8-day, winding kitchen clocks, just what you've been looking for and some dainty little gold lockets for your best little girl . . . and diamonds, too, for your big girl's Valentine.

HENRY'S WATCH REPAIR SHOP

Next door to the Bank — Dallas, Pa.

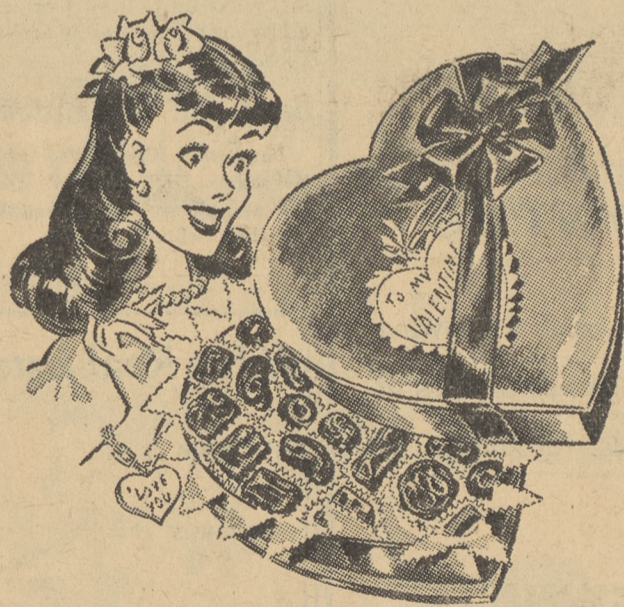

VALENTINE CANDY

Whitman's And Kemps finest chocolates



While you wait our experienced prescription department fills your drug needs rapidly, flawlessly. Freshest ingredients used.

Photo Finishing

BRING YOUR FILM HERE TO GET THE QUICKEST SERVICE

HALL'S DRUG STORE

PHONE 278 SHAVERTOWN