



MARGARET McPHERSON
... WSGA President



JANICE WANNER
... Panhel 1st Vp



ROBERTA HILL
... Leonides President



ELIZABETH INGLEY
... WRA President

WSGA, Panhel Leonides, WRA Elect Officers

(Continued from page one)

Leonides
In the Leonides election, Mary Kay Stoker, junior in arts and letters from St. Marys, defeated Beverly Cades for vice president with a vote of 150 to 105.

Patricia Shockey, junior in business administration from New Brighton, took the election for recording secretary. She defeated Billie Carroll by a vote of 185 to 82.

New Leonides corresponding secretary-treasurer is Patricia Hagan, sophomore in chemistry from Erie. She defeated Patricia Schaaft by a vote of 164 to 103.

Panhellenic
In the Panhel elections, Debora Urie, junior in arts and letters from Harrisburg and a member of Sigma Delta Tau, defeated Theadora Del Prete and Susan Grossman for treasurer.

Judith Colbeck, junior in applied art from Pittsburgh and a member of Delta Gamma, is the new corresponding secretary. She was opposed by Karen Bosler and Frances Kietz.

Sandra Wilson, sophomore in home economics from Claremont, Calif., and a member of Kappa Alpha Theta, defeated Martha Kline and Nancy Williams for recording secretary.

WRA
In the WRA elections, Barbara Newman, sophomore in elementary education from Philadelphia, defeated Susan Rich for vice president, 496 to 425.

WRA secretary-treasurer is Virginia Davenport, freshman in elementary education from Verona, N.J. She defeated Lois Affleck 609 to 328.

Nancy Barnhart, freshman in arts and letters from Pittsburgh, was elected sophomore representative to WRA with 171 votes. Her opponents were Janis Summerville (139) and Patricia Baker (91).

SGA Defeats Bill To Stop 'Switching'

By CAROL BLAKESLEE

Calmly and coolly the SGA Assembly voted down last night the bill which would have prohibited political party switching.

In sharp contrast to last week's spicy debate, discussion was slow and always on the merits of the bill itself.

There were no charges of "emotionalism" or pleas for discussion based on idealism and counter pleas for practical discussion as there were at the bill's first reading.

The bill would have prohibited candidates elected under one party from being nominated to office by another party during their term of office.

As a proposed amendment to the SGA by-laws, it required a reading one week and a majority vote the next to become effective.

Besides the proponent of the bill, Edwin Urie, alternate Assemblyman, only four others voted for it. They were John Brandt, alternate Assemblyman; Howard Byers (U.-Sr.); David Byers, alternate Assemblyman; and Bruce Brennerman, (C.-Sr.).

David Byers was the only spokesman for the affirmative. The basic argument for prohibiting party switches, he said, is that it would make the parties strong enough to get and keep candidates.

It would force an individual to run for, stand for and fight for his party throughout the year and would eliminate after-election apathy, he said.

Speaking against the bill, Patricia McGee (C.-Fr.) said that if a party were strong the switching of one or two candidates would not matter.

Walter Darren (C.-Jr.) said the bill would be a revision to the old All-University Cabinet system. The SGA system makes its representatives responsible to the student body and not to a specific interest group or political party, he said.

Student Group To Help Plan Stone Valley

The SGA Assembly last night voted to appoint several students to work with the Committee on Stone Valley Development.

Duane Alexander, sophomore class president, told Assembly that the committee chairman Peter W. Fletcher, director of the School of Forestry, had asked that student views be expressed particularly on the priority of development.

Stone Valley is a recreational area being developed about 12 miles southwest of State College. It is expected that the dam there will be filled this spring and that some parts of the area will be ready for use at that time.

The master plan has been almost completed by the administration, but student opinion is desired on development priority and investigation of methods of finance, including administration funds, alumni funds, class gifts and fees for usage.

Prof to Speak at Center

Dr. Milton S Osborne, professor and head of the Department of Architecture, will address students at the Wyomissing Center of the University on the development of structures in architecture.

Schnelle Outlines Plan For Job Applications

Robert G. Schnelle, assistant head of the Placement Division, has outlined a general procedure for job application, interviews, offers and placement.

Representatives of the various companies schedule interviews with interested student applicants on campus.

Rix Given Grant To Do Research

Dr. H. David Rix, associate professor of physics, has been awarded a grant of \$59,800 by the National Science Foundation to conduct research on the photodetachment cross sections of negative gaseous halogen ions, an area related to radio transmission and rocket science.

The grant, which became effective last month and will be two years in duration, will have Wilis Lehr, a doctor of philosophy degree candidate and part-time instructor in electrical engineering from York as assistant. Dr. Harry A. Atwater, associate professor of electrical engineering, will assist in certain phases of the research.

Bus Service --

(Continued from page one)
lege Heights district. This latter bus will not go up Shorthidge Rd. on the morning trips.

Toney said the fare from College Heights will be 20 cents to campus and town. He said the fare from Park Forest Village would not exceed 25 cents but the actual decision had not been made.

The bus service on the campus will be on a 6-month probationary period with the University reserving the right to bar the buses from the campus if congestion results, Toney explained.

The company now has two buses but hopes to add a spare, Toney said.

Most representatives prefer at least two interviews with the applicant before an offer for a job is extended, Schnelle said. Often the second interviews are scheduled at company plants in order that plant officials may meet the applicant and form an opinion on whether or not he will fit in the company, he said.

Most companies like to let the student know where he stands, Schnelle said, and the applicant is usually told after his first interview whether or not he may hear from the company again. However, company policies vary on this point.

After interviews are completed, the applicant will receive a job offer or, as the case may be, a letter of rejection, Schnelle said. Company policies also vary as to rejection.

Some companies will tell a student after an interview if the company has a place for him or not, others send letters of rejection and some do not contact the applicant at all. Schnelle said that most companies realize the applicant's position and try to let him know of his chances as soon as possible.

The Placement Office has no figures on the number of job offers accepted at the present time, he said.

Coeds May Get Photos

Coeds who entered the Campus Cover Girl Contest may obtain their photographs in the front office of The Daily Collegian.

Photographs not picked up by Tuesday will be discarded.

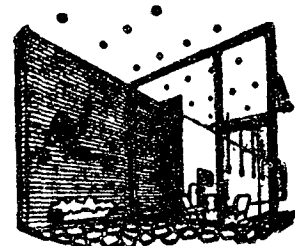

Through the Looking Glass with Gabbi

As the first round of bluebooks draws to a close (deep sigh of relief), every student's mind turns to thoughts of jam sessions, Hub hours, jam sessions, Whipples (if you belong to the "Polar Bear Club"), the gym finals, jam sessions. You get the idea. But true to Penn State tradition the weatherman won't co-operate. Spring is here complete with snowstorms. A few hardy souls were spotted on campus and downtown sporting trench coats and sockless sneakers. Next stop, infirmary. Speaking of next stop—drop by to see the botanical marvel in our window.

Only Ethel's Tree Grows Handbags

and only Ethel has such a variety of spring and summer purses. Especially chic are the bags of straw or linen trimmed in malgony or bone leather. Many of these beautiful handbags have been imported to satisfy your special requirements. Lucky coeds, Extra large handbags are in style this year. Now you can carry your books without looking studious.

Mom Should See Her Son Now . . .

You say your eyes resemble roadmaps, you have been wearing the same shirt for a week and worst of all you were really shot down in that last bluebook. Build up your morale. . . Handloomed ties in stripes, prints, checks, and solid colors can be found on Ethel's tie bar. We have the tie to boost any ego (and if you're charming, you may be able to convince your girl that it would make the "neatest" gift for a very appreciative male. We don't mean her father).

If You Still Have A Sense of Humor

send the guy who flunked the last bluebook a condolence card. To celebrate anything from birthdays to statehood send a card from Ethel's large selection of greeting cards. Enjoy the Nationals, See you next week. Gabbi

Ethel Meserve

WESLEY FOUNDATION

Present the Second of a Series on Immortality

March 20 9:00 a.m.

"Immortality According to Hinduism"

Mr. Pappa Reddy, speaker
Graduate Student, Engineering Mechanics

Coffee Hour 9:30 a.m.

Discussion Seminars 9:45 a.m.

"Animal Farm" by George Orwell
Rev. Joseph Faulkner, leader
Department of Sociology

"Religion as Creative Insecurity"
by Peter Bertocci
Dr. Elwood Oliver, leader
Department of Security

WELCOME

TO THE

NATIONALS

FOR YOUR CONVENIENCE:

- newspapers the latest NCAA results
- out-of-town papers
- paperbacks

NITTANY NEWS

WEST COLLEGE AVE., NEXT TO THE CORNER ROOM