

# IFC Sing to Include Quartets This Spring

Quartet competition will be included in this year's Greek Week sing contest as well as the regular IFC-Panhel sing.

Quartets are being included this year to "give fraternities and sororities a chance to enter competition if they can't get the minimum 12 singers for regular competition together," said Stewart Baily, co-chairman of IFC-Panhel sing committee.

Rules and entry blanks for sing competition were sent out last week.

Groups entering quartet competition will sing only one song. The choice of this song will be left up to the group. In regular competition one of the two songs will be chosen by the group and the other will be set by the committee. "Aura Lee" has been chosen for fraternities while "Goodnight My Someone" has been chosen for sororities.

Each group entering will receive two free copies of the required song. Additional copies may be purchased through the sing committee.

Preliminary tryouts for the regular sing will be held from 6:30 to 9:30 p.m. on Thursday, April 9 and Friday, April 10 in Schwab Auditorium.

Quarter preliminaries will be held on the same days; however, male quartet entries will compete on the night of the sorority preliminaries, and girls quartet entries will sing on the night of the fraternity preliminaries, thus enabling them to sing with their respective sing groups.

Fraternities and sororities may enter in both the group sing and the quartet sing.

Judging, which will be conducted over three evenings, will be based on tone quality, intonation, interpretation and phrasing, balance of parts, diction and general effects.

Final competition will begin at 7:30 p.m. on Saturday, April 11 in Schwab.

## Budget—

(Continued from page one)

vate benefactors for operating funds are unproductive because it is looked upon legally as an agency and ward of the State, Walker said.

"Only two courses of action are open to the University—either we cut the coat to fit the cloth or we seek additional funds," Walker said.

Lawrence told Walker personally last week of his appropriation request for the University. He also told Walker that he would only approve of a legislative increase in the University's allocation if the Commonwealth's budget is balanced.

As a last resort, Walker said that tuition fees and charges will have to be raised to make the ends meet.

In taking his request directly to the legislature, Walker will become the first University president to do so. In the past presidents have been called to Senate appropriations committee hearings to testify as to the University's needs.

Walker pointed out that the \$4.5 million increase will provide little more than enough money to take care of increased operating costs.

Walker's budget request was a \$15 million increase over the \$29.7 million the University received two years ago. At that time Walker requested \$38 mil-

# 'Gooney' Birds Cause Dilemma

By KATIE DAVIS

"How much farther can we ask a bird to go than to an island in the middle of the Pacific Ocean?" Dr. Hubert W. Frings, professor of zoology, asked yesterday at the faculty luncheon club.

Frings spoke to the faculty on "Civilization—The Bird's Dilemma." He explained the plight of the albatross or "gooney bird" which has been living on Midway Island for generations but is now being forced to leave due to the armed forces bases there.

"The birds settle on runways and get sucked into planes taking off," Frings said. "This is damaging to the planes and birds too."

Frings pointed out that these fatalities have not upset the remaining gooney birds at all. They are very tame and totally disrespectful of man, he said.

Only two devices have been moderately successful in driving away gooney birds. They leave upon hearing certain sounds played on a recording device and they will not fly into or near solid objects such as aprons placed above runways.

These devices are causing the birds to leave gradually. They can go to four other islands in the Midway area which have been established as bird reserves, Frings said.

Frings also explained the problem of areas in the United States and England overpopulated by starlings. He said that they first became pests in the 1890's when

central heating in homes became widespread. The starlings, instead of going south in the winter, just settled on warm buildings.

They also love towns with Norway maples and elm trees. "There is nothing better for starlings," Frings said.

Distress calls of starlings recorded and then played back have been successful in driving them away for a season, Frings said.

"We should ask what can we do to help these birds and ourselves," Frings concluded. "Often after we have let birds become extinct we realize how much they mean to us."

# Bjoerling Proclaims Local Crowds Best

By JEFF POLLACK

Playing the role of the perfect international diplomat, Jussi Bjoerling called Pennsylvanians the best audiences he has sung to. (His only other Pennsylvania appearances have been in Philadelphia.)

The Swedish-born tenor, who has sung in all the world's great opera houses, made the statement when he arrived on campus Saturday.

Bjoerling named the roles of Othello and Tristan as his favorites. His accompanist was quick to explain they are two roles the tenor doesn't sing.

Bjoerling said his enjoyment of a role depended on what mood he was in, where he was singing and how he felt physically.

On a more serious side, Bjoerling said that in some countries opera is the major part of the musical world. "It is not so in this country," he said.

The tenor said he was not considering rock and roll. "I don't believe it is in the same field," he said.

However, the man who made his operatic debut in his late teens is not opposed to other types of music. He said he had heard Louis Armstrong in Stockholm and thought he was very good. Arm-

strong played "Jazz at the Philharmonic."

At his summer home in Sweden, Bjoerling said he has a collection of things from his many world-wide tours. From the United States he has a 10-gallon hat from Texas as well as the keys to the city of Houston.

Besides having been given the honorary degree of professor of music at the University of Houston he is an honorary citizen of our second largest state.

Among his souvenirs are drums from the African tour and fishing and hunting equipment. Bjoerling said he probably got the most use out of the fishing equipment. He is an avid angler.

central heating in homes became widespread. The starlings, instead of going south in the winter, just settled on warm buildings.

They also love towns with Norway maples and elm trees. "There is nothing better for starlings," Frings said.

Distress calls of starlings recorded and then played back have been successful in driving them away for a season, Frings said.

"We should ask what can we do to help these birds and ourselves," Frings concluded. "Often after we have let birds become extinct we realize how much they mean to us."

central heating in homes became widespread. The starlings, instead of going south in the winter, just settled on warm buildings.

They also love towns with Norway maples and elm trees. "There is nothing better for starlings," Frings said.

Distress calls of starlings recorded and then played back have been successful in driving them away for a season, Frings said.

"We should ask what can we do to help these birds and ourselves," Frings concluded. "Often after we have let birds become extinct we realize how much they mean to us."

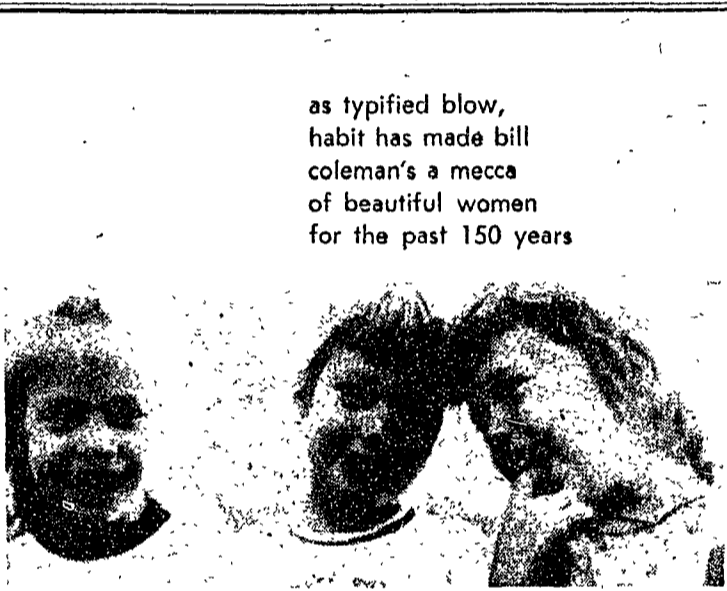

as typified blow, habit has made bill coleman's a mecca of beautiful women for the past 150 years

now you know . . .

because of the deluge of girls asking if the weird picture on display was of their sorority president, we feel that the time is propitious for the great revelation. Ashamedly, we admit the picture was taken at a local auction lately.

almost free . . .

we have about 200 extra party pix which we'll swap for the paltry fee of 50c each . . . to be turned over to the L.Sharp fund . . . today and tomorrow.

read on . . .

should your face appear in our new display—consider yourself one of the chosen ones indeed. The selections were made from over 500 recent sittings. If the prints appear a bit misty or ethereal, ist simply some of our experimenting . . . to seek your approval or otherwise

bill coleman's  
a very small studio on e. college avenue

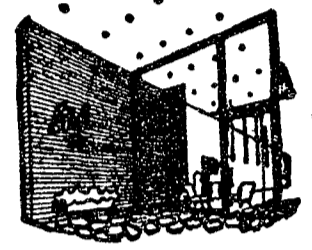

## Through the Looking Glass

with Gabbi

Looks like the spring thaw has set in kids. Maybe I'm rushing things a little, but I just purchased my season ticket to Whipples. Got yours yet? Speaking of rushing, why not rush right down to Ethel's and look over these items.

To get you into the swing of spring, Ethel has imported from Italy all shapes and sizes of natural straw bags trimmed in mahogany leather. Best of all, there are matching straw belts to give that spring '59 look to last year's khaki shirt.

In the jewelry department are delicate gold bracelets—five on one clasp. Each set has a small dangle—either a bell, whistle, or gold coin. These are specially designed to drive professors crazy as they clank against desk and books.

If you're puzzling over a gift idea, why not drop in and see Ethel's beautiful selection of table lighters. Some have flower designs, and others are in solid pastel shades. In the men's department are leather lighters by Irice and Rolfs. One tall, tall two tone leather lighter is particularly striking.

Say guys—this excludes habitual wearers of dirty grey sneakers. If you're short on time and need a shine (that little rhyme should qualify me for mention in Circa), why not look at some of the shine kits in the men's department. One which caught my eye is a soft leather pouch containing two brushes and a polishing rag. Another time and space saver is a clear plastic clothes brush with a manicure set built right into the top of the brush.—Be seeing you soon.

Ethel Meserve

**CIRCULATION STAFF MEETING**  
**Tuesday, March 3**  
**AT 7:00**  
**IN COLLEGIAN BUSINESS OFFICE**

we will be billing—  
 promotions will be announced

**Your Own School Colors in Stripes**

White cushion-foot crew sock that stretches to fit your size. Blend of soft cotton and stretch nylon foot with a true rib all cotton top.

WARREN HOSIERY COMPANY  
 ROUTE 1, BOX 29, NORLINA, N. C.

Please send me \_\_\_\_\_ pair  
 My school colors \_\_\_\_\_  
 Name \_\_\_\_\_  
 Address \_\_\_\_\_  
 City \_\_\_\_\_ State \_\_\_\_\_

Send cash, check or M. O. Include 10 cents for mailing. No C.O.D.'s