

# Opera Star to Open Community Concerts

Eileen Farrell, soprano of the San Francisco Opera Association, will open the 1956-57 series of programs for the State College Association at 8:30 p.m. Monday in Schwab Auditorium.

Membership cards, which will be required for admission to each of the five concerts scheduled for this season, have been mailed to the 1230 members of the association.

## 2 Speakers To Address Ed Meeting

Dr. Earl McGrath, director of the Institute of Higher Education, Teachers College, Columbia University, and Dr. John Russell, chancellor and executive secretary, New Mexico Board of Educational Finance, will be two of the key speakers at the annual meeting of the Pennsylvania Association of Colleges and Universities.

The meetings open on Sunday and continue through Tuesday morning at the University. More than 50 representatives of Pennsylvania colleges will attend.

Dr. McGrath, former U.S. commissioner of education, will speak at the dinner meeting Monday night while Dr. Russell, former assistant U.S. commissioner for higher education, will speak on "Space Utilization" at the Tuesday morning business meeting.

The meetings will open Sunday night with a buffet dinner, followed by a reception by President and Mrs. Eric A. Walker. Monday morning the program includes business meetings and a tour of the campus including observation of the closed-circuit television system in operation.

The new president of the Association will be installed at the Monday night banquet.

## WSGA Names 5 Committees

The Women's Student Government Association has appointed members for five committees.

They are:  
Publicity: Susan Whittington, chairman; Rozanne Friedlander, Marcia Griffin, Nancy Choraske, Josephine Rider, Susan Baicher, Susan Mamolen, Mona Fehrenbach, Mary Jane Clark, Marianne Maier, Marilyn Elias, and Joan Boucher.

Student Enforcement: Marilyn Seltzer, chairman; Helen Skade, Barbara Simon, Sybil Kirsch, Patricia O'Neill, Janet McHugh, Mary Ann Lawton, Linda Hartman, Mary Ellen Paxton, Anne McMullan, and Mary Funke.  
Necessity Counters: Josephine Hough, chairman; Janet Thompson, Susan Graham, Judith Klank, Judith Schindehette, Barbara Beamer, Mary Alice Wolfe, Dorothea Harms, Judith Bowers, Karen Goble, and Candy Hoffman.

Money Making: Susan Straight, chairman; Marilyn Coher, Barbara Jacques, Gail Rolle, Helen Baldwin, Jean Wilson, Susan Sunderland, and Ruth Nissen.

Television: Phyllis Hodges, Georgeann Roll, Nancy Bollenbacher, Suzanne Keener, and Marcia Frederico.

Her career began in 1950 when she made an overwhelming and triumphant New York debut recital in Carnegie Hall. This was followed by 61 solo performances in five separate engagements with the New York Philharmonic Society.

Miss Farrell's program will include Johann Sebastian Bach's "Mein Glaubiges Herze", the aria Ernani Involami from "Ernani" by Giuseppe Verdi, "Freundliche Vision" by Richard Strauss and the aria "To This We've Come from 'The Consul' by Gian-Carlo Menotti.

**Career Began in Radio**  
Born in Willimantic, Conn., Miss Farrell received her training in this country. Her career began in radio but concert managers and orchestra conductors were quick to recognize the magnificence of her lyric-dramatic soprano voice and she soon became a soloist with many major orchestras as well as a concert artist.

She sang 55 performances in two engagements when the Philharmonic Society made its first trip to Broadway's Roxy Theater. Following this she sang the part of Elektra in the American premiere of Milhaud's "Les Choeurs," an all-Wagner Easter Sunday program.

Miss Farrell is also known as guest star of The Telephone Hour and other major radio and television programs. Her voice was used for the sound track of the motion picture, "Interrupted Melody," the film biography of the Metropolitan Opera soprano, Marjorie Lawrence.

Miss Farrell became an opera star last year debuting as Leonora in "Il Trovatore" with the San Francisco Opera Association. More recently she has been winning acclaim for her role in the San Francisco Opera's presentation of "The Flying Dutchman."

## Professors to Hear Christ-Janer Talk

Dr. Albert Christ-Janer, director of the School of Arts, will speak at a meeting of the University chapter of the American Association of University Professors at 7:30 p.m. Tuesday in the Mineral Sciences auditorium.

Dr. Christ-Janer will give an illustrated speech on "America's New Painters."

Dr. Christ-Janer came to the University last February from New York University where he was director of Arts Center Associates, Inc.

A graduate of St. Olaf College and Yale University, he has been on the faculties of Stephens College, Michigan State University, and the University of Chicago.

## '1900' Junior Class Yell

The Junior Class yell of 1900: Hippy, hip! Kerzip, kerzip! Hippy hip! Kerzip! 1900, 1900; State, ZIP! ZIP!

## Little Man on Campus by Dick Bibler

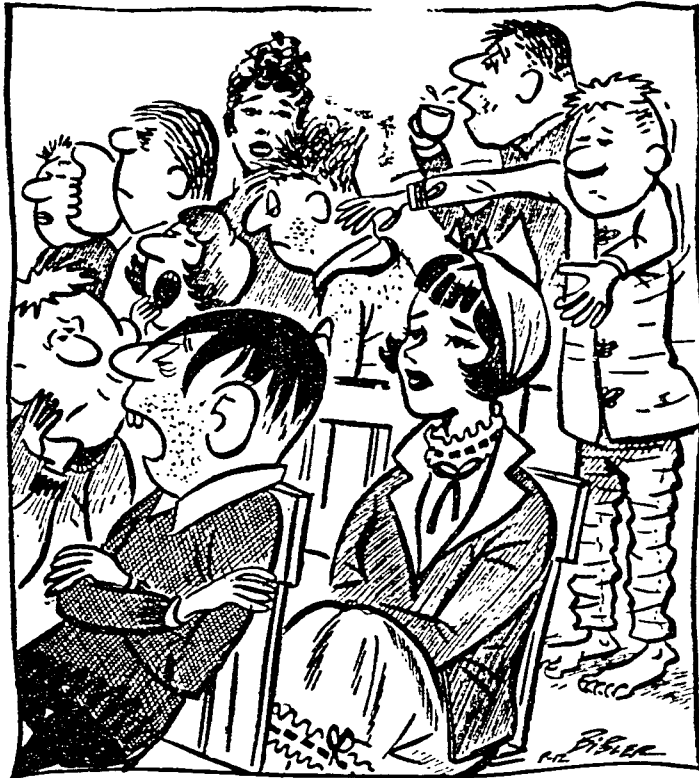

"First period classes ain't so bad—but get here on time—this guy locks th' door after th' bell rings."

## Approved Fraternities

The following fraternities have been approved by the dean of men's office for the entertainment of women guests tonight and tomorrow night:

Acacia, Alpha Chi Rho, Alpha Chi Sigma, Alpha Epsilon Pi, Alpha Gamma Rho, Alpha Phi Delta, Alpha Rho Chi, Alpha Sigma Phi, Alpha Tau Omega, Alpha Zeta, Beaver House, Beta Sigma Rho, Beta Theta Pi, Chi Phi, Delta Chi, Delta Sigma Lambda, Delta Sigma Phi, Delta Tau Delta, Delta Theta Sigma, Delta Upsilon, Kappa Delta Rho, Kappa Sigma, Lambda Chi Alpha, Phi Delta Theta, Phi Epsilon Pi, Phi Gamma Delta, Phi Kappa, Phi Kappa Psi, Phi Kappa Sigma, Phi Kappa Tau, Phi Mu Delta, Phi Sigma Delta, Phi Sigma Kappa, Pi Kappa Alpha.

Pi Kappa Phi, Pi Sigma Upsilon, Sigma Alpha Epsilon, Sigma Alpha Mu, Sigma Chi, Sigma Nu, Sigma Phi Alpha, Sigma Phi Epsilon, Sigma Pi, Tau Kappa Epsilon, Tau Phi Delta, Theta Chi, Theta Delta Chi, Theta Kappa Phi, Theta Xi, Triangle Zeta, Beta Tau.

Pi Lambda Phi has been approved for tomorrow night only.

The following fraternities have been approved for import housing: Alpha Chi Rho, Alpha Chi Sigma, Alpha Sigma Phi, Alpha Zeta, Beta Theta Pi, Chi Phi, Delta Tau Delta, Kappa Delta Rho, Phi Gamma Delta, Phi Kappa Sigma, Phi Kappa Phi, Sigma Pi, Tau Kappa Epsilon, Theta Chi, Theta Kappa Phi, Theta Xi, Triangle.

## Jazz Club Re-elects Byram to Presidency

Hampton Byram has been re-elected president of the Jazz Club.

Others elected were Riggs Griffith, vice president; Barbara McMillan, secretary; Nicholas Holman, treasurer; Robert Hild, historian, and Nancy Bortz, alumni secretary.

## Sigma Delta Chi Selects Delegate

John Lawrence, senior in journalism from Philadelphia, has been selected as the delegate to the national convention of Sigma Delta Chi, professional journalistic fraternity, from the University undergraduate chapter.

Chapter president, Harry Davis, senior in journalism from Clairton, has been selected as alternate.

The 47th annual convention of the fraternity is scheduled for Nov. 28, 29, 30, and Dec. 1 at Louisville, Ky.

**Russell Stover CANDIES**

guaranteed fresh... and so delicious!

\$1.35 1 lb. box

\$2.60 2 lb. box

exclusive at **GRIGGS PHARMACY**

120 E. College Ave.

## SPECIAL STOCKING OFFER!

**2 PAIRS AND 2 SPARES**

That's Right Ladies! With Every Two Pair You Get Two Spares... **FREE!**

Here's a rare opportunity to get a real long-lasting supply of fine nylon hosiery for far less than you ever imagined! A regular \$1.25 value for only \$1.00—plus a spare! When you buy this package of two pairs and two spares, you are actually getting three pairs of fine nylon hose. Take advantage of this offer NOW. Clip and mail the coupon below for fast delivery!

DENISE HOSEY, BOX 227, READING, PA.

Please send me two-pairs and two spares of Denise Hosiery For this I am enclosing \$2.00.

Name \_\_\_\_\_ Size \_\_\_\_\_ Length \_\_\_\_\_  
Address \_\_\_\_\_ Business Sheer   
Dress Sheer   
City \_\_\_\_\_ State \_\_\_\_\_  Beige  Taupe

DENISE HOSEY, BOX 227, READING, PA.

## Co-Edits

Newly initiated into Beta Sigma Omicron were Helen Baldwin, Patricia Hile, Sara Murphy, Carolyn Quarles, Margaret Jean Smith, and Huberta Young.

New initiates of Alpha Kappa Alpha are Arlene Roebuck and Grace Smith.

Newly initiated into Phi Kappa Tau are Ronald Casarella, Robert Clausen, John Drake, Joseph Janosky, Andrew Logan, Richard Strickler and Nelson Van Fleet.

New pledges at Phi Kappa Tau are John Bernard, Larry Cole, Frank Ehrenfeld, Francis Ganz, Floyd Grimm, Stephen Myers, John Newlin, Richard Noll, Walter Scott, Harry Sichi, Joseph Stecker, Robert Parker, Joseph Padolick and Louis Phillips.

New initiates of Phi Gamma Delta are Roberts Githens, Dale Sypherd, Wayne Breisch, Ralph Swank, James Nagle, Dana Harrison, Samuel Fleming, Phil Bostley, David Beebe, James Forsythe, Kenneth Bryfogle, and John Lange.

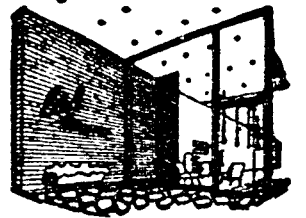

## Through the Looking Glass

by Jan

This is Conglomeration Time. Just a smattering the various and sundry items that can be found Through the Looking Glass while just browsing.

### JUST FOR FUN

If you've just barfed a blue-book, what you really need is something to cheer you up, or even if you've gotten A's on all of them. Why not buy some little extravagance that isn't necessary, but that's just unique! Just for fun!

How's about a tiny glass perfume vial, encrusted with rhinestones... or maybe you would prefer a match box in a brass case that has an embossed beetle perched on the front.

### PILLS, PILLS, PILLS

Big headaches from little annoyances grow. Are you a periodic pill-taker? Ethel's has a new pill-timer. It's a small round pill-case in black and gold that looks like the face of a clock with rhinestone numerals. You just set the little gold hands to the time you're supposed to down the next pill... clever, n'est-ce pas?

Do you like personalized or monogrammed possessions? Self-adhering, rust-proof metalgrams are, for you, then. They're small black and brass initial discs that will adhere to anything. They come in three sizes: 3 for \$75, 3 for \$1.00, and 3 for \$1.25. They'll look great on leather flask cases.

### DIRECT STEAL...

Does your room lack color? Are your walls drab and dingy? Do you hate to study in your abode because of the atmosphere? Don't be dissatisfied and dismayed. Ethel's has just the thing for you. Toss pillows galore! In colors straight from a Picasso canvas. You'll never complain again. Fabrics, sizes, shapes and prices to fit your every mood. Take your friends with you Through the Looking Glass to browse, or even sniff the sample perfumes. Mmmmm. See you there!

*Ethel Meserve*

112 E. COLLEGE AVE.

## HEAR STEPHENS...

featuring...

## Natural Sound

Shadle Associates proudly presents its favored line of High Fidelity speakers—Stephens. Available from the simplest to the most elaborate combinations... all with the natural sound. Prices start at \$38.50. See them today!

**SHADLE ASSOCIATES**

"The House of High Fidelity"

—151 S. Allen—