

Tomorrow Sunday

The Suburb With Water, Gas and Electricity
R. O. Stuckenrath Will Sell
In One Big Sale

Starting at 1.30 P. M. Sharp

CASH OR

At Your Own Terms
No Interest--No Taxes
For Two Years

Nothing Less Than 50 Ft.
Sold On Market Street,
40 Ft. On All Other Streets
To a Purchaser

Suitable Building
Restrictions

IN A NUTSHELL
A SMALL AMOUNT DOWN
Secures Your Plot Selected
A LITTLE EACH MONTH
Pays For the Ground Purchased

No Premiums--No Free
Lots--No Brass Band
Concerts--No Balloon
Ascensions--No Souvenirs
Every Cent Goes Against the
Land Purchased

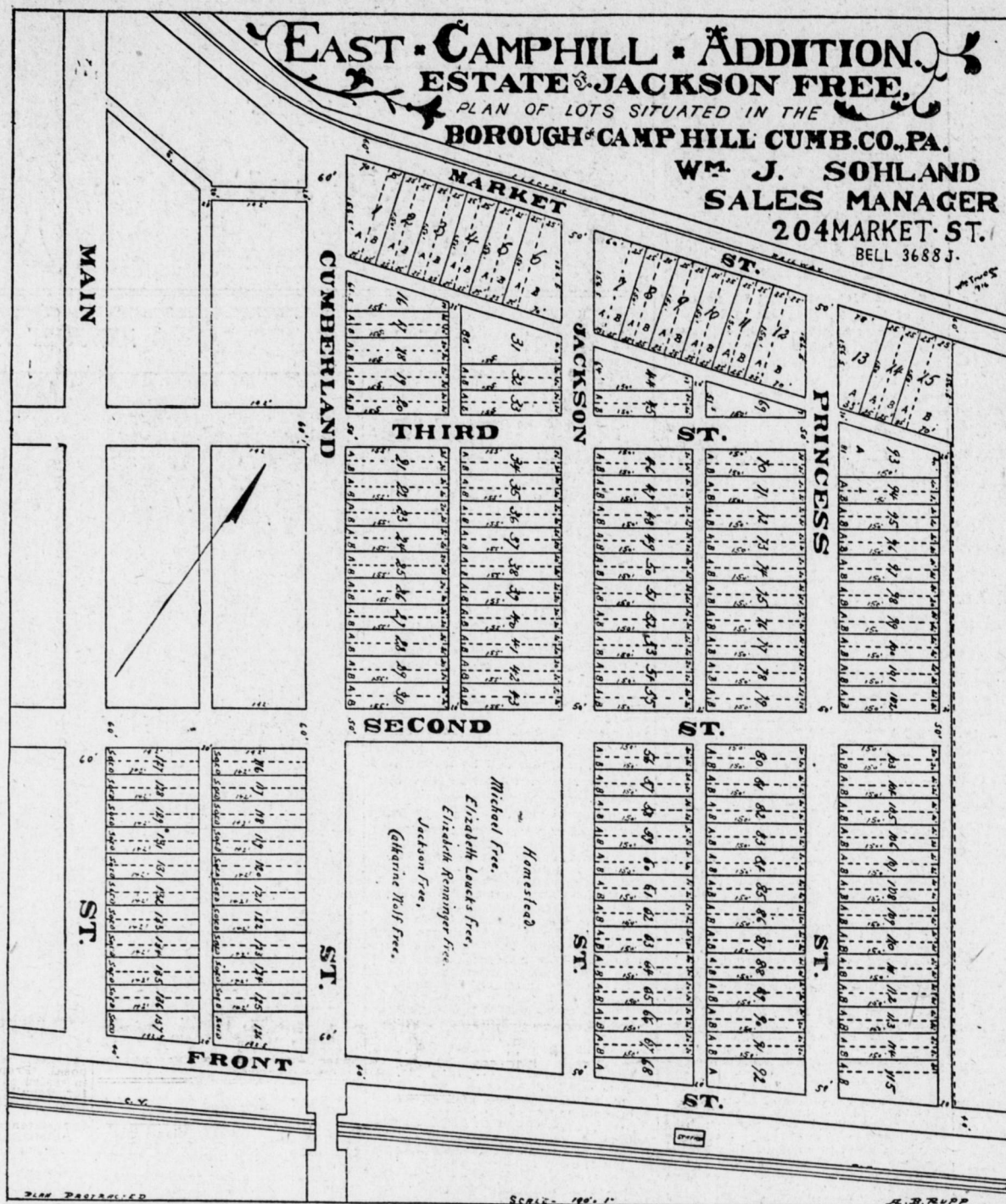

Inspection-Day
Bought Right
and
Sold Right
Ready to Build On
Fit to Live In

Perfect Title
Immediate Deeds
Guaranteed Survey
Fertile Soil
Right Location

A SUBURBAN LAYOUT
With City Conveniences

REMEMBER
Only 116 Plots Available

INDUCEMENTS
5c Carfare Limit
15 Minute Car Service
50 Foot Streets
10 Foot Sidewalks
20 Foot Alleys

How to Get There

Take a Camp Hill, Mechanicsburg or Carlisle Car—Tell the Conductor to Leave You Off at EAST CAMP HILL ADDITION.

How to Get There

RESERVE YOUR LOCATION BEFORE THE SALE---Call Bell 3688J We Will Take You To the Ground

Bell 3688J---W. J. Sohland, Mgr. Hbg. Office: Room 7, Shearer Bldg., 204 Market St. R. O. Stuckenrath, Owner, Bell 3688J

ECONOMICAL STEER FEEDING

OUTLINED BY STATE COLLEGE
It is essential to give feeding steers the right start when they are brought into winter quarters. If pasture is short they may be fed some good hay for the first week until they become acclimated to their new quarters. Corn in the form of fodder may gradually

be introduced, and any available pasture may be utilized at the same time. Steers should make a gain of one and one-half pounds a day on pasture supplemented by unhusked corn fodder, hay or any home grown feed. Steers should be placed in winter quarters when grass is frosted, usually

from November 15 to December 1. If they are of good grade and in good condition and weight, experiments at the Pennsylvania State College indicate that an economical feed consists of corn silage to the limit of appetite supplemented with two and one-half pounds of cottonseed meal for each 1,000 pounds live weight. This

ration may be fed the first three months, after which time the cottonseed meal may be increased gradually until when the steers have been in winter quarters for five months they will be receiving three and one-half or four pounds for each 1,000 pounds live weight. It is necessary to supply ear corn

in addition to corn silage and cottonseed meal during the last three months to animals not of high grade in quality and condition. When steers refuse to eat all ear corn or to shell corn from the ear, shelled corn should be substituted.

TEACHING JAPAN TO CHEW

Again the hustling American trader has been caught breaking down the ancient standards of the East. It used to be considered the height of rudeness in Japan to eat anything on the street. Along comes the Wrig-

ley's man with ten million sticks of chewing gum to be given away free to everyone who will promise to go out on the street and chew it. The campaign started last Fall with an extensive program of newspaper and billboard advertising. — World Outlook.

Bringing Up Father

Copyright, 1916, International News Service

By McManus

