

Political Points

On Feb. 8, at Uniondale, Rev. Charles Rhoads, of Philadelphia, and Mrs. J. Woodbridge Barner, two prominent state Sunday school workers will be present.

The Historical society of this county will meet in Montrose, on Saturday. The Republican county committee will meet in Montrose on Tuesday next.

H. G. Carr, of Dunmore, called on friends and business acquaintances here yesterday.

The following have been elected officers of St. Agnes' Pioneer corps for the ensuing term: President, W. P. Cole; vice president, John Shaugnessy; recording secretary, David Haley; financial secretary, William White; treasurer, Michael McGrath.

On Sunday morning the pulpit of the Presbyterian church will be occupied by Rev. G. N. Makely, of Greater New York.

Several changes are slated in the appointments of outdoor physicians. At present the West Side and North End wards are in one district in charge of Dr. Morgan J. Williams.

The question has been raised as to the right of three officials to hold certain city offices while occupying county or other city offices.

There are two opinions upon Dr. Payne's right to serve on the board of health. Mayor Bailey a year ago contended that Dr. Payne was ineligible to serve as a health official inasmuch as he receives pay as a poor director.

Today, between the hours of 4 and 7 o'clock, Democratic caucuses will be held in the Sixth and Eighteenth wards.

Primaries will be held in all the wards in the city Saturday afternoon to elect delegates to the Republican convention, to be held in Music hall, Tuesday next.

Tribune Classified Specials

HELP WANTED.....1 CENT A WORD FOR RENT.....1 CENT A WORD FOR SALE.....1 CENT A WORD REAL ESTATE.....1 CENT A WORD AGENTS WANTED.....1 CENT A WORD

SITUATIONS WANTED Free of Charge. All advertisements inserted in these columns (except as noted) are published free of charge, and are payable STRICTLY IN ADVANCE. DON'T fail to have them charged.

HELP WANTED—MALES. Adv. Under This Head One Cent a Word. HOTEL COOKS, YORK STATE, FARE 1000. Rooming on side line \$7.50 a month. 1438 UNION ST. WANTED—DRUG CLERK. H. M. COLE, 1438 UNION ST.

HELP WANTED—FEMALES. Adv. Under This Head One Cent a Word. LADIES, PIN MONEY, MAKE PATCHES on old clothing machine. We pay 70¢ per hundred; make 1200 weekly. We pay 70¢ per hundred for sample and particular. Write for particulars. American Trade Building, New York.

AGENTS WANTED. AGENTS—THE "MONARCH" IS THE best and cheapest telephone desk on the market. Retail price, including one year of paper, \$1. Liberal discount; exclusive territory. W. W. HAMILTON & CO., 21 MILK ST., Boston.

EMPLOYMENT AGENCY. Adv. Under This Head One Cent a Word. EMPLOYMENT AGENCY—HELP PUPILS, MISSED, MALE OR FEMALE. Room 2, Arcade.

FOR RENT. ROOM FOR RENT—709 ADAMS AVE. 105 SPRUCE STREET. ELEVEN ROOMS. Q26 GREEN RIDGE STREET. SEVEN ROOMS.

FOR SALE. FOR SALE—ONE 1897 "KEATING SPECIFIC" Bicycle, new, \$28.45. 222 WYOMING AVENUE. FOR SALE—ONE 1897 SPALDING RACING CAR, almost new, \$50.00. 222 WYOMING AVENUE.

SITUATIONS WANTED. WANTED—A POSITION BY A FIRST-CLASS BARBER, of good habits. Address, N. B. 104 office. SITUATION WANTED—BY EXPERIENCED ENGINEER AND FIREMAN. Will work anything. F. N., 526 Lavelle's Court.

WANTED—A POSITION IN STORE OR OFFICE, by experienced young lady; good penman. Address 901 Price street. AN INTELLIGENT LADY WOULD GIVE her time (except Sundays) for home privileges and small remuneration, with a charitable family in need of help. She is willing to help with light upstairs work. Address, X. Y. Z., Tribune office.

SHERIFF'S SALES

By virtue of sundry writs of Fieri Facias, Levatus Pacis and Venditioni Exposita, issued out of the court of common pleas of Lackawanna county, to me directed, I will expose to public sale by vendue or outcry, to the highest and best bidder, for cash, the contents hereinafter in the City of Scranton, Lackawanna county, on FRIDAY, the FOURTEENTH DAY OF JANUARY, 1922, at 10 o'clock in the forenoon of said day, all the right, title and interest of the defendant in and to the following described lots, piece or parcels of land, viz:

No. 1.—All the right, title and interest of the defendant, Thomas M. Jones and John J. Jones, in and to all of their undivided eighth (8/8) interest in all that certain lot or piece of land situate in the township of Spring Brook, (late Covington), in the County of Lackawanna (late Luzerne), and State of Pennsylvania, known as lot number forty-five (45) in the attachment of the Hockland lands, bounded and described as follows, to-wit: Beginning at a point on the southwest corner of the premises hereby granted, it being also the southeast corner of lot number forty-four (44) as shown by the east line of said lot last mentioned, and of lot number thirty-three (33) north of said lot forty-five (45) and south of lot number thirty-four (34) and thirty-five (35) north of said lot forty-five (45); thence by said lot last mentioned line west ninety-two (92) perches to a point on the east line of said lot last mentioned line west ninety-two (92) perches to the place of beginning.

Containing one hundred (100) acres and eight (8) perches, be the same more or less. Excepting and reserving therefrom, a tract of land that certain lot or piece of land, bounded and described as follows, to-wit: The western half (1/2) of lot number forty-five (45) in the attachment of the Hockland lands, beginning at a point on the southwest corner of the premises hereby granted, it being also the southeast corner of lot number forty-four (44) as shown by the east line of said lot last mentioned, and of lot number thirty-three (33) north of said lot forty-five (45) and south of lot number thirty-four (34) and thirty-five (35) north of said lot forty-five (45); thence by said lot last mentioned line west ninety-two (92) perches to a point on the east line of said lot last mentioned line west ninety-two (92) perches to the place of beginning.

Containing one hundred (100) acres and eight (8) perches, be the same more or less. Being the one-half (1/2) part of the land first above described. The premises hereby intended to be conveyed being the lot of land, bounded and described as follows, to-wit: Beginning at a point on the southeast corner of the premises hereby granted, it being also the southeast corner of lot number forty-four (44) as shown by the east line of said lot last mentioned, and of lot number thirty-three (33) north of said lot forty-five (45) and south of lot number thirty-four (34) and thirty-five (35) north of said lot forty-five (45); thence by said lot last mentioned line west ninety-two (92) perches to a point on the east line of said lot last mentioned line west ninety-two (92) perches to the place of beginning.

Containing one hundred (100) acres and eight (8) perches, be the same more or less. Being the one-half (1/2) part of the land first above described. The premises hereby intended to be conveyed being the lot of land, bounded and described as follows, to-wit: Beginning at a point on the southeast corner of the premises hereby granted, it being also the southeast corner of lot number forty-four (44) as shown by the east line of said lot last mentioned, and of lot number thirty-three (33) north of said lot forty-five (45) and south of lot number thirty-four (34) and thirty-five (35) north of said lot forty-five (45); thence by said lot last mentioned line west ninety-two (92) perches to a point on the east line of said lot last mentioned line west ninety-two (92) perches to the place of beginning.

Containing one hundred (100) acres and eight (8) perches, be the same more or less. Being the one-half (1/2) part of the land first above described. The premises hereby intended to be conveyed being the lot of land, bounded and described as follows, to-wit: Beginning at a point on the southeast corner of the premises hereby granted, it being also the southeast corner of lot number forty-four (44) as shown by the east line of said lot last mentioned, and of lot number thirty-three (33) north of said lot forty-five (45) and south of lot number thirty-four (34) and thirty-five (35) north of said lot forty-five (45); thence by said lot last mentioned line west ninety-two (92) perches to a point on the east line of said lot last mentioned line west ninety-two (92) perches to the place of beginning.

Containing one hundred (100) acres and eight (8) perches, be the same more or less. Being the one-half (1/2) part of the land first above described. The premises hereby intended to be conveyed being the lot of land, bounded and described as follows, to-wit: Beginning at a point on the southeast corner of the premises hereby granted, it being also the southeast corner of lot number forty-four (44) as shown by the east line of said lot last mentioned, and of lot number thirty-three (33) north of said lot forty-five (45) and south of lot number thirty-four (34) and thirty-five (35) north of said lot forty-five (45); thence by said lot last mentioned line west ninety-two (92) perches to a point on the east line of said lot last mentioned line west ninety-two (92) perches to the place of beginning.

Containing one hundred (100) acres and eight (8) perches, be the same more or less. Being the one-half (1/2) part of the land first above described. The premises hereby intended to be conveyed being the lot of land, bounded and described as follows, to-wit: Beginning at a point on the southeast corner of the premises hereby granted, it being also the southeast corner of lot number forty-four (44) as shown by the east line of said lot last mentioned, and of lot number thirty-three (33) north of said lot forty-five (45) and south of lot number thirty-four (34) and thirty-five (35) north of said lot forty-five (45); thence by said lot last mentioned line west ninety-two (92) perches to a point on the east line of said lot last mentioned line west ninety-two (92) perches to the place of beginning.

Containing one hundred (100) acres and eight (8) perches, be the same more or less. Being the one-half (1/2) part of the land first above described. The premises hereby intended to be conveyed being the lot of land, bounded and described as follows, to-wit: Beginning at a point on the southeast corner of the premises hereby granted, it being also the southeast corner of lot number forty-four (44) as shown by the east line of said lot last mentioned, and of lot number thirty-three (33) north of said lot forty-five (45) and south of lot number thirty-four (34) and thirty-five (35) north of said lot forty-five (45); thence by said lot last mentioned line west ninety-two (92) perches to a point on the east line of said lot last mentioned line west ninety-two (92) perches to the place of beginning.

Containing one hundred (100) acres and eight (8) perches, be the same more or less. Being the one-half (1/2) part of the land first above described. The premises hereby intended to be conveyed being the lot of land, bounded and described as follows, to-wit: Beginning at a point on the southeast corner of the premises hereby granted, it being also the southeast corner of lot number forty-four (44) as shown by the east line of said lot last mentioned, and of lot number thirty-three (33) north of said lot forty-five (45) and south of lot number thirty-four (34) and thirty-five (35) north of said lot forty-five (45); thence by said lot last mentioned line west ninety-two (92) perches to a point on the east line of said lot last mentioned line west ninety-two (92) perches to the place of beginning.

Annual Sale of Ladies' Underwear

It's always a January event in this store. More so this year than ever, because the stock is larger and better, and the prices lower than ever before. Our goods are all clean and fresh, made by intelligent people, in the best factory in the business. Our immense purchases cause these remarkably low prices.

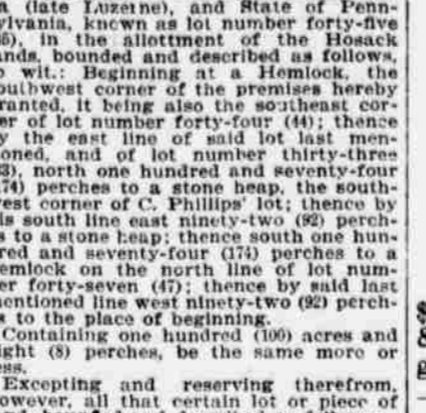

Night Gowns. SPECIAL PRICES—45c, 50c, 58c, 60c, 89c, \$1.15, \$1.25, \$1.35, \$1.50, \$1.65, \$1.75, \$2.25, \$2.50. Hill & Lonsdale Muslin, Lonsdale Cambrics and other good makes are used in our garments.

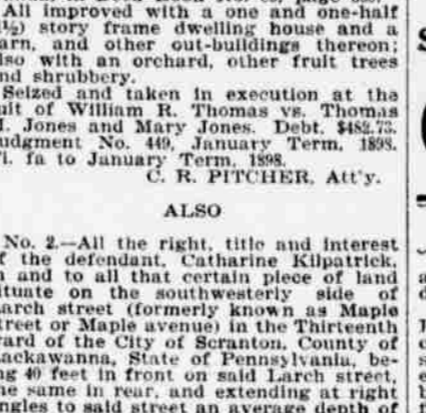

Drawers, Corset Covers. In all the different shapes, styles and finishes. These new prices: 23c, 29c, 37 1/2c, 45c, 69c, 75c, 89c, \$1.15, \$1.25. Others at 22c, 35c, 45c, 75c, 89c, \$1.15.

CHEMISE—Special lots at 37 1/2c, 45c, 69c, 75c. Scranton's greatest sale of Muslin Underwear.

Annual Sale of Ladies' Underwear

It's always a January event in this store. More so this year than ever, because the stock is larger and better, and the prices lower than ever before. Our goods are all clean and fresh, made by intelligent people, in the best factory in the business. Our immense purchases cause these remarkably low prices.



Night Gowns. SPECIAL PRICES—45c, 50c, 58c, 60c, 89c, \$1.15, \$1.25, \$1.35, \$1.50, \$1.65, \$1.75, \$2.25, \$2.50. Hill & Lonsdale Muslin, Lonsdale Cambrics and other good makes are used in our garments.



Drawers, Corset Covers. In all the different shapes, styles and finishes. These new prices: 23c, 29c, 37 1/2c, 45c, 69c, 75c, 89c, \$1.15, \$1.25. Others at 22c, 35c, 45c, 75c, 89c, \$1.15.

CHEMISE—Special lots at 37 1/2c, 45c, 69c, 75c. Scranton's greatest sale of Muslin Underwear.

Conroy & Wallace

Annual Sale of Ladies' Underwear. It's always a January event in this store. More so this year than ever, because the stock is larger and better, and the prices lower than ever before. Our goods are all clean and fresh, made by intelligent people, in the best factory in the business. Our immense purchases cause these remarkably low prices.



Night Gowns. SPECIAL PRICES—45c, 50c, 58c, 60c, 89c, \$1.15, \$1.25, \$1.35, \$1.50, \$1.65, \$1.75, \$2.25, \$2.50. Hill & Lonsdale Muslin, Lonsdale Cambrics and other good makes are used in our garments.

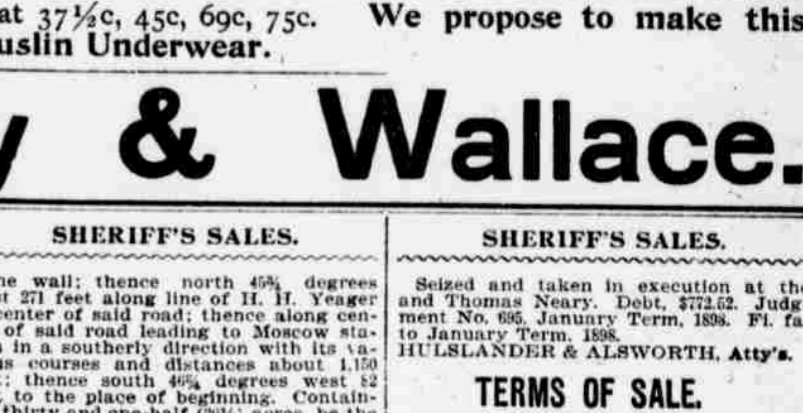

Drawers, Corset Covers. In all the different shapes, styles and finishes. These new prices: 23c, 29c, 37 1/2c, 45c, 69c, 75c, 89c, \$1.15, \$1.25. Others at 22c, 35c, 45c, 75c, 89c, \$1.15.

CHEMISE—Special lots at 37 1/2c, 45c, 69c, 75c. Scranton's greatest sale of Muslin Underwear.

Skates

A new line of Peck & Snyder's celebrated ICE SKATES. New Models, New Prices, New Ice. That Cut Ice. Prices That Cut More Ice.

WOLF & WENZEL, 240 Adams Ave., Opp. Court House. PRACTICAL TINNERS and PLUMBERS. Sole Agents for Richardson-Boylan's Furnaces and Ranges.