

County Correspondence

PINE GROVE MILLS

Game warden George Reed is driving a new Essex Six coach. J. Alf Reed, of Greensburg, visited his home folks here last week.

WINGATE.

Robert Malone made a business trip to Emporium, on Saturday.

The condition of Mrs. Silas Emehizer is very little improved at this writing.

Roy Summers is working for Ellwood Comley, on the State road near Snow Shoe.

Word from the Lock Haven hospital is to the effect that the condition of John T. Harnish is unchanged.

The W. C. T. U. met, on Friday evening, at the home of Mrs. Ida Wimer, with eight members present.

Rev. Herr preached two able sermons in the Baptist church at Milesburg, on Sunday morning and evening.

The Watchman correspondent will appreciate it if all those having news items will hand same to her not later than Monday.

We are glad to report that the condition of Mrs. Michael Witherite and Mrs. Elias Hancock, both of Runville, is decidedly improved.

John Furl, of Runville, was engaged in making a number of much-needed repairs on the buildings on the Boggs township poor farm last week.

Before leaving for his new appointment in Lock Haven, Rev. T. R. Hussler, of Howard, made farewell calls on his parishioners in this section.

Old mother earth was covered with eleven inches of snow, on Sunday morning, and the State highway was called out at five o'clock to clear the roads.

Mrs. Irwin, her two daughters, Florence and Edna, and son, Donald, with Mrs. Mary McLaughlin, were among the first to welcome their new neighbors, Mr. and Mrs. John Shawley, of near Bellefonte, who have taken charge of the Boggs township poor farm.

Miss Jane Hazel has been quite ill for several days.

G. Willis Houtz has installed an Atwater Kent radio in his home.

Mrs. John Jacobs is visiting her sister, Mrs. Jacob Feltz, in Altoona.

Wm. Rockett is making extensive improvements to the interior of his residence.

Charles Kuhn purchased the James Reed property, on Mountain street, at public sale on Saturday.

Mr. and Mrs. Israel Reitz, of Millbrook, spent Sunday at the home of their parents, Mr. and Mrs. Henry Reitz.

Representatives of the Spangler Music house, of Harrisburg, circulated in town last week and placed pianos in a number of homes.

Mrs. Wallace White, of Linden Hall, and Mrs. Luther Dale and daughter, Miss Margaret Dale, of Oak Hall, were guests of the Misses Dale for a day.

Mr. and Mrs. E. R. Tussey and family moved into the Goheen home last Wednesday. The house adjoining the Tavern, vacated by the Tusseys, will be occupied by Mr. Weaver, of Lemont.

The Women's Bible class of the Lutheran Sunday school gave a farewell party, Thursday evening, for Mrs. Harry Markle. The Markles expect to move to a farm in Ferguson township.

The public is invited to attend an oratorical contest by the pupils of the High school, in the Presbyterian church, Friday evening, March 23, at 7.30. The Civic club will present prizes to the winners.

Chaplain of President's Yacht at Penn State.

Chaplain Reuben S. Shrum, U. S. Navy, and for the past several years chaplain for the presidential yacht, "The Mayflower," is to be the chapel speaker at the Pennsylvania State College next Sunday, and his address is to be broadcast through the college radio station at 11 o'clock. These radio services at the college have become very popular with the radio listeners of Central Pennsylvania. The Sunday afternoon concerts broadcast from Schwab auditorium are also winning favor, the college orchestra, glee club and military band having been heard on the last three Sundays. Next Sunday at 3:30 the student mandolin club will give a concert, and on the following Sunday, March 25, Miss Ada Romig, a Senior, will give a recital assisted by the girls' glee club.

Trade in Moleskins.

Once considered chiefly as a pest, the mole is now regarded as an important article of commerce, since the demand for its fur involves a business of more than \$2,000,000 in this country annually, says Popular Mechanics Magazine. The most desirable varieties come from abroad, but more than \$100,000 worth of raw American moleskins have been marketed for fur. While the animal does considerable injury to crops, it is sometimes of benefit in destroying harmful insects.

Miss Grace Millward entertained Miss Eleanor Hoy, of Bellefonte, over the week-end.

Little Dorothy Tate, daughter of Mr. and Mrs. Mert Tate, is seriously ill at this writing.

Mr. and Mrs. James Williams, of Bellefonte, spent Sunday with their daughter, Mrs. Charles Stitzer.

Frank Millward and wife spent

Friday in Altoona, where they attended the Methodist conference.

Rev. and Mrs. Metzger are entertaining Mrs. Metzger's mother and sister, Mrs. Yeager, and daughter, of Jersey Shore.

Fred Gingham, a guard at the western penitentiary, was taken to the Centre County hospital with an attack of appendicitis.

Professor Jonas E. Wagner, wife and two sons, of Harrisburg, were week-end guests at the T. E. Jodon home, and visited grandpa Smeltzer in the Centre County hospital.

The recently organized Y. P. E. will meet at the home of Mrs. Wade Evey, April 13th, at 7.45 p. m. Any one between the ages of 14 and 25 is eligible for membership by signing the pledge and paying dues.

Real Estate Transfers.

Clarence A. Houtz, et ux, to James B. Stere, tract in Union twp.; \$4,228.09.

James E. Houser, et ux, to John W. Bathgate, et al, tract in College twp. \$1,500.

H. E. Dunlap, sheriff, to E. R. Taylor, et ux, tract in Marion twp.; \$4,500.

William L. Foster, et al, to John Winborne White, tract in State College; \$1.

E. E. Weiser, et al, to H. N. Worthley, et ux, tract in State College; \$8,635.

R. H. Graham, et ux, to Charles L. Byron, tract in Phillipsburg; \$1.

Harris Stover, et ux, to S. W. Gramley, tract in Penn and Haines twps.; \$1.

S. W. Gramley, et ux, to Harris Stover, et ux, tract in Penn and Haines twps.; \$1.

John B. Payne, et ux, to Olive H. Cliffe, et bar, tract in Bellefonte; \$9,000.

Catherine Summers to D. L. Keller, et ux, tract in Spring Twp.; \$3,000.

William P. Bell, Jr., et ux, to Maude H. Bell, tract in Lemont; \$500.

Clayton H. Fye, et ux, to Orvis Fetzer, tract in Curtin Twp.; \$550.

Trustees of Evangelical Parsonage of the Evangelical church of Millheim, to James E. Zeigler, tract in Millheim; \$4,000.

A. S. Stover, et ux, to Rudolph Beran, tract in Haines Twp.; \$500.

William Lytle to Janet McFarland, tract in College twp.; \$1.

Clayton D. Weaver, et al, Exec., to Esther Bierly, tract in Miles Twp.; \$600.

Daniel A. Krumrine, et ux, to George H. Harper, et ux, tract in State College; \$1.

Minnie Sensor to Catherine Anna Hopkins, tract in College Twp.; \$250.

Phillipsburg Cemetery Association to Edward J. Thompson, tract in Rush Twp.; \$38.50.

John H. Bitner to the United Mine Workers of America Hunting and Fishing Camp, tract in Potter Twp.; \$1,400.

Ellen S. Spotts, et ux, to James B. Flick, tract in Union Twp.; \$2174.65.

G. Edward Haupt, et al to John S. Knapik, tract in Bellefonte; \$250.

Henry Showers, et ux, to George W. Day, tract in Miles Twp.; \$700.

Fast Flight Soon.

"Around the world in 20 days" will be practical in a few years, according to calculations of French aeronaut experts based on the numerous flights from Paris to the Far East accomplished in the last two years.

From a detailed examination of the various flights it is apparent that the actual flying time over long distances was only a small part of the time taken, due to delays on the ground.

Thus, Pelletier D'Oisy, who flew from Paris to Saigon, a distance of about 7,000 miles, in 18 days, lost three days at Karachi, India; another day at Agra and three more at Calcutta.

The Americans, Brock and Schlee, flew from Paris to Rangoon, 6,300 miles, in ten days, having lost one day at Constantinople, owing to passport formalities.

Of course, none of these men flew at night. It is therefore deduced that, even at present, the Paris-Java flight, of a little more than 8,000 miles, can be made in seven days. As the circumference of the earth is 24,000 miles, the entire circuit could be made in three weeks. But for this it will be necessary to arrange the various "jumps," each of which would be made by a different machine with a fresh pilot.

The airplanes of 1927 are vastly superior to those of three years ago as far as the motors and radius of action are concerned, but the limit of human endurance has not varied. This is especially the case when it is a question of a constant effort over ten or more days.

As far as commercial flying has progressed it may be taken that 1,200 miles a day is the average distance possible. When special measures have been taken to make night flights safe the time of the world girdling flight will be appreciably diminished.

Ask Teachers to Aid Safety Move.

School directors in all sections of the State are asking superintendents and teachers to stress highway safety instruction in the schools.

The following communication is typical of those being sent to teachers:

"Since many of our schools are located along the busy highways over the country, children going to and from school along these highways are constantly in danger, and for this reason we ask teachers to urge children to use a great care while walking along these thoroughfares.

"Have the children walk on the left hand side of the road so that they may be able to see all approaching automobiles thus avoiding any confusion causing them to run to and fro across the road.

"Children should not accost the automobilist for a 'lift.' They little understand the responsibility the law places upon an automobilist who takes a child within his automobile.

"Teachers should make clear that in case an accident and personal injury should come to a free-passenger, the owner becomes responsible for any injury.

"Automobilists should not pick up children walking upon the highway and children should understand the reason why they are not picked up."

"Lindbergh Beach" Is Officially Given Name by Coast Town in France.

Saint Lo d'Ourville, a microscopic community on the Channel is the first town to be put on the map by trans-Atlantic flying. It now boasts a Lindbergh Beach. Imitators beware! Use of the name has been officially sanctioned by young Colonel Charles himself.

By a mere chance Lindbergh landed the Spirit of St. Louis at Saint Lo on

HOW TO SOLVE A CROSS-WORD PUZZLE

When the correct letters are placed in the white spaces this puzzle will spell words both vertically and horizontally. The first letter in each word is indicated by a number, which refers to the definition listed below the puzzle. Thus No. 1 under the column headed "horizontal" defines a word which will fill the white spaces up to the first black square to the right, and a number under "vertical" defines a word which will fill the white squares to the next black one below. No letters go in the black spaces. All words used are dictionary words, except proper names. Abbreviations, slang, initials, technical terms and obsolete forms are indicated in the definitions.

CROSS-WORD PUZZLE No. 1.

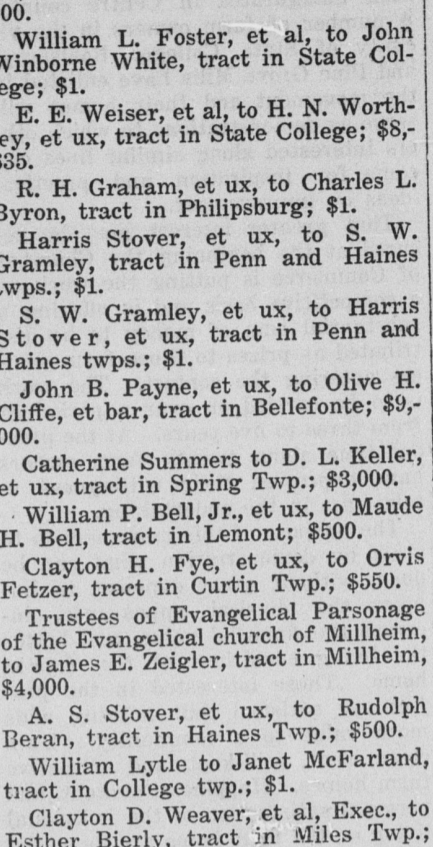

(© 1926, Western Newspaper Union.)

- Horizontal. 1-Oscillation 8-To differ 9-Part of an envelope 10-Kit 11-Flith 12-Piece of work 13-Filth 14-Female person 15-Sign of zodiac 16-Preposition 17-To affect with pain 18-Carmine 19-Fifty-two weeks (abbr.) 20-Half a quart 21-Close to 22-French writer, first name Emile 23-Scheme 24-Small barn 25-Auditory organ 26-To help 27-Thus 28-Interrogative pronoun 29-Monarchs 30-Evergreen tree 31-Captain of the ark (Bib.) 32-Fruit pastry 33-Pointed pieces of wire 34-Cover with paper 35-Feeble 36-An assertion

Solution will appear in next issue.

Vertical.

- 1-Large in extent 2-Anger 3-Preposition 4-Small particle 5-Proposition 6-Aged 7-Spike 8-Conceited 9-Animal sought by another as food 10-Chinese district in any large city 11-A shock 12-Bull-fighters 13-Stable 14-To be victorious 15-Born 16-Passageway in a church 17-Journey 18-Energy (U. S. slang) 19-Metal stick 20-Kind of tree 21-Wise man 22-Belonging to him 23-Theatrical performance 24-To go under water 25-Rowing implements 26-Egyptian river 27-Authoritative sanction 28-Head piece 29-Writing implement 30-Father 31-You and I

CHICHESTER'S PILLS

THE DIAMOND BRAND. Ladies! Ask your Druggist for Chichester's Diamond Brand Pills in Red and Gold metallic boxes, sealed with Blue Ribbons. Take no other. Buy only the DIAMOND BRAND PILLS, for 25 years known as Best. Satisfies Always. Sold by DRUGGISTS EVERYWHERE.



—Subscribe for the Watchman.

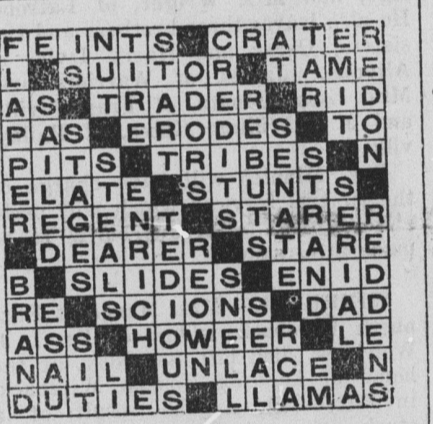

—Subscribe for the Watchman.

Used Car Bargains

AT Decker Chevrolet Co. Cor. High and Spring Sts. BELLEFONTE, PENNA.

WITH AN "O. K." THAT COUNTS

Table listing car models and prices: 1923 Maxwell Roadster \$50.00, 1925 Chevrolet Touring 175.00, 1923 Studebaker Sedan 250.00, 1926 Star Touring 225.00, 1925 Chevrolet Roadster, very good condition 260.00, 1927 Landau Sedan, fully equipped 500.00, 1924 Chevrolet Coupe 100.00, 1924 Ford Roadster 85.00, 1926 Chevrolet Touring 200.00, 1923 Nash Sedan 325.00, 1927 Chevrolet Coach, "late model" 450.00.

All These Cars Are Re-conditioned.

LIBERAL TERMS. Small Down-payment. Balance in Equal Monthly Payments.

Open Night and Day

ATTORNEYS-AT-LAW

SKLINE WOODRING—Attorney-at-Law, Bellefonte, Pa. Practices in all courts. Office, room 18 Crider's Exchange. 51-17

JENNEDY JOHNSTON—Attorney-at-Law, Bellefonte, Pa. Prompt attention given all legal business entrusted to his care. Offices—No. 5, East High street. 57-44

M. KEICHLINE—Attorney-at-Law and Justice of the Peace. All professional business will receive prompt attention. Offices on second floor of Temple Court. 49-5-17

W. G. RUNKLE—Attorney-at-Law, Consultation in English and German. Office in Crider's Exchange, Bellefonte, Pa. 58-5

PHYSICIANS

D. R. L. CAPERS, OSTEOPATH. Bellefonte Crider's Ex. 66-11 State College Holmes Bldg.

S. GLENN, M. D. Physician and Surgeon, State College, Centre county, Pa. Office at his residence, 35-41

C. D. CASEBEER, Optometrist—Registered and licensed by the State. Eyes examined, glasses fitted, Satisfaction guaranteed. Frames replaced and lenses matched. Casebeer Bldg., High St., Bellefonte, Pa. 71-22-1r

E. VA B. ROAN, Optometrist, Licensed by the State Board, State College, every day except Saturday. Bellefonte, in the Garbick building opposite the Court House, Wednesday afternoons from 2 to 5 p. m. and Saturdays 9 a. m. to 4:30 p. m. Bell Phone 63-40

Feeds

We Have Just Received a Carload

Wayne Chick Feed

Wayne Chick Starter, \$4.50 per H. Wayne All Mash Starter, \$4.40 per H. Wayne Chick Feed, \$3.50 per H. Wayne Egg Mash - \$3.50 per H.

We have just received a car of

Good Western Barley

re-cleaned for Seed and ready for Sowing. Price \$1.30 per Bushel

When you want good Bread or Pastry try

"Our Best" Flour

"GOLD COIN" Flour a high grade of spring wheat Pat.

C. Y. Wagner & Co., Inc

66-11-1yr. BELLEFONTE, PA.

Caldwell & Son

Bellefonte, Pa.

Plumbing and Heating

Vapor...Steam By Hot Water Pipeless Furnaces Full Line of Pipe and Fittings and Mill Supplies All Sizes of Terra Cotta Pipe and Fittings ESTIMATES Cheerfully and Promptly Furnished 66-15-1r.

Fine Job Printing

A SPECIALTY at the WATCHMAN OFFICE There is no style of work, from the cheapest "Dodger" to the finest BOOK WORK that we can do in the most satisfactory manner, and at Prices consistent with the class of work. Call on or communicate with this office

Employers

This Interests You

The Workman's Compensation Law went into effect Jan. 1, 1916. It makes insurance compulsory. We specialize in placing such insurance. We inspect Plants and recommend Accident Prevention Safe Guards which Reduce Insurance rates. It will be to your interest to consult us before placing your Insurance.

JOHN F. GRAY & SON.

State College Bellefonte.