

# Tillage Parts

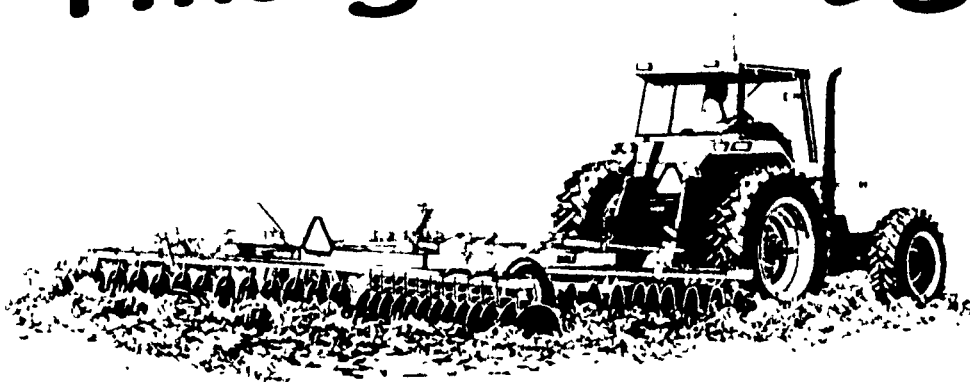

## DISC BLADES

Diameter	Thickness	Type	Hole Size	Hole Size	Part Number	List Price	Discount	Special Sale Price
20"	.177	Solid	1-1/8"Sq	1-1/4"Sq	30922R1	18.54	10%	16.69
20"	.177	Solid	1-1/4"Sq	1-1/2"Rd	998809R1	18.76	10%	16.88
20"	.177	Solid	7/8"Sq	1" Rd	31200R1	18.76	10%	16.88
20"	.177	Solid	1-1/8"Sq		<b>482973R1</b>	18.76	10%	16.88
22"	.197	Solid	1-1/2"Sq	1-3/4"Rd	604633R3	23.83	10%	21.45
22"	.197	Solid	1-1/8"Sq	1-1/4"Sq	644010R5	23.83	10%	21.45
22"	.197	Solid	1-1/4"Sq	1-1/2"Rd	960968R4	23.83	10%	21.45
22"	.256(1/4")	Solid	1-1/4"Sq	1-1/2"Rd	1132171R2	30.71	10%	27.64
22"	.256(1/4")	Solid	1-1/2"Sq	1-3/4"Rd	2804355R1	30.61	10%	27.55
22"	.197	Solid	1-1/8"Sq	1-1/4"Rd	<b>482975R1</b>	23.83	10%	21.45
22"	.197	Notched	1-1/8"Sq	1-1/4"Sq	955510R4	24.92	10%	22.43
24"	.197	Solid	1-1/2"Sq	1-1/2"Rd	956702R4	29.45	10%	26.51
24"	.256(1/4")	Solid	1-1/2"Sq	1-3/4"Rd	998865R3	37.00	15%	31.45
24"	.256(1/4")	Notched	1-1/2"Sq	1-3/4"Rd	998866R3	43.55	15%	37.02
24"	.312(5/16")	Solid	1-1/2"Sq	1-3/4"Rd	2804227R2	54.49	15%	46.32
24"	.256(1/4")			1-1/4"Sq	790-1000	35.76	10%	32.18

Prices Good Thru 4/30/03 With 16 or More Blades **Boldfaced Part #'s** indicate a crimped center blade.  
15% Off Any Part # With Purchase Of 30 Or More.

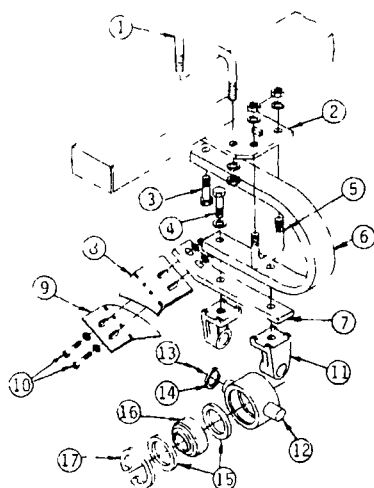

C FLEX STANDARD ASSEMBLY

## Sunflower Parts

	Part #	Description	List Price
1	2563	U-BOLT	5.30
6	2761	C-FLEX HANGER	65.14
7	3899B	DUAL SCRAPER MOUNT	7.98
8		Call for correct number	CALL
9		Call for correct number	CALL
11	3096B	BEARING MOUNT	12.65
12	3092	HOUSING-(Order 3090 - Comp. Assv)	N/A
14	3095	SPACER WASHER	.30
16	3091	BEARING INSERT-(See CASE IH Ins)	33.12
17	3094	BEARING RETAINER RING	2.53
	3090	COMPLETE BEARING ASSEMBLY	51.19
	2686	1/4" x 22" x 1 3/4" RD Blade, Harrow	36.45

### CASE IH Bearing Insert

		List \$
DC21UTR2	BEARING INSERT (SUNFLOWER APP)	32.95
FD209RAB	BEARING INSERT (IH & CASE IH APP)	18.38