

# Sale Reports

**M.M. WEAVER AND SONS SALE**  
Approximately 1,300 farm-related items were sold Monday at a public auction conducted by Aaron E. Martin Auction Service, Ephrata, for M.M. Weaver and Sons, 169 N. Groffdale Road, Leola. There were 1,104 registered bidders

Highlights included an MF 6180 tractor, \$31,000; JD 6300 tractor, \$18,250; a JD 4055 tractor, \$23,000; an MF 3650 tractor, \$18,000; a JD 4640 tractor, \$15,800; a JD 3640 tractor, \$11,100; a Case IH 5150 tractor, \$23,500; two Case IH 5230 tractors, \$15,000, \$12,500; a Ford 8630 tractor, \$20,700; a JD 4250 tractor, \$17,900; an MF 3140 tractor, \$22,000; an MF 263 tractor, \$12,500; two MF 230 tractors, \$5,000; and \$3,500; a Bobcat 743 skid loader, \$4,850; a Case 2090 tractor, \$4,300; an MF 1085 tractor, \$5,400; a JD 2640 tractor, \$6,350; an MF 35 tractor, \$4,850; an MF 2805 tractor, \$6,200; an IH 1086 tractor, \$4,900; a JD 350 crawler, \$4,650; a Ford 7700 tractor, \$6,700; an MF 1130 tractor, \$4,400; a Deutz 13006 tractor, \$4,200; an NH L445 skid loader, \$3,100; a JD 4020 tractor, \$7,000; an MF 540 combine, \$10,000; and an MF 1215 tractor, \$6,700.

Also, an MF 8460 combine and heads, \$8,100; two JD 2940 tractors, \$7,600 and \$9,000; a JD 50 tractor, \$1,800; an MF 240 tractor and loader, \$8,850; a JD 720 tractor, \$3,150; an MF 135 tractor, \$3,700; an IH 1086 tractor, \$9,800; a JD L tractor, \$2,075; a Case 1840 skid loader, \$8,000; two Case 1845 skid loaders, \$7,000 and \$4,300; an MF 285 tractor, \$7,100; a Ford 8N tractor, \$1,400; a JD 2630 tractor, \$4,700; an IH 584 tractor, \$5,600; an MF 1080 tractor, \$3,900; a JD 4010 tractor, \$5,200; a JD 4030 tractor, \$6,750; an MF 165 tractor, \$2,700; a JD 2640 tractor, \$9,200; a Ford 5640 tractor, \$9,900; a Sunflower disc, \$5,700; four Gehl 970 forage wagons, \$3,200, \$3,150, \$3,100 and \$2,600; a Gehl 170 mill, \$4,200; four JD 7000 corn planters, \$4,100, \$3,050, \$3,200 and \$2,900; a Brillion packer, \$3,600; a Badger forage wagon, \$6,100; a Hesston disc bine, \$18,000; and two Brillion seeders, \$2,500 and \$1,200.

Also, a bale wrapper, \$3,200; a Vicon rake, \$1,600; an NH 1495 haybine, \$1,825; an NH disc bine, \$6,300; an NH 316 baler, \$4,500; five bale wagons, \$4,400, \$2,000, \$1,850, \$1,800 and \$1,775; a JD 347 baler, \$4,500; an NH 630 baler, \$4,300; a JD 328 baler, \$5,000; a Hesston 459D baler, \$7,200; an NI spreader, \$4,500; three Gehl grinder/mixers, \$5,300, \$3,800 and \$3,100; an NH round baler, \$3,550; an NH 492 haybine, \$3,100; an Athens transport disc, \$2,900; an NH 40 forage blower, \$2,900; a Krause folding disc, \$4,100; a JD round baler, \$4,200; a Case IH 1360 grinder/mixer, \$12,500; two JD 935 disc bines, \$9,800 and \$7,100; an NH 488 haybine, \$1,800; an NH 634 round baler, \$5,700; a Hydra-Spread

spreader, \$7,250; a Risler 450 mixer, \$5,500; a JD 716-A forage wagon, \$3,525; a silage bagger, \$7,000; a JD harvester, \$6,000; two Case blowers, \$2,350; and \$2,200; a Woods mower,

\$5,900; a Hardi sprayer, \$2,300; and an NH 477 haybine, \$2,000.

**POTTER FARM SALE**  
An auction of a 97+ farm was conducted March 16 in McAllisterville by Courtney and Hassinger Auctioneers for the Potter Farm. The

property was purchased for \$330,000. Also sold were a Griswald #14 pan, \$200; a giant salted peanuts tin, \$450; an Edison cylinder player, \$400; a green swirl graniteware coffee pot, \$600; a fall

front desk, \$725; a grain painted chest, \$1,325; a green and cream Sears kitchen cupboard, \$4,300; a yellowware bowl, \$210; a sausage stuffer, \$200; a Farmall H tractor, \$1,000.



## 6.6 AC. TRACT OF WOODLAND IN WEST COCALICO TOWNSHIP PUBLIC AUCTION

**SATURDAY, APRIL 13, 2002**

**Auction Time 2:00 PM**

**DIRECTIONS:** From Reinholds take Route 897 North through Blainsport, turn right onto Peartown Road, go 1/2 mile, turn left onto Texter Mountain Road, go approx. 1 mile to property on left, West Cocalico Twp, Lancaster Co., PA

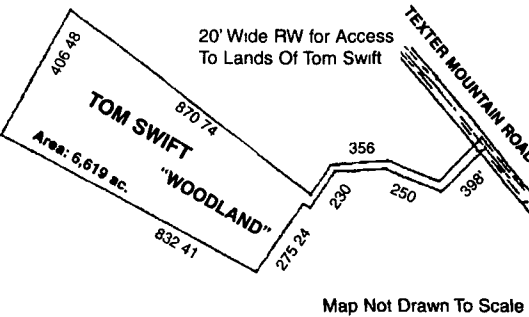

Map Not Drawn To Scale

This is a 6.6 acre wooded building lot approx. 1200 ft. off Texter Mountain Rd. This lot has a 20' stoned right of way to the lot and is totally secluded. Lot has been perked for an inground septic system. A must see for privacy. You may drive in and see it. **NOTE:** Auction will be held at the 6.6 acre lot. If you're looking for a private setting, or a great tract for hunting, don't miss this auction! **TERMS:** 15% down payment at auction, balance at final settlement on or before June 1, 2002. Attorney: Harvey Miller, 299-7374



Auction By **TOM SWIFT** 299-6631

## PUBLIC AUCTION SAT., MAY 11, 2002 9:00 AM REAL ESTATE, CARS, PERSONAL PROPERTY

**Location:** 665 Green Ridge Dr. Manheim, Penn Twp., Lanc. Co. PA. From Manheim - Rt. 72 S. turn Right on Sunhill Rd. approx. 1 1/2 mi. to Green Ridge Dr turn Right, third house on Right. Watch for signs.

House consists of brick and vinyl frame bi-level, wall to wall carpet, situated on a spacious lot with mature shrubs and trees. Includes modern kitchen, dining rm, living rm, family rm w/wet bar, 4 bedrms, 2 fireplaces - 1 w/insert, 2 full ceramic tile baths - 1 w/laundry, utility rm, attached 2 car garage, open deck, patio w/roof, and utility shed.

This is a must see property located in a culdesac situated in a quiet, rural neighborhood, yet close to school, church and business; approx. 10 mi. from Lancaster and 6 mi. from Exit 20 PA Turnpike

**OPEN HOUSE** April 1 5-7PM April 6 2-4PM or by appt. call 717 665-6684

Property to be sold at 11AM followed by cars - 1978 Rolls Royce Silver Shadow II, 46K org, CA compliance, PA insp. (completely restored) 1979 Cadillac

**TERMS:** 10% down day of sale, balance due on or before June 26, 2002

**Wolgemuth Auction Service**  
Agent for owner  
717 665-6684  
Young & Young Att.

**WOLGEMUTH AUCTION SERVICE**  
Robert Wolgemuth Lic#1534  
Dennis Wolgemuth  
Eric Felch app.

## PUBLIC AUCTION Sale of Excess Inventory, Trucks, Various Types of Equipment, Including Lawn & Garden, Contractor, New & Used Tools Sat., April 20, 2002 @ 8:30 AM 1327 N. Reading Rd., Stevens, PA

From PA Turnpike Exit 21 take Rt 272 South for approx 2 miles to auction on left E. Cocalico Twp, Lancaster Co

**Eg. Equipment:** SDK#7 Toyota Skid Loader (approx 2000 hrs. exc cond.) Toyota backhoe attach 18" auger attach, MS300 1981 Mack w/new engine 1982 Ford 4x4 pick-up w/Myers 7' snow plow, 1994 Dodge 4x4 pick-up w/Myers snow plow 52000 mi ex cond, JD Gator 400cc Polaris diesel 4x4 ATV, numerous sizes of skid loader & utility trailers, Ford 800 tractor w/3pt hitch, 20hp SP stump grinder, tow behind air compressors ranging from 100-160 CFM, JD 212 riding mower w/38" deck JD plow attach, JD bagger attach, JD snow blower cycle trailers, car caddies, 880 Wacker roller, TC 30 Car fork lift

**Misc. Equipment:** 3-230 gal tanks w/spill plate preventer, 12" floor polisher, carpet cleaners, belt sanders, joint grinders, nailers, cut off saws, generators, 1400-4500 watt self feeding screw shooter, stud gun, 16mm projector lectern table top PA system, dehumidifier, 19" color TV, upright vacuum, 70" x70" projector screen, elec ceramic heaters, clip on hitches, bumper to bumper tow bars, ball to frame tow bars, snow blowers, elec pipe threaders, wet/dry vacs, car polishers, sander, mixer saws, battery charger, chain saws, 1 & 2 man post hole diggers, Binks auto paint gun HVLP paint sprayer, core drill, 1-1/2 ton chain hoist level sight, David White transit, laser levels, Little Wonder hedge trimmers, cordless drill band saw, tree pruners w/saw, Bosch demo Hammers, forced air BTU heaters, drywall lifts, troweling machines, Sweepster power broom, Mighty Mac 3hp leaf shredder, chippers, 1500lb Cap Engine crane broadcast spreaders, drop spreaders, kero heaters, wood router, hammer staplers, quartz light on stand, weed cutters, string trimmers, circular saws, saw-all, leaf blowers, elec concrete mixers, pallet jack, step ladders, sandblasters, Edco floor saws, lawn rollers, push & pull type lawn aerators, Troy-bilt chipper vac w/hose, gas trash pumps, steam jenny, pressure washers, Wacker compactors (upright & plate tampers), air jack hammers, rock drill, hand press, drain saw, alum brakes, Blue Bird 6pc engine crane, Muller 6cu ft gas mortar mixer, Muller 10cu ft concrete power buggy, York rake, submersible pump, drop seeders, gas lawn mowers, rear tire tillers, bench grinders, lawn thatcher, lawn edger, overseeder, misc trailers, concrete vibrators, metal roof rack, front tire filler, elec cable hoists, metal detector, portable signal 4 gal/elecric French fryers, lots of B&D misc parts

**New Equipment:** Jet hydraulics jacks, Little Wonder hedge trimmer B&D grinder, Stihl elec weed cutter, Senco roofing stapler, Senco corrugated fastener, Bosch cordless drill, Makita rt angle drill, Bosch chip ping hammer and much more new and used power and hand tools

This sale is of excess equipment obtained from the purchase of another business. Lots of good equipment with more than one and up to ten of many items!!!!

**Eagle Rental is expanding to better serve you** Starting at 8:30 AM sharp with misc small equipment trucks and licensed equipment will be sold at 12 noon followed by the balance of the large equipment

Food available Auction held indoors  
**Terms By: Eagle Rental Center**  
HFA>>Horning Farm Agency, Inc.  
Realtors \* Auctioneers \* Appraisers  
Alvin & Elton Horning \* Merle Eberly 2417-L \* C Ivan Stoltzfus  
Route 23 Morgantown PA 19543 (610) 286-5183  
www.horningfarmagency.com

## PUBLIC AUCTION JOHN DEERE TRACTORS/ GRAIN & DUMP TRUCKS FARM EQUIPMENT/ MACHINERY

Auction for JOSEPH PYSKATY, Asbury Rd, Hackettstown, NJ. From Rt. 57, go into Hackettstown, at "Y" bear left onto Rt. 46 West (Main St) thru town, turn right on Petersburg Rd. & left on Asbury Rd. to farm on right. Arrows posted.

**SAT., APRIL 6 - 9:30 A.M.**

John Deere 4030 diesel wide front tractor w/rollcage - good rubber & good running cond., John Deere 3020 diesel tractor w/rollbar - 3 pth & good rubber, John Deere 4020 diesel tractor w/heated cab - 3 pth - good rubber - wide front, 1962 Int. B180 14' grain body truck w/double cyl. hoist - good running cond. & 66K orig. miles, J.D. 224 baler w/kicker, J.D. 3 pth 5' brush hog, J.D. 2500 18" 5 bottom plow, J.D. cultivators, J.D. 110 disc, J.D. pulltype brush hog, J.D. 7000 corn planter w/fiberglass attachments, J.D. husker w/narrow head, 16' to 40' grain/hay elevators, A.C. Glenler K combine w/11 grain heads, N.H. 2 row corn chopper - #469 (9') haybine - #55 5 bar hay rake, (2) 8'x16' hay wagons w/6 ton gears, 2 Parker slide wagons, (2) 8 ton 8'x16' hay wagons, 4 ton 8'x16' hay wagon, 3 pth. post hole digger, 30' boom 180 gal. sprayer, 6' Mott PTO mower, 3 pth. 4 row cultivator, Lely 1 row tedder, 8 tooth Graham chisel plow, 3 pth. 7' side bar mower, 11' & 16' on wheels spring tooth harrows, lg. field lime spreader on wheels, 3 pth. spin fertilizer spreader, Meyer 9' angle snow plow, Crafts. air comp, hardware, parts, log & tractor chains, hand tools, chain saw, very partial listing. All tractors in good working order ready for spring. Not responsible for accidents. Auction starts w/smalls - tractors/machinery to start about 11:00/11:30.

**Terms:** Cash or approved check  
Food

Arthur Hanna Auctioneers  
Bloomsbury, NJ  
(908) 995-9699

## TOOL & EQUIPMENT CONSIGNMENT AUCTION

**Sat., April 6th, 2002**

**Auction Time 9:00 A.M.**

**Directions:** Located at Reistville Produce Auction Grounds Lebanon County, PA Midway between Schaefferstown and Myerstown off Route 501

**From Route 422** Take Route 501 South turn right on Reistville Rod  
**From Route 897** Take Route 501 North turn left on Reistville Road to auction on right

**EQUIPMENT:** John Deere 250 skidloader 800 hrs. (Like New) Daewoo Mini Tractor (diesel) 1995 Chevrolet Silverado 4x4 Ext. cab 1500 pick up (165 000 miles), 1996 Pequea Tandem axle flat 20 trailer (2900 GVW Elec. brakes), Koehring Skytrac 30' Telescoping highlift (diesel) Allis Chalmers LP forklift 5,000 lbs., Stone Mud Mixer, Set skidloader forks 3 pt Gill Pulverizer, Reading Work Topper 1993 Ford F-350 Crew Cab, dually (155 000 miles), 2001 Pequea 20' Gooseneck Trailer (14,000 GVW), 1989 Ford F-150 with Reading Cap (150,000 miles), 1991 Chevy Cavalier Sdn., automatic (200,000 miles), 16' Trailer Triaxle with elec. brakes (18,000 GVW)

**TOOLS:** Honda 6500, Honda 5500 and (3) Honda 3500 generators, 2 Emgo compressors, (3) Bostitch roofing nailers, (4) Bostitch coil framing nailers, Impulse frame nailer, Acetylene torch and cart outfit (no tanks), Homelite 5 HP Water Pump, Campbell Hausfield compressor Black & Decker Electric cut off saw, Rockwell and other drills, (2) Milwaukee Rotary Hammer Drills, Milwaukee Screwshooters, (2) 18 volt Dewalt cordless drills, Sawzall, Duofast Framing nailer, Tripod, Berger Transit, Spectra-Physics Laser, Top-Con Laser, Whiteman 8 HP 36" Troweling machine, Hand held vibrating concrete screed, Concrete yard bucket to pour block cores, Shovels, Rakes, Hoes, Lots of sockets, wrenches, pliers, vise grps, hammers, etc Plus Delta table saw, Delta jointer, Bandsaw and more woodworking tools, air hoses, extension cords, fiberglass ladders, 10' Aluminum brake & accessories, Dewalt sliding compound mitre saw, Makita 7" framing saws, lots of tool boxes, 36" & 48" troweling machines

**BUILDING MATERIALS:** (2) skids New brick 4"x8" patio pavers, new vinyl double pane windows (various sizes), 2'x3' New Certained Slider Door, 36" Storm door, New gas fireplace stove, plus more

**AUCTIONEERS NOTE:** This is only a partial list, lots more to show up by auction date To consign items call (717) 949-2771, receiving date April 5th 8 00 AM till 8 00 PM We reserve the right to reject any unsaleable items

**TERMS:** Cash or good PA check no out of state checks unless accompanied by Approved Bank Letter of Credit

**Philip Hurst**  
(717) 949-2771  
For Fast Reliable Auctions  
call **HURST FIRST**  
5 Stump Rd  
Newmanstown, PA 17073  
AU-003375-L

## 9 ACRE HORSE FARM ~ TRACTOR ~ DUMP TRUCK ~ TOOLS & EQUIPMENT ~ SHORT NOTICE PUBLIC AUCTION SAT., APRIL 27TH 9:00 AM

**LOCATION:** 40 STRAUSSTOWN RD. TULPEHOCKEN TOWNSHIP, BERKS CO. BETHEL, PA. 19507 178 Old Exit 6, Take Rt. 419 South Approx. 2 Miles To Strausstown Rd. Turn Left To Sale On Rt. Look For Sign.

### REAL ESTATE

Nicely Situated. Featuring 2 Dwellings & 26' x 133' 8 Stall Horse Barn w/Individual Paddocks. Property Is Pastured With 6 Strand Hi-Tensile Fence From Ag Fencing. Also Fenced Riding Ring. 2 Story Farm House Includes Kitchen, Dining Rm. Living Rm., Laundry & Bath On First Floor, 3 Bedrooms & Bath On 2nd Floor. New 200 Amp Service & Oil Hot Water Heat. Other Out Buildings Include 2 Story 2 Car Garage With Attached 25'x51' Shop, 16'x24' Screened in Pavilion, 14'x60' 5 Yr. Old Mobile Home w/Shingle Roof (Nice Rental Property), 10'x54' Office Trailer (Could Be Used For Dressing Area). New Septic System Installed For 3 Dwellings. Beautiful Country Setting w/View Of Blue Mountain!! Terms For Real Estate 10% Down Day Of Sale Balance Within 90 Days. Real Estate Offered w/Reserve At 12 Noon. For information Or Inspection Please Call Auctioneer. House Will Be Open Sale Day 8-10 Am. If Interested Call Now And Take Advantage Of This Short Notice Public Auction Opportunity!!! Also Selling Same Day - 65 Massey Ferguson Tractor; 3 Pt Equip.; ~ Carpenter Tools & Equipment ~ Building Materials & Supplies ~ Misc. Personal Prop.

**SALE FOR: OWEN & BARBARA BEIBER**  
Ken Sandoe Attorney

**NOTICE:** Terms Of Sale Cash Or Good Pa. Check. Neither Seller Nor The Auctioneer assume Any Liability For Hurt Or Damages To Anyone Attending This Auction! Announcements Made Day Of Sale Take Precedent Over All Printed Material. Food Served.

**AUCTION CONDUCTED BY: LES LONGENECKER AUCTIONEER (610) 488-6575**