

MAILBOX MARKET FOR SALE

1951 GMC 470 2 1/2 ton 6,997 miles believed to be correct, 6 new 10 00x20's rust free cab runs, drives Seneca 607-532-8512

84 Ford dump truck bad motor, eisdiesel car for sale set of cultivators for C Farmall Schuykill Co 570-889-5740

12 ton winch with PTO from 18 speed R model Mack \$500 OBO Berks Co 610-921-5760

97 Polaris snowmobile 680CC Dynoport pipes, 192 studs, reeds, polished, ported, very fast grass drags winner, ex cond Berks Co 610-285-6444

Howse 6 ft Brush Hog mower, 3ph like new \$425 Centre Co 814-238-7570

Euclid-L15 front end loader 8N Ford, Farmall M, M Moline ZU Snapper mig welder 6 ft Bush Hog 3 pt rear blades, Clinton Co 570-726-6641

John Deere Model M with Woods belly mower, completely restored \$4500 570-374-4246 after 5 PM

Cub Cadet 1250 hyd lift \$700 IH windbreaker for Cub Cadet \$145, old Simo sickle sharpener \$5 Leb Co 717-866-5199

1963 JD snowblower attachment Model 36, new bearings decals, and paint, works great \$325 Lanc Co 717-367-9214

Hobart 12 qt mixer \$500 No Sunday calls Columbia Co 570-799-0139

M Moline backhoe 2 hoe buckets front bucket all work good, but needs motor \$2000 or best offer Brad Co 570-596-4939 7 AM-5 PM

Multimay calf hutch, good for several weaning age calves \$475 Chester Co 610-593-5165

Antique spring wagon or truck board, good cond, would paint it to your specification, Lanc Co, 717-442-9333

2 cyl Wis baler eng in good cond, model TJD, \$500 Levi Fisher, 5780 Buena Vista Rd, Gap, PA 17527, Lanc Co, 717-442-3333

Jack Russel pups, ready to go now, \$200 OBO, Lanc Co 717-354-5347

Dnan 2 cyl, Jacobsen snow, super 20, antq 77 AMC, \$490 OBO, 1500 bu galv corn crib \$800 OBO, silage, spreader, 20', \$80, Montg Co, 610-454-0139

Cap for short bed truck, red, exc cond side sliding windows, \$550, Bucks Co, 215-968-2798

100+ pcs Guardian service cookware, \$600 all, belt conveyor, 4 10' sections, 15" wide w/motor, \$100 York Co, 717-235-8166

Order now red sex link pullets, ready to lay 1/25/02, (1-10 \$4 60) (11-25 \$4 40) (26+\$4 20) crates, fountains, Samuel Lapp, 1598 Noble Rd, Kirkwood, PA 17536

Jersey heifer, due 2/22/02, \$750, Berks Co, 717-933-8835

Sorrell mare work horse, 8 yrs old, works on both sides, good, broke, 17 hands, Elam H Zimmerman, 128 California Rd, Narvon, PA 17555, Lanc Co

Chicken nest, 15 hole, \$35, hog feeder, 2 hole, \$40, good cond, Cream Ridge, NJ, Monmouth Co, 609-758-8207

Gas range, 20" white, \$20, alum roofing sheets, 26" wide, 10' long, used, \$5 each, Lanc Co, 717-872-6745

4 Harmony claws for milking units, \$150 each, Henry Z Fisher, 38 S Kinzer Rd, Kinzers, PA 17535, Lanc Co

Cub Cadet 102 snow blower, ft mt, good cond, \$95, Lanc Co, 717-872-5520

Hay, \$ 45/bale, Chester Co, 610-857-3560

Used treated lumber, 2x6 14' long, PVC tubing pipe rolls, Leb Co, 717-949-3044

12 young dark Brahma chicken roosters & hens, Lanc Co, 717-354-0644

Ford 9N 3 pt hitch, hyd loader, PTO, new ignition, battery looks and works good \$2500 Tire chains avail Cumb Co 717-697-9745

MF 50C with loader and canopy engine overhauled, new tires, ex cond Call after 5 PM \$7500 Lehigh Co 610-298-2701

Holstein heifer calf DOB 11-14-01 dam 64 lbs 4% 41,000 SCC 450 00 Kent Co De call after 6 PM 302-422-2832

Hesston baler model 4590 with thrower, hydraulic, bale tension and pickup ex cond \$8000 OBO Burl Co 609-267-6589

10' side dump body, good for feed lot troughs \$800 570-345-8426

Used windmill also 6000 or 8000 gallon water tank Write eter Starr, 499 W Maple Grove Rd, Denver, Pa 17517 Lanc Co

JD sound guard cab parts, glass door, roof, air conditioner & windows, Rissler TMR mixer #75 \$1000 Bedford Co 814-766-2325

1987 Ford F150 pickup 6 cyl, AT, 140K miles, new insp \$2400 1994 Ford Ranger PU 4 cyl 5 sp \$2900 Chester Co 610-495-6273

12 yr old saddlebred mare, reg, nice trot, green, broke, \$1,600, King, 195 Little Britain Church Rd, Peach Bottom, PA 17563, 717-548-4005

81 Chrysler LeBaron, \$500 MO, 85 Chrysler New Yorker, \$1,500 MO, Berks Co, 610-385-4376

13 Angus feeders, 8 heifers, 5 steers, Balto Co, 410-357-8658

675 gal ELS liquid manure spreader, \$500, 5 HP air compressor, good cond, \$700, Chester Co, 610-593-7052

Used set of cats for D3 dozer, \$200 OBO, Sch Co, 570-889-3831

Jamesway Nesseth pit pump, 2 pth, 8' w/fill pipe, good working cond \$1,200, 15' Hesston agitator \$700, Lanc Co, 717-484-2517

Superior I & J mower mtd on forecart Honda eng w/hyd, ideal for pasture clipping or alfalfa, \$2,000, Chester Co, Christian H King, 47 Friendship Church Rd, Cochranville, PA 19330

Snow plow for Wheelhorse garden tractor, 42" blade, \$300 OBO, Montg Co, 610-948-3725

Ford Jubilee 8 stone rake Steelkraft doors, 36x80 Hiltl DX451, steel pipe, 6", Gen Set 30 kva, 9-00-20 tires, stainless steel valves, North'd Co, 570-648-3872

Front mt snow blade w/all attachments for JD 420 standard, possible del to Beiler sale in Feb, \$475, Patrick, VA, 276-694-6137

2 Pied peacocks, 2 Blue India peacocks, 2 Blue India pea hens, \$45-\$75 each, York Co, 717-862-3729

Allis B tractor w/or w/out Woods 59 mower, champion blacksmith forge & blower, \$200, good cond, call after 4 p m, Berks Co, 717-933-4103

IH model H 42 snow blower, \$200, fuel miser heat reclaimr, \$20, Dovre coal stove, \$150, Lanc Co, 717-872-2287

Glencoe 7400 7 tooth soil saver chisel, exc, \$6,900 OBO, Lanc Co, 717-898-2088

Water conditioning unit, bacteria & nitrates, good cond, Lanc Co, 717-354-3143

2 saddlebred carriage horses, 8 & 13 yrs old, \$850, \$1,400, ready for miles, after 5 p m or Mons & Sats, J PB, 1753 Noble Rd, Kirkwood, PA 17536

Snow plower for Farmall Cub, \$275, dirt plow for Cub, \$100, model L59 mower for AC/B Woods, \$350, Chester Co, 610-369-7866

MAILBOX MARKET WANTED

Iron water troughs w/cast iron ends wanted, any cond, Bush's, Foltz, National, Erie, others, Robert Rauhauser, 4882 Emig School Rd, Thomasville, PA 17364-3324

In Business To Give You Power



John Deere Powertec Diesel Engines
 • Smooth • Quiet
 • Very fuel efficient
 • Built tough
 • AFFORDABLE

Ideal engines for dairy, home, shop, saw mills, gen sets. New engines in stock. Also a wide range of good running used and rebuilt engines.

Air Compressors

- Industrial Air
- Quincy
- Saylor-Beall

Complete air system installation available.

Hydraulic Systems and Skids made to order

Quaker Machine

401 Quaker Church Rd. Christiana, PA 17509
610-593-0389

Gas burner for butcher kettle, Yates, NY, 315-536-0512

Backhoe #23 for Case 430 CK w/mount, Warren Co, 908-607-5647 days

Backhoe adapter or rear wt holder for JD 350 crawler, need 4 in 1 bucket for same 350 crawler, Q A Co, 410-778-6976

Chipper/shredder attachment to fit Steiner garden tractor, Bradford Co, 570-265-6465

Chrysler 1958 V8 392ci eng, Ford 1949-1951 Club Coupe, stock, modified, Hartford friction shock absorbers, 1930s, Berks Co, 610-670-5054

Incubator, Adams Co, 717-259-0297

Ford tractor for parts or Ford parts, Dearborn implements, usable or parts, must be reasonable, West Co, 724-539-3808

JD chain saw, ask for Allen, Lanc Co, 717-354-9127

Need cash? Looking for 2 cyl JD tractor to restore, does not need to run, Cumb Co, 717-776-7942

Chain driven beater for 351 VI manure spreader, box is 51" wide, Berks Co, 610-362-7714

/Nine making equip, what do you have? Montg Co, 310-754-6569

Power steering cul for 317 JD garden tractor, Mifflin Co, 717-543-5539

JD 240 or 250 skid steer, must have hand controls & be in exc cond, Juniata Co, 717-463-2394

Truck bed for 86-93 Chev or GMC S10/15 p/u, 6', no rust, York Co, 717-382-1664

Hay soybean or rye hay or straw, trade for labor or cash, for sale, concrete linets, 78" or 10", Lanc Co, 310-593-1270

Crankshaft for Oliver 1655 Diesel, no on crank 221-211C, have a 221-211 for sale or trade, Sullivan Co, 570-924-3757

Attachments for a Montgomery Ward 2 wheeled walk after garden tractor, Dauphin Co, 717-896-3656

Mahoning Outdoor Furnaces

Cut Your Heating Costs With Our Outdoor Furnace

- Standard Model Burns Wood, Coal or Wood by-products
- Multi-Fuel Model Burns Wood, Coal, Oil or Gas

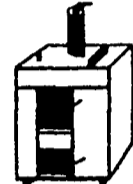

Adapts to any existing heat system Installation & Accessories Available

Gottysburg-New Oxford (717) 624-3639

Custom Built

SNOW PLOWS



For: Large Forklifts, Skid Loaders, Tractors, Etc. Manual or Hydraulic Angle Adjustment. Made To Order

Groffdale Machine Co.

194 S. Groffdale Rd., Leola, PA 17540
717-656-7657

PACIFIC WESTERN OUTDOOR WOOD FURNACE

Stainless Steel
 20 Year
 Limited Warranty



Dealerships Available
S&R Outdoor Furnaces/Distributor
 Box 233
 Shippensburg, PA
(717) 532-5820

GOLF CARTS



- Fully Reconditioned
- Gasoline & electric powered
- Up to 150 miles on a tank of gas
- Great for farmers, hunters, housewives
- 90 Days Same as Cash

Rock Springs Hardware

1320 Rock Springs Rd. (Rt. 222) • Rising Sun, MD
800-858-0288

DIESEL POWER SYSTEMS

415 Peters Dr. • Gordonville (Lancaster Co.), PA 17529

Cummins - Isuzu - VW

Industrial Power Units & Engines
 10-2,000 HP

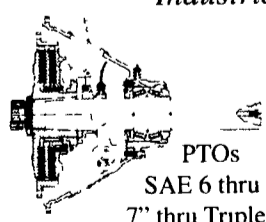

PTOs
 SAE 6 thru 0
 7" thru Triple 14

Cummins
 N14-525

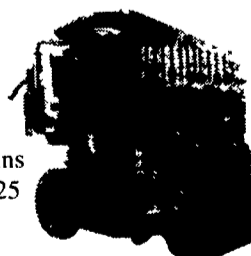

SPECIAL SALE PURCHASE

(Limited Quantity)

- 1006T Perkins Power Unit, 180 hp w/clutch **\$7,895**
- 8 Hp Lombardini Air Cooled **\$875**
- (8) KW @ 3600 (2) Bearing Generators **\$378/ea.**

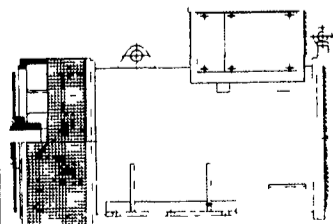

Single- & Two-Bearing Generators

New - Used - Rebuilt

Qualified Reseller Discounts!
 Call for Complete Product Line Listing
 717-354-4801 • Toll Free 877-354-4808
 Fax 717-354-4404

MAILBOX MARKET AD FORM

Only ads submitted on this official form will be published in our mailbox markets. No photo copies accepted!

Please NO PHONE CALLS • Please PRINT LEGIBLY

Attach Your Lancaster Farming Mailing Label Here

Check One:
 For Sale Notice Wanted
 If You Do Not Wish To Be On The Internet Please Check Here

1	2	3	4
5	6	7	8
9	10	11	12
13	14	15	16
17	18	County	Phone No.

No Phone Calls Please!

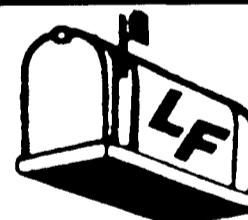

FREE TO SUBSCRIBERS ONLY

PLEASE READ ALL REQUIREMENTS BEFORE FILLING OUT FORM!

- Requirements:
- 1) Subscribers allowed "one" free Mailbox Market per month only. (Ad will appear 1 week only).
 - 2) Lancaster Farming Mailing Label must be attached.
 - 3) Limit: 20 words.
 - 4) Phone number must include area code.
 - 5) Your County must be included.
 - 6) Markets must be received in office by Monday or will be held until following week's issue.
 - 7) No Business Ads accepted.

** The Lancaster Farming staff has the right to reject any Mailbox Markets that do not meet these requirements **

Mail To:
 Lancaster Farming
 Mailbox Markets
 1 E. Main St.
 P.O. Box 609
 Ephrata, PA 17522