

**Mercer Livestock Auction**  
Mercer, Pa.  
November 27, 2001

Report Supplied By USDA  
CATTLE 184...(PDA)..Compared with last week's sale..steers mostly steady on small supply, cows steady to 2.00 higher.

STEERS: Choice 2-3 1075-1425 lbs 65.50-68.00, Select 1-3 60.00-65.00, few Standard 1-2 49.00-59.50.

HEIFERS: Choice and Select 1140-1265 lbs 62.00-65.00, few Standard 1-2 50.00-56.50.

COWS: Breakers 75-80% lean 37.75-42.50, Boners 80-85% lean 34.00-39.50, Lean 85-90% lean 30.00-35.00. Shells down to 20.00.

BULLS: few Yield Grade 1 1280-1990 lbs 49.00-52.75, Yield Grade 2 1050-2465 lbs 39.00-48.00.

FEEDER CATTLE: STEERS: Medium and Large 1 525-625 lbs 81.00-89.00, few Medium 2 475-625 lbs 68.00-77.00; HEIFERS: Medium 1 350-550 lbs 79.00-84.00, few Medium 2 375-500 lbs 65.00-79.00; BULLS: few Medium 1-2 375-630 lbs 70.00-92.00.

CALVES 108...VEALERS: Standard and Good 75-115 lbs 20.00-50.00, Utility 50-80 lbs 10.00-20.00.

FARM CALVES: No 1 Holstein bulls 85-115 lbs 100.00-120.00, one 127.50, No 2 80-115 lbs 40.00-100.00; few No 1 Holstein heifers 80-110 lbs 445.00-520.00, few No 2 75-110 lbs 150.00-340.00.

Few beef type bulls and heifers 90-100 lbs 140.00-150.00.

HOGS 27...BARROWS AND GILTS: few 49-54% lean 250-260 lbs 36.00-38.25, 45-50% lean 250-270 lbs 33.50-35.00, few 40-45% lean 270-300 lbs 31.00-33.00.

SOWS: few 1-3 430-610 lbs 25.00-28.00.

FEEDER PIGS 0...NO MARKET TEST!

SHEEP 0...NO MARKET TEST!

GOATS 6...(All sold by the head). One Large Billy 70.00, couple Large Nannies 60.00 & 65.00.

**National Carlot Meat Report**

Des Moines, IA  
November 27, 2001

Report Supplied By USDA  
USDA Market New USDA Carlot Meat 4:00 Summary: Compared to Previous Day Prices in dollars per hundredweight, Equated to FOB Omaha Basis.

NATIONAL BOXED BEEF: Boxed beef uneven on moderate demand. Offerings moderate to heavy on Select and light to moderate on Choice. Select chuck and round cuts steady to weak, while rib and loin cuts steady to firm. Choice chuck and round cuts steady to firm, while rib and loin cuts higher. Beef trimmings lower on light to moderate demand and moderate to heavy offerings.

Estimated composite cutout value of Choice 1-3 600-750 lbs carcasses up 1.53 at 114.26, 750-900 lbs up 1.88 at 112.93; Select 1-3 600-750 lbs dn .20 at 104.72, 750-900 lbs up .23 at 104.07; based on 127.46 loads of Choice cuts, 170.90 loads of Select cuts, 54.47 loads of trimmings, and 64.24 loads of coarse ground trimmings.

Estimated carcass price equivalent value of Choice 1-3 600-750 lbs up 1.29 at 104.44, 750-900 lbs up 1.55 at 103.48; Select 1-3 600-750 lbs up .43 at 95.14, 750-900 lbs up .72 at 94.70. Current index reflects the equivalent of 387,400 head c' cattle.

NATIONAL CARLOT BEEF: The Cutter cow carcass gross cutout value was estimated at 87.06, dn .30.

By-Product Drop Value: Hide and offal from a typical slaughter steer was estimated at 7.50, up .02.

NATIONAL CARLOT PORK: Sales reported on 85.0 loads of pork cuts and 32.0 loads of trim/process pork. Compared to Monday's close: Fresh loins and butts generally steady; sknd. hams 17-23 lbs. steady to 2.00 lower, 23-27 lbs. generally steady; sds. bellies 1.00-3.00 higher; lean trimmings steady to 2.00 lower. Trading mostly moderate, with

mostly moderate demand and offerings.

Calculations for a 185 lb Pork Carcass 51-52 percent lean 0.80" -0.99" back fat at last rib — 56.53 up .97. Loins bone in fresh 1/4 inch trim 21 lb/down light 95.00-99.00. Hams bone in trimmed, 17-20 lbs trim spec 1 79.00-89.00; 20-23 lbs trim spec 1 54.00-61.00. Seedless bellies 14-16 lbs 68.00-70.00; 16-18 lbs 65.00-67.75.

CARLOT LAMB CARCASS: 0 head reported.

**Oklahoma Feeder Cattle Weekly**

Oklahoma City, OK  
November 28, 2001

Report Supplied By USDA  
Oklahoma National Stockyards - Weekly Cattle Summary — Compared to last week: Feeder steers 2.00 higher, feeder heifers steady to 1.00 higher. Good demand for feeders. Steer and heifer calves 2.00-5.00 higher with very good demand. Quality of feeders plain to average; calf quality plain to average, few attractive. Receipts this week 9208; last week 4232; last year 7665. Supply consisted of 51% yearlings and calves over 600 lb; 42% calves; 7% cows and bulls. Heifers comprised 42% of feeder and calf supply.

Prices follow with weighted average weight and price in parenthesis.

FEEDER STEERS: Medium and Large 1: 250-300 lbs (289 lbs) 122.00-124.00 (123.35); 300-400 lbs (350 lbs) 119.50-128.00 (122.80); 400-500 lbs (450 lbs) 104.50-116.50, thin 109.00-121.00 (112.02); 500-600 lbs (550 lbs) 94.50-109.50, fleshy 89.00-94.50 (99.92); 600-700 lbs (650 lbs) 87.25-97.50 (89.90); 700-800 lbs (750 lbs) 87.00- 90.50 (89.02), fleshy 83.75-88.00; 800-850 lbs (836 lbs) 84.50-88.75 (87.18), fleshy 81.00-84.75; few 850-900 lbs (879 lbs) 80.00-81.00 (80.38). Holsteins: Large 3 385 lbs 77.25; 485 lbs 75.00; 800-850 lbs 57.00- 63.00.

FEEDER HEIFERS: Medium and

Large 1: 300-400 lbs (350 lbs) 101.00-113.00 (108.39); 400-500 lbs (450 lbs) 93.00-106.00 (99.37); 500-550 lbs (523 lbs) 87.50-94.00 (91.96); 550-600 lbs (582 lbs) 83.00- 88.50 (84.84); 600-700 lbs (650 lbs) 78.75-84.75 (82.16); 700-775 lbs (750 lbs) 80.50-82.50, fleshy 76.75-80.50 (80.50).

**Middleburg Livestock Auction**

Middleburg, Pa.  
Tuesday, November 27, 2001

Report Supplied By USDA  
CATTLE 337...(SUPPLIED BY THE AUCTION)..steers and heifers 1.00 higher, cows steady, bulls 3.00 higher.

STEERS: High Choice and Prime 2-4 1150-1500 lbs 66.00-69.00, Choice 2-3 1150-1550 lbs 62.50-66.00, Select 1-3 56.00-62.00, Standard 1-2 46.00-56.00.

HOLSTEIN STEERS: High Choice and Prime 2-3 1200-1500 lbs 58.50-56.50, Choice 2-3 1100-1600 lbs 50.00-53.50, Select 1-2 49.00-49.50.

HEIFERS: High Choice and Prime 2-4 1075-1400 lbs 64.00-68.00, Choice 2-4 1050-1400 lbs 57.50-64.00, Select 1-3 53.00-57.50, Standard 1-2 45.00-53.00.

COWS: Breakers 75-80% lean 37.50-48.50, Boners 80-85% lean 32.50-37.50, Lean 85-90% 27.00-32.50. Shells 10.00-25.00.

BULLS: Yield Grade 1 1700-2500 lbs 53.00-57.00, Yield Grade 2 1400-2600 lbs 48.00-53.00.

CALVES 273...FARM CALVES: No 1 Holstein bulls 90-110 lbs 110.00-122.00, No 2 90-125 lbs 85.00-110.00; No 1 Holstein heifers 90-110 lbs 350.00-585.00, No 2 75-110 lbs 150.00-350.00.

HOGS 120...BARROWS AND GILTS: 49-54% lean 225-270 lbs 30.00-31.00, 40-45% lean 220-275 lbs 28.00-30.00.

FEEDER PIGS 0...NO MARKET TEST!

SHEEP 0...NO MARKET TEST!  
GOATS 0...NO MARKET TEST!

**West Virginia Special Feeder Cattle Sales**

Charleston, W. Va.  
November 28, 2001

Report Supplied By USDA  
BUCKHANNON BARN SALE, Nov. 27:

STEERS: 195 head. Med. and Lge. 1: 300-400 lb 82-92.50; 400-500 lb 80-95.50; 500-600 lb 80-93.00; 600-700 lb 73-79.00; 700-800 lb 60-77.00; 800-900 lb 78-85.50; 900-1000 lb 57-68.00. Med. and Lge. 2: 200-300 lb 78.00; 300-400 lb 85.00; 400-500 lb 80.00; 400-500 lb 73-79.00; 500-600 lb 66.50-78.00; 600-700 lb 59-63.00. Small 1 & 2: 400-500 lb 73.00; 500-600 lb 69-75.00; 600-700 lb 62-66.00; 700-800 lb 65.00.

HEIFERS: 364 head. Med. and Lge. 1: 300-400 lb 71-79.00; 400-500 lb 70-77.50; 500-600 lb 60-71.50; 600-700 lb 65-68.00; 700-800 lb 64-69.00. Med. and Lge. 2: 200-300 lb 78.00; 300-400 lb 85.00; 400-500 lb 73-79.00; 600-700 lb 66.50-78.00; 700-800 lb 59-63.00. Small 1 & 2: 400-500 lb 73.00; 500-600 lb 69-75.00; 600-700 lb 61-66.00; 800-900 lb 65.00.

BUCKHANNON BOARD SALE, Nov. 27:

STEERS: 1215 head. 30 head, BBWF, M&L 1&2, 540 lb 91.75; 73 head, BBWF, M&L 1&2, 685 lb 88.25; 74 head, BBWF, M&L 1&2, 660 lb 89.00; 148 head, BBWF, M&L 1, 685 lb 89.75; 85 head, BBWF-CH-RX, M&L 1, 610 lb 90.25; 81 head, BBWF-CH-RX, M&L 1&2, 625 lb 90.75; 78 head, BBWF-CH-RX-H, M&L 1&2, 675 lb, 87.75; 78 head, BBWF-CH-RX-H, M&L 1&2, 685 lb 85.50; 41 head, BBWF-CH-RX, M&L 1&2, 685 lb, 84.75; 68 head, BBWF-CH-RX, M&L 1&2 740 lb, 84.00; 68 head, BBWF-CH-RX, M&L 1&2, 740 lb 84.00; 66 head, BBWF-CH-RX, M&L 1&2 & S1, 750 lb 83.25; 76 head, BBWF-CH-RX, M&L 1&2, 775 lb 83.00; 64 head, BBWF-Gray-Yellow, M&L 1&2, 775 lb

**Weaver Insurance Agency**

'We're Here To Serve'

**FARMS —**

We can insure all farms from mushrooms to fish, and from dairy to nursery stock. No farm is too complex or too small for us to help you with.

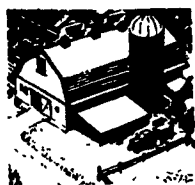

Please Call For Quotations or Information.  
We Offer All Types of Farm and Agribusiness Insurance

Roger Slusher • Bob Lee • Carol Young  
• Cindy Beyer • Julie Lee • Terry Wingert

248B Maple Ave., Quarryville, PA 17566

(717) 786-1711 (800) 882-1415



**Pasture Mat**

The Golden Standard In Cow Comfort

**Pasture Mat Plus**

The Perfect Addition To Your Pasture Mats

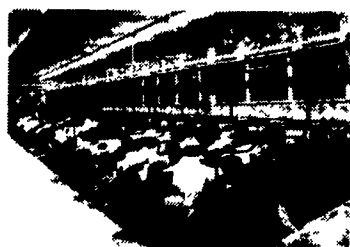

**Why Pasture Mat?**

Pasture Mat is tightly stuffed with rubber and sewn every 4" to prevent shifting  
Proven most durable top cover  
Least abrasive top cover on the market  
Fits any stall  
Proven performance

- Its soft durable design provides added cushion to both old & new mattresses
- It helps to remove the ripple effect of the mattress, and increases the ease of cleaning

For details and installation with over 9 years experience, call:

**Petersheim's Cow Mattresses**

117 Christiana Pike (Route 372), Christiana, PA 17509

U.S. Pat. No 5653195

**610-593-2242**

Ask For Merrill or Sam



WB95PZ Zimmerman Water Bowl

**The Unlimited Water Supply For Your Cows!**

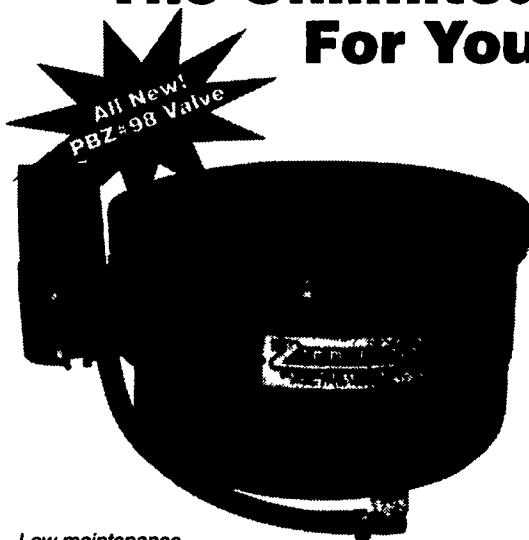

Low maintenance noncorrosive Delrin valve is self cleaning & simple to operate!

Now you can give your cows the water they need to produce more milk. With the Zimmerman Water Bowl, you can do it at no extra cost!

The bowls are designed to comply with known federal and local requirements when installed properly.\*

Cows are not designed to push a paddle when they need a drink. This unique watering system provides a continuous supply of fresh water in the way nature intended cows to drink. With a large capacity, fast recovery and a guarantee against breakage, the Zimmerman Water Bowl will revolutionize the way you water your herd.

\*All bottom fill bowls require that approved back flow prevention devices be installed in potable water supply lines.

Install in new or remodeled facilities or in most existing barns on manger or stall side!

- 12" in diameter & 8" deep.
- 3 gallon capacity- 6 times that of other bowls!
- Fast recovery- 3 gallons per minute at 40 psi.
- PVC construction- guaranteed unbreakable, inhibits bacterial growth.
- With nonrestrictive splash guard.
- Cleaner- water fill located at bottom.
- Bottom drain- for easy cleaning.
- Adjustable water level.

**MORE WATER MEANS MORE MILK...NATURALLY!**



Heavy duty steel clamp & mounting bracket totally supports bowl.

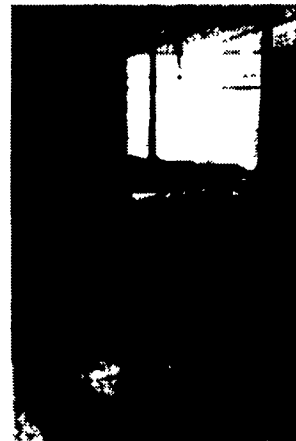

**Added Value With Our 2 Coat Process!**

- 1 Five step metal preparation, including iron phosphate conversion coating, to enhance adhesion & prevent undercoat corrosion
- 2 Zinc rich epoxy powder undercoat
- 3 TGIC polyester powder top coat, baked at 400° to fuse costs, forming a cross link molecular bond

**Paul B. Zimmerman, Inc.**

295 Woodcorner Rd. • Lititz, PA 17543 • 717/738-7365

1 mile West of Ephrata

Call or write for additional information & the name of your nearest dealer.

Hours. Mon -Fri 7-5 Sat, 7-11