

# Incredible Prices !!!

UP TO  
**60% OFF**  
**SUPER HEAVY STEEL**

- Equipment Storage!
- Workshops!

**FAST AND SIMPLE TO ERECT!!** 30 x 50 (2 LEFT) 40 x 64 (3 LEFT)  
**NO CRANE NEEDED!!** 45 x 80 (2 LEFT) 52 x 100 (1 LEFT)  
55 x 120 (2 LEFT)



AVAILABLE MODELS

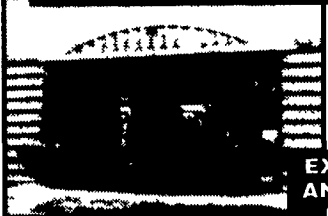

EXCELLENT FOR HAY AND GRAIN STORAGE



800/825-5059

Lancaster Farming, Saturday, September 23, 2000-D13

Wanted for salvage old factories & warehouses. Buying yellow pine salvage timbers 717-382-9935.

### Top Dollar Paid

for  
Wide Attic Flooring, Barr Grainery Boards, Wide Roof Boards, Big Beams of Chestnut, Heart Pine, White Oak, White Pine, Interior Salvage of Early Stone of Brick House, Indian Doors, Hand-Hewn House Joists and Rafters, Summer Kitchens, Old Factories, Old Warehouses and Log Houses!!!!

**(610) 857-1002**  
Anytime  
Pay the most &  
Travel the Farthest

Antique building materials, beams, wide pine boards, flooring, doors etc. 717-249-2304.

White Pine lumber, kiln dried, 1 inch thick, log run random width & length boards up to 20 inches wide & 16 ft long, 60¢ per bf, 500 ft minimum. Edrich Lumber 410-922-5959

WANT: Old barns and mushroom houses to dismantle for building material. 610-367-8193.

Chain Link Fence, new slightly imperfect, heavy 9-gauge galvanized. 3' 90¢/ft; 3 1/2' \$1/ft; 4' \$1.20/ft; 5' \$1.50/ft; 6' \$1.65/ft; 7' \$1.90/ft; 8' \$2.10/ft. Vinyl coated also available. 7-8am or aft 5pm, 570-822-7820.

## Rocky Ridge Construction

**Pole Barns, Horse Barns, Dairy. Masonry and Concrete. Agriculture and Residential.**

**Benuel K. Lapp**  
Coatesville, PA  
**(610) 383-5047**

## FALL FIX-UP TIME

- 5", 6" & 7" Seamless Gutters in 32 Colors • Half Round Gutters
- Gutter Protech™
- Windows & Doors
- Tubular Skylights



265 E Meadow Valley Rd  
Lititz PA 17543  
717-733-7160 • 717-627-6886  
1-800-247-2107

VISA M/C DISCOVER Financing Available



COMFORTABLE



APPEALING

## SOFSCAPE™ PAVERS

Softening the Globe "One Scrap Tire at a Time"  
Great For...

- Driveway • Work Shops • Barns • Pool Decks • Walkways • Garages • Porches • Patios • Playgrounds

For More information contact:

Reifen Rubber Co.  
199 W. Steigel St.  
Manheim, PA 17545  
Ph: 717-665-1428  
Fax: 717-665-1430



DURABLE • SAFE

Dealers/Distributors Wanted—PRIME AREAS STILL AVAILABLE

# Foremost Industries

Experiencing a Better Way to Build

- Panelized Homes • Panelized Homes
- Complete Sales (Roof & Floor Truss(s))

FOREMOST BUILDING INNOVATORS

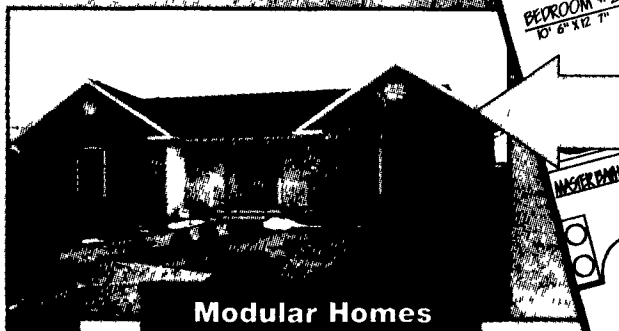

Modular Homes Starting at \$47,500

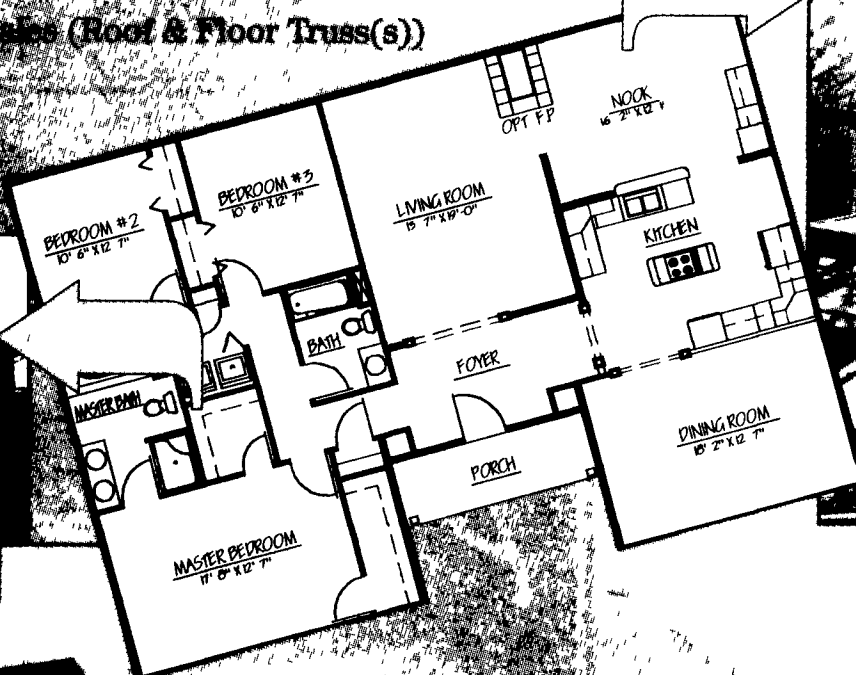

Panelized Shell Framing Packages Starting at \$15,400

Building has never been so easy & affordable for the Builder, Developer or Do-It-Yourselfer. Shell Framing Packages, Roof Truss(s), Engineered Wall Panels, Anderson Windows, Peachtree Doors, and Appalachian Mill Kitchen/Bath Cabinetry...

Buy Your Building Components from a Manufacturer and Save

You Do Have A Choice

Call **1-877-BUILD-FI**

We've built over 5000 Modular Homes, so you owe it to yourself to check us out. Visit our Model Home Village to see 7 beautifully decorated Model Homes, and pick up our "Collection of Home Plans."

Modular Plans Built, Erected, & Finished the Foremost Way.

Foremost Industries, Inc.  
2375 Buchanan Trail West  
Greencastle, PA  
717-597-7166

Exit 3 off I-81. Take Rt 16W for 2 miles. Foremost will be on your right.

