

# Top Crawford DHIA Cows By Protein For May

The cows that finished protein records of 800 or more pounds in May in Crawford DHIA are listed as follows:

| OWNER - COW'S NAME      | MILK   | FAT  | PRO-TEIN |
|-------------------------|--------|------|----------|
| <b>CRAWFORD COUNTY</b>  |        |      |          |
| <b>ALRIGHT FARMS</b>    |        |      |          |
| LIZA                    | 41,678 | 1824 | 1248     |
| RACHEL                  | 37,791 | 1277 | 1165     |
| STELLA                  | 39,178 | 1502 | 1150     |
| SASHA                   | 33,388 | 1179 | 1090     |
| BONNIE                  | 35,550 | 1105 | 1047     |
| SHERI                   | 28,371 | 1109 | 1004     |
| MARCIE                  | 24,456 | 1050 | 812      |
| JESS                    | 24,941 | 1012 | 805      |
| <b>RYND HOME FARMS</b>  |        |      |          |
| PAM                     | 32,780 | 1094 | 1047     |
| BRETTA                  | 32,567 | 1343 | 1037     |
| CLOVER                  | 24,907 | 1055 | 870      |
| CASPER                  | 25,105 | 933  | 853      |
| <b>LARRY F CHARLES</b>  |        |      |          |
| TANG                    | 31,262 | 1053 | 995      |
| COLLEE                  | 29,533 | 1010 | 954      |
| DANA                    | 27,833 | 959  | 915      |
| ABBY                    | 22,864 | 1082 | 866      |
| JO                      | 25,407 | 988  | 848      |
| BONNIE                  | 27,351 | 799  | 828      |
| 251                     | 23,355 | 756  | 815      |
| 249                     | 24,232 | 983  | 802      |
| 165                     | 21,657 | 854  | 801      |
| <b>BLACK POND FARMS</b> |        |      |          |
| RENEE                   | 33,460 | 988  | 988      |
| HILDA                   | 28,521 | 1254 | 927      |
| CELENA                  | 28,139 | 1051 | 893      |

|                             |        |      |     |
|-----------------------------|--------|------|-----|
| CATHIE                      | 26,889 | 961  | 817 |
| MAE                         | 23,970 | 839  | 806 |
| <b>CUSTEAD-VALLEY FARMS</b> |        |      |     |
| BELL                        | 30,962 | 1003 | 981 |
| EVA                         | 29,637 | 927  | 923 |
| <b>MORRELL FARMS</b>        |        |      |     |
| SANDY                       | 32,052 | 1122 | 971 |
| DORA                        | 27,111 | 1058 | 862 |
| TERRIE                      | 25,492 | 910  | 851 |
| LANA                        | 30,234 | 1106 | 847 |
| GEM                         | 25,688 | 1078 | 805 |
| <b>JAMES + JANET HUNTER</b> |        |      |     |
| SHARLA                      | 30,101 | 945  | 971 |
| JULIE                       | 31,264 | 1093 | 926 |
| FLANNY                      | 29,763 | 1084 | 918 |
| ARIEL                       | 27,805 | 964  | 836 |
| BRIGET                      | 24,479 | 974  | 827 |
| ARDEL                       | 25,908 | 826  | 800 |
| <b>WIL-AIRE FARM</b>        |        |      |     |
| SEBAST                      | 28,556 | 794  | 944 |
| MAUDE                       | 29,040 | 602  | 889 |
| SEAN                        | 24,733 | 695  | 812 |
| <b>GREENE ACRES</b>         |        |      |     |
| TANYA                       | 25,651 | 1157 | 939 |
| OLLIE                       | 24,617 | 1072 | 828 |
| SHERRY                      | 23,320 | 1090 | 819 |
| FRANNI                      | 25,351 | 918  | 810 |
| SHADOW                      | 25,146 | 928  | 806 |
| CRISTY                      | 26,261 | 887  | 802 |
| <b>RONALD KALINOWSKI</b>    |        |      |     |
| GUS                         | 28,088 | 1141 | 933 |
| WILLY                       | 32,050 | 1143 | 864 |
| <b>INFIELD BROTHERS</b>     |        |      |     |
| VICKI                       | 25,772 | 1025 | 914 |
| <b>CURT+BARB GREENAWALT</b> |        |      |     |
| SALT1                       | 25,409 | 1016 | 881 |
| LISA2                       | 29,184 | 999  | 811 |

|                                    |        |      |     |
|------------------------------------|--------|------|-----|
| <b>SPRUCE ROW FARMS</b>            |        |      |     |
| NEKA                               | 22,169 | 965  | 859 |
| <b>CLARK S DUNCAN</b>              |        |      |     |
| SQUIRT                             | 27,012 | 833  | 849 |
| <b>SAM HEAGY</b>                   |        |      |     |
| 51                                 | 29,088 | 1111 | 826 |
| <b>GALEN GARBER</b>                |        |      |     |
| ANGIE                              | 23,113 | 924  | 818 |
| <b>E. DEAN AND DAN HOUSEHOLDER</b> |        |      |     |
| 162                                | 24,071 | 867  | 812 |
| <b>STANHOPE FARMS</b>              |        |      |     |
| 447                                | 26,231 | 971  | 800 |
| <b>ERIE COUNTY</b>                 |        |      |     |
| <b>THOMAS + TERRI RAND</b>         |        |      |     |
| NITEMA                             | 30,020 | 1028 | 931 |
| <b>MERCER COUNTY</b>               |        |      |     |
| <b>SUNRISE DAIRY</b>               |        |      |     |
| 645                                | 31,608 | 1000 | 959 |
| B19                                | 28,106 | 1002 | 931 |
| B31                                | 25,467 | 929  | 861 |
| 803                                | 29,303 | 803  | 840 |
| 801                                | 25,563 | 822  | 833 |
| 809                                | 28,724 | 841  | 830 |
| B70                                | 24,422 | 666  | 815 |
| <b>VENAGO COUNTY</b>               |        |      |     |
| <b>WILLIAM E GEER</b>              |        |      |     |
| 34                                 | 30,910 | 971  | 973 |
| 44                                 | 25,336 | 288  | 945 |
| 116                                | 21,633 | 1103 | 905 |
| 39                                 | 23,472 | 954  | 835 |
| <b>ROLLING SPRING FARM</b>         |        |      |     |
| ANDREA                             | 28,135 | 887  | 823 |
| STAR                               | 24,520 | 958  | 811 |
| SPOT                               | 26,584 | 995  | 802 |

## Tour Aims To Improve Profitability, Ohio Farm Sustainability

(Continued from Page B19)

dairy herd with a rotational grazing system.

• Sept. 28 — Fox Trail Run Farm, Belmont, 1 p.m.-4 p.m. Highlight: 630-acre Brown Swiss cattle operation with managed grazing system.

• Sept. 30 — Country Living Field Day, Augusta, 10 a.m.-5 p.m. Highlights: workshops, displays, exhibits, and tours about dozens of alternative agricultural and natural resource enterprises. It's the largest field day of its type in the U.S.

• Oct. 3 — Saum Family Farms, Lancaster, 1 p.m.-4 p.m. Highlights: 600-acre hog, beef, horse, goat, corn, soybean, wheat, pumpkin and gourd operation complimented by Christmas trees and nursery trees and handmade wreaths and holiday items.

For more information about the 2000 Ohio Farm Profitability Tour Series, contact your local Ohio State University Extension office, Innovative Farmers of Ohio at (740) 363-2548, or the Ohio Ecological Food and Farm Association at (614) 421-2002.

## THERE'S SOMETHING ABOUT ICE CREAM

### MAILBOX MARKET FOR SALE

85 Chevy C-20 conversion van, 305 111K, no rust, very clean inside & out, cold AC, runs great! \$2,900, Franklin Co., 717-328-5038

Griswald 273 stick pan #10, pop over pan #8, oven w/trivet & others, \$250 all, pea & bean sets, \$200, Chester Co., 610-896-9519

IH 484 diesel 3750 hrs, 14 9-28, 90%, 3 pt hitch, wide front, roll guard, new paint, no Sunday calls, Leb Co., 717-933-5533

JD 336 kicker baler, nice, \$3,000, JD 8200 grain drill, DD openers, grass seed, press wheels, nice, \$2,400, Sch Co., 717-354-3208

1990 Chev Cavalier, AC, ps, pb, 4 cyl, 5 spd, exc gas mileage, \$1,400, digital retail, 30 lb scales, good cond, Lanc Co., 717-656-7353

18' wooden rack hay wagon, 8 ton running gear, very nice, 5100 grain drill, like new, Juniata Co., 717-589-3407

White pine logs, large, BO, York Co., 717-993-3900

74 IH 1600, 345 ci 5 & 2, good, 12' flat bed dump, runs o.k., lost title, 9 00x20, good, \$1,500 or trade for C-SC IH tractor, Fred Co., 301-874-2672

73-87 Chevy 6' pu bed good cond, \$200, 4 WD parts for 80s Chevy's, call Jamie for prices, Phila., PA, 215-487-1232

Beautiful female llama, \$675, 703-443-0880

2" diaphragm pump, 5HP motor like new, less than 10 hrs, \$790, Robin eng, Lanc Co., 717-786-1232

Sickle mower, 6' dearborn, 3 ph, fits Ford 8N & early Ferguson, good cond, \$150, requires 1 1/2" PTO shaft, York Co., 717-938-6480

17 units Holstein semen, some current, some older, Leadman, Jeff, Magic, Pheo, Cleitus, etc., \$200 value, all \$150, Dauphin Co., 717-692-4648

2 gravity wagons, \$900/\$500, both \$1,250, 30' elevator rebuilt, new motor, \$1,000, NI picker, 1 row, \$900, call eves, Cumb Co., 717-241-5455

Goats Nubian, Nubian/Sannan cross kids & milking does, \$45 & up, mixed Bantam roosters, \$1, kittens, Adams Co., 717-337-0348

Dodge truck 1972 stake body, 318 eng, avt torque flite trans, 38,000 orig mi., \$1,000 OBO, York Co., 717-993-9090

AC gleaner, F2 combine w/grain head & corn head, good cond, NH 60' over head, bale conveyor, Queen Annes Co., 410-778-3386

Electrol variable speed control, used for speed control on egg belts, \$100, Leb Co., 717-865-4159

Chev 1 ton crewcab, dual wheel pick-up, 1984, high mileage, new trans, good motor, \$2,000 firm, Perry Co., 717-438-3556

Miniature horses, yearling filly, golden color, 28" amhr also dwarf 17" filly, no papers, 3 months old, Sussex Co., 973-398-7954

JD 336 baler w/kicker, NH 56 rake, NH elevator w/elec & hyd motor, 3 hay wagons, York Co., 717-993-6220



### Loop Stalls Designed for Durability

Finished with a zinc rich under coat & polyester top coat.

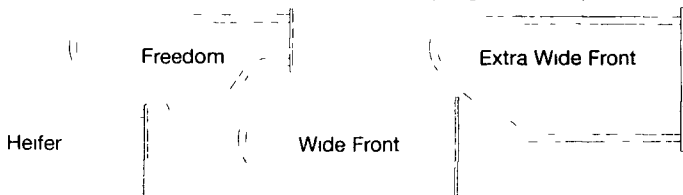

Available in 4', 5', 6', 6'6", & 6'9"

Finish protects against rust, chipping, and chemical deterioration.

### Wide Front Loop Stalls

Versatile design offers greater cow comfort. Generous lunge space for head & neck between top and bottom of loop.

### Loop Stall Construction Features:

Heavy Duty construction with 2 3/8" outside diameter high yield steel tubing with 12 gauge (108) wall. Spray arc transfer method used on welds.



**Paul B. Zimmerman, Inc.**  
295 Woodcorner Road • Lititz, PA 17543  
717/738-7365  
1 mile west of Ephrata

Call or write for additional information and the name of your nearest dealer

Hours Mon - Fri 7-5

### Aqua-Therm

### Outside Wood Burning Furnace

- Clean
- Safe
- Easy
- Efficient

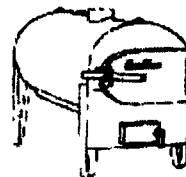

Buy the top of the line!

- \*Stainless Steel Fire Box
- \*Ash Removal Auger
- \*15 Year Warranty
- \*Thermostatically Controlled

Heat your house, shop and/or hot water with one unit

For more information,

call 717-838-9270 or 1-888-382-8170

Email: mkpowell@paonline.com



### KEYSTONE GUN-KRETE

### CONCRETE PUMPING SERVICE

- Sidewinder-45 Concrete Pump • Up To 40 Cubic Yards Per Hour
- Pump Up to 150 Ft. Vertical And 800 Ft. Horizontal

### CONCRETE-SPRAYING SERVICE

A Proven Way of Applying Concrete

- Repair Retaining Walls
- Strengthen Existing Masonry Walls
- Reseal Manure Pits
- Manure Pit Construction
- Trench Silo Construction
- Silo Repair

### KEYSTONE GUN-KRETE

61 Poplar Street • Gordonville, PA 17529  
(717) 768-3641

**55' PIRATE KING II**  
Day or Night Charters  
**BLUEFISH/FLUKE**  
609-494-7990  
CAPT. Charles Eble III  
18th St. Barnegat Light

### PUT MORE NUTRIENTS INTO YOUR COWS

Designed for John Deere 5000 Series Self Propelled harvesters. Process silage or high moisture corn.



3 Belt Pulleys

Replacement Auger Chute and/or Auger For John Deere 5000 Series Self Propelled Harvesters. All Parts Available For 5000 Series Self-Propelled With Kernal Processor.

**Lancaster Silage Crimper**  
2008 Horseshoe Rd. Lancaster, PA 17601  
717-299-3721