

AG INDUSTRIAL INC.

A WENGER COMPANY

Located on Rt. 1 at the MD/PA Line
50 North Greenmont Road, Rising Sun, MD 21911

410-658-5568 800-442-5043

e-mail: agind@eclipse1.com



Brillion 9-Tooth Chisel Plow
3 Pt. Hitch, Gauge Wheels,
Nice Condition



BerVac 615 24 Ft. Field Cultivator
w/Land Leveler & Rolling Baskets,
Does An Excellent Job
Price Reduced!

TRACTORS & LOADERS

Ford 7600 2WD
Ford 4500 Tractor w/Loader and 44" Tree Spade
Ford 6610 w/Boom Mower
Ford 6640 S Tractor, 76 hp
Ford 7710 II, 2WD
Ford TN75S, 4WD w/Super Steer
Int Cub w/60" Deck
Case 580B Tractor w/Loader & Backhoe
JD 301 w/Loader
White 2-85, 2WD, w/Westendorf Loader
AC 6060

HAY & FORAGE

NH 56B Rake
NH 254 Rake Tedder
NH 256 Rake
NH 258 Rake
NH 320 Baler with 1/4 Turn Chute
NH 430 Baler with 1/4 Turn Chute
NH 575 Baler w/Bale Case Ext & 1/4 Turn Chute
NH 855 Round Baler
(2) NH 2000 Big Square Baler
NH 890 Harvester
NH 890A, N3, WPU, Harvester Heads
NH 782 Harvester w/770 Pickup
NH 892 Harvester
Field Queen 1412 S P Harvester 3 RN
Corn Head, 7 Ft Pickup
NH 2 RN Snapper Head
NH 411 Discbine, 540 PTO
NH 499 Pivot Tongue Haybine

NH 469 Haybine
(3) NH 489 Haybine
(2) NH 492 Haybine
NH 1495 S P Haybine, Gas, Hydro
NH 2450 SP Haybine 12 ft Head
JD 1217 7 Ft MoCo
JD 346 Baler w/Thrower
JD 348 Baler w/1/4 Turn Chute
Hesston 1150 12' Haybine
Hesston 8200 Self Propelled Haybine
12 Ft Head
Badger, BN950 Forage Box

SKID STEER LOADERS

NH L455 Skid Steer
NH L553 Skid Steer
NH LX665 Skid Steer Loader
(3) NH L785 Skid Steer
Hydramac 8C Skid Steer
Lowe 750E Auger Drive w/Old Style
NH Mounting

MISCELLANEOUS

NH 791 Manure Spreader
Kill Bros. 350 Gravity Flow Box w/Gear
Ber-Vac 24' Field Cultivator
NI 1 Row Corn Picker
Bush Hog 3126 10ft. Rotary Mower
Brillion 12' Packer
Deutz 2500 15' Disc
JD 4 Bottom Plow
Roadside 7' Flail Mower
Brillion 5'4" Landscape Seeder
Centerville 6-Ton Trailer



1989 Hesston 8200
Self-Propelled Haybine,
12' Cut, Cab, 1,720 Hrs.,
Field Ready



1993 New Holland 2450
Self-Propelled Haybine,
12' Cut, Cab, 842 Hrs.,
Excellent Condition

READING KUBOTA

A WENGER COMPANY

RD 2 Box 2008 Reading, PA 19605
Along Rt. 61 3 Miles North of Reading

Phone 610-926-2441 • Fax 610-926-0970

E-Mail us - kubotas@zdiel.com



Hours
Mon - Fri 8-5
Sat 8-12
Sun Closed

Kubota Tractors & Equipment

• USED COMPACT TRACTORS • USED SKID LOADERS
• REAR BLADES • BACKHOES • LOADERS

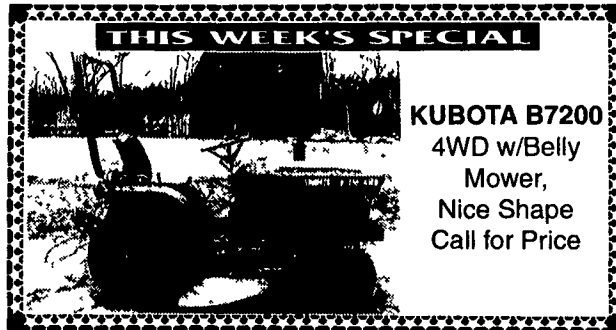

KUBOTA B7200
4WD w/Belly
Mower,
Nice Shape
Call for Price

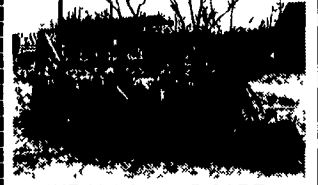

KUBOTA L35 w/LOADER
& Backhoe, 4WD, 760 Hrs.,
Nice Condition



JD 1050
36 HP, 4WD w/Loader,
Turf Tires

USED 25 HP & UP TRACTORS

Kubota L35 TLB
Kubota L4150, 50 HP, 4WD
w/Loader
Kubota L305 DT 4 WD
w/Loader, 30 HP, Showroom
Condition



KUBOTA L2500DT
27 HP 4WD Tractor w/Loader
Only 70 Hrs.

USED 15 TO 24 HP TRACTORS

(3) Kubota B7100's, 4wd -
Priced To Sell
Ford 1100 13HP Diesel, Nice
Satoh Beaver w/Belly Mower,
Diesel - Make Offer



KUBOTA B4200 w/LOADER
& Belly Mower, 4WD, Diesel,
900 Hrs., Excellent Cond.

MISC. EQUIP.

Used Case IH 3 pt Snow
Blower - \$995
New Bush Hog 72" MTH720
Finish Mower Blow Out Price
Used Landpride Overseeders
-SALE OR RENT
Kubota BF800 Loader to Fit
L3350-MAKE OFFER
4, 5, 6 Ft. Landscape Rakes In
Stock
3 Pt. Dump Carts In Stock
3 Pt. Spreaders (In Stock)
New Harley Rakes In Stock
Used Kubota Belly Mowers in
stock
F35 Woods Belly Mower nice -
make offer
New Snowblowers In Stock
Used Landpride AT 2590 3 Pt.
Finish Mower
New Power Steering Unit for
Kubota B9200

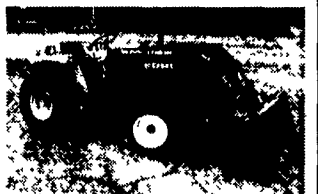

FORD 1710,
4WD w/Loader,
Nice Condition

USED LAWN & GARDEN TRACTORS

Kubota T1600, 2WD Diesel,
44" Belly Mower, Hydro
JD 425 w/Grass Catcher,
48" Deck, All Wheel
Steering, only 140 Hrs.
Cub Cadet 1863 48" Mower
Kubota G1900 w/60" Mower,
Kubota FZ2400, 60" Deck,
Low Hrs.
Gravelly Gem 16, 50" Mower

PARTS SALES - RENTAL SERVICE

Experience the Bobcat Advantage

**Total Value
That Can't Be Matched**

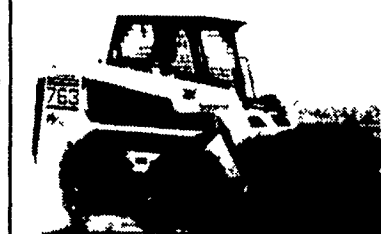

*The Bobcat
Advantage*



Mon.-Fri.

7:30 AM to 5:00 PM

Sat. 7:30 to Noon



WENGER OF MYERSTOWN

Tractor Parts

tractpts@wengers.com • http://www.wengers.com

814 S. COLLEGE ST.
(ROUTE 501)
MYERSTOWN, PA 17067
800-451-5240
(717) 866-2135
Fax 717-866-7866

FARM TRACTOR PARTS

USED - RECONDITIONED - NEW

Largest Computerized Inventory In The East

RECENTLY ARRIVED FOR SALVAGE

Farmall Cub	IH 1586	JD 50
IH 666	IH 3588	JD 7610



PARTS SALES POSITION AVAILABLE

Call 717-866-2130. Ask for Rose in Human Resources

NEW PARTS SPECIAL

10% Discount On New
Replacement Front Axle Parts

- Bearing Kits • Hubs
- Tie Rods • Axle Extensions

Through March 11, 2000

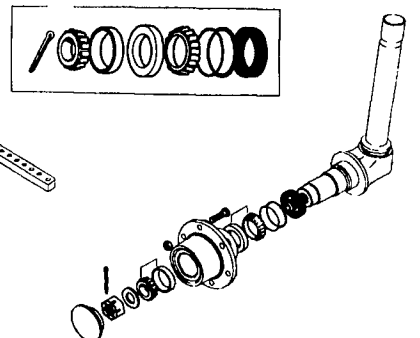

2nd ANNUAL TRACTOR SHOW

May 19 & 20, 2000

For More Information or to Register - Call & Ask For Daryl