

Public Auction of Real Estate

Thurs., Oct. 29, 1998

at 11:00 AM Sharp

Martin Wolf Farm, Located in Carlisle, PA, Cumberland County

From Interstate 81 (either direction) take exit 14 onto Rt 34 south, toward Mt. Holly Springs, Approx. 2 miles to Marsh Drive (just before ideal Pontiac dealership), turn right, first farm on left back long lane next to the catholic church.

Farm is being sold due to the death of Mr. Wolf. Approximately 119 acres, approximately 100 tillable, large brick house with lots of rooms, structure in very good condition, attached butcher house, very nice brick house.

Large bank barn used for raising heifers and steers, in good condition, other out buildings and wagon shed, land is being farmed now and is in good state of cultivation.

Farm is zoned agricultural. No development rights or building rights have been sold off this property.

Sale for: Estate of Martin Wolf

Wayne Pepper, Admin.

2423 Walnut Bottom Road,

Carlisle, PA 17013

717-243-4923

Attorney: Frances H. Del Duca

10 W. High St., Carlisle, PA 17013

717-249-1323

Rick Foreman, Auctioneer AU1163L

Terms of sale: 10% down sale day, balance in 45 days, no exceptions. Offered with reserve.

Announcements sale day take precedence over all printed material. For more information call Wayne Pepper 717-243-4923 or Frances Del Duca, Attorney 717-249-1323. For appointment to see farm, call 717-243-4923.

FALL FARM MACHINERY AUCTION

At the Rt. 15 AUCTION CENTER. 9801 Hansonville Rd., Frederick, MD. From Frederick take Rt. 15 north approx. 8 mi. to Hansonville Rd. & turn left, go approx. 1 mi. to center on right on:

SAT., OCT. 31, 1998

At 9:30 A.M.

SELLING: A selection of farm equipment; restaurant equipment; tools; yard & garden items incl.: **CASE 1740 diesel skid loader; Ford 8N tractor w/loader; Ford 1600 compact tractor; NUFFIELD 460 diesel tractor; JOHN DEERE 2840 wide front tractor w/3 pt. - one owner tractor; J.D. B tractor; Farnall M tractor; Woods 5 ft. mower; N.I. #14 ground drive manure spreader; N.I. #327 (2) row cornpicker, like new; woodside hay wagon on 10 ton gear; gravity wagon on J. D. gear; 1995 Pace 6x12 tandem axle box trailer; Indus. air compressor; bench grinder; transmission jack; wheel balancer; radial arm saw; sel. yard & garden tools; **VULCAN 10 burner, 2 oven elec. stove; commercial mixer w/5 gal. bowl; Globe meat slicer; elec. deep fryer; & much more!!****

1990 FORD EXPLORER 4x4

TERMS: Cash, Check, Visa or Master Card. 5% administrative fee charged on all purchases which is DISCOUNTED for CASH or CHECK payment. 5% buyers premium.

LOW COMMISSION RATES!! TO CONSIGN CONTACT

SINCE 1920



"Experience Doesn't Cost, It Pays!"
9801 Hansonville Rd., Frederick, MD 21702
301-898-9899 Fax 301-898-3596
e-mail - TroutAuctions@juno.com

Dairy and Livestock Sales

WARREN COUNTY'S NO. 1 HERD Mr. And Mrs. Randy Messenger PUBLIC AUCTION

Located 8 Mile East Of Corry, PA., On Rt. 6, 2 Mile South Of Rt. 6 On Sears Hill Rd. Follow Signs, on

FRIDAY, NOVEMBER 6---11 AM 54--HOLSTEINS--54

One Of The Finest Uddered Dairy Cows You Will Ever See- Daily Average of 86 Lbs., With Records Up To 32,300 (305 Days)--12 Cows Recently Fresh, 5 First Calf Heifers fresh In Last 60 Days, 6 Springers, 8 Due Jan. And Feb., 24,356 Herd DHIA Average, 3.6 Fat, 3.2 Protein---Several Cows Over 28,000 Lbs., 33 Cows Under 70,000 Somatic Cell Count---Average Under 100,000---No BST---All Vac. Elite 9HS Shots---J5 And Staph--An Outstanding Opportunity To Purchase The Best.

RALEIGH AND TODD CHESLEY

Auctioneers--Brokers--Appraisers

11431 Wilson, Rd., North East, PA, 16428

814-725-1303 Or 4969---AU-000147-L



CONSIGNMENT HORSE SALE

SPECIAL DRAFT HORSES & MULES

WELL MATCHED TEAMS

LOADS OF STANDARDBRED DRIVING HORSES and RIDING HORSES

SATURDAY, OCTOBER 31, 1998

11:00 AM Sharp Tack To Be Sold at 8:30 AM

Middleburg Livestock Auction Sales, Inc.

Rt. 522 3 miles East of Middleburg, PA

5 miles West of Selingsgrove, PA

For information call:

717-837-2222 or 717-837-2512

Middleburg Livestock Auction Sales, Inc.

Aaron Reiff (agent) 717-922-1490

Lic. #000357

Clarence Shirk, Auctioneer

Terms: Cash

Trucking Available

Restaurant

SKE CONSTRUCTION INC. PUBLIC AUCTION

MASONRY EQUIP. & TOOLS

TRUCKS, 2 PETTIBONES - SKID LOADER

THURS., NOVEMBER 12, 1998

Auction Time 11 A.M.

LOCATION: 426 California Rd., Morgantown, PA From Morgantown Rt. 23 West approx 2-1/2 miles turn right onto California Rd go approx 1-1/2 mi to auction on right Caernarvon Twp., Lanc Co

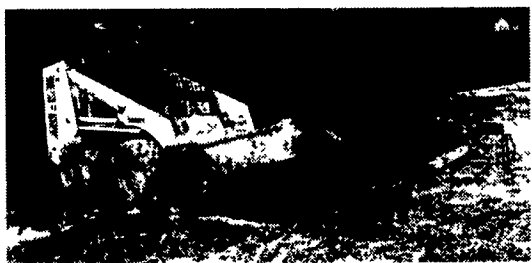

1995 Pettibone B 66 just under 2000 hrs., Cummins diesel, ex cond

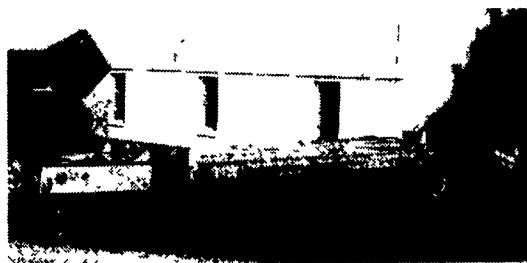

1977 Mack truck, 300 HP Mack diesel eng., 5 spd trans, 8,000 lb front axle, 34,000 lb comb rear axles 14' flat bed w/dump, good cond

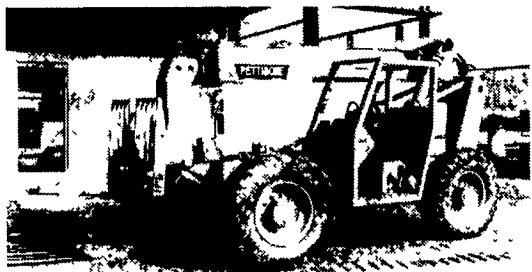

1986 Bobcat #743 skid loader w/stone & dirt buckets, pallet forks & mounting for backhoe approx 2200 hrs



1987 Eager Beaver trailer - GVWR 39,040 lb

1987 Pettibone B-66 approx 7500 hrs Cummins Diesel, good cond, 1986 Ford F-250 pickup 302 V8 heavy duty, 4 spd trans, 1986 Ford F-350 crew cab pickup - 6.9L diesel, Warner 4 spd trans, Hyster Mod H50H tow motor - 5,000 lb lift cap - propane fuel 1978 Zimmer trailer GVWR 6000 lb

Non-stop Masonry Tower Scaffolding - Components to set up a complete operating system to cover approx. 100 lin. ft. of wall approx. 25' high - ex. cond. between 3 & 4 yrs. old - (call SKE for more info.)

Biljax Pipe Scaffolding - approx 14 sections 6'6" high x 5' wide, approx 25 sections of 5' high x 5' wide - access include approx 30 screwjack leveling feet 27 Side Brackets & Misc safety railing, approx 50 - 16 Laminated Scaffold Planks, Misc 8' Planks Target Masonry Table Saw 220 V w/ 14" Diamond Blade, Linc AC 225 Welder Stow 2 Bagger Mortar Mixer, Stone Mod 850 2-

1/2 Bagger Mortar Mixer Stow 6 cu ft Concrete Mixer, Wyco Concrete Vibrator Multiton Pallet Jack - 5500 lb lift Stahl 12' & 14' Cutoff Saws, Makita Mitre Saw w/14" Wood-cutting Blade, Rockwell Wood-cutting Table Saw, 2 Propane Heaters, Misc Shovels, Wheelbarrows, Mud Pans, Chains Chain Binders, Ratchet Tiedown Straps, Etc

NOTE: SKE Construction Inc also trading as Morgantown Masonry, has operated a residential carpentry & commercial masonry business since 1980 Jeff King & Rich Esh have recently sold their masonry operations to Robert Miller who will continue to do masonry work as Morgantown Masonry Inc while SKE will continue to do residential carpentry As a result of this transition, the following machinery & equipment will be offered at Public Auction **Very Few Small Items.** Auction to begin w/sm items followed by larger equipment & trucks Be there early - not a long auction

Terms are cash or good PA check No out of state checks unless current bank letter of credit addressed to this particular auction Food stand

Auction conducted by Randal V Kline, Lloyd Kreider Roy Good, Jr., Auctioneers Lic #2116, #499, #513 717-445-4309

Terms by

SKE CONSTRUCTION, INC.

610-286-6166



Melwood Holsteins Complete Dispersal Monday, November 9 * 12:00 Noon

Cochranville, PA

RHA: 29,228 Milk 3.6% 1055 Fat 3.2% 923 Protein • No BST

The Facts Speak For Themselves:

40 Sell From Dams w/Over 30,000Lbs! 28 Sell From Dams w/Over 35,000Lbs! 11 Cows Sell w/Over 30,000lbs! 8 Cows Sell w/Over 35,000Lbs! 46 Sell From VG Or EX Dams & Many Backed by 10 Generations of VG or EX Dams!

Bred for Production * No BST * Fast Milking * Trouble Free

* EX Bstar Dtr. Sells Milking 125 lbs.! Last Record 5 yrs. 353D 40,422 3.2% 1287 3.0% 994! Dam VG-86 w/35,430M & 3 Records Over 1100F & Grdam VG-88 w/32,090 1218F! Her Luke Twins Also Sell Due 3/18 to Lead & 4/1 to Storm!

* VG-87 Leadman Sells Due 2/2 To Mary w/4 Yrs. 365D 44,000 3.4% 1488 3.2% 1389! Mat Sister to Bstar above! Her Mandel Dtr. Sells Due 4/8 to Celsius w/1-09 262D 23,167 590F 689P!

* VG Roebuck Dtr. Sells w/1-11 365D, 28,236 3.4% 973 3.2% 895! She sells 1 Week Fresh At Sale Time!

* VG Jed Dtr. Sells Due 12/10 & Made 1-11 365D 28,887 3.7% 1077 3.3% 944!

* VG-86 Leadman Sells Milking 117 Lbs. at 5 yrs. & Made 4 Yrs 365D 39,470 4.0% 1560 3.1% 1237! Dam EX w/100,000 LT & Grdam VG-88 w/31,530 3.7% 1176!

*VG-87 Bstar Dtr. Sells Milking 114 lbs. at 5 Yrs. & Made 4 Yrs. 348D 36,541 4.1% 1486 3.2% 1154! Due 3/16 to Storm!

* VG-88 Jet Dtr. Sells fresh Milking 120Lbs after Making 2 Yrs 347D 31,543 3.1% 979 3.0% 950! Dam VG w/29,458 1111F!

* VG-87 Ares Sells Milking 92 Lbs., Due 2/18 to Airliner & Finishing w/42,000 4.4% 1840F! Her Dam is VG w/39,967 3.8% 1517F!

DON'T FORGET, THEIR DAUGHTERS ALL SELL AS WELL!

* Cattle are Tested for Immediate Interstate Shipment, Pregnancy Examined & Inoculated Against Shipping Fever.

* Long Distance Trucking Available * Lunch At Ringside*

Directions: From Gap: On Rt. 30 take Rt. 41 South to Rt. 10 South to Rt. 926 on the left. Make left at 2nd cross road & 1st farm. From Oxford, PA: Take 10 North & Turn Right On Rt. 926 & Follow Signs.



Dave Rama R02 Box 79 Delhi, NY 13753

Phone 607/746-2226 Fax: 607/746-2911

AU-002463-E www.cattleexchange.com

cattleex@catskill.net

Owners:
Melvin Stoltzfus & Family

Cochranville, PA

610-869-9627

610-869-6013