



POWDER-COATED STEEL BARN EQUIPMENT

**STOP AND SEE US AT THE
ANIMAL HOUSING EXPO**
November 8 & 9 - Lebanon Fairgrounds

LOOP STALLS

All Loop Stalls are Coated with Baked on Top Grade Polyester TGIC Powder Coating after Fabrication

- Super Tough Finish
- Protection From Rust & Corrosion
- Superior Electrical Insulation
- Chip Resistant
- Resists Acid & Chemicals
- Smoother Finish Stays Cleaner



LOOP STALLS WIDE FRONT

FEATURING

- The most versatile of all loop stall designs
- Greater cow comfort when entering and exiting stalls
- Sufficient lunge space for head and neck between top and bottom of loop

CONVENTIONAL STALLS

Loop Stalls Are Constructed of:

- 2 3/8" Outside Diameter High Yield Steel Tubing With A 12 Ga. (.108) Wall
- Spray Arc Transfer Method Used On Welds



GATES AND FENCING



All Gates & Fencing Made Of 1.9" Outside Diameter High Yield Steel Tubing With 13 Ga. Wall

New Zimmerman Water Bowls

IMPROVE YOUR AVERAGE Increase Milk Production...Naturally!

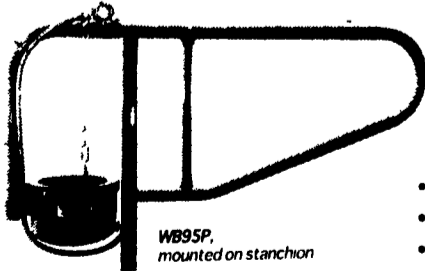

WB95P, mounted on stanchion

- 3 gallon capacity
- PVC construction,

Guaranteed Unbreakable

Available in 2 models for both pressurized and gravity systems they can be built into new, or added to existing, tie stall housing.

**Improve your average!
Call today for more information**

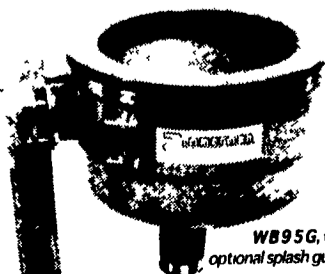

WB95G, with optional splash guard

SUSPENDED COMFORT STALLS

Finished With Baked on Top Grade Polyester TGIC Powder Coating, After Fabrication

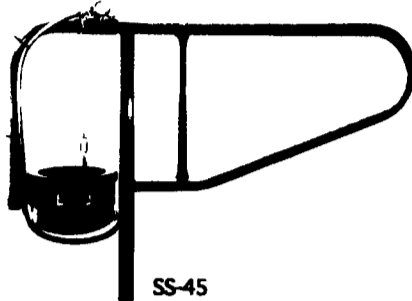

SS-45

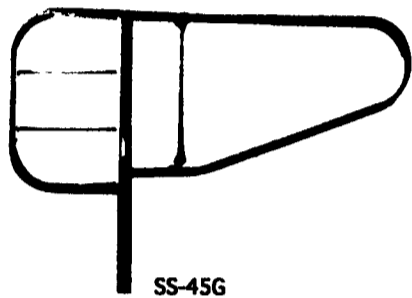

SS-45G

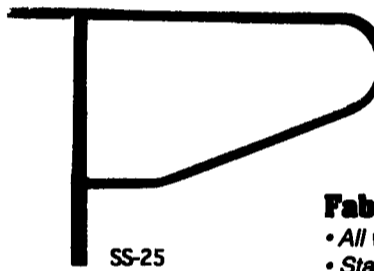

SS-25

**Install the Best!
Get These Advantages:**

- Increased comfort for cows
- Easy cleaning
- Easy access for bedding & milking
- Adjustable tie rail
- Fewer trampled teat problems
- Durable powder coating resists manure acids & chemicals
- Powder coating helps insulate against stray voltage problems

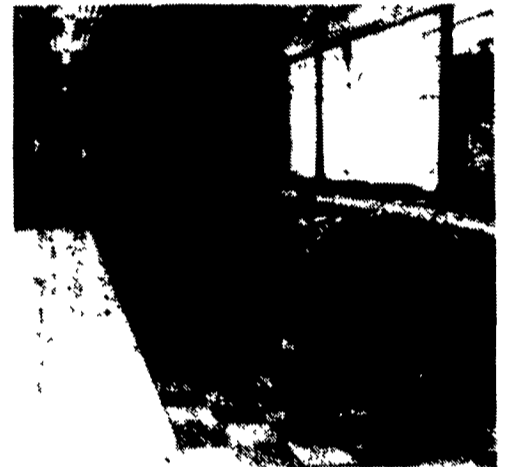

Fabricated for Durability & Dependability

- All welded construction for many years of trouble free service.
- Stalls are constructed with 1.9 O.D. (.133) wall, high strength tube and 2" square post with 1/4" wall.

MANURE PUSH OFF GUARD

For Tractor
and Cattle

Available In
8' and 10'

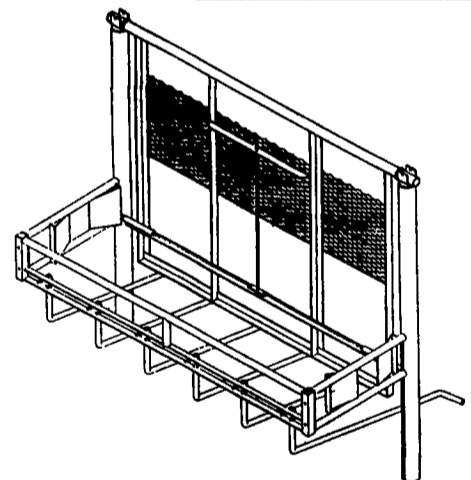

HEADLOCKS

THREE
SIZES
AVAILABLE
TO MEET
ALL YOUR
CATTLE
HANDLING
NEEDS

EXTRA
HEAVY
CONSTRUCTION

