

Sale Reports

GLENN SALE
A Public Auction of farm machinery was held April 8 by Ethel Glenn, 3 miles east of Chester, West Virginia on Little Blue Road.

Some prices were: Oliver 1550 tractor \$5200, A.C. D-17 tractor \$2200, J.D. garden tractor \$2200, 375 gal. bulk tank \$110, N.I. manure spreader \$575, N.H. haybine \$1600, OMC mixer \$850, gravity bin \$400, skid steer loader \$2300 and Minn. Molene plow \$300.

The auctioneers were Jim, Ken & Bill Baer and Gordon Koehler & Mark Harding.

FETTERMAN SALE
A Public Auction of farm equipment was held April 8 by Hazel Fetterman, south of Catawissa, Pa. on Gas Well Road.

Some items sold were: grain bin \$1600, A.C. 175 diesel tractor \$4000, M.F. tractor \$1100, J.D. mower \$150, Clay honey wagon \$500, Howse MH6 mower \$600, fodder cutter \$80, potato plow \$110, table saw \$90 and router table \$80.

J. Vance Auction Co. conducted the sale.

LANDIS SALE
A Public Auction of real estate and antiques was held April 7 and April 8 by David and Martha Landis, 1838 Windy Hill Road, W. Lampeter Twp., Lancaster, Pa. There were 575 registered bidders at the 2 day sale.

The 3 bedroom brick rancher with a 2 car garage was sold for \$102,000.

Other prices included: Farmall Cub tractor \$1200, riding tractor \$1950, rototiller \$525, storage shed \$425, quilts \$500 & \$525, half-spindle settee \$1350, 6 plank bottom chairs \$360, 6 hand-painted plank bottom chairs \$390, jelly cupboard \$575, gaudy Dutch plate \$170, large decorated ironstone bowl \$510, two \$2½ gold pieces 1909 & 1912 \$170 each, 1917 standing Liberty 25¢ piece in mint condition \$235 and Atlas \$265.

Miller & Siegrist were the auctioneers.

SHANK SALE
A Machinery Auction was held April 6 by Merle and Elsie Shank, 755 Social Island Road, Chambersburg, Pa. in Franklin Co.

Some prices received were: Gehl 970 wagon \$7000, Meyers feeder wagon \$1750, Killbros. gravity wagon \$1225, Brillion cultimulcher \$2750, J.D. 3020 D tractor \$6600, Farmall Super M tractor \$2200, N.H. 489 haybine \$4800, Case 1845 C uniloader \$14,600, Gehl silage blower

\$1400 and N.I. manure spreader \$2400.

Kling's Auction Service conducted the sale.

SCHAFFNER SALE
A Public Auction of real estate and gasoline engines was held April

8 by Merle L. Schaffner, 2 miles south of Dalmatia, Pa. There were 257 registered bidders.

The 2 3/10 acres with a 3-bedroom dwelling and storage sheds was sold for \$20,250.

Other prices were: 2 Farmall H tractors \$950 & \$550, Dingo go-cart \$180, adult 3-wheel

bicycle \$135 and some of 83 engines sold: N.H. 2 h.p. (not complete) \$2050, Geiser 2 h.p. \$1900, Associate 4 h.p. \$1600, Int. 1½ h.p.

\$1400, 2 Economy 1½ h.p. \$645 & \$325 and Maytag and others \$20 to \$240 each.

Mike and George Deibert were the auctioneers.

20th ANNUAL CONSIGNMENT SALE

Sat. April 22, 1995
9 AM

Located at the Nescopeck Volunteer Fire Co. on Rt. 93

For Information on Consigning
Phone Herschel Hileman
(717)379-3807
Box 1400, RR 1
Nescopeck, PA 18635

Will have all Kinds of Farm Machinery, Household Goods and So Forth.
Truck Loads of New Building Material.

Local Auctioneers

LIQUIDATION AUCTION

Of Valuable
REAL ESTATE - BUILDING LOTS
VEHICLES - TOOLS - BUILDING
SUPPLIES - ETC...

ON: Tues., Apr. 25, 1995
at 10 A.M.

AT: 7 Industrial Road, Glen Rock, Pa. (Located along RT. 111 in the Exit 2 Industrial Park). The following to be offered at Public Auction.

REAL ESTATE
2.13 acres with a 40'x64' metal pole building with a 41'x36' Eldarodo stone front. Building has 3 overhead doors - Access doors - Partial second floor & cemented floors. Stone front consists of rough in for 2 full baths - 3 Offices - Reception area - Conference room - Lunch room. Building has ample parking - Gas available - Sewer hookup paid - Short distance from Route 83 - Many possibilities. **TERMS: 10% down day of auction, balance due in 60 days. OPEN HOUSE: Saturday, April 15 from 10 A.M. - 12 Noon. Real Estate to be offered for sale at 12 Noon on day of auction.**

BUILDING LOTS
2 Lots each approx. 1.5 acres - Perked & probed - On site septic - Partially wooded. Located on Hain Road off RT. 111 and only 2 miles from Shrewsbury in N. Hopewell Twp. signs posted. To be offered for sale at 12 Noon.

EQUIPMENT & TOOLS
1978 Ford 8000 single axle dump truck - New CAT motor w/2000 miles - 1979 Int. dump truck single axle w/11' plow - 24' 11 ton tri axle equipment trailer - 1984 Ford 4x4 pickup - 1976 JLG60 2 man lift - Raymond elec. straddle truck - 1978 Chev. van - 1962 Studebaker Daytona convertible (in running order) Robin Tamper - 1 Ft. John Deere hoe bucket - Pressure washer - Craftsman radial arm saw - Emglo air compressor - Coleman 4000 watt generator - Honda 3500 watt generator - Makita cordless drills - Bostich roofing & framing nailer - LP heater - David White transit & tripod - 7 New in box gas & elec. stoves - Whirlpool washer & dryer - Approx. 30 asst. new interior doors - 7 Marble vanity tops - Step ladders - New kenmore elec. hot water heater - Asst. new Anderson windows - Carpet remnants - Carpet padding - Tub & shower unit - Asst. hand tools - Shovels - Gas cans - Bag truck - Wheel barrows - Asst. hardware - Elec. items - Misc. PVC pipe - Screens - Office equip. - Scaffolding - Plus many other items too numerous to mention. Not responsible for accidents on day of auction.

Owner: **Glatfelter Construction**
Gilbert & Gilbert Auctioneers
Brian L. Gilbert, Lic. # 2256
Jacob A. Gilbert, Lic. # 336
Ph. (717) 252-1656 or 252-3591

PUBLIC SALE of New Home Medical Equipment

Bed - Porto-Lift
Wheelchairs
Large Appliances
Household Goods - Tools
MON., APR. 24, 1995
at 5:30 PM

Loc. 18 Green Hill Drive, Millersville, Lancaster Co., PA. Take RT 999 (Millersville Pike) one mile west of Lancaster. Turn Left onto Green Hill Drive and follow to sale.

Food served. Sale by
Carolyn C. Morrill Estate
Howard E. Shaub, Inc. 717-464-3541
Auctioneer (AU-000831-L)

LONG VIEW FARM MACHINERY SALE

Having rented the farm and discontinuing farming will sell on the farm located in Frederick County, Thurmont, Maryland.

SATURDAY, APRIL 22, 10:30 A.M.

5 — TRACTORS — 5
Case 970 w/wide F.E., AC 180 Turbo diesel w/wide F.E., (2) Ford 5000 w/wide F.E. All with excellent rubber, Ford 740 w/scraper blade.

— HAY EQUIPMENT —
NH 315 Baler w/kicker, NH 488 Haybine (9 ft), JD 660 hay rake, Grim hay tedder, NH 32 ft. hay elevator, (4) NH hay wagons w/metal sides, (2) hay wagons wooden sides.

— FORAGE EQUIPMENT —
New Ideal 702 Diesel Uni-System w/corn head 30" & 38", Grain head and sheller head, (2) NH model #8 self-unloading wagons w/roof and tandem axles, JD 716 self-unloading wagon w/tandem axle, Gehl 1540 blower, NH 770 chopper w/corn and grass head, IH 720 chopper w/2 row corn head 30" and grass head.

— TILLING EQUIPMENT —
(2) IH transport disk harrow 12', Springtooth folding harrow 16', Springtooth harrow 12', 4 bottom plow 14" 3ph, 12' single cultipacker.

— MANURE EQUIPMENT —
Slurrystore 3200 gal. tank spreader, injectors to be sold separate, NH 679 manure spreader w/tandem axle, NH 312 manure spreader (needs repair).

— OTHERS —
Oswalt 230 mixer wagon, Winco Generator, Hay Spear, JD Grain Drill (13 Disk) 3 Ph Fertilizer Spreader, 6000 Gal. Liquid Nitrogen or Protein Tank.

Note: There will be a very few small items selling, so if you are interested in equipment be on time.
Terms: Cash or Good Check only. Lunch available. Not Responsible for Accidents.

DIRECTIONS TO FARM: From points north take U.S. 15 to MD. 77 east to Graceham. Turn right on Graceham Road and go one mile to farm on left. From Frederick, take U.S. 15 north three miles and turn right on Old Frederick Road. Follow Old Frederick Road for six miles to stop sign. Make a left on MD. 550 and follow one mile to right turn on Graceham Road. Go 1/2 mile to farm on right.

OWNERS
HAROLD & MARY K. LONG
13127 Graceham Road
Thurmont, Maryland 21788
Ph: 301-271-7577

Sale Manager and Auctioneer
CATTLE CO.
NORMAN HILL
15905 Union Chapel Road
Woodbine, Maryland
Phone: 410-489-7121

REAL ESTATE 2 WOODED LOTS PUBLIC AUCTION

SAT., MAY 13, 1995
Auction Time: 2:00 P.M.
Directions: From Route 272 in Ephrata take Schoeneck Road north to Schoeneck stay left at the Y, continue on Cocalico Road approx. 2 miles, turn left on Furnace Hills Road go to Girl Scout Road turn left to property on left, watch for signs, Clay Township, Lanc. Co.

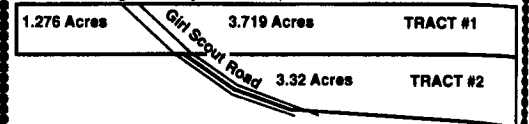

WOODED LOT #1
Contains 5 acres with frontage on both sides of Girl Scout Road. This lot has 1.27 acres on the west side and 3.7 on the east side of Girl Scout Road.

WOODED LOT #2
Contains 3.32 acres on the east side of Girl Scout Road. Owner has a current sewage permit for this particular lot.

TERMS: 10% down payment day of auction, balance at final settlement on or before June 25th, 1995.
NOTE: Don't miss these choice lots located next to Middle Creek Wildlife Preserve. For more details contact the owner or the auctioneer or owner will be at the lots on Saturday, April 22, 1:00 P.M. to 3:00 P.M.
ATTORNEY: Michael P. Kane

Auction By
Glen W. & Mary Kay Fox
Professional 336-6410
AUCTIONEERING
MARTIN AUCTION SERVICE
410 West Church Rd.
Ephrata, PA. 17522
(717) 733-3511

PUBLIC AUCTION

Estate Of
Margaret I. Latshaw
Wed., April 26, 1995
1:00 p.m.

Location At Red Cross, turn East off Rt. 225, continue 1/2 mile, at red brick church, turn right 1/2 mile to sale site. Approximately 15 miles S.E. of Sunbury, PA, Northumberland County.

ANTIQUES - COLLECTIBLES - HOUSEHOLD
Jelly Cupboard; (2) Blanket Chests; Set Of 4 Pressed Back Chairs, Painted; Parlor Stand, Claw/ Glass Ball Feet; 8 Pc. Depression Dining Room Suite; 3 Pc. Depression Bedroom Suite; Kit. Cabinet, Painted; Oak Treadle Sewing Machine; Washstand, Painted, Player Piano, Armstrong; Baby Carriage; Wooden Adv. Boxes; Quilt Frame; Rockers; Copper Wash Boiler; Mirror w/Oak Frame; Floor Lamps; Empress Shelf Clock; Kerosene Lamps; Oak Table Boards; Wheel Barrow w/Wooden Wheel; Wooden Measure; Butcher Benches; Bike Shelby Flyer; Egg Baskets; Wooden Berry Crates & Barrel; Butcher Fork & Ladle; Mortise Bench; Dovetailed Bench; Trumpet; Clarinet; Pressed & Pattern Glass; Nest Of Bowls; Halls, Mixing Bowls; CI Fry Pans; Grass Baskets; Doilies; Wooden Ironing Board Baskets; Apple Cookie Jars; Crocks; Jugs, Dishes By Knowles China; Avon Christmas Plates 1973-1977; Broad Ax; 2 Man Saw; Hay Hook; Draw Knife; Lanterns; Milk Cans; Sausage Stuffer; Carry Coke Cooler; Etc. Following GE, Appliances: 2 Dr. Refrigerator/Freezer; 30" Electric Stove & Washer & Dryer; Portable Color TV; Westinghouse Chest Freezer; Maytag Sq. Tub Wringer Washer; Kenmore Sweeper; Sofa Beds Matching Rocker & Arm chair, Sofa-love Seat & Chair; Upholstered Rockers; 5 Pc. Wooden Dinette Set, Metal Base Cabinets; End Tables; Electric Gone w/The Wind Lamp; Floor & Table Lamps; Single Bed Complete; Blonde Bedroom Suite; Wall Pictures; Hamper; Guardian Service. Everyday Dishes, Pots & Pans And Silverware; Mixers Etc., Lawn Chairs; Plus Many Other Items.

TRACTOR - FARM MACHINERY - TILLER
1952 John Deere "A" Tractor, Nice & Clean, #692026; J.D. 2 Bottom Trailer Plow; N.I. Ground Drive Manure Spreader, Good; Potato Plow; 1 Horse Walking Cultivator, Skid Gas Tank w/Hand Pump; Approximately 200 Bale Hay; Misc. Used Lumber, Seats 16 Gal. Shop Vac; Troy Bilt 6 HP Roto Tiller; 15' Air Boat w/16 HP Kohler Engine, Electric Start, Tee Nee Trailer.

NOTE: Tractor-Tiller-Boat, Sell At Approximately 5:00 p.m.
TERMS: Cash or PA Check.

LUNCH STAND
EXECUTOR: **Kenneth J. Latshaw**
Attorney: Isaac J. Tressler
MARK J. JONES AUCTIONEERING SERVICE
Phone (717) 286-0052
Lic. #AU1595-L
NICE COUNTRY AUCTION