

MAY-CO PLASTIC SILO LINERS BIG DISCOUNTS

For the early order low discount prices of the best made silo liners call or write to

May-Co Supply Co., Inc.
48 Jeffrey Road, Gordonville, PA 17529
Phone (717) 768-3269
Shop (717) 399-8232

BADGER'S AGRICULTURAL SERVICE, INC.

Dillsburg, PA 15 miles South of Harrisburg
717-432-8377 Brian Badger

* Goliath Standard Cutter Chain
- Longest Warranty Available -

Chain 48
- Strongest Chain Available -

Micor Epoxy Floors
- Always Had A Warranty -

Rissler Wooden TMR Mixers & Conveyors
- Long Lasting & Versatile Get More For Your Automation Dollar -

Lancaster Level-Flo Goosenecks
- More Feed In Your Silo And Faster Without Plugging Problems -

Goliath And Hercules Sprockets
- 12 Month Pro-rated Warranty -

Highest Quality Replacement Parts And Service

Not affiliated with A O Smith Harvestore Products, Inc.

WANTED: Original Floor, Grainery Boards, 2" Flooring, Barn Beams, Tobacco Sheds, Siding
717/229-2806
Mobile 717/880-4549

Close Construction

Agricultural, Residential and Commercial.
Also Building Take-Down and Removal
Southern York Co., Northern Baltimore and Northern Harford County, MD

(410)879-4915

2016 Channel Road
Pylesville, MD 21132

Pole Buildings

30x40x10
1-10x10 Slider
1-Service Door \$7,195
24x32x8
1-9x7 Overhead Door
1-Service Door \$5,395

Other Sizes Available

Call Anytime

1 (800) 352-1782
Cheyenne Buildings

\$ WHOLESALE \$

1/2" to 8" **PIPE** 1/2" to 8"

Prime, secondary, structure pipe
Farmers, Manufacturers, Fabrication
— Will Cut To Your Size Needs —

BRICKER'S PIPE YARD

717-261-0095 1970 Frank Road
Chambersburg, PA 17201

FLOORING

Ash "Golden-Oak", Oak, Maple, Walnut, 3 to 10 Inch Wide Planks, 3/8 and 3/4" Thick, T&G, KD,

\$1.95 to \$3.50 Sq. Ft.

Custom & Stock Floor & Moldings
610-565-6038

John Koser's

FOR YOUR HOME IMPROVEMENT NEEDS

LOCATED NORTH OF ELIZABETHTOWN
OPEN MON.-FRI. 8 TO 6; SAT. 8 TO 3

- Kitchen Cabinets
- Plywood & Waferboard
- Asphalt Roofing Shingles
- T-1-11 Siding
- GP Insulation
- Railroad Ties
- Shutters
- Replacement Windows
- GP Vinyl Siding

Metal Roofing Painted or Galvanized

717-367-0283

STEEL BUILDINGS EASY TO ERECT



(2 Left) 25x40 (1 Left) 40x60
(3 Left) 32x42 (2 Left) 50x100

!!! FACTORY CLEARANCE !!!

!!! 40% OFF !!!

American Steel Arch Inc.
Manufactured in Pittsburgh, PA

FACTORY DIRECT

1-800-942-1234
NATIONWIDE

Pine boards, not perfect, misc. lengths, many uses for farmers and contractors. By truck load only. 717-764-8397.

Pre-engineered steel buildings for Agricultural, Commercial or Churches. Authorized Gulf States Dealer. We will build from your plans or will design. **WEAVER CONSTRUCTION**, East Earl, PA. 717-445-5165.

Railroad ties, prices vary from \$4-\$10. Delivery available. Lancaster Co. 717-898-7689.

Barn deck approx. 30x150 FREE for dismantling and removal.
(717) 544-4559
(717) 366-3860

S.M.S. Builders POLE BARN AND GARAGES
717-354-8755 evenings
717-940-6920 mobile phone ask for Sam

DON'T IGNORE IT - RESTORE IT!
Masonry/Restoration specializing in restoring old stone/brick houses and barns.
Also Laying Eldorado Stone
J&J Restoration
717-442-4773

Lancaster Farming, Saturday, February 4, 1995-C13

For Sale: weathered barn boards, several up to 12in. wide, 12ft. long, some 8ft. long, 10-12in. wide, also some beams w/wooden pegs. Accepting bids 717-436-9317.

"FREE" Barn and Stone House. Must be removed Located Limerick Twp, Montgomery Co., PA. Call for details 610-768-2942.

Free House & Garage! Must be removed, Lititz, PA. 717/626-4765.

Metal working lathe, some tooling, less motor, \$250. 215-256-1642.

WANTED Old barns, good condition. Will pay fair price. 704-526-5877.

WANTED: Original floor, grainery boards, 2" flooring, barn beams, tobacco sheds, siding. (717)229-2806. mobile 717/880-4549.

WANTED TO BUY: Old attic flooring and log houses. Lanc. Co. 717/626-4520.

POLE BUILDINGS "KOHLER & KOHLER" WE SPECIALIZE IN POLE CONSTRUCTION

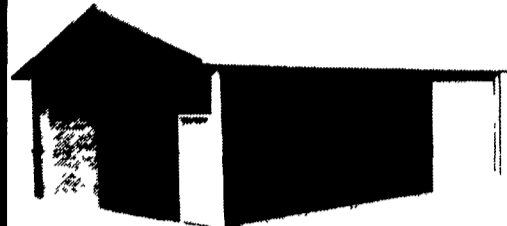

We're Building Our Business On Customer Satisfaction And Quality Construction. We Are Prepared To Meet Your Building Needs At Saving Prices

Please Call For Your Free Estimates
(717) 252-2874

POLE BUILDINGS, TRUSSES

GARAGES - COMMERCIAL BUILDINGS - HORSE BARN - STORAGE BUILDINGS

For FREE ESTIMATES Call

MUSSER & ASSOCIATES, INC.

245 Fetterville Rd.
East Earl, PA 17519



SALES

1-800-331-1875 717-354-7561

KW Pole Buildings



• Horsebarns • Riding Arenas • Livestock Facilities
• Implement Sheds • Storage Buildings • Garages

- ★ Quality Built, Custom Engineered; Agricultural, Commercial and Residential Buildings.
- ★ 20 Yr. Painted Steel Siding & Trims With A Large Selection Of Colors.
- ★ T1-II, Cedar Board & Batten And Vinyl Siding Also Available.
- ★ Custom Designed Dutch Doors & Horse Stalls.

Call Us For A Free Estimate - Fully Insured

KW Construction
Bethel, PA 19507
(717) 865-0825



4 BUILDINGS AND SUPPLIES

1000 watt mercury vapor lights, \$125/each. 717/354-3105.

#3 pine boards, 1"x12"x10-15", \$2.25/each. Must take 25 or more. 717/764-8337.

42X52 Oak Timber Frame, Manufactured in 1993. Stored Inside. \$25,000; 30X40 Chestnut and Oak Timber Frame, Circa 1902, Stored Inside, Complete for \$15,000 Craftwright Timber Frame Co (410)876-0999.

Antique building materials, beams, wide pine boards, flooring, doors, etc. 717/249-2304

BARN FLOORING: new, kiln dried, T&G or plain 2x8's, Y.pine, for floors, stalls, studs, rafters. 2x4's roofing perkins. Can deliver Noah Shirk Sawmill, 717/354-0192.

BARN FOR SALE: 45'x75' in good condition. Must be removed before April. Call 1(800)233-9358 for more details and directions.

Barn beams, rafters, wall boards from a 40x80 late 1800's barn. Taken down & stacked. Looking for package deal. \$14,900. 215/723-7865, 215/322-9424.

CECO KIRBY... ALLIED Steel buildings and components. Retrofit steel re-roofing. Commerce, Industry, Ag. Supply or supply erect Standard or custom. Complete or addition. Certified permit drawings. Building YOUR business is OUR business. A.S. HOOVER, INC 3125 Manor Rd., Coatesville, PA 19320. 610-942-2591; 717-445-4962; 1-800-942-2591.

B grade glass board and plastic sheets. Glenn Beider, Freeburg, PA, (717)539-8993.

Brick-Tile paver bricks, 1/2" thickness. (610)593-1172.

Building 40-160, feed bins, feeders pens, to be taken down, best reasonable offer. (301)898-8994.

Chain Link Fence, new, slightly imperfect, heavy 9-gauge galvanized. 3'-\$.90/ft, 4'-\$1.00/ft, 5'-\$1.55/ft, 6'-\$1.65/ft, 7'-\$1.85/ft, 8'-\$1.95/ft. Call 717/822-7820 7-8am or leave message.

Cramer's Discount Roofing, lowest prices in 3 states. See display ad section 4. (717)567-6782.

Dust Collectors, used and new, fans, ductwork, slide gates, hoppers, bins. Components or systems. We can help clean up your shop or plant. Call Dale at GSM 717-738-3394.

Flooring, new wide plank, T&G, timbers, see our display ad. 610/565-6038.

For Sale: 40'x40' corn barn to be torn down & removed in Montour Co. 717/898-0675.

GEBHART'S POLE BUILDINGS: Let quality and value stand for you. Custom design and built, commercial, residential or agricultural. Put your building up today. 717-259-9438.

Log Home Logs: new, 6x6, 6x8, white cedar, single or double, tongue & groove, inexpensive for self-builders \$2.75/LF. (717)354-3105

METAL ROOFING and Siding. We'll beat any competitor's regular panel price you mention on orders over 50 square. Call (717)354-2728.