

PUBLIC AUCTION REAL ESTATE

SATURDAY, MAY 28, 1994

Auction Time 1:00 P.M.

Directions: From Rt. 340 in White Horse take Cambridge Rd. North to Gault Rd., turn left to property on left. 478 Gault Rd., Salisbury Twp., Lanc. County.



1 Story Ranch Home New in 1991

Large eat-in kitchen with Washington cherry stain, family room area, pantry, laundry 1st floor, 2-car garage, 3 bedroom.

- Wood/coal stove
- Water filtration unit
- Strong well
- Expandable basement
- Outside basement entry
- Cold cellar

Horse Barn with Loft

1 Stall - Shop and Storage Area

Open House: May 7 and May 14, 1:00 to 3:00 P.M. or by appointment. For appointment for private showing or assistance to obtain financing call Aaron Martin, 717-738-4168.

Terms: 10% down payment day of auction, balance at final settlement on or before July 23, 1994.

Note: Very nice clean country property only 3 yrs. old.

Attorney: Mark James

Auction By

ANNIE K. STOLTZFUS



Professional
AUCTIONEERING

MARTIN AUCTION SERVICE

AU-002280-L Aaron E. Martin Richard L. Stauffer
(717) 738-4168 (717) 738-0296

PUBLIC AUCTION TRACTORS-TRUCKS-PAVING EQUIPMENT- TOOLS-MISC. HOUSEHOLD GOODS FRIDAY, JUNE 17, 1994 9:00 AM

CURVIN E. CROWL ESTATE 4590 DAVIDSBURG ROAD DOVER, PA

Kubota L2550 Tractor & Loader 4x4- 335 hrs., Kubota L2850 Tractor with Loader & Backhoe 4x4-980 hrs., Farmall C Tractor, 1988 Dodge Dakota- 38,000 miles, 1987 Dodge 1 Ton Dump 4x4, 1971 Ford F350 Stake Bed w/Black top Sealing Pump & Equipment Mtd., NEW B.R. Lee Paver-Model Lee Boy 700S with Diesel Motor, 2 Hudson 2 Axle Trailers 10,000 lb. & 1 Load Over Wheels, Hudson 1 Axle Trailer, 1 Ton Hydrostatic Roller, 5' 3 pt. Finish Mower, 6' 3 pt. Scraper Blade, 6' 3 pt. Scraper Box, 3 pt. Carry All, 2 Wheel Garden Tractor & Culti., Sears LT8 Lawn Tractor, Cement Mixer, Wheelbarrow, Air Bumper Jack, Electric Welder, 1 1/4 Ton Floor Jack, Diesel, Fuel Tank with electric Pump, Portable Sign with Letters, Bench Grinder, Vise, Pipe Wrenches, Box & Open End Wrenches, Electric Drills, Side Grinders, Screwdrivers, Rototiller, New Lawn Mower Wheels, Bench Drill Press, Bolts & Hardware, Refrigerator Truck, Step Ladder, Weedeater, Polan Chain Saw, Leaf Blower, LIKE NEW Demico Lawn Sprayer, 8 hp. MTD Shredder, Lawn Sweeper, Blacktop Hand Tools, Long Handle Garden Tools, Tonka Demo Saw, Ben Franklin Wood Stove, Red Commode, Misc. Lumber, Fan, Aluminum Window Screening & Other Misc. Items.

"EQUIPMENT IS IN LIKE NEW CONDITION"
TERMS: CASH OR GOOD CHECK

SELLER:

Estate of Curvin E. Crowl

EXECUTRIX:

Glenda F. Crowl

ATTORNEY:

Eugene Stumpf

AUCTION CONDUCTED BY:

Rentzel's Auction Service

Emigsville, PA

764-6412

PA Lic. #761

PUBLIC AUCTION

June 2, 1994

92± ACRE FARM

Residential "Opportunity"
(For Agricultural Purposes Only)

\$2,500 Minimum Bid/Acre

A NJ Farmland Preservation Project

**Hopewell Township
Mercer County, NJ**

Farm Tour: May 19, 1994

**Call for details
609-984-2504**

PUBLIC Auction

**OF 52 ACRE UNION COUNTY
FARM - HOUSEHOLD GOODS**

SATURDAY, MAY 28

COMMENCING AT 10:00 A.M.

Located Approx. 5 mi. West of Mifflinburg,
Off Route 45, 1/2 mi. North of Hartleton, Pa.,
along Cold Run Road, Union County.



52 ACRE FARM (12:00 NOON)

Consisting of All Tillable Soil w/Large Amount Underground Drain Tile. Buildings Consist of Bank Barn, 42' x 180' Adjacent Free Housing Barn, 12' x 35' and 10' x 35' Concrete Stave Silos, 2 Small Metal Grain Storage Bins, 2,000 bu. Round Wire Corn Crib & Rectangular Crib & Other Sheds. 3 Bedroom, 1 1/2 Story Frame House, Bath, Den, Kitchen, Living Room, Enclosed Patio. Newly Installed Baseboard Oil Furnace. 30' x 54' Block 2 Car Garage & Workshop Adjacent to House. This Farm in High State of Cultivation. Buildings All in Excellent Repair. For Inspection, Call 717-922-1719 or 717-922-1206.

HOUSEHOLD GOODS & ANTIQUES

16 cu. Amana Dbl. Door Refrigerator; 30" Imperial Electric Stove; G.E. Automatic Washer; G.E. Clothes Dryer; Maytag Wringer Washer; I.H. Refrigerator; 2 pc. Brown Tweed Living Room Suite; Rockers; Antique Walnut Sleigh Type Davenport; Household Treadle Sewing Machine; Misc. Dining Room Chairs; Floral Platform Rocker; Mahogany Kneehole Desk; Single Bed, Springs & Mattress; Metal Glider & Porch Chairs; Dropleaf Work Table; Rugs; Smoking Stand; ITE Elec. Adding Machine; Mantel Oil Light; Some Dishes & Cookware; Twin Wash Tubs; Antique Fruit Cupboard; Bench; Crocks; Avons; Set of Long Horns.

LAWN, GARDEN & MISC.

8 H.P. Wheelhorse Riding Lawn Mower, 30" Deck; McCullough Gas Driven Weed Eater; Lawn & Garden Tools; 24' Aluminum Extension Ladder; Potato Crates.

MRS. NED SHIVELY, OWNER

TERMS: Real Estate - 10% Down, Balance 30 Days or Before.

ATTORNEY: Thomas E. Boop

AUCTIONEERS:

Wayne Hess, AU-000411-L

(717) 922-1206

Lori Hess-Lauver AU-002854-L,

(717) 966-2512

OWNERS AND AUCTIONEERS NOT
RESPONSIBLE FOR ACCIDENTS

Public Auction Register

Closing Date Monday 5:00 P.M.
of each week's publication

SAT. MAY 28 - 9:30AM, Budman Dispersal. Located On Farm 1/2 Mile N. Of Lairdsville, Pa., 10 Miles E. Of Hughesville, Off Rt. 118. Owners, Glen & Nellie Budman. Fraley Auction Co.

SAT. MAY 28 - 10AM, Toy Auction. York Fairgrounds Harry's Auction.

SAT. MAY 28 - 10AM, Smith Machinery Dispersal. Located Thomas Hill Rd., Farmington Twp., Tioga, Pa. Follow Signs From Rte. 49 At Nelson Or From Rte. 287 Just South Of Tioga (Elkhorn Road). Owners, Mr. & Mrs. Perry Smith. Randy Jelliff Auction Service.

SAT. MAY 28 - 10AM, Estate Auction. Located 1/2 Mile North Of Hegins, Schuylkill Co., Pa. From I-81, Exit 34 Turn West On Route 25, In Hegins Turn North On Route 125, And Watch For Auction Sign Along East Mountain Road At Little Mountain. Estate Of George C.A. Malick. Mike & George Deibert, Auct.

SAT. MAY 28 - 10AM, 52 Acre Union County Farm, Household Goods. Located Approx. 5 Mi. West Of Mifflinburg, Off Route 45, 1/2 Mi. North Of Hartleton, Pa. Along Cold Run Road, Union Co. Wayne Hess, Lori Hess-Lauver, Aucts.

SAT. MAY 28 - 10:30AM, Robert Cook Estate & Friends. Located At The Karl Kohrs Farm, Teaton Rd., & Rt. 145, Durham, N.Y. Sale By Order Of, Candy Cook, Executrix. D. Luther, CAI Auct., Sales Mgr.

SAT. MAY 28 - 11AM, Machinery Auction. Located Halfway Between Montrose & Tunkhannock, Susq. Co. At Lynn, Pa., Just Off Rt. #29. Owners, Chuck & Billy Stone. Adriance Aucts.

SAT. MAY 28 - 11AM, 4 Tractors, Farm Machinery & Automobiles. Located 32 Wintersville Rd., Richland, Tulpehocken Township, Berks Co., Pa. From I-78 Bethel Exit - South On Route 501 To Stop Sign In Bethel - Right On Route 501 To Stop Sign - Left On Rehersburg Road. 3 Mile - Right On Wintersville Road 1.0 Mile To Farm On Right.

From Route 422 Between Myerstown And Stouchsburg At Traffic Light - North On Wintersville Road 4.6 Miles To Farm On Left. Auction Conducted By: Roy D. Shirk Auctioneering Service.

SAT. MAY 28 - 12Noon, Real Estate Auction. Located Off Rt. 706 Schneider Rd., Between Lawton & Campdown, Pa. Bradford County. 20 Miles S. Of Binghamton, Or 40 Miles N. Of Scranton. Auction Conducted By Shamrock Auction Service.

SAT. MAY 28 - 1PM Real Estate. 1 Story Ranch Home, Horse Barn w/Loft. Located From Rt. 340 In White Horse Take Cambridge Rd. North To Gault Rd., Turn Left To Property On Left. 478 Gault Rd., Salisbury Twp., Lanc. Co. Auction By, Annie K. Stoltzfus. Aaron E. Martin Auction Service.

MON. MAY 30 - 9AM, Antique & Collectible Farm Tractors, Parts & Farm Related Items. Located 5 Miles South Of Sunbury, Pa., 1 Mile West Of Route 890 Along Foye Road, Northumberland County. Or From Route 147, 5 Miles North Of Herndon Turn At Young Brothers Garage And Follow Auction Arrows. Owners, Frank D. And Goldie A. Ritchie. Mark J. Jones Auctioneering Service.

MON. MAY 30 - 9AM Antiques, household goods, glassware, antique truck, motorcycles, cars. North of Manchester, Pa turn left on Manchester St. and follow 1/2 mile to sale on left. Watch for signs. Marian Hewitt Estate. Rentzel's Auction Service.

MON. MAY 30 - 9AM, John "Smilie" Keith Memorial Day Sale Of Dolls, Antiques & Collectibles. Located In The Former Reinholds Elementary School Banquet Hall, Rt. 897 In Village Of Reinholds, W. Cocalico Twp. Art Pannebecker Auction Service.

MON. MAY 30 - 9:30AM, Memorial Day Auction Located At J.R. Meats, 1509 Ryan Road, Fallstown, Harford Co., Md Rte. 152 To Oakmont Rd., 6/10 Mi To Ryan Rd., Rt 4/10 Mi. To Sale On Left. Ryan Aucts

MON. MAY 30 - 9:30AM, Antiques Collectibles, Toys & Old Christmas Items. Located At The Mt. Joy Fire Company On New Haven St., Just Off Route 230 In Mt. Joy, Lanc. Co., Pa H Edward Johnson, Auct

Absolute Auction

**Industrial/Commercial
Real Estate**

Friday, May 27 - 1:00 P.M.

Located In Juniata Co. Just Off The Port Royal Exit Of PA State Rt. 322 Midway Between Harrisburg And State College.

22.9144 Acres

Industrial/Commercial Zoning. Tax Map Parcel No. 17/4/45. Complete Industrial Electrical System Installed Penn Dot Approved Driveway Passed Perk At Both Sections Tested 1390' Frontage Bordering On Rt. 75 Permitted Uses. Walker Township, Juniata County: Phone 717-456-9471.

Terms: 10% Deposit - Cash Or Good Check.

Sale Held On Site

Owner, **Del Shank**
Phone 717-436-9471

Bryan D. Imes, Auctioneer
Phone 717-527-2449
AU-001656-L

PUBLIC AUCTION

KENWOOD ESTATES

Building Lots • 2 Tracts of Land

Saturday, June 11, 1994

1:00p.m.

Located in Decatur Township, Mifflin County, PA, along Route 522, 3 miles South of McClure or 11 miles North of Lewistown, PA.

10 Building Lots approved for sand mound septic. After all lots are sold, streets will be paved.

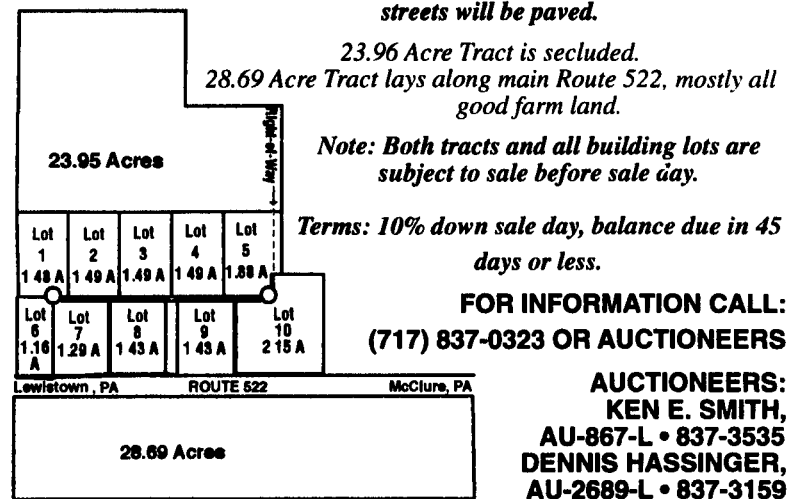

23.96 Acre Tract is secluded.
28.69 Acre Tract lays along main Route 522, mostly all good farm land.

Note: Both tracts and all building lots are subject to sale before sale day.

Terms: 10% down sale day, balance due in 45 days or less.

FOR INFORMATION CALL:

(717) 837-0323 OR AUCTIONEERS

AUCTIONEERS:
KEN E. SMITH,
AU-867-L • 837-3535
DENNIS HASSINGER,
AU-2689-L • 837-3159