

**PUBLIC AUCTION**

**OLEY VALLEY SCHOOL DISTRICT  
OF S/S KITCHEN EQUIP.,  
FARMALL 140 TRACTOR,  
SCHOOL DESKS, CHAIRS &  
SURPLUS ITEMS ON  
SAT., APRIL 2, 1994**

Sale at 10:00 A.M.

To be sold at the OLEY VALLEY MIDDLE SCHOOL. Located off Main St., 1 block W off Rt. 73 at the traffic signal, Village of Oley, Berks Co., Watch for signs.

Traulsen S/S 2 & 3 door refs; Market Forge S/S Steam It & Steam Kettle comb unit; 13' 4" S/S steam & ref serving table; GE 3 burner elec range; GE 3 unit elec oven; Hobart S/S "L" shaped dishwasher unit; Hobart S/S 1/3 HP mixer; Hobart potato peeler; 7 1/2 S/S dbl & triple sink units; S/S table w/sink; 12"x4' S/S exhaust hood; alum cooking kettles; folding cafeteria table/bench units on rollers; cafeteria trays & other kitchen items. **NOTE: ALL EQUIP. WAS IN USE & STILL SET UP IN KITCHEN AREA.**

FARMALL 140 tractor; McC #60 snow blade, Woods L306A rotary mower.

100's of metal leg flip top desks & fiberglass seat chairs; Kdg. to 6th grade; teacher's desks; metal shelves; tables; card catalog drawers; pendant & fluorescent lights; suspended ceiling grid work & tiles; projectors; & other audio/visual & other surplus items.

**TERMS: CASH OR PA CHECK**

**SOLD FOR:**

**OLEY VALLEY SCHOOL DISTRICT**

**FREY AUCTIONEERS**  
AU-000302-L

Refreshments On Premises

**PUBLIC AUCTION**

**OF VALUABLE REAL ESTATE**

Brick Rancher w/Approx. 1 1/4 Acre, Adjoining Approx. 1 1/4 Acre Lot, Antiques, Furniture, Guns, Tools, Books, Coins, Cub Cadet Riding Tractor, Snow Blower, Shredder/Chipper, HO Trains, 1983 Pontiac Station Wagon

**Saturday, April 16, 1994**  
• 8:30 A.M.

Coins: 9 a.m. • Car & Mower: 1 p.m. • Real Estate: 2 p.m.



1163 Penn Grant Road, Lancaster, Strasburg Twp., PA.

Dir.: From Strasburg take Rt. 741 W past Strasburg Menno. Church. Turn left on Penn Grant Rd. Approx. 1 mile, sale on right.

**Real Estate consists of...**

3 Bedroom Brick Rancher situated on 1 1/4 Acre m/l Lot, Closed-in Porch, Living Room, Kitchen w/Modern Cupboards, Dining Room Comb., Lg. Family Room w/Brick Fireplace & Bookshelves, Office Room, Utility Room, 3 Bedrooms, Full Bath, Powder Room, Wall-to-Wall Carpet, Closets Throughout, Electric Ceiling Heat.

Lg. Basement w/Cold Cellar, On-Site Well & Sewer System.

15'x30' Storage Shed w/Electric Partly Finished for Office or Shop - Garage Door w/Auto. Opener, 10'x15' Storage Barn.

**Nice Country Setting.**

Adjoining 1 1/4 Acre m/l Open Lot w/ Evergreens.

Partials will be offered separate and as an entirety. **OPEN HOUSE: Thurs., March 31, 6-8 p.m., Sat., April 2, 1-3 p.m. or call (717) 687-6857.**

**TERMS: 10% down, balance on or before June 1, 1994.**

**ATTORNEY: John R. Gibbel**

**Sale For:**

**Susanna Reitzel**

**MILLER & SIEGRIST AUCTIONEERS**  
(717) 687-6857 • AU-1723L

**PUBLIC AUCTION**

Located 20 mile South of Youngs, Oh. or 15 ml. North of E. Liverpool OH. on ST. RT. 11 to the Lisbon/Rogers Interchange (just 2 ml. East of Lisbon Oh.). Then East on St. Rt. 154 1 mile to Elkton Ohio, then continuing East on Middle Beaver Rd. 1 block to the Elkton Rd. then South 1 block to Eells Poultry farm on

**SAT., APRIL 9th, 1994**  
At 11:00 AM

**REAL ESTATE 112 ACRE  
POULTRY FARM NORTH EAST  
OHIO-COLUMBIANA COUNTY  
ELKRUN TWP-BEAVR LOCAL  
SCH.-ROUTE 11**

Show Date: Wed. Eve. March 23 RD  
From 3:00 to 6:00 PM

**PARCEL #1:** Over 75,000 square feet of buildings, 3 phase electric; 4 water wells; lake; Bld. 1 is 45x530 ft.; Bld. 2 is 50x420 with equipment for 40,000 birds; Bld. 3 is 45x270 w/equipment for 30,000 birds; Bld. 4 is 45x225 ft. storage bldg. with a 45x80 insulated cooler room and 62,000 BTU Burch cooler comp.; Bld. 5 is 30x50 processing bld. with rest room facility; Bld. 6 is 40x100 Butler bld.; Bld 7 is 40x60 pin and frame bank barn; All this is situated on 38.53 acres of land bordering scenic Beaver Creek in Elkton Ohio.

**NOTE:** Although built for poultry, these buildings could be well adapted for many other uses. **PARCEL 2 and 3:** Containing 6.38 and 5.09 acres respectively w/approx. 250 ft. of frontage on Elkton road. **PARCEL 4:** Contains 22.47 acres with active creek and is partially wooded (Excellent log cabin site). **PARCEL 5:** Contains 8.97 acres with approx. 600 ft. of frontage on Elkton road. **PARCEL 6:** Contains 30.76 acres with 100 ft. frontage along Elkton road (another excellent log cabin site).

**Auctioneers note:** Real Estate will be offered in parcels, combination of parcels, (ie: parcels 1-4 and parcels 5 & 6), and as a whole farm to be sold the method bringing the most. Real Estate sells at 12:00 sharp!

**TERMS ON REAL ESTATE: 15% down payment day of sale. Balance upon delivery of deed and guarantee title. This property will sell to the highest bidder without reservation.**

**FARM MACHINERY**

1987 Case International diesel tractor; model 2294, 4WD, 130 hp, cab, air, 540 and 1000 pto, front weights, app 2000 hrs.; 1979 International model 886 diesel tractor, 85 hp, 4440 hrs. black stripe w/partial cab; Owatonna 440 Mustang skid steer loader w/dirt and manure buckets; Taylor Way 12 chisel plow; 1989 Kent 12 ft. discovator; Miller 12 ft. offset disc used very little since rebuild; 1986 International model 50 12 ft. stalk shredder; Deutz model 385 4 row no till air planter with dry fertilizers, insecticide applicators, and seed monitors; 2 Allis Chalmers model 333 no till air planters with dry fertilizers, insecticide applicators and seed monitors; 1987 Knight 1500 gal. slinger manure spreader; 1984 Knight 2500 gal. slinger spreader. Winpower pto-60 KW 1000 RPM generator; Unverferth hyd auger; Ski Doo 340 snowmobile; Lincoln 225 amp welder; 12-5 shelf carts; Model 34 Burn Easy Incinerator 80 to 95 lb./hour cap.; Harris cutting torch set; 8 ft. 3 pt. hitch blade; 17-48 inch fan blades w/pulleys; 12" side extension and tarp hoops for L.H. dump;

**Note:** Not many misc. items be on time.

**GRAIN HANDLING  
EQUIPMENT  
GLENER N-5 - BINS -  
GRINDER MIXER -  
GRAIN DRYER**

1984 Glenner model N-5 combine with 4 row 38 in. corn head, 15 ft. flex grainhead, 1550 thresher hrs. 2000 combine hrs. complete with all the extras (TO BE OFFERED SEPARATELY AND TOGETHER); Continuous Mix-Mill Inc. grinder-mixer with 4-20 ton bin tower; Parker model 6000 - 400 bus. tandem axle grain buggy pto auger with hydraulic swing; new 15 ton feed bin; 2 used 15 ton feed bins; 1975 International Fleetstar 2010 tandem axle truck with 20 ft. Midwest (7 yrs. old) grain body with 2 cylinder hoist and 534 cu. in. gas engine; 3-22000 bu. bins; 42000 bu. bin; 8000 bu. bin; 6000 bu. bin w/dryer and stirrator; Kan Sun continuous flow 300 bu./hour dryer; 2000 bu. bin; 12 ft.-8" bin sweep auger w/motor; 2-16 ft. - 4" bin sweep auger; 20 ft.-6" bin sweep auger w/motor; Hance 90 ft. grain elevator leg complete with down spouts (Note: GRAIN BINS WILL SELL AFTER REAL ESTATE)

**EELLS POULTRY FARM  
INC. Owners**

Lunch On The Grounds

**TERMS: CASH OR GOOD CHECK.**

Jim Baer, Auctioneer/Realty (216) 227-3236  
Ken Baer, Auctioneer  
Bill Baer, Auctioneer  
Gordon Koehler, Auctioneer/Salesman  
Mark Harding, Auctioneer

**JIM BAER**  
Auctioneer & Realty

**Public Auction Register**

Closing Date Monday 5:00 P.M.  
of each week's publication

SAT. APR. 23 - 9AM Tractors, combines, farm equip. riding mowers, car, misc. Southern York Co., Pa. From I-83 exit #2 (Glen Rock) follow Rt. 216W ±3.2 mi to sale on left. Owner:

Delores (Debbie) Dehoff. Melvin Haines, Ralph Breneman, Russell Wright, auct.

SAT. APR. 23 - 9AM, Real Estate, Household Goods,

**Farmersville Fire Company  
Incorporated 1948  
FARMERSVILLE,  
LANCASTER COUNTY  
PENNSYLVANIA**

**19th ANNUAL  
FARMERSVILLE FIRE  
COMPANY**

**COMMUNITY SALE  
THURS., MARCH 31, 1994**

At 4:30 P.M.

**New and used furniture - new  
local handcrafted wood furniture  
-handmade toys.**

**Quilt Sale**

App. 7:00 P.M.

Approximately 100 Quilts: Irish Chain, Sam & Sue (crib), Log Cabin, Trip Around the World, Lone Star, Log Cabin Basket, Nine Patch Crib, Double Wedding Ring, Oh My Stars w/H, Little Dahlia, Patch Work, Boston Commons, Crib & Pillow etc., Dahlia on Parade, Fence Rail & Hearts, 1 white Queen size Pineapple, 1 Queen Kansas Wheat Comforts, Pillows, Crib quilt, Printed fabric quilts, Dolls, Wall hanging, Crafts.

Tobacco spears, Tobacco sizing box, Ertel Lancaster 250th Anniversary Horse & Wagon, Winross-J.D.M. Duffie, Brunnerville Fire Co. tanker, Park City 1993, Iron 12 place plant stand with 12 clay pots, Pair of Hand Forged Stirrup, Meat hooks, Tire irons, #6 watering can, Rotary mowerblades, Old glass top jars (some blue), PRR pick, #8 iron pot skillet, New Poulan PRO #195 trimmer.

**Donated items appreciated. Donated baked goods and food items (no food sold on commission). Items too numerous to mention.**

**Terms: Cash or good check. All out of state buyers paying by check must have letter of credit addressed to this specific auction.**

For information call

354-9174, 354-5835 or 733-3926.

Not responsible for any type of accidents.

Lunch by the Farmersville Ladies Auxiliary.

**HORST AUCTIONS.**  
T. GLENN AU438L  
TIMOTHY G. (717) 859-1331 • (717) 738-3080  
THOMAS A. Fax # (717) 738-2132  
"VOICES OF EXPERIENCE"

**AUCTION**

**REAL ESTATE and CONTENTS**

**SAT., APRIL 9th at 9:00 AM**

Real Estate Sold at 12 Noon

Selling for the estate of Vernon Snyder.

**LOCATION:** Tulpehocken Twp. Berks Co., PA From I-78, take exit #6, go south on Rt. 419 about 2 miles. To crossroad, turn left to sale on right. Half way between Strausstown and Rehersburg. Watch for auction arrows.

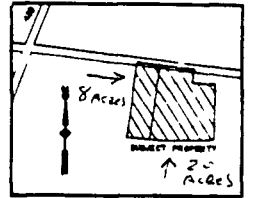

**REAL ESTATE** 1 1/2 story house, with kit. L. R m, office, laundry on 1st floor. Upstairs has two bedrooms. & full baths, oil hot water heat, own well & septic system. Property also has a bank barn, 3 car garage, two story summer house, other buildings on property. Never failing spring. For appointment, call Mrs. Snyder at (717) 933-8519 or auctioneer at (717) 933-5736. **NOTE:** Property will be offered as 8 acre tract & then 20 acre tract, then property will be offered as one parcel. **TERMS:** 10% down day of sale, bal. in 45 days or less.

10" Craftsman table saw, bench vise, bench grinder, storage bin, c-clamps, forks & shovels, butcher top bench, SS table, misc. nuts & bolts, brass fittings, 25 cu' chest freezer, pipe wrenches, like new wheelbarrow, masonry tools, weedwacker, elect chain saw, Craftsman drill, sander, jig saw, hand saws, hatchet, tin snips, levels, window fans, log chains, chicken catchers, chicken crates, cast iron water trough, elect fence chargers, JD #140 riding mower, JD snow blade for mower, JD #80 garden trailer, Parker lawn sweeper, misc. lumber, step ladder, turkey items, floor model safe, two hole com sheller, Rem 22 pump mod. 21, Rem. 410 mod. 11-18, Old wicker doll coach, child's wicker rocking chair, 2 cedar chests, wood chest drawers, old peanut dolls, old hand painted etched egg, 1883 & signed, file cabinet, oak office chair, old redware plate, few carnival pcs, green depression glass, old pictures & frames, wooden benches, Zenith floor model radio, oak flat top desk, oct. shape cement flower stand w/stain glass, assorted coins, davenport pcs many other misc. items to be sold, don't miss this auction.

**Note:** If you are looking for a nice farmette, take a look at this one.

**Auction For MABEL SNYDER**

Auctioneer AU-2414-L  
Dwight D. Miller AU002414L Call (717) 933-5736  
Terms: Cash or PA Check.

