

# BUY, SELL, TRADE OR RENT THROUGH THE CLASSIFIED ADS

PHONE: 717-626-1164 or 717-394-3047

FAX 717-733-6058

Mon., Tues., Wed., Fri. 8 AM to 5 PM; Thurs. 7 AM to 5 PM

## CLASSIFIED AD ORDER BLANK

PLEASE WRITE CLEARLY

MAIL TO:

**LANCASTER FARMING**  
P.O. Box 609, Ephrata, PA 17522

PLEASE CALL OUR CLASSIFIED AD DEPT. IF YOU WANT TO ADVERTISE A DISPLAY BOX IN OUR PAPER.

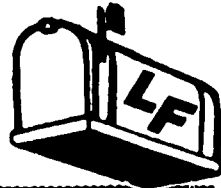

NOTE: Please do not use this form for Mail Box Market Ads, see instructions with Mailbox Markets.

Name \_\_\_\_\_  
Address \_\_\_\_\_  
City \_\_\_\_\_ State \_\_\_\_\_  
Zip \_\_\_\_\_ Phone (\_\_\_\_) \_\_\_\_\_

### CLASSIFIED ADVERTISING RATES

38¢ per word per week - 1 or 2 times  
32¢ per word per week - 3 or more times  
11 word minimum

Words	1 Time	2 Times	3 Times
up to 11	4.18	8.36	10.56
12	4.56	9.12	11.52
13	4.94	9.88	12.48
14	5.32	10.64	13.44
15	5.70	11.40	14.40
16	6.08	12.16	15.36
17	6.46	12.92	16.32
18	6.84	13.68	17.28
19	7.22	14.44	18.24
20	7.60	15.20	19.20

Please publish my \_\_\_\_\_ word ad \_\_\_\_\_ times starting with the \_\_\_\_\_ issue. Classify under # \_\_\_\_\_ I enclose \_\_\_\_\_

Box Replies: Ads with answers coming to a box number, c/o Lancaster Farming: \$1.50 per ad per week additional.

This newspaper will not be responsible for more than one incorrect insertion of any advertisement.

**DEADLINES:**  
SECTION C - WEDNESDAY AT 5:00 P.M.  
SECTION D - THURSDAY AT 9:00 A.M.  
OF EACH WEEK'S PUBLICATION

1	2	3	4	5
6	7	8	9	10
11	12	13	14	15
16	17	18	19	20
21	22	23	24	25
26	27	28	29	30
31	32	33	34	35
36	37	38	39	40

(Phone Numbers Count As One Word)

Lancaster Farming  
1 E. Main St.  
Ephrata, Pa. 17522  
717-394-3047  
or LITIZ  
717-626-1164  
FAX 717-733-6058

PHONE HOURS:  
Mon., Tues.,  
Wed & Fri  
8 a.m. to 5 p.m.  
Thurs.  
7 a.m. to 5 p.m.

OFFICE HOURS:  
Mon thru Fri.  
8 a.m. to 5 p.m.

The following categories are available for your classified advertising:  
In Section D, Deadline: Thursday morning at 9 of each week's publication  
1 Farm Equipment  
2 Farm Eq. Wanted

The following categories are available in your classified advertising in Section C, Deadline: Wednesday afternoon at 5 of each week's publication

- 1a Construction Equipment
- 3 Silos and Unloaders
- 4 Building and Supplies
- 5 Grain Equipment
- 6 Dairy Equipment
- 7 Livestock Equipment
- 8 Cattle
- 9 Horses & Mules
- 10 Sheep & Goats
- 11 Swine
- 12 Artificial Breeding
- 13 Hog Eq. & Supplies
- 14 Poultry & Supplies
- 15 Feed & Seed
- 16 Fertilizer
- 17 Plants
- 18 Fruits & Vegetables
- 19 Nursery
- 20 Lawn & Garden
- 21 Services Offered
- 22 Custom Work
- 23 Help Wanted
- 24 Situations Wanted
- 25 Business Opportunities
- 26 Household
- 27 Pets
- 28 Lost
- 29 Found
- 30 Computers
- 31 Notice
- 32 Miscellaneous
- 33 Recreational Vehicles
- 34 Autos
- 35 Trucks & Trailers
- 36 Real Estate

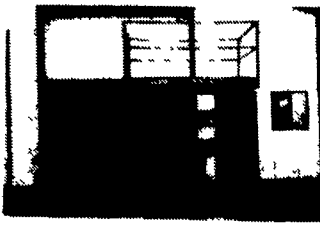

18' Platform Lift  
\$2,800



Vermeer 454A Ditcher  
w/Deutz Diesel, Good  
Condition  
\$6,800



Hyster 60' man lift with  
Deutz diesel, good  
condition, 2000 hours



1986 580 Super E Tractor,  
Loader, Backhoe With  
Extendahoe With Cab & Air,  
Nice



1986 Case 450C Crawler  
w/6 way blade, 1280 Hr.,  
U/C Excellent  
\$23,000



1987 Kawasaki 3800 Hr.  
In Excellent Condition

We Buy & Sell  
Financing Or Lease Purchase Available

### AA Equipment

1797 Robert Fulton Hwy., Quarryville, PA 17566

717/529-2512

No Sunday Call

### 1a CONSTRUCTION EQUIPMENT



Route 206 North, P.O. Drawer E  
Newton, NJ 07860 (201) 383-3370

Outside NJ 1-800-545-1278

Toll Free NJ (Parts) 1-800-382-9207

JD FINANCING AVAILABLE TO QUALIFIED BUYERS

FAX: 201-383-5756

### CRAWLER DOZERS

1973 Dresser TD20C, 75% bottom Tilt Blade	\$17,500
1969 JD 350 dozer, 6 way, ROPS	\$9,500
1988 JD 750B w/Cab, 1900 Hrs.	\$48,000
1987 JD 750B w/ROPS, 1950 Hrs.	\$42,000
1988 JD 450G, 6 way blade	\$35,000
1990 JD 450G, WT, 24" pads, 6 way, 600 hrs.	\$50,000
1990 JD 550G, WT, 24" pads, 6 way, 620 hrs.	\$54,000
1992 JD 550G 6 way blade, 510 hrs.	\$58,000

### 4 WHEEL DRIVE LOADERS

1981 JD 544C, cab, 6415 hrs., 2.70 yd. material bucket, rebuilt trans.	\$33,500
1985 JD 544C w/cab,	POR

### WHEEL LOADER BACKHOES

1988 JD 310C cab, 4x4, 2400 hrs.	\$35,000
1990 JD 310C cab, low hrs.	\$36,000
1992 JD 310D w/cab, 4x4, extend-a-hoe, 700 hrs.	\$47,500
1977 JD 410 cab, rebuilt engine	\$14,000
1988 JD 410C cab, 4x4, 3400 hrs.	\$37,000
1986 JD 415B, 4x4, ROPS, aux. plumbing	\$18,500
1987 JD 410C w/cab, ext. dipper, 2280 hrs.	\$32,500
1967 JD 500, good condition	\$8,500
1987 JD 510C w/cab, 4x4 extendable dipper	\$38,500
1985 JD 515B with cab & side shift Backhoe aux. Plumbing	\$19,500

**SAKAI  
TRAIL KING  
TRAMAC  
MUSTANG**



Want To Buy  
John Deere  
Equipment -  
Any Model

### WHEEL TRACTOR

1985 Bradco (Ford 1910) Loader Backhoe 4WD	\$13,500
1988 JD 950, 600 Hrs., 4" Sold Tire	\$9,000

### CRAWLER LOADER

1978 JD 555 w/9300, backhoe	\$23,500
1980 JD 555, ROPS, 4&1 bucket	\$16,000

### HYDRAULIC EXCAVATORS

1988 JD 490D Long Stick, 28" Pads, New U/C	\$51,000
1975 JD 690B good Sold on	\$22,000
1989 JD 490D, 1600 Hrs.	\$55,000
1990 JD 590D, long & wide, 2300 hrs	\$69,000
1987 JD 790, Clean, New U/C, aux plumbing	\$65,000
1988 JD 70D w/blade, long stick, 2315 hrs	\$32,000

### AGRICULTURAL & MISCELLANEOUS

Toyota skid steer loader buckets	POR
RM Denico Sprayer, like new, 3 pt. 21' Boom	\$1,000
New JD 350 Crawler Loader Series 4-1 Bucket Replacement clam and back	\$1,500
JD 603 Rotary cutter	\$700
3 Yd. 444E Material bucket, new	\$2,400
New York Rake RW 7' wheels & blade	\$1,600
(3) Stanley MB 550 hammers	\$5,000/ea

### TRAILERS & TRUCKS

1968 Mack R Tractor 237/5 Speed	\$5,500
1988 25 Ton Ridgid Eager Beaver Trailer	\$9,000
1984 F350 Reading Utility, Sold Diesel	\$4,200
Eager Beaver 10 ton electric brake	\$4,200
1972 Eager Beaver 18HA	\$5,500
(2) Tag-a-Long Trailers	Make Offer
Mighty Mover Landscape Trailer, 2 axles, long bed	\$1,700
1975 Gas International 1600 ract Sold truck	\$2,000

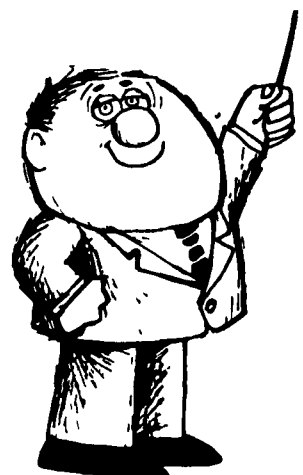

A LESSON  
WELL  
LEARNED...  
LANCASTER  
FARMING'S  
CLASSIFIED  
ADS  
GET RESULTS!