

Public Auction Register

Closing Date Monday 5:00 P.M.
of each week's publication

AUCTION JEWELRY-RARE COINS VINTAGE SPORTSCARDS COMICS

SUN., MARCH 13, 1994
1:00 P.M.

At Holiday Inn, Rt. 63 & Exit 31 Pa.
Turnpike, Lansdale, PA.
Inspection 12:00 PM & Throughout
Auction.

JEWELRY- Over 275 lots of closeout jewelry. Womans rings, earrings, bracelets, necklaces, mans rings, etc. 10 & 14 kt gold, emerald, ruby, diamond, topaz, amethyst, etc. Many beautiful styles. All brand new, all must go. Don't miss this chance to buy jewelry at auction, where you set the price. All items as seen on T.V. home shopping shows.

COINS- 1904 Proof Morgan Dollar, BU 1933s Half Dollar, 1859 Proof Quarter, U.S. Gold Coins, Commemoratives, A great selection Half Cents To Gold. Very Worthwhile. We sell more coins at auction more often than anyone else in the area.

SPORTS CARDS & COMICS- Many cards from 1935-1977. Most are early issues. Several Rookie Stars. Comics include early X-Men, Amazing Spiderman, Etc.

A total of over 675 items will be offered at this auction! Don't Miss It!

Terms Cash, 10% Buyer Premium,
Request Free Catalog.

Consignments always accepted for future auctions. If you have coins to sell, get the best price by selling at auction. Low Rates-FAST PAYOUT!

Christian Hubscher Auctions
P.O. Box 500 - Souderton, PA 18964
(215) 257-3001 Pa. Lic. AU1465L

THURS. MAR. 31 - 1:30PM. (Due To Easter Lamb & Goat Sale). State Graded Feeder Pig Sale. Located At Carlisle Livestock Market, Inc. Exit 12 South Off I-81. Left Onto Alexander Spring Road. (717) 249-4511.

THURS. MAR. 31 - 4:30PM. 19th Annual Farmersville Fire Company Community Sale. Located Farmersville Fire Company.

APRIL
FRI. APR. 1 & SAT. APR. 2 - Large Upcoming Auction.

Annual Spring Western Maryland Contractors Auction. Located Cochran Auction Complex, 4 Miles South Of Exit 35 Off Interstate 70 Along Maryland Route 66 South. Cochran Auctions & Associates, Ltd.

FRI. APR. 1 - 9AM. Split Level Dwelling, Real Estate, Fine Antiques. Located At 563 Hiview Dr. (Hiview Estates), Midway Between Litz & Marheim, Just Off Doe Run Road, Onto Audrey Dr., Onto

Hiview, Penn Township, Lancaster Co., Pa. Terms By, Elwood "Woody" Funk & Mariene Funk. Horst Auctions.

FRI. APR. 1 - 1PM & SAT. APR. 2 - 9AM Valuable antiques, household goods, garden supplies & tools, 25 yr. collection of fine antiques. 2691 Old Phila. Pike (Rt. 340) Bird in Hand, across from Bird in Hand Post Office, Lanc. Co., Pa. By Robert B. Good, Robert E. & Jeffrey R. Martin, aucts.

SAT. APR. 2 - Consignment sale by Messick Farm Equipment. Rheems Exit

Lancaster Farming, Saturday, March 5, 1994-E25

Rt. 283, Elizabethtown, Pa.

SAT. APR. 2 - Located 5 mi. West of Mifflinburg, 1 mile N. off 45 @ Hartleton, Pa. Union Co. Selling Shop Equip., tools & farm machinery. Mrs. Ned Shively, owner. Wayne Hees & Lori Hess Lauer aucts.

SAT. APR. 2 - Kling's Annual Consignment Auction. Selling Farm Machinery - Livestock - Horses - Construction Equipment - Building Supplies And Other Items. Located Landisburg, PA. Call 789-3883 For Advertising And Rates.

Managed By Kling's Auctions, Inc.

SAT. APR. 2 - 9 AM Annual Manheim Farm Show Benefit Auct. John D. Stauffer, auct.

SAT. APR. 2 - 9AM Spring consignment auction, tractors, farm equip., lawn & garden tools. At Isenrock Auctions, New Park, Pa.

SAT. APR. 2 - 9AM Antiques, household goods, tools, 177 Smithville Rd., New Providence, Pa. Take Rt. 272 from Lanc. 7 miles, turn left on Byerland Church Rd., 1 mile to sale. Terms by Harry Denlinger, Kreider, Kline & Good aucts.

SAT. APR. 2 - 9AM Large farm equip. 146 Jacobstown-Cookstown Rd., Wrightstown, NJ Norman Parker Farm. Lee Parker, auct.

SAT. APR. 2 - 9AM, 12.3 Acre Farmette, 2 Dwellings, Bank Barn, Ford Tractor, Tools & Household Goods. Located At 1614 Division Highway, Rt. 322, Narvon (Between Blue Ball & Honey Brook), East Earl Township, Lanc. Co., Pa. Terms By, Edwin Siedhof Estate. Horst Auctions.

SAT. APR. 2 - 9:30AM, Antique Tractors & Loaders, Hay Equipment, Tillage Equipment, Etc., Butchering Equipment, Truck, Cattle Equipment & Misc. Located Moved For Convenience Of Sale, To Spring Meadow Farm On Rt. 97, 1 Mile South Of Rt. 70 in Howard County, Md. Sale On Left 1/2 Mile After The Intersection Of Rt. 144 And Rt. 97. There Will Be Sale Signs Posted. Estate Of Pauline & Francis Hill. Ridgely's Auction Service.

SAT. APR. 2 - 9:30AM, Rest. Equip., Antiques, & Household Goods. Located Mill Hill, Pa. Owner, Ellis Warner. Aucts. Ron Gilligan & Son #AU339-L & AA2223L.

SAT. APR. 2 - 9:30AM Inventory Reduction Sale Tractors, farm machinery, industrial machinery, other machinery. Marshall Machinery, Rte. 652 6 miles E. of Honesdale, Pa 717-729-7117.

SAT. APR. 2 - 10AM, Real Estate 26 Acre Farmette, Feeder Cattle, Machinery & Some Household. Located in Huntingdon Co., 2 Miles West Of McAlveys Fort, Pa., Or 12 Miles East Of Petersburg, Pa., Along Route 305. Owners, John & Ella Mae Kauffman. Mark Glick & Dale Gibboney, Aucts.

SAT. APR. 2 - 10:30 AM Tractors, silage & ground equip. Walkersville, Md. Mr. & Mrs. Clarence "Dick" Wolfe, Jr., owners. Trout aucts.

PUBLIC AUCTION OF 13.6 ACRE FARMETTE PLUS THREE BUILDING LOTS HOUSEHOLD GOODS AND TOOLS

FRI., MARCH 11, 1994

At 9:00 A.M., Real Estate At 12:30 PM
Location 2 miles north of Mifflinburg, on Buffalo Rd. from Lewisburg take Route 45 West to Mifflinburg turn right, at Coastal Mart, 2 miles to sale site, West Buffalo Twp., Union County, Pa.

REAL ESTATE

13.6 Acre Farmette Plus Three Building Lots, Ready To Build

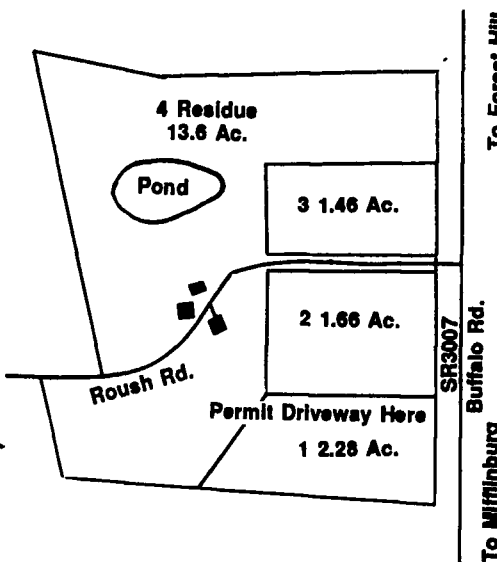

Lot #1 2.28 Acre; Lot #2 1.66 Acre; Lot #3 1.46 Acre. Will be offered separate or all together.

Building on 13.6 acre, 2 1/2 story brick house with 2 car garage, FIRST FLOOR, living room, dining room, kitchen with range, dishwasher, refrigerator, carpets, 1/2 bath, laundry, sun porch, 200 amp elec. service. SECOND FLOOR 3 bedrooms w/closets, 1 full bath, walk in closet, hot air oil heat, 2 good wells. Note: House in real nice condition.

Outbuilding with elec. and water 40x60 bank barn, good cond.

Pond, in meadow, fruit trees. NOTE: Would make a nice horse farm, nice country setting.

HOUSEHOLD GOODS

Breakfast set, table, 4 chairs, rocking chair, dresser, old cupboard with flour bin, odd ends, materials, 750 Sharp copying machine good condition, nice 10'x14' produce stand, plus produce goods, etc.

FARM MACHINERY AND TOOLS

10' transport disc 3 pt. 3 bottom plow, 2 row McCormick corn planter, small trailer, etc. 12' MGS 4000 GVWR dual wheel trailer.

TOOLS AND CARPENTRY SUPPLIES

10' Tapco Pro-II alum. brake, Hilti screw shooter, Porter Cable drill, 1 Black & Decker 13 volt cordless drill, 1 Ryobi 12 volt cordless drill, Paslode framing nailer, Senco framing nailer, Pole jacks, 10" Delta miter saw, 50,000 BTU master heater, 2 white side boxes for pickup trucks, rack for truck, job boxes, rolls of 24" coil stock, windows, cabinet, insulated doors, rails for siding doors, 110' peg board wall shelving, 22x28 Velux br. skylight w/flashing kit, casement windows, 2-10x10 steel insulated row up doors w/openers. Lumber, Paint, nails, etc.

AUCTIONEER NOTE: TERMS 10% due at auction, balance 30 days, Open House. Inspection of property by appointment or Open House Feb. 26 or March 5 1 to 4 PM For land plotting and details, call auctioneer 717-656-8793 or owner 717-966-3750.

Sale Order: Tools, Farm Machinery 9:00 AM and household goods 12:30 Real Estate.

Terms by

LUKE &

KATHRYN SHIRK

717-966-3750

Auction Conducted By
C.W. Shirk Auction Service
Lic. #2750 Ph. 717-656-8793

Not Responsible For Accidents
Food At Auction

J. Robert Meyers AU-000-801L Auctioneer
Smith & Blattenberger, Clerks

PUBLIC SALE

**Farm Equipment, Milking
Equipment, Feeding Equipment,
Feed and Household Items**

To be held at 1793 Hykes Road,
Greencastle, Franklin Co. Pa. 4 mile
South of Greencastle on Route 11 to
Jear-Dan sign turn east on Hykes Road
to farm. If on Route 81 get off at Exit 2.
Signs will be posted.

Sat., March 26, 1994

12 Noon

Farm Equipment - Massey Ferguson tractor Model 65 diesel wide front end with industrial loader; AVCO New Idea uni system complete as follows- 708 tractor with 3424 hours, 717 combine, 740 throat, 713-S soybean grain head, 767 super chopper with throat, 766 grass pickup head, 768 wide-narrow 3 row corn cutter head, 737 husker, 744-W 4 row 38" snapper, this outfit was always shed kept. Massey Ferguson chisel plow; Massey Ferguson model 880 4 bottom automatic reset plow; MF 880 plow for parts. John Deere model 210 disk; Farnall H tractor; 36 ft. New Holland bale elevator; Gehl model 99 high throw blower; HI Co-PTO 5 ft. Bush Hog; field sprayer; 3 PH scraper blade; wagons; one with hay racks; air compressor; Ford 3 PH 2 row cultivator; high pressure washer; assortment of small items; etc.

Milking Equipment - Surge pacemaker pulsation control; 10 Surge direct action alternating pulsators, 10 Randsels for parts only; 5 Surge low profile siphon breaker cups; 3 inch stainless low line with receiver; 5 older style Surge siphon 84-84F with breaker cups; Surge 100 plus vacuum pump; double 5 (10 stalls) sawtooth herring bone parlor with stainless steel feeders; 10-Big Dutchman feeders with timers; conveyors and feed bin; stainless steel wash vat; Surge electrobrain all liquid pipeline washer; Girton 850 gallon milk tank with a new 4 HP compressor; Electrobrain dial pipeline washer; Surge pail milkers; 2 DeLaval milk meters; etc.

Feeding Equipment - Acorn 24 ft. silo unloader; Badger conveyor with motor; Badger shuttle feeder with motor; etc.

Feed - Corn silage; mixed hay; etc.

Household Items - Surge gran premier water softener; Norge 30" electric stove; GE 20" electric stove; coal & wood heatrola; 2 furnaces; 1 oil fired hot air, 1 gas fired hot air with duct work; Massey Ferguson Model 85 riding lawn mower; etc.

Auctioneer Note: This is reduction sale of good items. The New Idea System will be offered separately and as one unit. The household items will start the sale. Be here early, not many small items.

Terms: Cash. Out of state or area must have bank reference.

PHILIP & ANNA KENNEDY
717-597-8723

Public Auction

**THURSDAY,
MARCH 31, 1994**
1:00 P.M.

185 ACRE FARM REAL ESTATE

LOCATION: Route 2 Anville, N. Anville Twp., Lebanon Co., Pa. From Rt. 422 In Anville - N. on Rt. 934 for 3.7 miles to Bellegrove - at Y bear left onto Blacks Bridge Road - appx. 1 mile to sharp left turn to first farm on right. From I-81 Exit 29 Fort Indiantown Gap - South on Rt. 934 for 3.7 miles to stone church on left - turn right onto Hostetter Lane to Blacks Bridge Road- turn right to farm on the right after sharp curve.

FARM REAL ESTATE - 185+/- acres with over 1 mile of road frontage on Rts. 934, Blacks Bridge Rd. & Snyder Road. Gently rolling to level land w/some contour farming in various stages of cultivation. Large frame bank barn w/stalls for 45 cows - milkhouse - silo - various asst. frame storage buildings. Spring fed stream. Large 2 1/2 story 3 bedroom frame house w/no central heat.

A tremendous opportunity to purchase a large tract of farm real estate. Call auctioneer or owner for inspection appointment.

10% down payment auction day w/balance due at settlement within 90 days.

John D. Enck, Attorney
(717) 272-7637

Auction by
HERBERT NAGLE
(717) 867-1317

HARRY H.
BACHMAN
AUCTIONEER
138 College Avenue-Anville PA 17003
(717) 867-1809