

WHITE MOUNTAIN Freezer Parts

HAND CRANKED

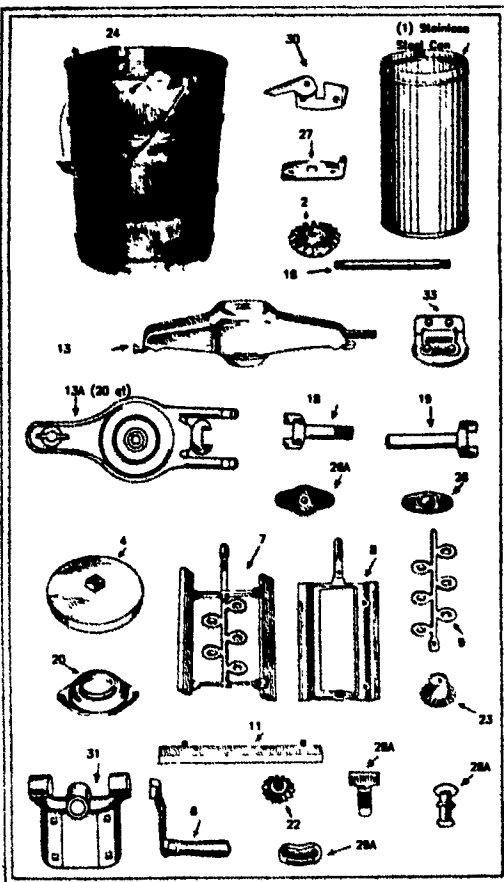

Part No.	Description	2	4	6	8	10	20
1	Can	27.41	33.28	38.42	46.88	88.85	375.71
4	Can, Cover	18.15	24.81	28.74	36.00	58.99	120.22
6	Crank	9.38	15.97	15.97	22.81	22.81	58.90
7	Dasher, Single Piece		22.94				168.11
8	Dasher, Outer with Scrapers	17.37	22.81	31.77	36.81	62.32	
9	Dasher, Inner	7.89	16.46	17.37	18.03	28.38	
11	Dasher, Scrapers (pair)*	7.50	9.87	11.25	12.46	17.01	23.06
11a	Dasher, Scraper, Holder, each*						10.41
13	Gearframe, Complete with gears	31.82	42.66	45.80	76.96	107.21	457.88
14	Gearframe, Skeleton, no gears	26.98	36.25	42.00	64.44	82.87	282.58
16	Gearframe, Crank Shaft	5.46	14.74	14.74	17.67	17.67	40.98
17	Gearframe, Clutch only, each*						15.62
18	Gearframe, Gear Shaft & Clutch						55.97
19	Gearframe, Crank Shaft & Clutch						55.97
20	Gearframe, Lower Bearing	10.84	10.84	10.84	16.16	16.16	42.96
21	Gearframe, Bottom Gear	18.34	18.34	18.34	23.96	23.96	46.90
22	Gearframe, Shaft Gear	19.48	19.48	19.48	20.99	20.99	41.26
23	Gearframe, Top Gear	19.48	19.48	19.48	27.41	27.41	60.81
24	Tub, Complete with fittings	38.91	40.96	44.96	53.06	55.90	325.25
25	Tub Bail Handle with wood grip	5.32	6.96	6.96	9.08	11.25	
26	Tub Center	5.39	5.39	5.39	5.39	5.39	15.13
27	Tub Ear (steel)	7.99	7.99	7.99	7.99	7.99	
28	Tub, Frame Button						19.72
28a	Tub, Frame Button Holder						24.99
28b	Tub, Frame Button Back Plate						6.66
30	Tub, Latch (steel)	9.20	9.20	9.20	9.20	9.20	
31	Tub, Hanger (tub)						84.44
32	Tub, Hanger Pivot Screws, each						20.88
33	Tub, Handle Comp-each						11.25

* These parts not illustrated

When ordering, please specify part number and description, size of freezer and the part number on the underside of the gear frame and the number on the cover. Cans are shipped without covers. Can covers are ordered separately.

ELECTRIC MODELS

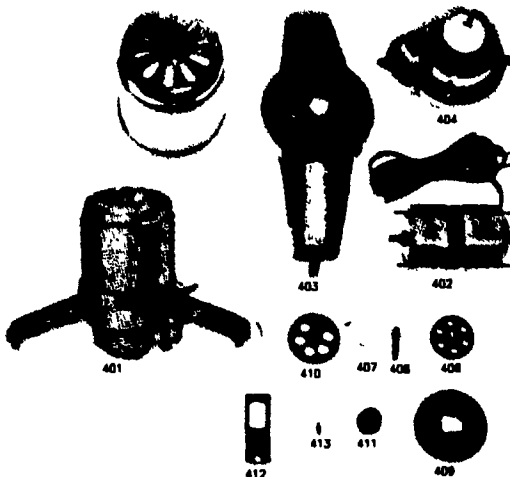

You may also order the #401 motorizing unit only for your 6 quart hand freezer

Part No	Description	Price 2-Qt.	Price 4-Qt.	Price 6-Qt.
1	Can	27.41	33.28	38.42
4	Can Cover Lid (Aluminum)	18.15	24.81	28.74
8	Dasher, Outer with Scrapers	17.37	22.81	31.77
9	Dasher, Inner	7.89	17.96	17.37
11	Dasher Scrapers (pair)	8.18	9.87	11.25
24	Tub, complete with fittings	38.91	40.96	44.96
25	Tub Bail Handle with wood grip	5.32	6.96	6.96
26	Tub Center	5.39	5.39	5.39
27	Tub Ear (steel)	7.99	7.99	7.99
30	Tub Latch (steel)	9.20	9.20	9.20
401	Motorizing Unit Complete	76.96	76.96	76.96
402	Motor	54.57	54.57	54.57
403	Unit Frame Blank	26.98	26.98	26.98
404	Unit Gear Housing	18.76	18.76	18.76
405	Unit Steel Hood	13.01	13.01	13.01
406	Top and Cluster Gear	16.40	16.40	16.40
407	Top Retaining Ring	2.66	2.66	2.66
408	Stud for Top and Cluster Gear	5.57	5.57	5.57
409	Main Drive Gear	24.51	24.51	24.51
410	Intermediate Gear with Pinion Rod	21.12	21.12	21.12
411	Dasher Hub Section Holder	8.31	8.31	8.31
412	Dasher Holder Steel Strap	6.05	6.05	6.05

All prices now include shipping and handling - no extra charges
Please use the Order Blank on page 2. Most 6 quart parts are in stock. Other sizes may take up to 3 weeks for delivery. No C.O.D.'s on White Mountain Parts. Payment must be sent with order. Minimum order is \$10.00.

Andy H Weaver

16891 Farmington Road
West Farmington OH 44491

Phones: (216) 548-8799 & 548-2231
TOLL FREE ORDER LINES:
1-800-882-8799 or 1-800-768-5518