

# WHITE MOUNTAIN Freezer Parts

HAND CRANKED

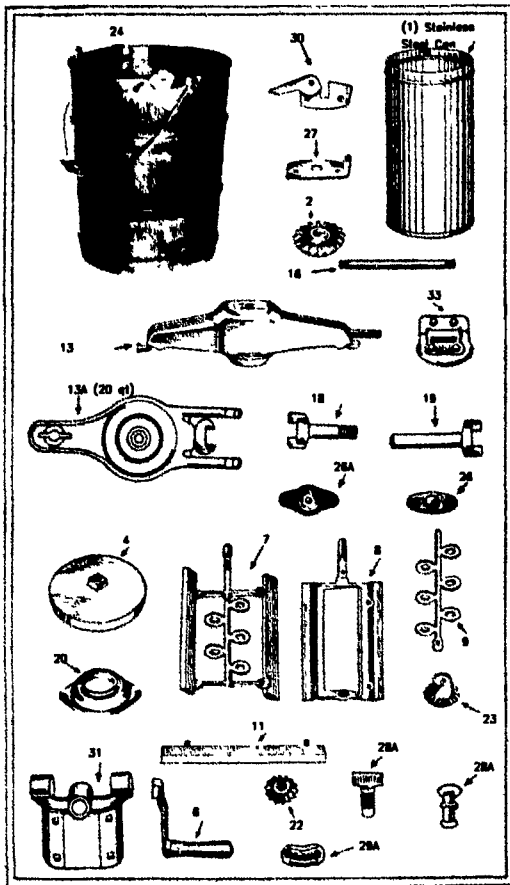

| Part No. | Description                     | 2     | 4     | 6     | 8     | 10     | 20     |
|----------|---------------------------------|-------|-------|-------|-------|--------|--------|
| 1        | Can                             | 27.41 | 33.28 | 38.42 | 46.88 | 88.85  | 375.71 |
| 4        | Can, Cover                      | 18.15 | 24.81 | 28.74 | 36.00 | 58.89  | 120.22 |
| 6        | Crank                           | 9.38  | 15.97 | 15.97 | 22.81 | 22.81  | 59.90  |
| 7        | Dasher, Single Piece            |       | 22.84 |       |       |        | 185.11 |
| 8        | Dasher, Outer with Scrapers     | 17.37 | 22.81 | 31.77 | 38.61 | 62.32  |        |
| 9        | Dasher, Inner                   | 7.69  | 16.46 | 17.37 | 18.03 | 28.38  |        |
| 11       | Dasher, Scrapers (pair)*        | 7.50  | 9.87  | 11.25 | 12.48 | 17.01  | 23.08  |
| 11a      | Dasher, Scraper, Holder, each*  |       |       |       |       |        | 10.41  |
| 13       | Gearframe, Complete with gears  | 31.82 | 42.66 | 45.80 | 76.96 | 107.21 | 427.86 |
| 14       | Gearframe, Skeleton, no gears   | 26.98 | 36.25 | 42.00 | 64.44 | 92.87  | 252.58 |
| 16       | Gearframe, Crank Shaft          | 5.46  | 14.74 | 14.74 | 17.67 | 17.67  | 40.96  |
| 17       | Gearframe, Clutch only, each*   |       |       |       |       |        | 15.62  |
| 18       | Gearframe, Gear Shaft & Clutch  |       |       |       |       |        | 55.97  |
| 19       | Gearframe, Crank Shaft & Clutch |       |       |       |       |        | 55.97  |
| 20       | Gearframe, Lower Bearing        | 10.84 | 10.84 | 10.84 | 16.16 | 16.16  | 42.96  |
| 21       | Gearframe, Bottom Gear          | 18.34 | 18.34 | 18.34 | 23.96 | 23.96  | 45.80  |
| 22       | Gearframe, Shaft Gear           | 19.48 | 19.48 | 19.48 | 20.69 | 20.69  | 41.26  |
| 23       | Gearframe, Top Gear             | 19.48 | 19.48 | 19.48 | 27.41 | 27.41  | 60.81  |
| 24       | Tub, Complete with fittings     | 36.91 | 40.96 | 44.96 | 53.06 | 55.90  | 325.25 |
| 25       | Tub Bail Handle with wood grip  | 5.32  | 6.96  | 6.96  | 9.08  | 11.25  |        |
| 26       | Tub Center                      | 5.39  | 5.39  | 5.39  | 5.39  | 5.39   | 15.13  |
| 27       | Tub Ear (steel)                 | 7.99  | 7.99  | 7.99  | 7.99  | 7.99   |        |
| 28       | Tub, Frame Button               |       |       |       |       |        | 19.72  |
| 28a      | Tub, Frame Button Holder        |       |       |       |       |        | 24.99  |
| 29b      | Tub, Frame Button Back Plate    |       |       |       |       |        | 6.66   |
| 30       | Tub, Latch (steel)              | 9.20  | 9.20  | 9.20  | 9.20  | 9.20   |        |
| 31       | Tub, Hanger (tub)               |       |       |       |       |        | 64.44  |
| 32       | Tub, Hanger Pivot Screws, each  |       |       |       |       |        | 20.89  |
| 33       | Tub, Handle Comp-each           |       |       |       |       |        | 11.25  |

\* These parts not illustrated

When ordering, please specify part number and description, size of freezer and the part number on the underside of the gear frame and the number on the cover. Cans are shipped without covers. Can covers are ordered separately.

## ELECTRIC MODELS

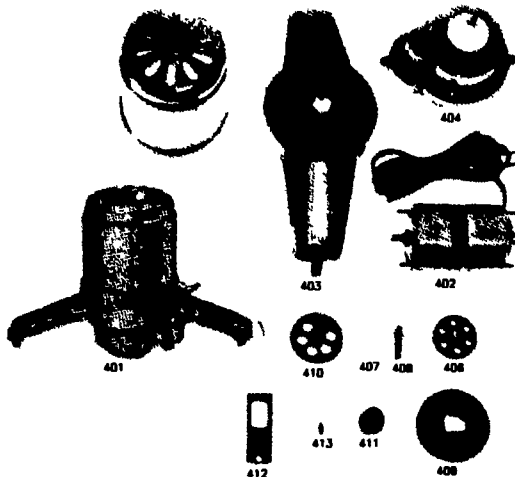

| Part No. | Description                       | Price 2-Qt | Price 4-Qt | Price 6-Qt |
|----------|-----------------------------------|------------|------------|------------|
| 1        | Can                               | 27.41      | 33.28      | 38.42      |
| 4        | Can Cover Lid (Aluminum)          | 18.15      | 24.81      | 28.74      |
| 8        | Dasher, Outer with Scrapers       | 17.37      | 22.81      | 31.77      |
| 9        | Dasher, Inner                     | 7.69       | 17.96      | 17.37      |
| 11       | Dasher Scrapers (pair)            | 8.18       | 9.87       | 11.25      |
| 24       | Tub, complete with fittings       | 36.91      | 40.96      | 44.96      |
| 25       | Tub Bail Handle with wood grip    | 5.32       | 6.96       | 6.96       |
| 26       | Tub Center                        | 5.39       | 5.39       | 5.39       |
| 27       | Tub Ear (steel)                   | 7.99       | 7.99       | 7.99       |
| 30       | Tub Latch (steel)                 | 9.20       | 9.20       | 9.20       |
| 401      | Motorizing Unit Complete          | 78.96      | 78.96      | 78.96      |
| 402      | Motor                             | 54.57      | 54.57      | 54.57      |
| 403      | Unit Frame Blank                  | 26.98      | 26.98      | 26.98      |
| 404      | Unit Gear Housing                 | 18.76      | 18.76      | 18.76      |
| 405      | Unit Steel Hood                   | 13.01      | 13.01      | 13.01      |
| 406      | Top and Cluster Gear              | 16.40      | 16.40      | 16.40      |
| 407      | Top Retaining Ring                | 2.66       | 2.66       | 2.66       |
| 408      | Stud for Top and Cluster Gear     | 5.57       | 5.57       | 5.57       |
| 409      | Main Drive Gear                   | 24.51      | 24.51      | 24.51      |
| 410      | Intermediate Gear with Pinion Rod | 21.12      | 21.12      | 21.12      |
| 411      | Dasher Hub Section Holder         | 8.31       | 8.31       | 8.31       |
| 412      | Dasher Holder Steel Strap         | 6.05       | 6.05       | 6.05       |

You may also order the #401 motorizing unit only for your 6 quart hand freezer.

## Andy H Weaver



16891 Farmington Road  
West Farmington OH 44491

Phones: (216) 548-8799 & 548-2231  
TOLL FREE ORDER LINES:  
1-800-882-8799 or 1-800-768-5518

All prices now include shipping and handling - no extra charges. Please use the Order Blank on page 2. Most 6 quart parts are in stock. Other sizes may take up to 3 weeks for delivery. No C.O.D.'s on White Mountain Parts. Payment must be sent with order. Minimum order is \$10.00.