

Keystone International Livestock Exposition To Open Sept. 30



Lambs are part of the fun for visitors to KILE.

DAILY EVENTS

THURSDAY, SEPTEMBER 30

Media Day

8:00 a.m. Pinto Horse Show
8:00 a.m. Appaloosa Horse Show

The Farm Show Complex: Home Of The Keystone Show

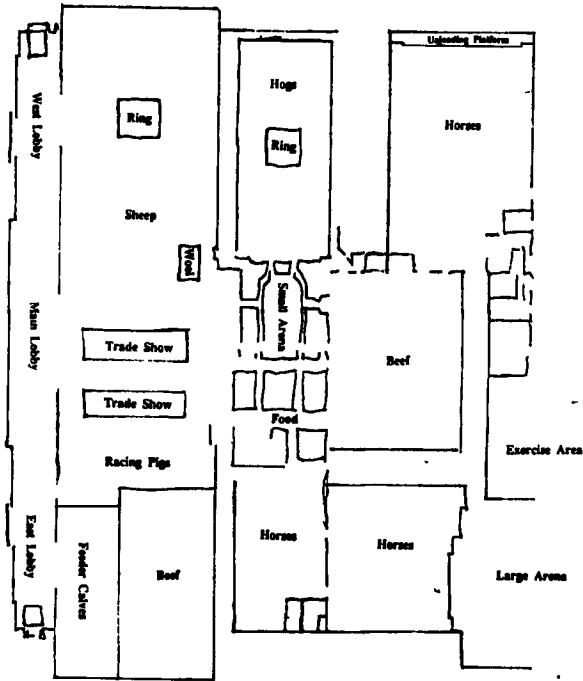

2:00-7:00 Stockman's Trade Show
4:00 p.m. Opening Ceremony & Awards Presentation
4:45 p.m. Media Pig Race
6:00 p.m. Breeding Swine: Hampshire, Landrace & Poland China in order
6:00 p.m. Hatfield Racing Pigs
7:30 p.m. Hatfield Racing Pigs

FRIDAY, OCTOBER 1

Stockman's Day

8:00 a.m. Merino & Dorset Breeding Sheep
8:00 a.m. Quarter Horse Show
9:00 a.m. Polled Hereford Breeding Cattle
9:00 a.m. Breeding Swine: Chester White, Spotted Swine, Berkshire, Duroc and Yorkshire
10:00 a.m. Wool Judging
10:00 a.m. Hatfield Racing Pigs
10:00-7:30 Stockman's Trade Show
11:00 a.m. Rambouillet Breeding Sheep
12:00 noon Hatfield Racing Pigs
12:30 p.m. Simmental followed by Sales Breeders Cattle
1:00 p.m. Suffolk Breeding Sheep
1:30 p.m. Corriedale Breeding Sheep
2:00 p.m. Hatfield Racing Pigs
4:00 p.m. Hatfield Racing Pigs
4:30 p.m. Feeder Calves
6:00 p.m. Hampshire & Shropshire Breeding Sheep
6:00 p.m. Hatfield Racing Pigs
6:00 p.m. Chester White & Spotted Swine
6:00 p.m. "Keystone Classic Sale"
7:00 p.m. Glatfelter "Challenge of the Breeds" plus Draft Horse Team Classes
7:30 p.m. Hatfield Racing Pigs

SATURDAY, OCTOBER 2

Kid's Day

7:00 a.m. Draft Horse Halter Classes
8:00 a.m. Junior & Intercollegiate Livestock Judging contest
8:00 a.m. Southdown Breeding Sheep
10:00 a.m. Hatfield Racing Pigs
10:00-7:30 Stockman's Trade Show
11:00 a.m. Limousin Sale Cattle Show
12:00 noon Hatfield Racing Pigs
12:00 noon Keystone Lead Line followed by crowning of the PSWGA Queen
12:00 noon Lebanon Valley National Bank- "Agri-Kid Olympics"
12:30 p.m. Highland Cattle NE Regional Show, followed by Simmental Capital Futurity
1:00 p.m. Paso Fino Horse Show
2:00 p.m. Hatfield Racing Pigs
3:00 p.m. Yearling Bred Ewe Sale: Hampshire, Southdown, Dorset & Shropshire
3:00 p.m. Evergreen Tractor Kiddie's Pedal Pull
4:00 p.m. Hatfield Racing Pigs
6:00 p.m. Yearling Bred Ewe Sale: Suffolk
6:00 p.m. Hatfield Racing Pigs
6:30 p.m. Feeder Calf Sale - Feeder Calf Pens
7:00 p.m. Draft Horse 4-Horse & 6-Horse Hitch Classes
7:30 p.m. Hatfield Racing Pigs
8:00 p.m. Highland Cattle Sale

SUNDAY, OCTOBER 3

Family Day

7:30 a.m. Draft Horse Hitch Classes
8:00 a.m. Family Sunrise Service 8:00 a.m.
8:00 a.m. Columbia & Tunis Breeding Sheep
8:00 a.m. Junior Beef Breeding Cattle
8:00 a.m. Draft Horse Hitch Classes
9:00 a.m. Duroc Barrows On-Foot, followed by Cross-bred and Purebred Barrows of Other Breed
10:00 a.m. Junior Breeding Sheep: Suffolk, Dorset, Southdown, Shropshire & Merino
10:00 a.m. Junior Breeding Sheep: Montadale, Hampshire, Cheviot, Oxford & Corriedale
10:00 a.m. Hatfield Racing Pigs
10:00-7:30 Stockman's Trade Show
11:00 a.m. Junior (4-H & FFA)
12:00 noon Hatfield Racing Pigs
12:30 p.m. Live Hog Evaluation Contest
1:00 p.m. Limousin Medal of Excellence Show
1:30 p.m. Junior Barrows
2:00 p.m. Hatfield Racing Pigs
3:30 p.m. Truckloads of 6 Market Hogs
4:00, 6:00 & 7:30 Hatfield Racing Pigs

MONDAY, OCTOBER 4

8:00 a.m. Arabian Horse Show
8:30 a.m. Breeding Sheep: Oxford, Cheviot, Montadale
9:00 a.m. Angus Breeding Cattle
9:00 a.m. Open Barrows On-Foot: Berkshire, Chester White, Hampshire, Landrace, Poland China, Spotted Swine & Yorkshire
9:30 a.m. Keystone Stockman's Show
10:00-4:00 Stockman's Trade Show
12:00 noon Shorthorn Breeding Cattle
2:30 p.m. Keystone Stockman's Contest Awards

Sponsors Assist In Production Of KILE

HARRISBURG (Dauphin Co.) — The Keystone International Livestock Exposition is in its 37th year at Harrisburg. The Exposition is recognized nationally as a showcase for the nation's top beef cattle, swine, sheep, and horses. It will be held at the Farm Show Complex in Harrisburg on September 30-October 4.

To date, five sponsors have committed funds to support the Keystone International Livestock Exposition. A sponsorship program was put together this year for the second time. The purpose behind the program is to sell advertising and promotion of the show to the client who is looking for the agricultural-family oriented consumer, and we have thousands of people at the KILE show which fit this description. With the revamped KILE program, many opportunities exist for agricultural companies to get involved.

Glatfelter Insurance Group in York, PA is sponsoring the "Challenge Of The Breeds" show on Friday evening in the large arena. This event will pit four internationally recognized horse breeds, the Appaloosa, the Arabian, the Paint and the Quarter Horse against each other in an

evening of fun and mastery. A total of four horses chosen by their respective breed associations will be entered in the competition. The "Keystone Sovereign Champion" will then receive \$1,000.

Sponsoring the Kiddie Pedal Pull is Evergreen Tractor Sales at Lebanon, PA. Dennis Grumbine, owner, reports that he chose the Kiddie's Pedal Pull to sponsor because of the close tie-in with the equipment business. The Pedal Pull will be held on Saturday, October 2, at 3:00 PM. The event is open to children between the ages of 3 and 8.

Hatfield Quality Meats is sponsoring the Racing Pigs at the show. The racing pigs will be "running" six times each day in the activity area of the KILE Show. Mr. Dwight Woelker, from the Corporate Office of Hatfield, states that the corporation has a commitment to animal agriculture and wants to be a part of the KILE Show in 1993.

Kessler Meats has chosen to sponsor our daily "Kessler's Barnyard", as it is called, where kids of all ages can touch and pet barnyard animals. Kessler's Meats is located in LeMoyné, PA.

Lebanon Valley National Bank is sponsoring the Agri-Kid Olympics. Farm-related competitive events will be held for children including wheelbarrow races, hay toss, sack races, hog-calling, and laughing contests. Kids will even learn how to auctioneer.

The Keystone International Livestock Exposition is sponsored by the PA Livestock Association in cooperation with the PA Department of Agriculture and the PA Farm Products Show Commission.

Why not plan to come on down to the farm at the 1993 Keystone International Livestock Exposition.

EVERGREEN TRACTOR CO., INC

30 Evergreen Road, Lebanon, PA 17042
(717) 272-4641



HATFIELD
Quality Meats since 1895
Keystone International Livestock Exposition
Quality products begin with quality hogs. At Hatfield, we start only with the best to make the best.
HATFIELD QUALITY MEATS INC
HATFIELD PENNSYLVANIA 16840-0002

Agri-Business
INSURANCE AGENCY, INC.
a subsidiary of the GLATFELTER INSURANCE GROUP
The Agri-Business Insurance Agency, Inc. (ABIA) provides comprehensive insurance programs to progressive farm operations. Our staff has over 75 years of agricultural experience, and we offer farm packages which include building, livestock, equipment and liability exposures. In addition, we tailor crop insurance coverages to individual farm operations.
The Agri-Business Insurance Agency has accepted the challenge of properly addressing the farms of the future. We will work with your local agent or broker providing the guidance necessary to properly cover your farm exposures. Have your agent or broker contact us today. Or you can call us at the toll free number below.
P O Box 2726, York, PA 17405
(717) 741 0911 • (800) 233-1957

Tackle A Nittany Lion Frank Now!
KESSLER'S
Nittany Lion Franks
Kessler's, Inc. • 1386 Hummel Ave. • Lancaster, PA 17602

LV NB
HEADQUARTERS OFFICE
Lebanon Valley National Bank
Phone (717) 274-6900
LEBANON, PA 17042-1285