

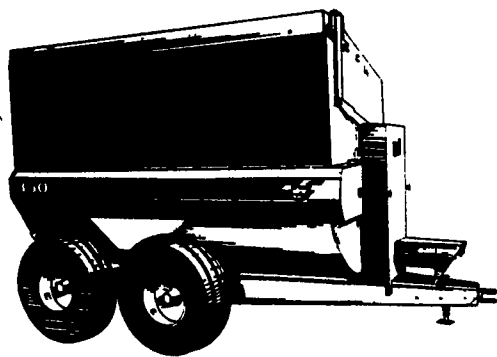

SPREADERS

Choice!

MODEL 350
10½ Ton Unit



MODEL 240
7 Ton Unit

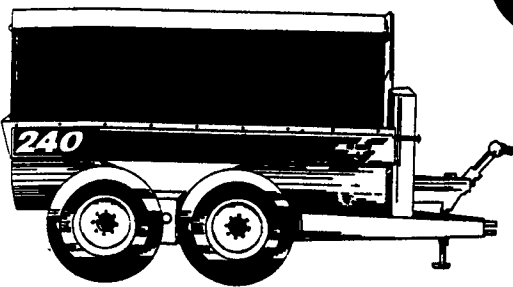

MODEL 200
6 Ton Unit

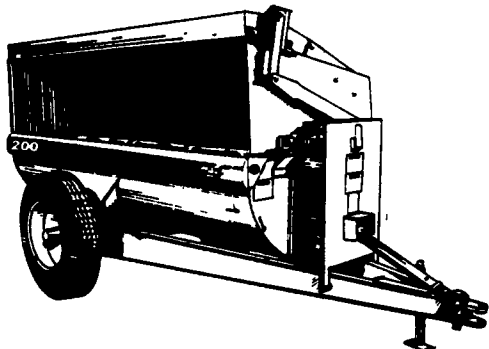

MODEL 170
5 Ton Unit

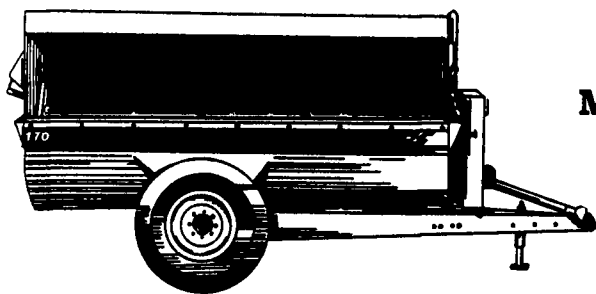

Four models... one just right for you!

Nu Hawk manure spreaders offer four ways to economically handle your fertilizing needs. Each model provides an option for any size operation at an "easy to handle" price.

So take your pick of the litter, and choose a spreader that offers a perfect fit when it comes to size, durability, and price: Nu Hawk by Ideal Industries.

Low-Cost **FUERST** F-L-E-X-I-B-L-E TINE HARROW



HERBICIDE INCORPORATION: Independent research using black light photography proves the Fuerst Harrow behind your disk or cultivator gives you "near perfect" incorporation in one pass—better than implements costing several times more! Shreds trash as it prepares & levels seedbeds.

BROADCASTING SMALL GRAINS AND GRASSES: University of Illinois found overseeding by broadcasting followed by a Fuerst Harrow a superior combination, out-performing equipment costing more than 10 times as much. Pulled behind the broadcaster, it covers seed to desired depth in one time-saving operation.

SHREDS STALKS: Shreds and spreads stalks in spring ahead of no-till and ridge-till planting.

4 to 42 ft. widths. Flexes to cover every inch at 6-8 mph. No maintenance. Easy to use and store. Insist on the original "Spreading Action"® tines.

Original "Spreading Action"® tines give better coverage at much higher speeds. Adjusts without tools to provide the right penetration for a big variety of jobs!

PASTURES: Increases quality and quantity of feed from pastures. Aerates to stimulate growth and improve moisture penetration. Scatters droppings, reducing parasites. Prepares soil for overseeding without disturbing existing growth. Works in seed and fertilizer. Many owners report pasture yield increases of 15%.

Ritchie



WATER THAT WON'T QUIT.

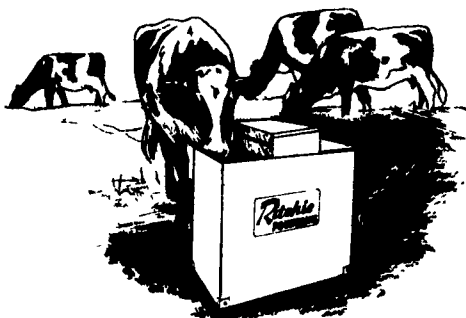

BE READY FOR COLD WINTER MONTHS!

The Farmer Can Relax When He Has A #3 Electric Cattle Waterer

Ritchie WATER PRO ENERGY FREE!

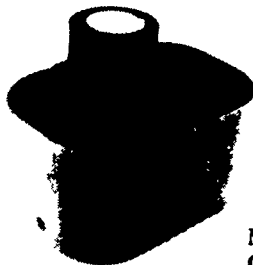

MODEL S2
MULTI-PURPOSE
2 DRINK

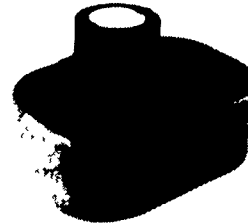

MODEL C2
CATTLE 2 DRINK

Recapping Your Ritchie® Fountains Makes Sense... And Saves Money!

If you own a Ritchie #3, #5 or #10 cattle or combination fountain, or a #48 or #84 Cattle-master fountain, you can save up to 50% in energy costs! Just recap your existing fountain with a Ritchie Thermal Cover lid.

Thermal Cover lids float right on the water and are

lined with extra insulation — up to 1½" thick — to reduce heat loss in winter and keep water cooler and prevent algae growth in the summer. And they're easy to install.

Just stop by and ask how you can save money with Ritchie Thermal Cover lids

RELAX..

Ritchie®

WATERS 'EM RIGHT™
70 years of quality products and service



5 Cattle Fountain

For split or single lot applications
Waters up to 150 head
Part No. 11290
20" x 37½" x 26" high
Electric (536W, CSA approved) or Gas

3 Cattle Fountain

Designed for big service in small pens
Waters up to 100 head
Part No. 11255
17" x 28½" x 26" high
Electric (536W, CSA approved) or Gas

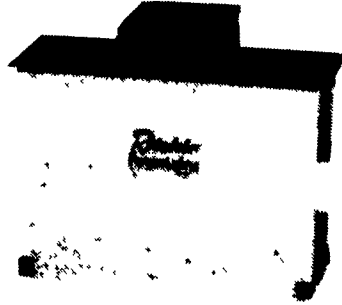

2AC Multi-Purpose Fountain

Waters calves, sheep and goats. Perfect for box stalls, small lots or fencelines
Waters up to 40 cattle/100 calves
Part No. 12295
10" x 24" x 18" high
Electric (286W, CSA approved)

See Us At
PA FARM SHOW
Jan. 11-16
Space 312 to 317
688-2379

RYDER SUPPLY CO.

P.O. Box 219
Chambersburg, PA 17201-0219
Phone 717-263-9111