

Looking for Acreage? Twenty acre gentleman's farm with a lovely 4 bedroom farmhouse with a huge country kitchen, open stairway in the living room, 3 car garage, 52x36 barn and more. The land is partially tillable, some woodland and a stream. Excellent north of Lancaster location.

CENTURY 21
Hoffer & Associates
 95 N Reading Road
 Ephrata, PA 17522
 (717) 738-4261

WHAT A GREAT DEAL!

175 Acre NYS Farm

with unbelievable country home, 3 BR. Everything has been done right. Worth \$100,000 alone.

Also has barn suitable for dairy, beef or horses and new machine shed. Over 1 mile of road frontage on good road. This place has many, many possibilities. Must be seen to be appreciated. \$157,000

Mel Manasse
 Licensed Real Estate Broker
 Whitney Point, NY
 607-692-4540

BLAIR CO. FARMS

OUTSTANDING DAIRY FARM located in Morrisons Cove area near Martinsburg! Modern dairy setup! Priced very reasonable!

112 ACRE FARM, currently a horse operation! 60'x136' free span building attached to conventional barn. Home features country decor with 2 fireplaces! Trout stream! Adjoins above farm!

BEDFORD CO. FARM

140+ ACRE GENERAL FARM, large pond and excellent home and buildings! Picturesque setting!

REALTY CENTER
 James R. Michelone, Realtor
 (814) 832-3665
 or (814) 695-8696

PERRY COUNTY
 144 acres of woodland, stream. \$575 per acre.

FARM & HOME REALTY
 East Petersburg, PA
 717-569-3992

Sylvester Baum 717-776-3967
 Harlan Keener 717-464-2669

Broker- J. Irvin Denlinger
 717-898-8962

FARMS FOR SALE

Maryland's Eastern Shore

187 acres, 182 tillable, older farm house \$395,000
 220 acres, 207 tillable, \$683,000
 186 acres, 108 tillable, two 5 acre ponds, excellent hunting \$437,000
 41 acres, 18 tillable, pond, brick rancher, \$225,000.

KENT CREEK REAL ESTATE
 Galena, MD
 301-648-5656

NEW LISTING DAIRY FARM

190 acres with 90 tillable, 32x100 dairy barn with 40x44 new addition, 58 tie stalls, pipeline, 2 silos with one unloader, 100 ft. mow conveyor, nice modern 4 bedroom, 1 1/2 baths home that's only 11 yrs. old. Call for more details.

Endless Mt. Real Est.

RD #1, Box 203 - A
 Covington, PA 16917
 Office Ph. 717-659-5684
 Richard Chamberlain Broker 717-549-4173
 Jake Ensminger Res. 659-5245
 Bill Smith Res. 549-5146
 Don Chamberlain Res 549-4721

LANCASTER AREA REAL ESTATE WANTED

LET US SELL YOUR FARM:
 We Need Farm Listings - Call Us To Market Yours!

RESIDENTIAL DEV. PROP. WANTED
 We Are Looking For Residential Developments.
 Call Us!!!

JACK GAUGHEN
 REALTOR

Call Ralph Clemans
717-393-0403
 1500 Litz Pike
 Lancaster, PA

54 ACRES GOOD FARMLAND & PASTURE
 Adjoining the Tulpehocken Creek, (good water supply). Lebanon Co. Price negotiable.
717-866-4088

BEAUTIFUL FINGER LAKES AREA

STEBEN CO. - 50 Acres Development Land, 2 Story Home, Upper Level, 7 Rms., 2-3 Bdrms, 2 Baths, Eat-in-Kit w/built in appliances, Large Liv Rm w/Cathedral Ceiling, Din Area, Plush Carpeting, Front Deck, Sec'd, \$150,000 #2784

STEBEN CO. - 32 Acre Farmette, 8 Rm House, 3 Bdrms, Large Liv Rm, Din Rm, Eat-in-Kit w/Built in Appliances, New Bath, 2 porches, 46'x32' Barn w/ New Siding, 2nd House 4 Rms, Like New, Great for Income Property \$90,000 #2786

STEBEN CO. - 310 Acre Dairy Farm, 20 Ac Forest, 25 Ac Pasture, Bal Tillable, 100 Freestall, Several Out Bldgs, Silo, Double 4 Herringbone Milking Parlor, Badger Feeder & Conveyor, Automatic Take Off, Automatic Washer, 4 Bdrm Home, \$215,000 #2755

STONE BROOK NEAR - 20 Ac Surveyed, 10 Til, 10 Forest, \$18,000 Owner Will Divide into Two - 10 Ac Parcels, \$9,000 Each, Terms, #2788

STEBEN CO. - 76 Ac 1/2 Tillable, 8 Ac Forest, Pond, Stream, Excellent Investment for Recreational Purposes #2782

WRITE FOR FREE BROCHURES

MAKITRA REAL ESTATE, INC
 4 West Steuben St. Bath, N.Y. 14810
 Hrs., 8 to 5 (607) 776-6665
 24 Hr. # (607) 776-2468
 For After Hrs. Apt. Call (607) 776-2386

Snyder County

48 Acre Dairy Farm. House, barn, includes all equipment and cows
45 Acres, of tillable land, 3,200 sq ft home, small barn with corral Unique property, \$140,000

Montour County
11.89 Acre Game Farm Operation, 4 bedroom home, barn, deer pen, other pens, pond, pasture and wooded area, \$79,000

Juniata County Dairy Farm, 144 acres well equipped, 4 bedroom house, private setting

Mifflin County
136 Acre Dairy Farm, fully equipped, 50 cow barn plus 2 houses, 110 acres tillable, \$296,000

Union County
150 Acre Farm, house, barn, many outbuildings, very nice

Integrity Real Estate
 717-837-1061
 717-966-3851

REAL ESTATE PUBLIC AUCTION

Thursday
 July 14, 1988

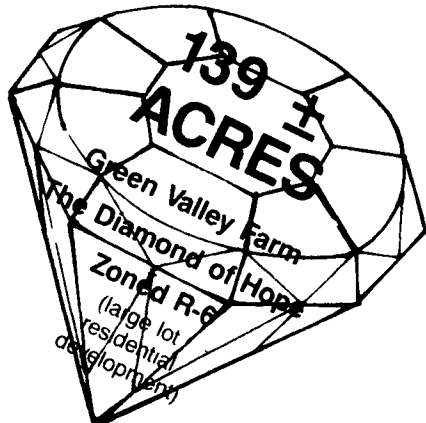

Hope Twp.,
 Warren Co., NJ

A hidden community of natural splendor offers yesterday's unspoiled beauty to today's seekers of the quiet tranquility for which Hope is renowned. Rich fertile farmland, the famous Beaver Brook, and stately forests graced with wild turkey, deer and native otter await those who are searching for that one special place of peace and beauty. Just 2 miles from I-80, Green Valley Farm is "one of the finest property offerings in the northeastern United States."

Inspection by appointment
 COLOR BROCHURE

201-234-2500

Max E. Spann
 Realtors
 Auctioneers

HERITAGE REALTY GROUP INC. MLS

1525 Science St., State College, PA 16801

814-231-0101

"FARM PEOPLE SERVING THE FARM COMMUNITY'S REAL ESTATE NEEDS."

Contact: DON C. MYERS
 Residence: (814) 422-8111
 ROBERT A. CONNOLLY
 Residence: (814) 383-4336

FARM & RURAL PROPERTY DIVISION

CENTRAL PENNSYLVANIA FARMS AND FARMETTES BLAIR COUNTY

#131 FA - GENERAL FARM - TYRONE AREA - \$277,500
 * 245 Acres (171 tillable, 8 pasture, 66 woodland, 7 site) Very productive tillable land
 * Sound 2 1/2 story brick house, tenant house, 67 x 122 steel 2-story bank barn sound garage
 * Small pond near house some Juniata River frontage

#2325 FL LARGE ACREAGE WOODED TRACT - MILESBURG AREA - \$698,500
 * 1225 Acres - all wooded, substantial public road frontage
 * Ideal for use by a hunting club
 * Easily accessible from Interstate 80 Has subdivision possibilities 486 Acres can be purchased for \$500/acre

CLINTON COUNTY
#260 FA - DAIRY or GENERAL FARM
 * 136 Acres (63 tillable, 70 woodland, 3 site)
 * Beautiful home, 2 barns with 1 suitable for a modern dairy operation implement shed, all extremely well maintained
 * Productive, level to moderately sloping land, picture perfect setting, trout stream, woodland joining State forest

HUNTINGDON COUNTY
#134 FA - RIVER BOTTOM LAND - ALEXANDRIA AREA - \$99,500
 * 55+ Acres (45.6 tillable, highly productive)
 * Ideal for truck cropping and irrigation
 * Situated in an excellent location for direct (roadside) marketing

LYCOMING COUNTY
#171 FA - RIVER BOTTOM FARM - MUNCY AREA - \$250,000
 * 93 Acres (71 tillable, 22 woodland, site and roads)
 * Excellent two-story stone and frame house, sound bank barn with 25 stanchions, bunk feeder, 26'x86' implement shed/shop combination, 3,500 bu steel grain bin
 * Highly productive, Class I soil, substantial Susquehanna river frontage, irrigation potential

#135 FA - LIVESTOCK & HOG FARM (Convertible to Dairy) - LAIRDSVILLE AREA - \$297,500
 * 270 Acres (165 tillable, 25 pasture, 85 woodland & site) tillable land is relatively level and productive, good growing season
 * Sound, aluminum sided 2 1/2 story home, large bank barn with 60'x120' one-story attachment, 20'x60' Harvestore silo
 * Substantial road frontage and stream frontage Approx 25 miles east of Williamsport Owner will subdivide and sell with reduced acreage

DETAILED BROCHURES ARE AVAILABLE FOR EACH OF THE LISTINGS ABOVE. THEY MAY BE VIEWED ON VIDEO TAPE AT OUR STATE COLLEGE OFFICE (Many land parcels and cabins available - **PHONE LISTEN**) Be sure to visit our **AN EXHIBITION DAYS DISPLAY**. Now is an excellent time to call to receive professional assistance of your property of the above.