

Firestone

END-OF-YEAR SPECIALS



TRACTN	F	RD	TBR1		
9	5	16	4	338-389	90.00
18	4	161	6	338-540	300.00
8	3	24	4	338-362	85.00
9	5	24	4	338-370	95.00
11	2	24	4	337-978	110.00
11	2	24	6	338-397	135.00
12	4	24	4	338-400	137.00
12	4	24	8	338-559	180.00
14	9	24	4	338-419	165.00
13	6	26	6	338-451	225.00
12	4	28	4	337-994	150.00
13	6	28	4	338-001	160.00
13	6	28	10	338-591	295.00
14	9	28	4	338-427	180.00
14	9	28	6	338-478	210.00
16	9	28	6	338-486	260.00
18	4	28	6	338-494	310.00
16	9	30	6	338-044	290.00
18	4	30	6	338-052	310.00
23	1	30	8	338-613	700.00
16	9	34	6	338-060	320.00
18	4	34	6	338-079	330.00
18	4	34	8	338-567	395.00
20	8	34	6	338-508	465.00
20	8	34	8	338-575	530.00
9	5	36	4	338-443	165.00
13	6	38	4	338-036	190.00
13	6	38	6	338-087	220.00
14	9	38	6	338-516	255.00
15	5	38	6	338-095	270.00
15	5	38	8	338-583	325.00
16	9	38	6	338-141	345.00
18	4	38	6	338-109	365.00
18	4	38	8	338-117	425.00
20	8	38	8	338-125	535.00
20	8	38	10	338-605	625.00
9	5	42	6	338-532	220.00
12	4	42	6	338-524	270.00

Public Auction Register

Closing Date Monday 5 00 P M
of each week's publication

DECEMBER

WED. DEC. 17 - 10AM 80 Head of High Grade Holstein Dairy Cattle, Feed & Dairy Supplies. W. of Hagerstown, MD, and 4/10 mi. W. of I-81 on Rt. 58 to Broadfarming Rd., W. 2 mis. on Broadfarming Rd. to farm. Eldon & Betty Eby. Robert C. Mullendore, Auct.

WED. DEC. 17 - 11AM Gentleman's Farm. For: Abe Cotler, Clearview Farms, 2 mis. S. of Pole Tavern Circle, 1 of the show places of Salem Co., Rt. 77, Upper Pittsgrove Twp., Salem Co. Melvin E. Sickler, Auct.

WED. DEC. 17 - 12 Noon. Special Dairy Sale Consignments at New Holland Sales Stables, Inc., 12 mis. E. of Lancaster, PA, just off Rt. 23, New Holland.

FARM EQUIPMENT

LOST CREEK IMPLEMENT

Oakland Mills, PA 17076
717-463-3511 463-2161



SPECIAL

JD 7000 6 row conservation planter, dry fertilizer, monitor, frame mounted coulters, insecticide
Sale Price \$11,750
DEMO

USED COMBINES

JD 6600 LL, rotary screen, 1,400 hrs., dsl., cab, AC, very good, \$19,000
JD 6600 Side Hill, dsl., hydro, cab, AC, 2,000 hrs., excellent
NH 185 rotary, 4WD, hydro, Cat dsl., 16' flex platform, Bish adaptor, very good, \$29,000
MF 760 hydro, cab, AC, 24 5x32 tires, good, 1163 CH, 15' platform, \$27,000
MF 750 hydro, cab, AC, mce, 1163 CH, 15' platform, \$27,000
MF 510, cab, dsl., platform, \$7,500
(2) JD 215 flex platforms, good \$5,000-\$6,000
JD 213 flex platform, good, \$6,000
JD 444 corn head, good, \$3,000
(2) MF 44 corn heads, good, \$2,800 ea
NH 710 Uni combine w/10' platform \$2,500
NH 325 2RN sheller, good, \$4,500
(New) JD 300 husker, In Stock

Interest Free Financing Till
Sept 1, 1987

USED TRACTORS

JD MT w/cult., sickle-mower & 2 btm. plow
JD 50, 3 pt., live power, good, \$1,800
JD A Tractor w/picker
MF 85 Tractor gas, WF, \$2,800
MF 65 gas, good, \$1,500
Farnall Super H, good, \$1,200
Farnall H \$900
Farnall 544, tri-axle, 3 pt., good, \$4,500
Farnall 350, \$1,200
Farnall 706 Gas, WF, excellent, \$6,000
AC WD w/2 btm. plow, good, \$1,300
1850 Oliver, gas, 9' h.p., good condition
1967 BN Ford, overhauled, excellent

TILLAGE

9' Case transport disk
JD RW 113 Disc
IH 60 auto, 3 btm., 16" reset plow, excellent
(6) 2, 3, 4, 5 bottom plows
18' transport harrow, Special \$900

DRILLS & PLANTERS

JD FBB 16x8 Hoe Drill, grass seed, excellent
JD FBB 17x7 disc drill, single disc, w/ grass seed, good
(2) JD 1230 planters, good cond
IH 56 4 row DD, dry test
IH 13x7 disc drill, good
JD 7000, 6R Cons., Dry Insect, Sharp, \$8,500

HAY, FORAGE & MISC.

NH 69 Baler, good
NH 269 Baler w/thrower
NH 273 Baler, excellent
NH 68 baler w/thrower
IH 241 round baler, very good
IH 430 baler w/thrower, good
JD 14T baler, mce
JD 480 mower conditioner
IH 990 haybine, 9
NH 460 haybine
NH 479 haybine, very good
NH 33 Flail Chopper, good
JD 15 Flail Chopper
JD 38 Harvester
Fox Harvester w/2 heads
Model 7600 Field Queen Harvester w/Grass Head, Diesel
NH 880 Forage Harvester w/2 heads
JD 115 Forage Box
JD 750 grinder mixer, very good
312 NH Spreader, \$100
JD 40 Spreader, excellent
3 Zimmermann Elevator, like new

Vegetable Management Seminar Set

NEW HOLLAND - The Eastern Lancaster County Adult Farmer Program will conduct a Vegetable Management Seminar on Thursday evening, Dec. 18th, from 6:30 to 9 p.m. at the Blue Ball School. Penn State Extension Vegetable and Small Fruit Specialists Mike Orzalek, Pete Ferretti, Rob Amsterdam, and Roland Daniels will present slide illustrated sessions on vegetable and small fruit management topics.

Subjects to be presented will include varieties, cultural practices, fertilization, pest control, and marketing. Research on row covers on cole crops (broccoli and

cauliflower) will be presented.

Many local produce crops will be discussed, but emphasis will be on cantaloupes, tomatoes, peppers, cauliflower, broccoli, asparagus, strawberries, raspberries, blackberries, and blueberries.

The opportunity for vegetable growers to update Private Applicator Licenses that expired in September 1986 will be available. All interested persons are invited.

The Blue Ball School is located 1/2 mile east of Blue Ball on Ewell Rd., between routes 322 and 23. For further information call the Adult Farmer office at 354-4525.

Fire Destroys Pennfield Plant

EPHRATA - Fire swept through one of Lancaster County's largest egg processing plants Wednesday night, destroying the building along with tens of thousands of eggs.

Located near Ephrata, the facility was owned by Pennfield Farms, a division of Pennfield Corp., of Rohrerstown.

Smoke was already pouring from the roof when the Shoeneck Fire Company arrived on the scene. About 150 firefighters from 13 fire companies battled the blaze.

Thirty-five employees were at work in the 32,000-square-foot building when the fire broke out, but no employee injuries were reported. One fireman was treated for smoke inhalation at Ephrata Community Hospital and released.

A company spokesman said that Pennfield was gearing up for the busy holiday season when the fire struck. Between 36,000 and 45,000 dozen eggs were in the plant at the time of the fire.

As of yesterday, the cause of the fire had not been determined. Damage to the building and

processing equipment was estimated at \$2 million.

Faith And Farming

(Continued from Page A38)

talents together, and Mennonites have done this better than anyone else, got it all equipped to feed the world at a cheaper rate and no world to feed. There are plenty of people who need food. But there aren't many people you can get the food to for political reasons, for economic reasons, for social reasons, for reasons of national security. So you have the people who can import the food who are raising their own crop. You had overvalued and speculated land prices. I know this may be painful but there is no way in world that you can have Kansas farm prices, wheat land \$1,200 an acre, dry land prices and raise wheat on it, and that's all you raise on it. And raise it for what the world will pay for it today and come out.

FREE MOUNTING



FIRESTONE RADIAL 23 0 TM

• Deep biting 23° bar angle tread	18 4R34 6 Ply	\$399.00
• Wide tread and large footprint combine to help minimize slippage on loose soil & sod	16 9R38 6 Ply	\$419.00
• Durable radial construction with stabilizer belt plies	18 4R38 10 Ply	\$529.00
	20 8R38 8 Ply	\$649.00
	20 8R38 10 Ply	\$699.00
	18 4R42 10 Ply	\$839.00
	20 8R42 10 Ply	\$899.00
	24 5R32	\$800.00
	30 5LR32	\$960.00
	18 4R34	\$399.00
	20 8R34	\$639.00
	23 1R34	\$795.00

FREE MOUNTING



FORESTRY SPECIAL WIDE TREAD PLY TIRE

18 4X26 10 Ply	\$499.00
23 1x26 10 Ply	\$899.00
28L26 10 Ply	\$1049.00
24.5x32 12 Ply	\$1230.00
30.5L32 12 Ply	\$1499.00
30 5L32 16 Ply	\$1749.00
18.4x34 10 Ply	\$699.00

Service Avail. - Call For Quote

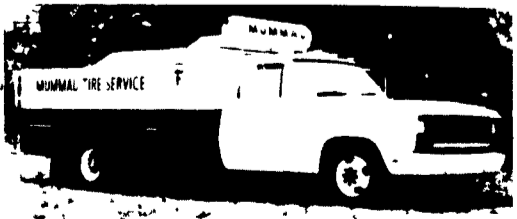

MUMMAU TIRE WAREHOUSE

Northumberland - 717-473-3974
Main Office (Mt Joy) 717-653-1260
PA TOLL FREE 1 800-222-1729

PERKA BUILDINGS

A size to suit your needs with or without Self-supporting Lean to.

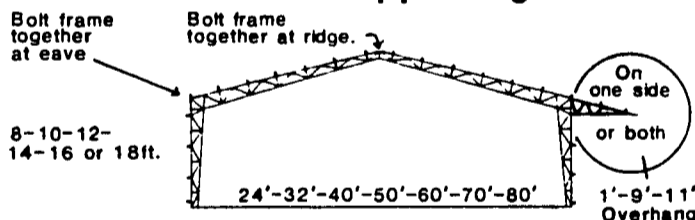

FARM • COMMERCIAL • INDUSTRIAL

3"-12" Roof Pitch for more over head space.

For extra floor space at a low cost add a Half Truss

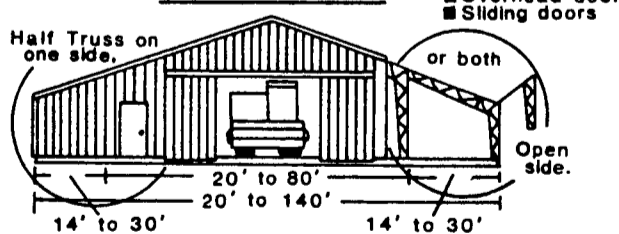

-OPEN CEILING-25% MORE USABLE SPACE.
-NO ROT-ONLY STEEL TOUCHING CONCRETE.
-EXPANDABLE-ADD ON LATER BY SIMPLY REMOVING ENDWALL SHEETING.

-EASY TO INSULATE.
-40 YEAR WARRANTY ON STEEL COLUMN & TRUSS.
-20 YEAR WARRANTY ON STEEL CLADDING.
-8 MODELS TO CHOOSE FROM CUSTOM DESIGN AVAILABLE.
-DO IT YOURSELF OR HAVE US ERECT IT FOR YOU.

Get Your FREE Perka book

To: PERKA BUILDINGS SYSTEMS
Box 166, RD #2
New Holland, PA 17557

Name _____

Address _____

Town/City _____ County _____

Telephone No _____ Postal Code _____

I am interested in the following type of building:

Width _____ Length _____ Size of Door _____

Implement Shed Dairy Hog Other

Workshop Loose Housing Stable

Industrial Commercial Riding Arena

Date of Planning To Build _____

or Call Now
(717)
354-4740

Fill out this card and mail it today