

Morrison Cove Livestock Martinsburg, Pa. Aug. 25, 1986

Report supplied by auction

CATTLE 133. STEERS: H. Choice & Prime 56.50-59.75, Choice 54.50-57.75; Good 52.50-55.50; Standard 40.50-47.50. HEIFERS: Choice 54.50-57.75, Good 45.50-52.75. COWS: Utility & Commercial 37.50-41.75; Cutters 34.00-38.75; Canner & Low Cutter 30.00-36.75. BULLOCKS: Good & Choice 47.50-51.75. BULLS: Yield Grade No. 1 40.25-49.00. FEEDER CATTLE: Steers Good 54.00-60.50; Standard 37.50-45.75. Bulls Good 52.00-57.50, Standard 38.00-44.50. Heifers Good 50.00-54.50, Standard 40.50-47.50.

CALVES 247: Vealers Prime None; Choice 65.00-70.50; Good 55.00-64.50; Standard & Good 45.00-54.50; 90-110 lbs. 43.50-52.50; 65-90 lbs. 35.00-43.00; Holstein bulls 90-130 lbs. 60.50-86.50; Holstein Heifers 90-130 lbs. 45.00-56.50.

HOGS 119. Barrows & Gilts US No. 1-2 210-245 lb. 63.00-64.75; US No. 1-3 210-255 lb. 62.00-64.25.

SOWS: US No. 1-3 54.00-60.50. FEEDER PIGS 31: US No. 1-3 20-35 lbs. 32.50-43.50 per head, No. 1-3 35-50 lbs. 46.00-51.50 per head.

SHEEP 27: Slaughter lambs Choice 90-110 lbs. 64.50-70.50; Good 65-85 lbs. 60.00-64.50; Sl. Ewes 22.50-33.00.

GOATS 12: 18.50-38.50 per hd.

Frederick Livestock

Monday, Aug. 25, 1986

BUTCHER COWS: \$1.50 Lower. Good 37.00-38.50; Standard & Utility 32.00-36.00; Cannors 28.00-32.00; Shelly 30.00-Down.

BULLS: Good 45.00-46.75; Medium 41.00-44.00.

HEIFERS: Good 38.00-40.50; Medium 35.00-37.00.

BUTCHER HOGS: \$2 lower. 230-260 lbs. 60.00-61.00; 290-320 lbs. 52.00-54.00.

SOWS: 300-600 lb. 49.00-52.00;

Livestock market and auction news

Heavy Boars 35.00-38.50.

VEAL CALVES: Steady prices. Good-Choice 64.00-71.00; Standard 58.00-63.00; Stocky & Thin 50.00-57.00; Light Calves 35.00-42.00; Weak & Rough 34.00-Down.

CALVES RETURNING TO FARM: Very active, steady prices. Holstein Bulls 85-95 lbs. 60.00-70.00; 100-115 lbs. 70.00-80.00.

LAMBS: Few offered. Medium 50.00-56.00.

STOCK CATTLE: Light run.

STEERS: Medium 40.00-44.00.

HEIFERS: Medium 35.00-40.00.

BULLS: Good 43.00-46.00; Medium 40.00-42.00.

SPRINGING HEIFERS: 460.00-750.00.

PIGS & SHOATS: Strong Demand. By The Head 40-70 lb. 38.00-55.00; By The Lb. 20-35 lb. 25.00-37.00.

Belleville Livestock

Belleville, Pa.
August 27, 1986

Report supplied by PDA

CATTLE 58. Report supplied by Auction. Slaughter steers, one Standard 46.50. Slaughter cows, Canner thru Commercial 29.35-41.85. Slaughter bulls 41.25-46.25.

CALVES 117. Vealers all grades 28.00-100.00.

HOGS 36. Barrows and gilts 53.50-61.10.

FEEDER PIGS 248. US No. 1-3 20-50 lbs. feeder pigs 23.00-47.00 per head.

SHEEP 14. Slaughter Lambs 53.00-60.00.

GOATS 0. Holstein Dairy Cows \$420.00-\$1,000.00 per head.

Belknap Livestock

Dayton, Pa.

Wednesday, August 27

Report Supplied by PDA

CATTLE 74. PDA Compared

with last Wednesday's market: Slaughter cows about steady. Good, individual slaughter steer at 53.75, couple Standard 48.00. Individual Choice slaughter heifer 53.00, one Standard 41.75. Breaking Utility and Commercial slaughter cows 36.00-37.75, Cutter and Boning Utility 33.50-37.50, Canner and Low Cutter 27.50-33.50, Shells down to 25.75. Few Utility slaughter bullocks 40.50-43.25. Feeder Cattle: Few Medium Frame No. 1 515-850 lbs. heifers 43.00-48.25; Few Medium Frame No. 1, 540-650 lbs. bulls 45.25-52.00.

CALVES 108. Few Good vealers 53.00-57.50, few Standard and Good 90-130 lbs. 42.00-48.00, 60-85 lbs. 30.00-44.00, few Utility 50-60 lbs. 15.00-30.00. Farm Calves: Holstein Bulls 95-130 lbs. 55.00-75.00, mostly 60.00-70.00. Beef cross bulls and heifers 60-160 lbs. 41.00-70.00.

HOGS 150. Barrows and gilts mostly .50-\$1 higher. US No. 1-2 220-245 lbs. 62.60-63.30, No. 1-3 225-250 lbs. 61.00-62.00, few No. 2-3 210-265 lbs. 56.00-58.00, No. 1-3 140-205 lbs. 50.00-59.75. Sows mostly \$1 higher. US No. 1-3 330-600 lbs. sows 49.50-55.00. Boars 38.50-46.50.

FEEDER PIGS 80. Few US No. 1-3 10-25 lbs. feeder pigs 20.00-30.00, 30-45 lbs. 30.00-41.00 — all per head. **SHEEP 8.** Few Choice 75-105 lbs. slaughter lambs 50.00-60.00, couple Good 70 lbs. 48.50.

GOATS 9. 11.00-25.00 — all per head.

Oklahoma Cattle

Thursday, Aug. 28

Report supplied by USDA

Weekly Cattle Summary: Feeder steers and heifers steady with last week. Demand continues good from stocker accounts and moderate from feedlot accounts. Slaughter cows 25-50 cents lower. Slaughter bulls 1.00 lower. Receipts this week near 21,000

head; last weeks count 14,253; last years number 27,434. Feeder steers and heifers made up 94% of run; cows and bulls 6%.

Medium and Large Frame 1 FEEDER STEERS: 300-400# 73.00-79.00; 400-500# 72.00-79.25; 500-600# 66.00-72.50; 600-700# 63.80-70.00; Mostly 64.00-67.50; 700-800# 63.00-65.50; 800-900# 61.10-63.30.

FEEDER HEIFERS: 275-375# 65.25-69.00; 400-500# 62.00-67.50; 500-600# 57.50-64.70; Mostly 60.00-62.00; 600-700# 58.50-61.00; 700-800# 57.00-60.70.

Leesport Livestock

Leesport, PA

Wednesday, August 27, 1986

Report Supplied by PDA

CATTLE 251. Supply included 27 feeder cattle. Compared with last Wednesday's market: Slaughter steers steady to 1.50 higher; Cows steady to .50 lower. Few High Choice and Prime 1050-1250 lbs. steers 62.85-64.00, Choice 1000-1400 lbs. 59.25-62.25, one 62.75, Good 55.00-59.00; few Standard 49.50-52.00; Good and Choice 1000-1500 lbs. holsteins 47.50-58.75, mostly 50-54.50, few Standard 40.50-44.75. Choice 850-1075 lbs. heifers 54.00-58.60, few Good 42.50-51.00, few Standard 41.00-43.25. Breaking Utility and Commercial slaughter cows 36.25-39.85, Cutter and Boning Utility 33.75-36.00, Canner and Low Cutter 30.50-34.10, Shells down to 22.00. Few Good slaughter bullocks 51.75-54.00, Standard 45.00-49.00; Good and Choice 1200-1600 lbs. holsteins 47.75-50.75. Few Yield Grade No. 1, 1200-1775 lbs. slaughter bulls 46.75-51.85, few No. 2, 850-950 lbs. 41.00-41.25. Feeder Cattle: Few Medium Frame No. 1, 475-875 lbs. steers 55.50-60, one lot Large No. 2 680 lbs. 45.50. Few Large and Medium Frame No. 1 375-650 lbs. heifers 46.00-49.00. Few

Medium Frame No. 1 600-700 lbs. bulls 49.75-50, few Large No. 2, 700-800 lbs. 39.50-40.50.

CALVES 176. Vealers steady to strong. Few Choice 76.50-86.50, few Good 65.00-72.00, few Standard and Good 110-120 lbs. 45.00-51.50, 85-105 lbs. 42.00-45.00, 70-85 lbs. 40.00-43.00, Utility 55-110 lbs. 30.00-40.00. Farm Calves: Holstein Bulls 90-135 lbs. 65.00-84.00, some down 45.00. Few Beef cross bulls and heifers 65-90 lbs. 48.00-95.00.

HOGS 390. Barrows and gilts \$1 to \$3 lower. Few lots US No. 1-2 215-240 lbs. 62.75-63.85, 1-3 210-245 lbs. 58.75-63.60, mostly 60.75-62, 200-240 lbs. 56.00-59.50, 2-3 210-260 lbs. 56.25-61.50, one lot 1-3 170 lbs. 52.50. Sows under 500 lbs. \$1 to \$2 higher. US No. 1-3 300-475 lbs. sows 51.50-55.00, 500-600 lbs. 54.00-56, one 57.00, few Medium 270-400 lbs. 43.00-50.25. Boars 38.00-45.75.

FEEDER PIGS 222. US No. 1-3 25-30 lbs. feeder pigs 129.00-135.00, lot 144.00, 35-45 lbs. 112.00-129.00, 55-100 lbs. 84.00-93.00, lot 120 lbs. 68.00, few Utility 50-85 lbs. 72.00-84.00 — all per hundredweight.

SHEEP 43. Choice 80-110 lbs. spring slaughter lambs 66.00-70.00, few 80.00, Utility and Good 65-80 lbs. 64.00-68.00. Slaughter sheep 23.00-37.00, few 40.00.

GOATS 48. Few Large adults 39.00-57.00, Large Kids 28.00-36.00, Small and Thin Kids 15.00-23.00 — all per head.

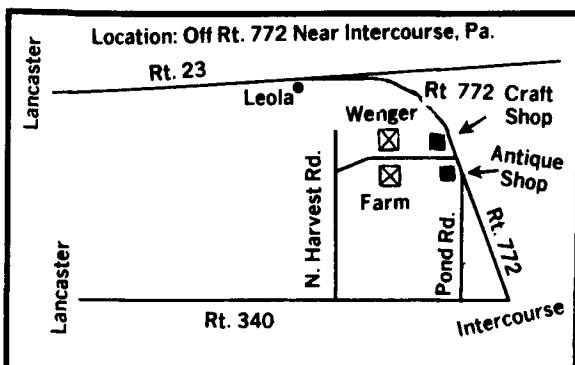
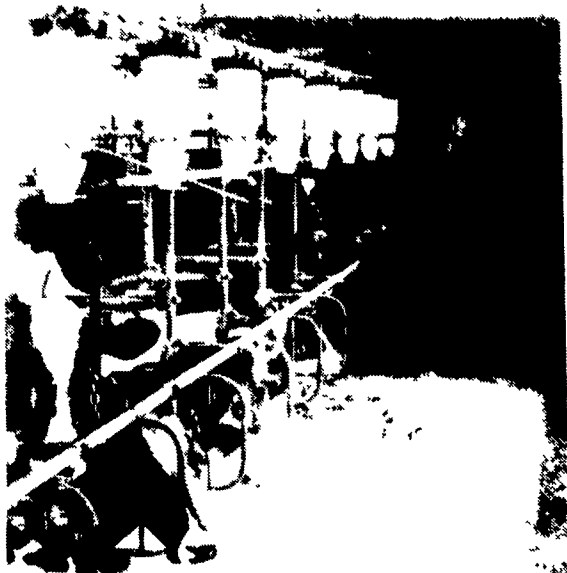

OPEN HOUSE

WED., SEPT. 3rd 10 am to 3 pm

2 Feedings - 10:30 And 1:30

**You're Invited... See This 63 Tie-Stall Facility
At The Ken Wenger Farm, Ronks, Pa.**

★ Refreshments Will Be Served ★

8 Reasons For Choosing...

- (1) **CABLEVEY Saves Labor** - That's important when you want to maximize milk production by feeding more often.
- (2) **CABLEVEY Saves Feed** - Many dairy producers have found the milk production increased even with equal or less feed after installing CABLEVEY.
- (3) **CABLEVEY Pays For Itself** - Just from the increase in milk production alone, many systems have paid for themselves in 12 months or less.
- (4) **CABLEVEY Reduces Feed Separation** - Unlike flex augers, feed separation is minimal... that means a more uniform ration to all cows.

- (5) **CABLEVEY Handles High Moisture Corn** - The 2" system and plastic drops are specially designed to handle high moisture corn without constant hang-ups.
- (6) **CABLEVEY Takes The Corners** - Specially designed 90° corners allow efficient system operation for nearly any barn layout.
- (7) **CABLEVEY Saves Energy** - 1 Motor and 1 system handle many livestock operations
- (8) **CABLEVEY Controls Feed By Weight Or Volume** - Cows individually fed a pre-set amount by Weight or Volume automatically 5 to 8 times per day for highest efficiency.



★ SPONSORED BY... ★

"Experience And Quality"

From Concept...

To Design...

To Completion...

TRIPLE H Construction

29 South Charles St. Ephrata, PA 17522

Phone: 717-738-2142

**Custom Builders of Dairy, Hog, Poultry, Horse, Storage,
Residential And Commercial Buildings.**

**Ken's Textureator® Feed Made By
MODERN MILLING CO., LITITZ**

Feedmobile Inc.

SALES • PARTS • SERVICE

727 Furnace Hills Pike, Lititz, PA 17543

(717) 626-2680

**Toll Free: 800-528-6695 U.S.
800-528-6693 PA.**