

North Jersey Livestock
 Hackettstown, NJ
 Tuesday, October 22
 Report supplied by auction
 Calves- 30.00-87.00.
 Cows 28.00-38.25.
 Easy Cows 27.00-34.50.
 Heifers 25.00-51.00.
 Bulls 34.50-49.25.

Steers 36.75-56.50.
 Hogs 45.50-46.50.
 Roasting Pigs, each 5.00-32.00.
 Boars 32.00.
 Sows 30.00-34.00.
 Sheep 18.00-57.00.
 Lambs, each 6.00-63.00.
 Lambs, per lb. .43-.90.
 Goats, each 18.00-37.00.
 Kids, each 9.00-45.00.

New Holland Dairy

New Holland Sales Stables
 Wednesday, October 23
 Report supplied by auction
 Reported receipts of 77 cows, 41 heifers, and 13 bulls.
 Heifer market active; cows slow.
 Springing heifers, 550.00-850.00, few up to 925.00, some shortbred, 450.00-550.00; Small open heifers, 75.00-130.00; Open breeding age, 290.00-430.00; Some smaller fresh heifers, 550.00-710.00.
 Local fresh and springing cows, 610.00-875.00; 1 ld. NY fresh and springing cows, 650.00-1175.00; 1 ld. upstate PA fresh and springing cows, 700.00-975.00.
 One ld. NY fresh cows, 910.00-1100.00; Stock Bulls, 425.00-650.00.

Weekly Summary

Harrisburg, PA
 Friday, October 25
 Report supplied by PDA
 15 Livestock Markets
CATTLE: 6495. Compared with 4504 head last week and 6619 head a year ago. Steers mostly 1.00-1.50 higher; heifers steady to 1.00 higher; cows steady to 1.00 lower; bullocks steady to weak; bulls steady to 2.00 lower; High Choice & Prime No. 3-4, 63.00-65.00; Choice No. 2-4, 58.00-64.00; Good 52.00-58.00; Standard 44.00-51.00; Choice heifers 55.00-58.50; Good 51.00-55.00; Standard 41.00-47.00; cows 34.00-37.50; Cutter & Boning 31.00-35.50; Canner & Cutter Grade 28.00-33.50; Shells down 20.00; few Choice bullocks 50.00-57.50; Good 47.00-50.00; Yield Grade No. 1, 1000-2200 42.00-47.00; No. 2, 900-1600 lb. 38.00-42.00.
FEEDER CATTLE: Steers Med. & Large No. 1, 350-800 lb. 48.00-59.00; heifers Med. No. 1, 300-700 lb. 42.00-54.00; bulls Med. No. 1, 350-950 lb. 40.00-48.00.
CALVES: 4227. Compared with 3158 head last week and 4941 head a year ago. Vealers uneven, mostly steady to 5.00 higher; few Prime 92.00-105.00; Choice 75.00-90.00; Good 60.00-75.00; 110-130 lb. 50.00-65.00; 90-110 lb. 43.00-52.00; 65-90 lb. 37.0-45.00; Utility 50-95 lb. 25.00-40.00; Hol. bulls 90-130 lb. 45.00-90.00; few heifers 90-120 lb. 45.00-85.00.
HOGS: 6162. Compared with 2896 head last week and 6721 head a year ago. Mostly weak to .50; spots to 1.00 lower; No. 1-2, 210-245 lb. 45.50-47.25; No. 1-3, 210-250 lb. 44.50-46.50; No. 2-3, 220-285 lb. 43.50-45.00; No. 1-3, 145-200 lb. 40.00-42.00; sows steady to 1.00 higher; No. 1-3, 300-650 lb. 34.00-39.00; No. 2-3, 300-600 lb. 31.00-34.00; boars 26.00-31.00.
FEEDER PIGS: 1093. Compared with 952 head last week and

1352 head a year ago. Steady to 5.00 lower; 20-35 lb. 13.00-30.00; 35-50 lb. 25.00-38.00; 50-85 lb. 36.00-43.50; all per head.
3 GRADED FEEDER PIG SALES: 2333. Compared with 2741 head last week and 2814 head a year ago. Uneven mostly steady to 5.00 higher; spots to 9.00 higher; No. 1-2, 20-30 lb. 95.00-108.00; 30-40 lb. 84.00-104.00; 40-50 lb. 80.00-99.00; 50-60 lb. 70.00-91.00; 60-70 lb. 66.00-76.00; No. 2-3, 20-40 lb. 82.00-88.00; 40-55 lb. 65.00-80.00.
SHEEP: 902. Compared with 660 head last week and 924 head a year ago. Wool lambs unevenly steady; High Choice & Prime 80-115 lb. 65.00-72.00; Choice 65-105 lb. 60.00-69.00; Good 60-105 lb. 54.00-61.00; Good & Choice 50-75 lb. feeder lambs 63.00-72.25; sl. sheep 15.00-29.00.

Chambersburg Livestock

Chambersburg, Pa.
 Thursday, October 24
 Report supplied by PDA
CATTLE: 285. Sl. cows .50-1.50 lower; few Choice steers 1030-1685 lb. 56.00-59.50; Good 51.75-56.25; few Choice holsteins 45.00-48.50; few Good heifers 51.50-55.50; cows Breaking Utility & Commercial 33.50-37.85; Cutter & Boning 32.50-35.75; Canner & Cutter 29.00-32.75; Yield Grade No. 1, 1075-1635 lb. bulls 40.25-46.50.
FEEDER CATTLE: Steers few Med. 1, 350-700 lb. including bulls 43.00-55.00.
CALVES: 401. Few Choice 76.00-92.00; Good 65.00-77.00; few Standard & Good 110-130 lb. 60.00-63.00; 70-105 lb. 52.00-58.00.
FARMS CALVES: Hol. bulls 90-130 lb. 57.00-73.00; Hol. heifers 90-120 lb. 55.00-65.00.
HOGS: 39. Sows US No. 1-3, 285-525 lb. 34.50-38.00; few boars 29.25-32.00.
FEEDER PIGS: 21. Few lots No. 1-3, 35-40 lb. 23.50-25.00 per head.

Lapp ENERGY FREE DRINKERS
 No Gas/No Electric

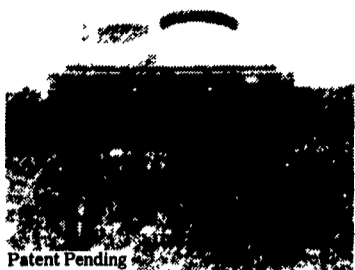

Drinkers have a new unique baffled drinking design manufactured from a durable poly product. A 2-hole 40 gallon and a 1-hole 4 gallon for all kinds of livestock, including horses, sheep, pigs, etc.

Manufactured By
SOUDERSBURG MFG.
 116 N. Soudersburg Rd., Gordonville, PA 17529

Authorized Dealers
LANCASTER CO. REISTSVILLE AREA
SHOW-EASE LAPPS
STALL CO. SHARPENING
 573 Willow Rd. SERVICE
 Lancaster, PA 17601 RD 2
 (717) 299-2536 Myerstown, PA 17067

MARYLAND FARM SPECIALTIES
 2433 Paradise Church Rd.
 Hagerstown, MD 21740
 (301) 733-0458
 Dealer Inquiries Invited

TOP PRICES FOR DOWN, CRIPPLED AND AS IS COWS, BULLS & STEERS

Slaughtered Under Federal Inspection
 Paid On Dressed Weight

Tom Mulvaney
 Livestock Trucking
 (201) 454-4247

HANDLING:
 Warren, Hunterdon, Sussex
 And Somerset Counties, New Jersey

IN PENNA:
 Northampton,
 Bucks And
 Lehigh Counties

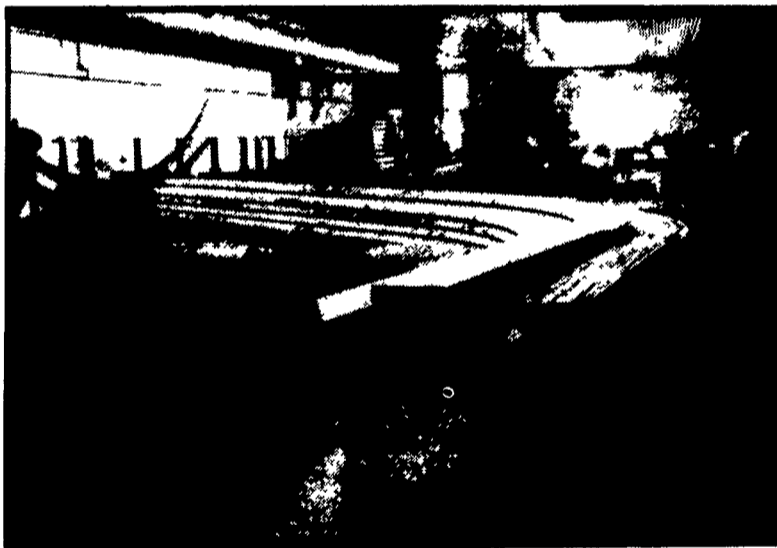
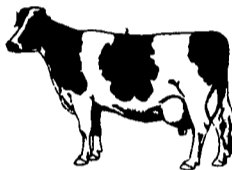

We Manufacture Laminated Beams & Archs In Our Plant In Richland.
 We Custom Build Archs To Fit Your Building Requirements. Archs Planed & Pre-Cut & Drilled Ready For Job Site Erection.

Rigidply Rafters Inc. Guarantee of Quality Product & Workmanship Assures You Of Our Product Integrity With Our Delivery Service To The Job Site.

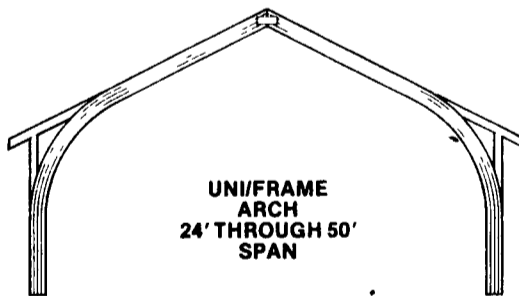
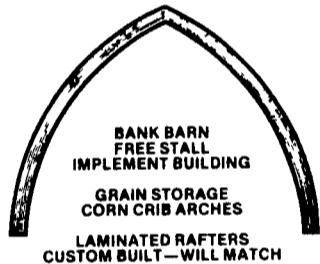

This UNI-ARCH Bldg. 40'x52' Is Built With Quality Products.

- * Fabral Roofing & Siding.
- * Cannon Ball Door Track
- * Agri Doors & Windows
- * Lam-Glue-Treated Timbers Up To 40'
- * Flooring & Decking - We Make Our Own The Lengths You Need.

