

Maryland avian flu

(Continued from Page A1)

to Pennsylvania, the infected flock is known to have contained birds purchased from at least two Pa. sources during early December, just prior to the date that the dealer was apprehended.

One group of 35 birds came from York County, and another small

flock was purchased at Root's Auction in Lancaster County.

"Certainly Root's Auction shouldn't be condemned for this (outbreak)," said Lancaster County Extension director Jay Irwin, "since all the birds leaving the auction were apparently healthy. It makes sense to me that

this outbreak may have originated from free-flying fowl," continued Irwin. "I honestly feel that the virus has been eliminated here in the county."

Pennsylvania's director of the Bureau of Animal Industry, Dr. Max Van Buskirk, agrees that blaming the state for the outbreak is premature.

"Our trace-backs would indicate that there is no problem at these

two farms," said Van Buskirk. "It's entirely speculation that, in fact, the virus came from Pennsylvania."

Dr. Van Buskirk pointed out that, although Pa.'s quarantine zones are no longer in force, surveillance was still being conducted on the west side of the Susquehanna River as recently as early December, with no further

indications of the presence of virus. Nor have any signs of the disease been noted in that portion of the zone east of the river, where surveillance remains in effect into the spring.

Stressing that the recent outbreak is no reason for panic in the industry, Jay Irwin urged poultrymen to view the problem, "calmly yet critically."

"The thing that concerns me," said Irwin, "is that we've got to tighten up our bio-security." The extension director stressed the importance of disinfecting all footwear before entering and leaving poultry houses, and cautioned poultrymen to lock all doors to unauthorized personnel.

Though concern has been expressed about the possibility of spreading virus through the upcoming Farm Show poultry exhibits, Irwin feels that the event poses no threat as long as those farmers participating and attending take the proper precautions. He stressed cleanliness before traveling to the Farm Show, as well as when returning home. Following a Farm Show visit, Irwin advised poultrymen to bath and clean clothing and footwear at a location other than their home farms.

He also pointed out that this year's Farm Show poultry health certification program includes a mandatory blood test for avian influenza.

Maryland poultrymen escaped relatively unscathed during last year's flu outbreak in neighboring Pa. A 900-bird flock in Carroll County was depopulated in October, 1983, and a second flock of 60,000 birds was destroyed in January of last year.

USDA veterinarian, Nancy Wiswall, stated that federal indemnity money will be available for losses incurred during the current outbreak.



YOUR FIRST CHOICE FOR AG PRODUCTS

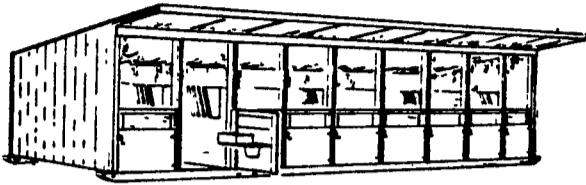

CALF CONDO

Available in 3, 4, 5, 7 and 9 stalls, fully assembled on treated skids. 3'x8' stalls each have easy access feeders. Painted.

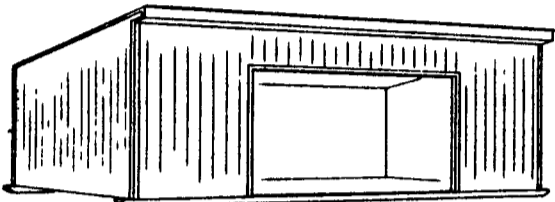

CATTLE SHELTER

Constructed of exterior rough sawn siding on treated skids. Shelter is painted and includes galvanized steel roofing and spouting.

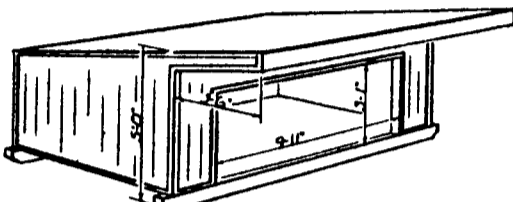

SHEEP SHELTER

Constructed of exterior rough sawn siding on treated skids. Shelter is painted and includes galvanized steel roofing.

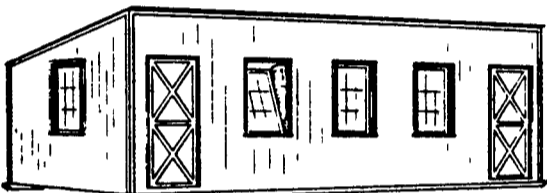

POULTRY HOUSE

Constructed of exterior rough sawn siding on treated skids. Galvanized steel roofing. Floor system - 2x6 floor joists & 3/4" T&G plywood.

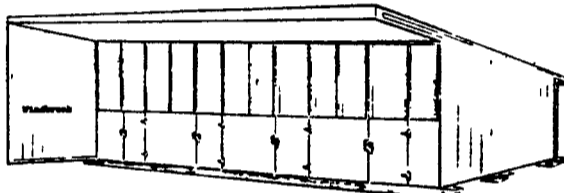

FARROWING HOUSE

Treated skids. 1-3/8" Oak floor. Removable partitions. 4 stalls. Feed panels from rear.

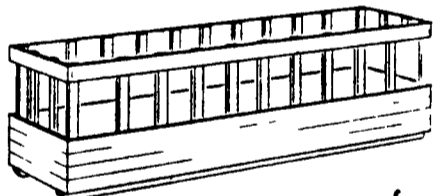

TREATED "SQUARE-NECK" FEEDER

Completely constructed of treated yellow pine lumber. Available in 10'-20' lengths. On skids for easy movability.

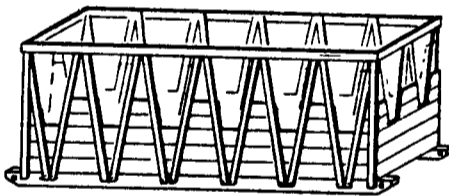

TREATED "V-NECK" HAY FEEDER

Completely constructed of treated yellow pine lumber. Available from 10'-20' lengths. On skids for easy movability.

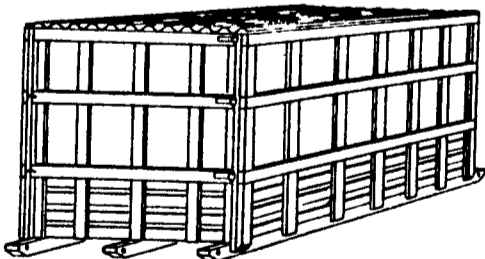

ROUND BALE FEEDER

Holds two round bales. Hinged door on both ends. Constructed completely with treated yellow pine. Galvanized steel roofing.

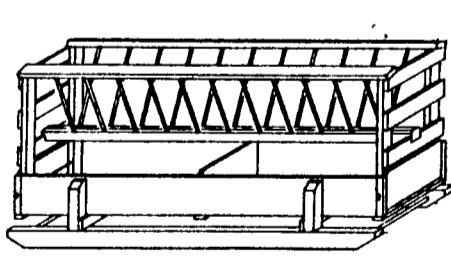

WOODEN OAK FEEDER TROUGH w/HAY RACK

Available in 10', 12' and 14' lengths. On skids for easy movement.

We Will continue 1984 prices through January of 1985. Place your order now for February, March or April delivery.

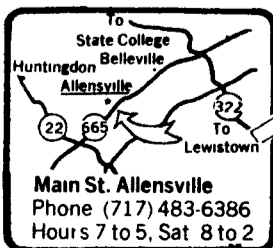

Allensville Planing Mill INC

True Value Hardware Store

ALL PURPOSE CART With Removable Front For Easy Dumping



- * 2 Sizes In Stock
- * 8 Cu. Ft. Assembled w/Solid Front w/20" pneumatic wheels, \$120.00 Reg.
- * 15 Cu. Ft. Assembled with dump front w/26" pneumatic wheels, \$150.00 Reg.

OR WILL MAKE THE SIZE YOU ORDER

- Made of 1/2" Exterior Plywood
- Edges Protected w/Galvanized Sheet
- Finished w/Treated Redwood Stain
- Handle & legs made with smooth finished galvanized tubing.

"GREAT FOR LAWN, GARDEN AND FARM USE"

Elam M. Ebersol
558 Gibbons Rd.
Rd 1, Bird-in-Hand,
PA 17505
1 1/2 Mile N. of
Bird-in-Hand, PA

