

PUBLIC SALE

of 139 Acre
Dairy Farm, Farm
Equipment, Dairy Cattle
& Draft Horses
SATURDAY, JULY 11
@ 10 A.M.

Located @ R.D. #2, Danville, Pa. Take
Rt. #54 North to Blinker Light @
Washingtonville. Turn right, go 1 mile to
Hillside Rd.; go 1 mile to farm. Derry
Twp., Montour Co.

Real Estate: 139 Acre Dairy Farm - House - 2
story frame w/asphalt siding; 1st flr. has
modern kit., dining rm., living rm., 3 bdrms.,
and new bath, 2nd flr. has kit., living rm., 3
bdrms. & bath, full basement w/cement flr.,
double garage door.

Barn & outbldgs: Stone & frame bank barn
w/horse stalls & box stalls for heifers: New
addition w/30 comfort stalls & 2 box stalls.
16'x20' block milk house; block diesel shed &
14'x60' Terre Hill silo.

Land: 139 acres total! 85 tillable, 10 pasture,
remainder in woodland. Soil type: mixed loam.
Water supply: stream, 2 wells w/windmill
supply tank.

The terrain on this farm is level to gentle slope.
All crops in the field except for 6 acres to
tobacco are included in this sale at time of
settlement. Also included are the Diesel engine
and compressors.

Terms: 10% down day of sale, settlement by
Oct. 15, 1981.

For information and inspection call Horning
Farm Agency, Inc. 215-286-5183 or Titus Snader
@ 717-437-2714.

Terms by:

BENUEL S. & FANNIE STOLTZFUS

Robert Marks, Esq.
HORNING FARM AGENCY, INC.
Elton & Alvin Horning, Auctioneers
Main St., Morgantown, Pa.
215-286-5183

Public Sales Register

Closing Date - Monday, 5:00 P.M.
of each week's publication

SAT JUNE 27 - 9:00 A.M. Orange St., Lancaster PA
Public Sale of Real Estate, Selling Household, Antiques and Household Personal Property, Silver Located in Beach Haven, and Jewelry and Furniture Sale for Henry C. PA The street along the Harner John Cooper river, across from the Auctioneer
Beach Haven Post Office
Sale for the late Beulah
and Arline Seely Dan
Newius, Olen Knecht and
Fred Antolick Auctioneers

SAT JUNE 27 - 11 A.M. Consignment Horse Sale
at Keister's Middleburg
Auction Sales, Inc., Rt.
522, 3 miles East of Mid-

SAT JUNE 27 - 9:00 A.M. Public Sale Held at 419 W.

PUBLIC SALE

50 Acres SALE 50 Acres

THURSDAY, JUNE 25, 1981

12:30 P.M.

Located at Steelville, Chester County, PA
- 7 miles North of Oxford, 7 miles South
of Georgetown. Take Rt. 896 to Bartville
Road, go East 3 miles to Steelville Road,
turn right on Bryson Road, go south.

50 Acre Dairy Farm

Improvements thereon consist of a 2½ story
frame house with vinyl siding, a 38' x 120' bank
dairy barn with 38 comfort stalls, 8 x 14 x 50
manure pit, all new, built in 1980, 14 x 60
concrete stave silo.

10% down day of sale, balance 90 days or
negotiable.

(If transportation is needed to see Real Estate
call 215-869-2508)

Terms By:

ISAAC B. & LYDIA ZOOK

Auctioneers
Steve Petersheim
215-869-2508
Everett Kreider
Attorney
Linda Kling

PUBLIC SALE

FARM, RANCHER, WOOD LOT
THURSDAY, JUNE 25, 1981

At 6:00 P.M.

The undersigned located along Shaffer
Road, Codorus Twp., York Co., PA. 1 mile
west of Shaffer's Church & 2 miles east of
Jefferson Borough (Shaffer Road in-
tersects Buffalo Valley Rd. & Shaffer's
Church Rd.), will offer at public sale on
the premises the following:

FARM - TRACT #1

Farm containing 69.1 A., more or less, im-
proved with 3 bedroom frame dwelling having
½ bath on first floor and full bath on second
floor, 2 story summer house with fireplace &
running water, large bank barn, 2 wagon sheds,
large 2 story block chicken house, frame
chicken house, 6 pen hog sty, garage with
ground cellar, & utility buildings. This farm
has hard road frontage, a meadow with a
stream running through, and good farming
ground.

RANCHER - TRACT #2

3 bedroom brick rancher with a breezeway &
2 car garage attached, having large kitchen
with bar, adequate cabinets, dishwasher &
range, living room, bath with shower,
fireplace, oil fired hot water central heat,
thermal glass throughout, and wall to wall
carpet. This dwelling was constructed 8 years
ago and is erected on a parcel containing 1.2839
Acres, more or less. Tract #2 adjoins Tract #1,
fronting Shaffer Road.

WOOD LOT - TRACT #3

Wood lot having an area of 10 A., more or
less, with assorted medium timber. This tract
is located close to Greenmount U.M. Church.

For information and inspection call area
code 717 229-2240.

TERMS: REAL ESTATE - 10% Down,
Balance within 45 days.

Tract #1 and #2 will be offered at site
locations. Tract #3 will be offered at Tract #2.

**RAYMOND J. SHARP
LAURA E. SHARP**

J. Ross McGinnis, & Mark D. Frankel,
Attorneys at Law •
C.C. Miller & Sons - Auctioneers & Clerks
Ph. 717-235-3627

PUBLIC SALE

OF CONSTRUCTION EQUIPMENT
TRACTORS, TRUCKS, PARTS
SATURDAY, JUNE 27, 1981

9:30 A.M.

Located at Sager Rd., about 1 mile
East of Elizabethtown, Pa., off Sch-
wanger Rd.

#510 J.D. Front-end Loader w/Backhoe, full
Cab Closure 2' & 3' buckets; #500 A J.D. Front-
end Loader w/Backhoe Cab, Buckets and
Rocktooth; 220 Int. '64 Tractor Single Axle
w/Wet Line; 220 Int. '64 Dump Truck Single
Axle; '68 Chevy 80 Series Cinder Spreader V-6;
'67 & '57 Chevy Vans; '65 Ford 1-Ton Flat Bed;
25-Ton Smithco Low Boy; 23 ft. Highway Dump
Trailer; #44 Massey Harris; Demolition Ball
Approx. 1-Ton; #125 Jaeger Air Compressor,
Truck Mounted; #75 Portable Air Compressor;
4 Drills, 5 Breaker Hose, Hammers, Drill Steel
Bits, Carbide Bits, Tampers, Small Wagon Drill
w/Drill Steel; Fork Lift for J.D. Loader; Root
Spring Snow Plows, 10 ft.; Dynamite Equip-
ment; 2 Transport Mag.; 2 Storage Mag.; 2
Designators; Mat Diaphragm 4" Mud Sucker;
Cable Wrench; Lincoln Welder, 180 A.M.P.;
High Pressure Washer; Winco Gas Generator;
Elect. 2" Submergible Pump; Cast Pipe
Cutter; 1-Ton Chain Hoist; Portable Greaser;
¾" Impact Wrench & Sockets; Trench & Pole
Jacks; Gas & Drum Pumps; Master Portable
Heater, 150,000 B.T.U.; 250 Gal. Fuel Tank for
pickup; Diesel & Gas Comb. Tanks; Acetylene
Torches; Bottles; Concrete Quickie; Saw &
Grinding Blades; Cement Finisher; Welding
Supplies; Anvils & Tools; Hyd. Tank; 4" Siffon
Hoses; 2 D-6 Teeth for Dozer; Leveling
Transant; Stabilizer Pad for J.D.; Dietz Visa
Flashers; Re-enforcing Cutters; Tires & Rims;
8" Soil Pipe & Others; Fitting, and many other
items too numerous to mention. Big Equipment
Sold at 1:00 P.M. No out of state checks.
Equipment in good condition.

Sale by

OLIVER SAGER & SON, INC.

Jerry Sager, Owner
717-367-1256

Harold (Abe) Shaffner &
C.H. Wolgemuth, Aucts.
Food stand

dieburg, 5 miles West of
Selinsgrove, Pa Don &
Walt Keister, Owners Ray
Long & Dave Imes Auc-
tioneers

SAT JUNE 27 - 9:00 A.M. Public Sale of Tinsmith
Tools, Equipment, Tin-
ware and Large Antique
Collection Located along
Rt. 322, 1 mile east of In-
tersection with Rt. 23,
Blue Ball, Lancaster Co.,
PA Sale for Maynard M
Windle H.H. Leid Auction
Service

SAT JUNE 27 - 9:00 A.M. Public Sale of Real Estate,
Machinery, Truck, Misc
Items Located in the city
of Shamokin, PA at 22
south Pearl St. 2 blocks
east of Shamokin St.
Watch for signs Korbach
Lumber Co., Inc. Owner.
Dockey & Dockey Auc-
tioneers

SAT JUNE 27 - 1:00 P.M. Marlou Farm Sale - Cows
and Heifers. Held at 825
Newman Springs Rd., Lin-
croft, NY. Bus Transporta-
tion available, from East
Town Mall, Rt. 30, Lan-
caster, 717-768-3545

SAT JUNE 27 - 11:30
A.M. Public Sale of Real
Estate & Household

Lancaster Farming, Saturday, June 20, 1981-D31

Goods Located off Rt.
625 1 mile South of
Bowmansville along
Spooklane Rd. Terms by
Howard H & Moses H.
Martin, executors for An-
na & Leah Martin LeRoy
S & Paul W Horst Auc-
tioneers

SAT JUNE 27 - 10:00
A.M. Public Sale of An-
tiques and Collectibles,
Personal Property
Located 6 miles north of
Hegins in the village of
Franklin Square,
Mahantongo Valley,
Schuylkill Co., PA Turn
west off Rt 125 at Keim's
Cafe, take road toward
Klingerstown Estate of
Palmer C Haas George
and Mike Deibert Auc-
tioneer

SAT JUNE 27 - 9:00 A.M. Public Sale of the
Maynard W. Windel
Tinsmith, Tools, Equip-
ment, Tinware and Large
Antique Collection
Located along Rt 322 one
mile east of intersection
with Rt 23, Blue Ball,
Lancaster Co., PA H H
Leid Auction Service.

SAT JUNE 27 - 1:00 P.M. Public Sale of Holsteins
and Machinery Located
on Browntown Rd., 3
miles from Caton, NY. 10
miles from Elmira, 10
miles from Lawrenceville,
PA 15 from Corning
Watch for auction arrows
off Rt 15 at Lindley, NY
Take County Rt 106 from
Lindley or Caton to
Browntown Rd Hakim
and Gisela Zagaschtoko
Owners Gordon Wood
Sale Manager

SAT JUNE 27 - 9:30 A.M. Public Sale of Con-
struction Equipment,
Tractors, Trucks, Parts
Located at Sager Rd
about 1 mile east of
Elizabethtown, PA off
Schwanger Rd Sale by
Oliver Sager and Son, Inc
Harold (Abe) Shaffner and
C.H. Wolgemuth Auc-
tioneers

SAT JUNE 27 - 9:00 A.M. Public Sale of Antiques,
Farm Equipment, Car,
Household Goods, Dutch
Cupboard. Located
between Hamburg and
Shartlesville, turn north
off Old Rt 22 onto Tilden
Rd, Berks Co., PA near
Indian Fort Inn Joseph
W Kauffman Estate
Ralph W Zettlemoyer
Auction Co

MON. JUNE 29 - 7:30
P.M. Public Sale of Grain
Drying Equipment,
Located 3½ miles west of
Taneytown, MD turn off
Rt. 140 at Bullfrog Rd in
Carroll Co Travel ½ mile
to sale Gerard Meunier
Owner Calvin Amoss
Auctioneer

MON. JUNE 29 - 6:00
P.M. Public Sale of
Vehicles, Antiques, Tools
and Coins, along Rt 272,
¼ mile south of Pea-
stown, Lancaster, Co, PA
Auction ordered by
Clarence Kern Estate,
H.H. Leid Auction Service

MON. EVE. JUNE 29
6:00 P.M. Public Sale of
Collector Guns, Antiques,
Household Goods, Moped,
Sporting Goods, Misc
Located along US 322
approx 4 miles west of
Ephrata, near the village
of Clay Terms by Dick
Sherk T Glenn Horst and
Timothy G Horst Auc-
tioneers

MON. JUNE 29. - 2 P.M.
Danville Livestock
Market, cattle and hog
auction Located Old
Route 11, Danville, PA
Melvin M Lehman,
owner

JULY

THURS JULY 2 - Monthly
Cow Sale at the Melvin
Kolb, Inc. Sales Barn,
2220 Dairy Road, Lan-
caster, Pa 17601 Dennis
Kolb, Sales Manager,
Robert Mulendore, Auc-
tioneer

FRI JULY 3 - 10:00 A.M.
Public Sale of Antiques,
Cars, Sterling Silver,
Diamonds, Pewter and
Coins Located at 31
Sunset Place, Lancaster,
PA Just off Rt 501 south
of Neffsville, near
Overlook and Armstrong
Manor Commonwealth
National Bank, Attorney-
in-Fact for Norman M
Badorf and Ella H Badorf
T Glenn Horst and
Timothy G. Horst Auc-
tioneers

PIGS

Have you ever attended the
"State Graded" Feeder Pig
Sales at Westminster?

- * Lots of pigs
- * Easy to get to
- * Super sanitary
- * Outstanding quality
- * Quick service
- * No tagging charge
- * No shipped pigs

**FRIDAY
JUNE 26
WESTMINSTER**

LIVESTOCK AUCTION
For directions or info call
collect (301) 733-8120 or
write Box 108 Hagerstown,
Md

EPHRATA UNION SCHOOL
DISTRICT

PUBLIC SALE

OF 10.301 ACRES
UNDEVELOPED LAND
WEDNESDAY EVE., JUNE 24
SALE TIME 7:00 P.M.

Located at the west end of Akron
Borough fronting on Rothsville Road,
Akron, Lancaster Co., Pa.

10.301 ACRES
AKRON BOROUGH.

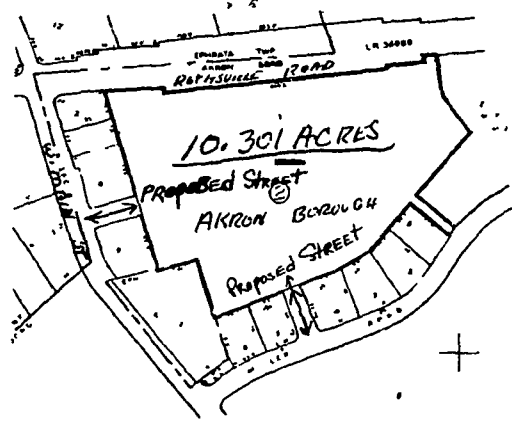

Approx. 840' (more or less) along Rothsville
Road.

ACCESS TO PROPERTY - Proposed street
off Main St. Proposed street off Miller Road.

This is a very desirable property located
adjacent to fine residential area. Near golf
course! Easy access.

For further information call auctioneer 859-
1331.

TERMS BY:
EPHRATA UNION SCHOOL DISTRICT
T. Glenn Horst, Auct.
Timothy G. Horst, Auct.
859-1331
Shreiner & Patterson, Attys.