

# SALE on HOG CONFINEMENT EQUIPMENT PRODUCTS

Unarco Rohn provides Long Life Performance  
with the BEST Protection Known to Man . . .

## HOT DIP GALVANIZING AFTER WELD

rs  
cts

e Foods,

an 1800 sow unit  
nsion. All of our  
Rohn, as well as  
s and breeding  
pleased with the  
ility of Unarco-

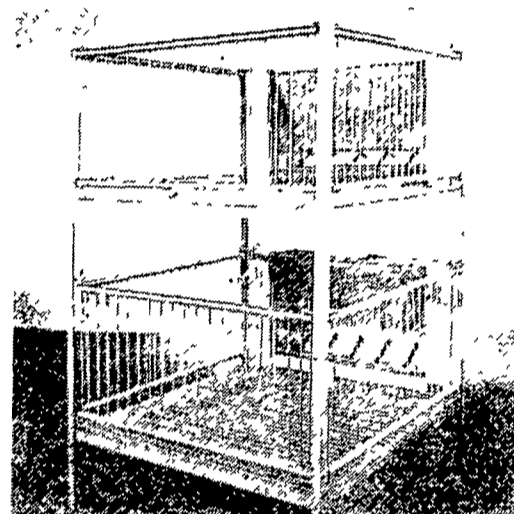
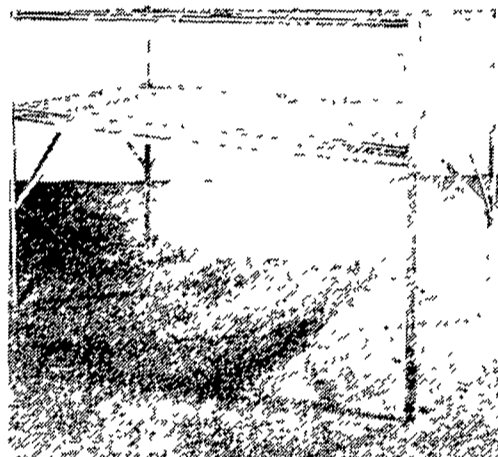

### NURSERY CAGES

Obtain the maximum use of your pork production facilities with Rohn Nursery Stack Pens. A proven boost to pig performance, Nursery Stack Pens provide a cleaner, dryer, safer, and more draft-free environment for the growing pig. Stack Pens can also reduce fixed building costs by doubling the number of pigs per square foot of available floor space.

Rohn Nursery Pens are constructed of strong, angular steel legs and frame that feature a Wire-Mesh Flooring...all of which are **HOT DIP GALVANIZED AFTER FABRICATION** for the utmost in corrosion protection. Wire-Mesh Flooring has 60% open spacing and a smooth, rounded surface that sheds waste and moisture build-up while preventing knee and foot abrasions.

Side panels swing from either end and are constructed of solid steel vertical rod which is **HOT DIP GALVANIZED AFTER FABRICATION**.

Specifications:

Pen Area; 4' x 4', 4' x 8'

Height:

Elevated Pen: 5'9" (from the floor to the top of the side panel). Bottom of the pen is 3'7" from the floor.

Stack Pens: 6'4" (from the floor to the top of the side panel). Bottom pens are 12" from the floor.

Feeder Capacity: Approximately 140 lbs.

TES

.54

**CAGES IN STOCK:  
4x8 STACK DECK,  
FLAT DECK &  
ELEVATED CAGES**

**4x8 CAGE  
WITH FEEDER**

Clearance Sale Special **\$372<sup>00</sup>**

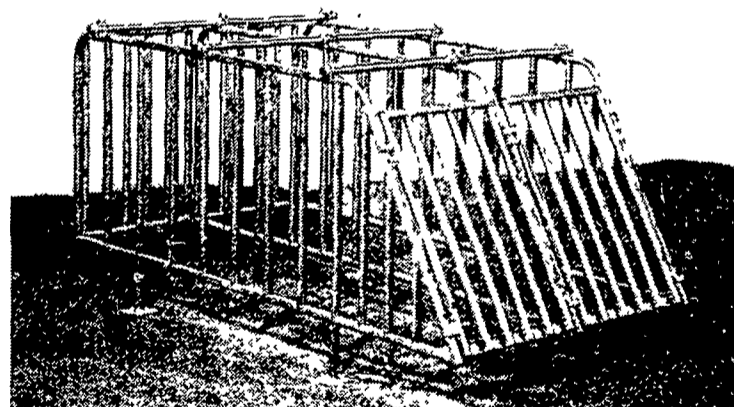
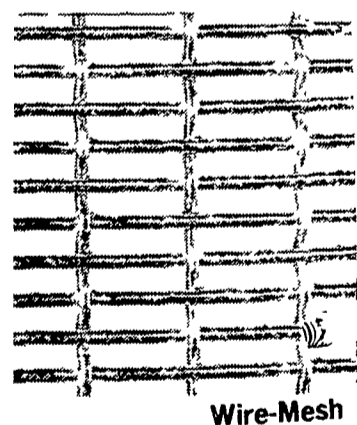

### GESTATION STALLS IN STOCK

Clearance Sale Special **\$100<sup>74</sup>** ea.

Rohn Rigid-Tube® Gestation Stalls feature all-welded construction and are **HOT DIP GALVANIZED AFTER FABRICATION** for complete corrosion protection inside and out.

The unique design of the Sloped Front Gestation Stall offers the advantages of added security during stress periods because hogs are unable to climb the front gate, and because the front gate slopes, more work room is available in the aisle.

Specifications:

Height: 41"  
Length: 7"  
Width: 22"

COMPLETE  
SERVICE



EQUIPMENT

354-4271  
ft. 7:30-12:00

### FENCING

SIZES IN STOCK  
★ 30" Height  
★ 38" Height  
★ 48" Height

Clearance Sale Special **10% OFF**

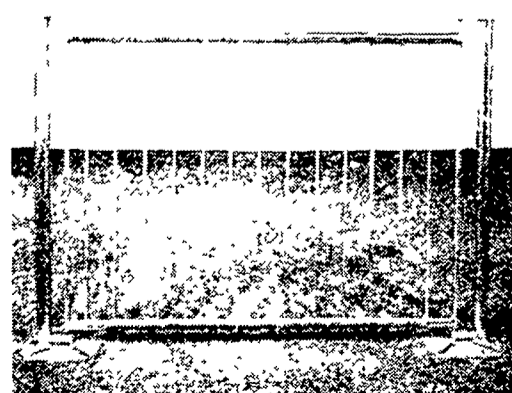

**SEE EQUIPMENT ON  
DISPLAY AT  
OUR WAREHOUSE**

**TERMS: CASH PAID UPON  
PICKUP OF WAREHOUSE  
CLEARANCE SALE ITEMS.**