

THE ALOHA LOAN.

A vacation loan that gets you off to a relaxing start No fuss No hassle Just a quick approval and easy terms

Commonwealth National Bank



Happy to help you Equal Opportunity Lender

Berwick Vegetable Cooperative

(Continued from Page 106)

and more farmers give up because there are a lot more easy ways to make a living. Today, we are beginning to realize that we must learn the lesson, and learn it quickly. Further delay and further disregard of agricultural problems will only add to the cost of the solution and compound the difficulty.

"You can pray that your kids will love the soil enough to find some sort of satisfaction and contentment in watching things grow out of that irreplaceable resource, the good earth, that God provided. Thank God some people still like to farm, and would rather do that than take an easier way out, like selling out to a developer, and those people are the hope of a world getting hungrier and hungrier and depending upon American agricultural production for something to eat.

"But it must be made profitable and attractive to keep them down on the farm...and on the family farm.

"A recent consultation held by 24 religious denominational and ecumenical agencies found that the family farm must be maintained and strengthened because:

1. It was found to be the most efficient unit of food production.
2. It is the best unit for conservation of land and water resources.
3. It preserves a genuinely competitive element in the national economy.
4. It provides a solid economic base for strong and cohesive family life.
5. It represents a way of life and containing the valuable elements of personal freedom, self-reliance, and vocational fulfillment.
6. It provides the best and

most suitable basis for the social and economic institutions of the rural community.

"The family farm must, necessarily and justly so, be able to earn a return equal to the cost of production plus a reasonable profit - and "reasonable" means return on investment as well as decent monetary gain based on the number of hours worked. And the return must come from the marketplace, and not from government. We're looking right here at a perfect example - you in the Berwick Vegetable Cooperative have developed a process for marketing your produce and getting a fair return, and it's through your own ingenuity in the marketplace.

Admitting that he is not a farmer, the Schuylkill County politician nonetheless said early in his remarks that he had one interest in common with his listeners. "And I also have one deep and abiding concern that I know you share with me," he added. "Our

common interest centers on the questions of how are we going to convince our kids that it is in their best interest to carry on the family farm - or the family small business. After all, all the worrying we do is done because we're concerned about our kids' heritage - not only the mundane things we might be able to love them, but what kind of social and economic world we are going to pass on to them."

BVC

Business Report

In other activities at the 25th anniversary meeting, BVC manager Burton Hetherington reported a profit for the period under review and that the profits would be distributed to the patrons of the cooperative within the time prescribed by Pennsylvania cooperative law. Hetherington noted that the co-op is in a sound financial position.

New directors elected to three year terms were J. Wilfred Richards, Dalton; Clemon Smith, Nescopeck; Robert Seesholtz, Jr., Bloomsburg; Dale Whitenight, Catawissa; and Joseph Skala, Ringtown.

Nature 4-H club meets

TAYLORIA - The first meeting of the 4-H Nature Club was held recently and officers were elected. Steve Aument was named treasurer, Lisa Bilheimer was picked news reporter, and Dannette Groff elected secretary.

The group then went on a

hike along the Octorara Creek, collecting specimens and observing nature. After returning, the plants and flowers were placed on boards and pressed.

The next meeting of the group will be held on June 17 at the home of Mrs. Kleinb, Tyloria.

Variety in milk

Can to bottle, bottle to paper, paper to plastic traces the evolution of milk packaging in the United States.

Raw to pasteurized to homogenized to UHT traces

product changes. Vitamin A is added to lowfat and skim milk; it's optional for whole milk. Fortification with vitamin D is optional for all forms of milk but it is added to about 98 per cent of the country's milk.

SOONER OR LATER YOU'LL OWN A GENERAL PURPOSE BARN

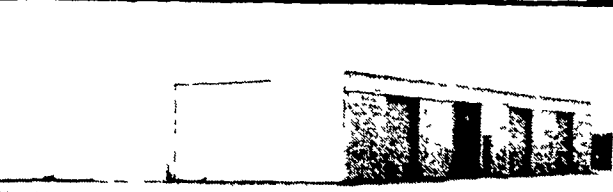

Q Why are Huskee-Bilt general purpose buildings so popular?
A They are versatile and economical. Plus we offer you a wide range of options - multiple colors, big wide doors, high eaves, stress rated lumber, skilled crews and Huskee-Bilt reliability.

If you need a machine storage building, hay shelter, animal shelter or repair shop, you've got it in the Huskee-Bilt General Purpose Building. You'll be surprised at the low square footage price.

ALSO, ask about Thrive Center Environmental, our Total Animal Confinement Systems



MERVIN MILLER
R R 2 - KEENER ROAD
LITITZ, PA 17543
PHONE: (717) 626-5204

"Kick your ollo blower to a star"

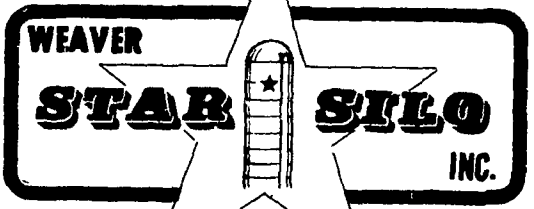

"Honey Pak" "Topper" "Energy Pak"
R.D. 4 MYERSTOWN, PA 17067
CALL COLLECT 717-866-5708

FACTORY OUTLET SAVINGS ON HEAVY-DUTY, SUPER TOUGH

TRAILERS

Trailers for every purpose at low factory outlet prices!

Save now on the best trailers on the market today! Capacities from 1000 to 30,000 lbs.

Model 907

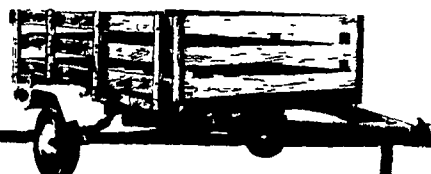

UTILITY TRAILERS

STAKE BODY KIT OPTIONAL
Choices of 4' to 7' widths
6' 4" to 16' lengths

STANDARD FEATURES

- Safety chains • ball coupler • 4 point electrical connector • stop tail and turn signal lights • license plate holder and light • reflectors • weatherized exterior grade wood bed • three ply springs • heavy duty auto tone five wheel axle assembly • weight capacities 1180 to 3000 lbs • tire sizes 4.80 x 8B 5.70 x 8B and 8.00 x 10C

Some models with jack stand, clearance lights, flotation tires and other features. Many optional features including tandem axles, loading ramp, stake body kit and many more as low as

\$267

Model 907

Model 916ST6

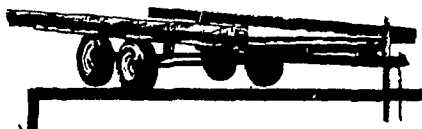

HEAVY EQUIPMENT TRAILERS

- 8 ft. width
- Bed lengths: 12'6" to 27'0"
- 6000 to 36,000 lbs. wt. cap
- Pintle eye or goose neck hitch
- Single, tandem or tri-axle
- Loading or flip-up ramps

SALE! SAVE \$\$\$!



GRAIN TRAILERS

- Removable 300 bu. grain box
- Wt. capacity: 20,000 lbs.
- Overall length: 24'2"
- Dump bed
- Tandem axles
- Bed length: 16'0"

SALE! SAVE \$\$\$!



MOTORCYCLE TRAILERS

- 1, 2 or 3 cycles
- Frame 6'4" x 49"
- Two 7' long cycle rails
- 1180 to 1430 lbs.
- Loading ramp
- Extra cycle rail (optional)

SALE! SAVE \$\$\$!



GN-42096-BFR-30 FLAT BED GOOSENECK TRAILERS

- Bogie axle/over wheel
- Beaver tail
- Wt. Capacity - 24,000 lbs.
- Overall length: 31'0"
- Bed length: 20'0"
- Loading width 96"

SALE! SAVE \$\$\$!

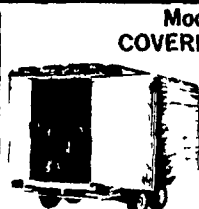

Model UT-12 COVERED TRAILERS

- 7' and 8' widths
- 12' to 32' lengths
- 8'2" to 9'7" heights
- 2000 to 10,000 lbs.
- Single or tandem axles
- All metal exterior

SALE! SAVE \$\$\$!

CATTLE HEAD GATE

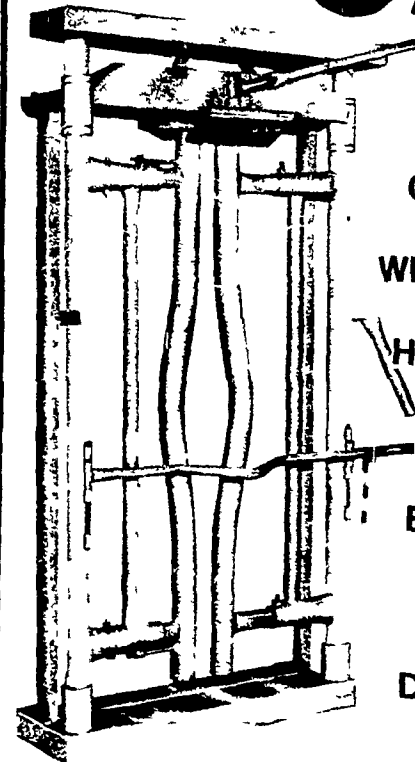

FOR THE CATTLEMAN WHO DOES NOT HAVE TIME TO FOOL WITH EQUIPMENT HE CAN'T DEPEND ON.

AARON S. GROFF & SON

FARM & DAIRY STORE
RD3, Ephrata, PA 17522 (Hinkletown)
Phone (717) 354-4631
Store Hours: 7 A.M. to 9 P.M.
Closed Tues., Wed. & Sat. at 5:30 P.

NOW ... RUSTPROOFING AVAILABLE

MGS TRAILERS

DIRECT FROM THE FACTORY SALES

Division of MGS, Inc.

Muddy Creek Church Rd., R D 3, Denver, PA
(1/2 Mile North of PA Turnpike - Exit 21)
Open Daily 8-5, Saturday 8-12 Noon Phone: 215-267-7528

