

York County DHIA

(Continued from Page 103)

Barb	3	2-7	305	16,309	3.8	613
Keeno	3	3-	305	15,869	3.8	601
Daisy	3	2-10	305	18,940	3.7	704
Senora	3	3-4	305	17,503	3.9	689
Rodman C Thompson						
Windy	3	8-2	295	15,646	4.0	628
Tinker	3	4-7	305	17,454	4.3	755
Stump Acres						
Imogene	3	5-6	305	19,417	3.6	708
Amy Jo	3	5-8	305	15,167	4.3	645
Satin	3	4-	305	19,371	3.0	577
Lajet	3	3-1	299	17,897	3.3	593
Jamara	3	3-4	305	17,487	3.6	635
J H & M B Hudson						
119	3	7-2	305	14,165	3.8	539
96B	3	6-	305	18,713	3.1	577
16 E	3	4-11	305	15,313	3.9	600
40	3	2-10	305	13,066	4.4	570
67	3	3-1	305	14,596	4.0	579
25	3	2-9	305	12,768	4.1	524
123 G	3	1-2-	305	14,913	4.0	596
Adrian Rinehart						
17	3	7-1	305	16,369	3.6	582
Robert R Stewart						
Jeri	3	7-9	305	21,323	3.2	692
Zell	3	3-11	305	17,525	4.2	741
Leroy Bupp						
Sandy	3	2-8	305	13,042	4.3	559
Dennis L McWilliams						
1	3	8-10	305	18,046	3.9	696
24	3	3-2	305	18,184	3.6	653
5	3	3-	270	11,603	4.7	547
76	3	2-8	305	18,385	3.3	615
72	3	5-	305	17,525	4.4	760
98	3	5-5	288	20,079	3.9	784
Palmer McWilliams Jr.						
49	3	6-6	305	17,750	3.7	664
Dennis J Myers						
Blackie	3	3-4	305	13,976	4.4	619
Chrissy	3	3-	305	16,173	4.0	651
Titus & Merle Walker						
6645	3	2-6	305	16,758	3.8	634
C Robert Kilgore						
7A	3	8-6	305	15,164	3.5	527
22A	3	5-6	287	15,861	4.3	681
Minnie	3	2-6	305	12,435	4.1	512
Phillip D Laughman						
Ruby	3	9-6	305	16,816	4.0	666
Avalong Farms Inc.						
Runt	3	7-11	285	17,708	3.5	628
Marge	3	7-9	305	22,318	3.4	769
Cindy	3	6-3	305	22,218	4.9	1098
Avalong Farms Inc						
Jewel	2	6-8	305	14,099	4.9	694
Jenifer	2	5-5	304	13,820	5.2	718
Ray	2	7-8	305	14,636	4.7	692
Linda	2	2-7	305	10,373	4.9	510

Paul R King						
Mitzi	3	5-1	305	20,133	4.2	838
Rocky	3	4-	295	14,068	4.7	657
Megan	3	1-11	305	14,194	4.2	590
Jet	3	1-11	250	12,127	4.3	522
Wayne B Mummert						
9	3	4-	294	21,481	3.1	663
5	3	3-6	305	16,751	4.5	748
Desota & Robt Burchett						
BW 27	3	6-7	296	14,313	4.4	625
W 86	3	5-7	305	10,973	4.8	525
W 94	3	4-10	297	12,315	4.5	553
RW 23	3	4-	305	14,493	3.9	568
100	3	4-	305	14,952	4.1	608
58	3	4-	305	14,466	4.1	586
D Fantom & E Gordon						
34	3	11-8	305	11,193	4.9	547
Star	3	5-9	305	14,567	4.2	612
Honey	3	5-8	305	13,322	4.1	551

(Continued on Page 105)

FISHER SPRAY PAINTERS

(Henry K. Fisher Inc.)

SANDBLASTING and SPRAY PAINTING

INTERIOR and EXTERIOR
Aerial Ladder Equipment

Office & Shop - 667 Hartman Station Rd.
Residence - 2322 Old Philadelphia Pike
Lancaster, Penna.

For FREE Estimates Call 717-393-6530

SAVE ENERGY! SAVE MONEY!

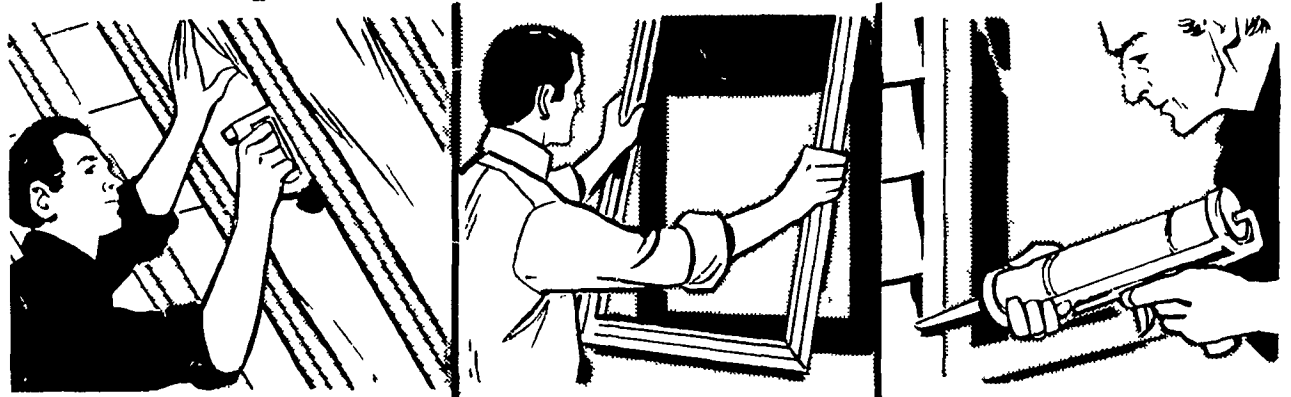

with an Energy Saver Loan
from the Friendly First—
NOW AT A SPECIAL
LOW RATE*

WINTERIZE NOW!

You can cut down on your energy bills while you help our nation save energy with an Energy Saver Loan. Come in to any of the Friendly First's five convenient offices and tell one of our loan officers about your home energy saver project — eligible borrowers can borrow \$1,000 to \$10,000 with up to 5 years to repay at a new special low annual percentage rate of only 8.95%. See typical payment schedule below.

LOANS AVAILABLE FOR 1 TO 5 YEARS

Here's a typical example of a 3-year-loan.

Amount Financed	36 Monthly Payments	Finance Charge	Total Payments	*
\$1000	\$ 31.78	\$ 144	\$1,144	ANNUAL PERCENTAGE RATE 8.95%
\$3000	\$ 95.34	\$ 432	\$3,432	
\$5000	\$158.89	\$ 720	\$5,720	

Life Insurance, Accident and Health Insurance not included above



The Friendly First

THE FIRST NATIONAL BANK OF STRASBURG

Millersville • Strasburg • Lancaster • Buck • Willow Street

Member F D I C

OFFER GOOD THROUGH OCT. 31, 1977



WISCONSIN

65.9 H.P. Model
V-465D

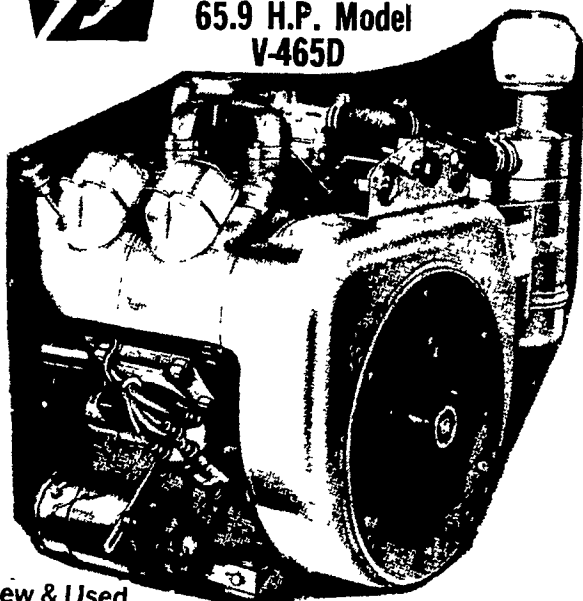

New & Used

Available in 3 Models:
with Clutch, with 4-1 Clutch Reduction and Standard

SPECIAL

\$2385.00

with clutch reduction

USED

SPECIAL

**FORD Industrial
172 Gas Power Unit
with Clutch Reduction**

\$1295

Authorized Service Center

FISHER ENGINE SERVICE

Amos L Fisher

3141 Old Phila. Pike
Bird-in-Hand, PA 17505