

built matory, automation has made it possible. Coping with the marketing developments and delicate financial balances are poultrymen such as Robah Buck in s, extreme right, who have hundreds of thousands of dollars invested in their n flocks producing facilities. One of the dangers of it all is the possibility of losing e ever since, but instead of the old coop, he has three long modern houses which measure 200, 300, and 500 feet in length. Hess got into a comparatively modern poultry barn in 1954 when he decided to have a long wooden structure built which turned out to be one of the first in the County equipped with a single row of cages. The layer house was built a section at a time, as it became affordable. Hess recalled how everyone was sure we were going to go broke by Summer," but it hasn't happened yet during 22 years. Today that same building stands abandoned and weather beaten. It once housed up to 5000 layers in a single row of cages designed to keep individual performance records. "That was the thing they pushed at that time," Hess recollected. Work is

electric power. If the fans aren't working to provide fresh air constantly, the tens of thousands of layers in any one building would die within 20 minutes. That's why Hess and other poultrymen have big powerplants of their own, such as the one Hess is testing, above.

underway to have the old structure replaced by a modern facility complete with decks of cages and automatic equipment. A member of state and local poultry associations, Hess has been an independent producer throughout his years in the egg business. "I prefer it that way," he stated simply, "I take the most risks that way, but I also gain the most when there's something to gain." It's a philosophy which fits neatly into Hess's belief of not giving up and proceeding with a schedule. He markets his eggs through the R.W. Sauder Company of Lititz. The experienced egg farmer has a price situation outlook which considers the prices of 1976 as having been "too high

for the good of the industry." He foretells a sharp drop in the market which will harm some producers. "Anybody who didn't make money with eggs last year should seriously consider doing something else," he suggested. One of the methods Hess uses to keep production fairly constant at his 70,000 hen operation, is to keep three different age groups of birds. He replaces just one house of birds at a time, instead of the entire flock. The production of 55,000 eggs per day requires a daily feed bill of approximately \$1000. The veteran poultryman has a few ideas which he hopes will someday be adopted by the entire industry. One idea is to have eggs marketed by the pound, rather than the dozen.

—ALSO
NU & **VEAL**
ERY **OG FINISHING**

E. M. Herr Equipment, Inc.

R.D. 1 Willow St., PA Lancaster Co. 717-464-3321

FARROWING MODELS

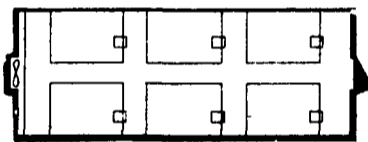

MODEL SC-1232-6
 A 23 x 32-ft farrowing building with 6 farrowing stalls. One 50,000 BTU furnace. Six 500-watt supplemental heaters for pigs. One modulator-operated constant running vent fan. Code No. 25-4050

MODEL SC-1240-8
 A 12 x 40-ft farrowing building with 8 farrowing stalls. Has two 50,000 BTU furnaces, plus eight 500-watt supplemental pig heaters. One modulator-operated constant running vent fan, plus one thermostat-controlled vent fan. Code No. 25-4046

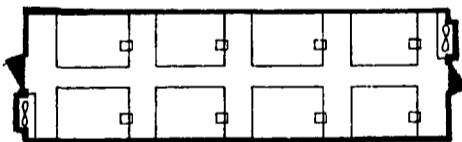

MODEL SC-1250-10
 A 12 x 50-ft farrowing building with 10 farrowing stalls. Two 50,000 BTU furnaces. Ten 500-watt supplemental heaters for pigs. One modulator-operated constant running vent fan, plus one thermostat-controlled vent fan in opposite end of building. Code No. 25-4047

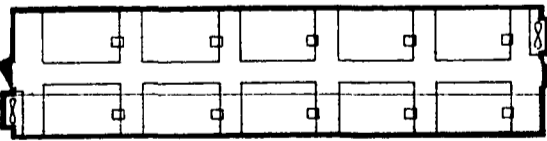

MODEL SC-2432-12
 A 24 x 32-ft farrowing building with 12 farrowing stalls. Two 50,000 BTU furnaces. Six 500-watt supplemental heaters for pigs. One modulator-operated constant running vent fan plus one thermostat-controlled vent fan. Code No. 25-4048

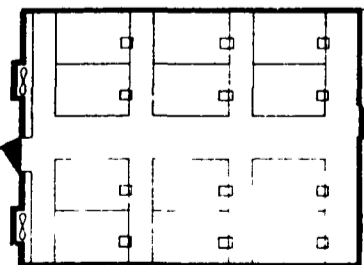

MODEL SC-2450-20
 A 24 x 50-ft farrowing building with 20 farrowing stalls. Two 50,000 BTU furnaces. Ten 500-watt supplemental heaters for pigs. One modulator-operated constant running vent fan plus two thermostat-controlled vent fans. Code No. 25-4049

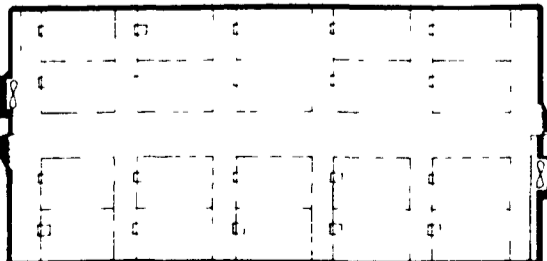

FARROWING/NURSERY MODELS

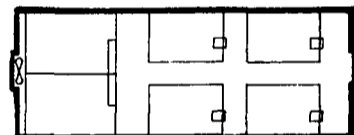

MODEL SCN-1232-4-2
 A 12 x 32-ft farrowing/nursery building with 4 farrowing stalls, plus 2 nursery pens for up to 75 pigs. The latter are about 6 x 8 ft each in size, have slotted floor, have one nipple waterer each, and are made of AGSTAR HOG-TITE® tube-type pen partitions. Building has one 50,000 BTU furnace, six 500-watt supplemental pig heaters. One modulator-operated constant running vent fan. Code No. 25-4055

MODEL SCN-1240-6-4
 A 12 x 40-ft farrowing/nursery building with 6 farrowing stalls, plus 4 nursery pens for up to about 75 pigs. The latter are about 5 x 5 ft each in size, have slotted floor, have nipple waterers, and are made of AGSTAR HOG-TITE® tube-type pen partitions. Building has two 50,000 BTU furnaces, plus eight 500-watt supplemental pig heaters. One modulator-operated constant running vent fan, plus one thermostat-controlled vent fan. Code No. 25-4058

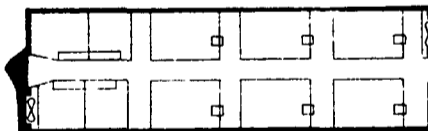

MODEL SCN-1250-8-4
 A 12 x 50-ft farrowing/nursery building with 8 farrowing stalls, plus 4 nursery pens for up to 75 pigs. The latter are about 5 x 5 ft each in size, have slotted floor, have one nipple waterer each, and are made of AGSTAR HOG-TITE® tube-type pen partitions. Building has two 50,000 BTU furnaces, ten 500-watt supplemental heaters for pigs. One modulator-operated constant running vent fan, plus one thermostat-controlled vent fan. Code No. 25-4054

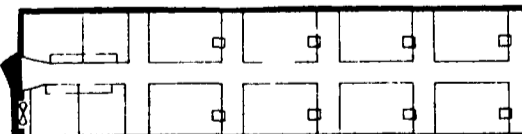

MODEL SCN-2450-16-8
 A 24 x 50-ft farrowing/nursery building with 16 farrowing stalls plus 8 nursery pens. The latter are about 5 x 5 ft each in size, have slotted floor, have one nipple waterer and are made of AGSTAR HOG-TITE® tube-type pen partitions. One all-welded nursery feeder serves two pens (5 feed openings each pen). Building has two 50,000 BTU furnaces, twelve 500-watt supplemental pig heaters. One modulator-operated constant running vent fan plus two thermostat-controlled vent fans. Code No. 25-4052

