

Visitor Participation Invited At New Farm, Crafts Fete

"Agricultural Americana," a five-day event at the Port Royal, Pa. Fairgrounds, will feature many of the old farm machines from the collection of Harold Sheaffer, a Juniata County school teacher-turned-collector. Sheaffer's collection is one of the largest private collections of antique farm equipment in the east.

The festival, which will become an annual event on a 190-acre farm Sheaffer has an option to buy, will be held at the fairground for the next few years as the farm is developed. In addition to the farm equipment, Sheaffer has also obtained old buildings to create a rural 19th century community.

The 33-year-old teacher's plans have stirred the interest and enthusiasm of Central Pennsylvania craftsmen and women. A wide variety of craft and trades people will join in Agricultural Americana's opening. More than 30 different exhibits will be set up for the festival.

"One retired farmer, who comes from a long line of blacksmiths, has opened the family's old shop and will participate with demonstrations," Sheaffer says. Also among the many exhibitors will be a silversmith, candlemaker, spinners, weavers, dyers and others whose crafts were popular in the early days of rural America.

"What we are going to do," says Sheaffer, "is create a rural village and have a

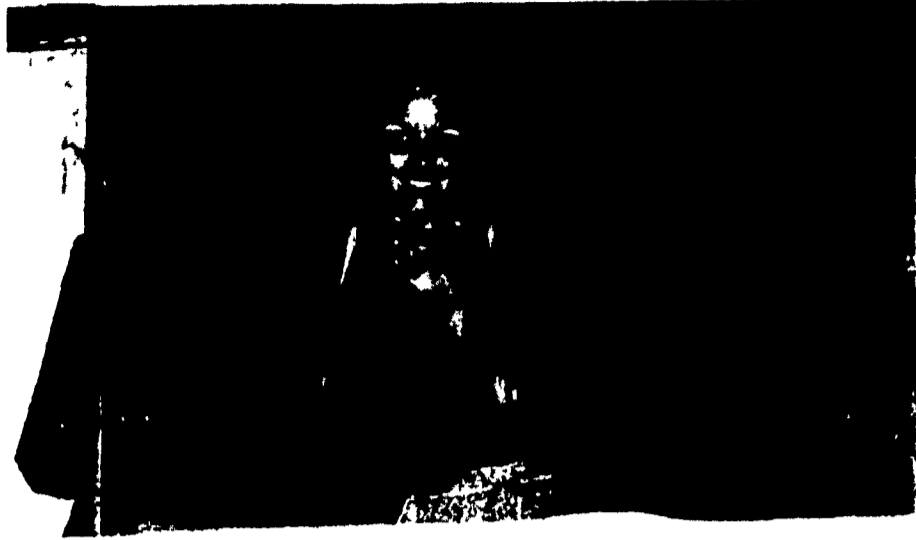

Churning butter with an old rocking churn is just one of the many exhibits and visitor participation events scheduled at Agricultural Americana at the Port Royal Fairgrounds August 14-18. More than

35 craftsmen and women and a huge selection of antique farm equipment will make up the opening event of what is to eventually be a permanent working farm museum.

working farm situation so the work that our forefathers put into building America. This is going to be a working farm museum. It's not going

to be a place where you can look but not touch."

The fairgrounds event, which runs from August 14-18, will provide many opportunities for visitors to try their hands at various farm activities. As an example, there will be six threshing machines from various periods in use during the event. Visitors will be able to pitch grain and help bag the various grains which are threshed.

Flintlock rifle experts will be on hand to load and check weapons from Sheaffer's collection. Visitors will have the opportunity to fire these weapons during a turkey shoot. Only rifles provided by Agricultural Americana will be used.

In various kitchen displays there will be butter churning, cider pressing and apple butter-making exhibits in which visitors can par-

ticipate. A dog treadmill hooked to a butter churn will show how dog power was often used by farmers.

The Port Royal Fairgrounds provide lots of room in 45 acres for exhibits, demonstrations of equipment and parking. Admission for adults will be two dollars, children one dollar. Senior citizens, 4-H and FFA members will be admitted for one dollar.

Food on the menu will include many old farm favorites such as ham and bean soup, chicken corn soup, fresh sauerkraut and sassafras tea. Area women will do much of the cooking from family recipes.

Port Royal is located on Route 322 between Harrisburg and State College. Sheaffer says there are several campsites at state parks in the area.

NEW WHEAT
IN THE MARKET DAILY

FOR TOP PRICES CALL
NELSON WEAVER & SON GRAIN
RD2 Lititz, Pa.
626-8538

IMMEDIATE PAYMENT!
PNEUMATIC TRUCK DUMP!
PRIVATE STORAGE!

We have a fleet of trucks available to pick-up your wheat on the farm or in the field

RIPCO

HAS ALL THE EQUIPMENT YOU NEED FOR FARM HAULING

Start with a Hart Universal Standard or Heavy Duty Platform.

8 STANDARD LENGTH MODELS

Overall Length 10 ft. x 4½ in. through 24 ft. x 4¼ in. x 95 in. wide

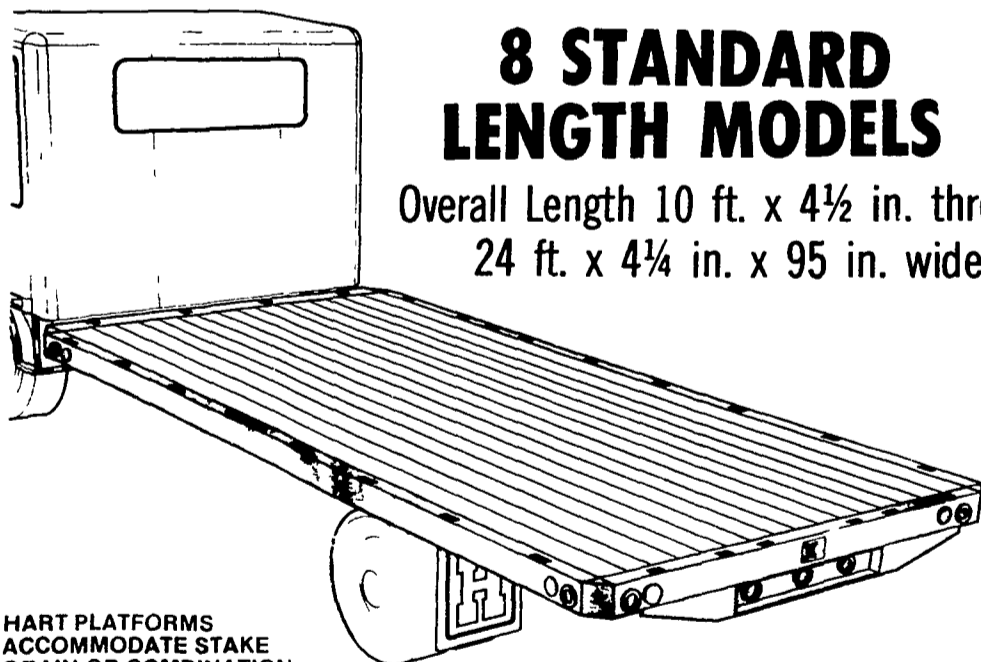

HART PLATFORMS ACCOMMODATE STAKE GRAIN OR COMBINATION PANEL ASSEMBLIES

RECTANGULAR TUBE LONG SILL

Add any of the following Racks and Bodies to Fit Your HAULING Loads.

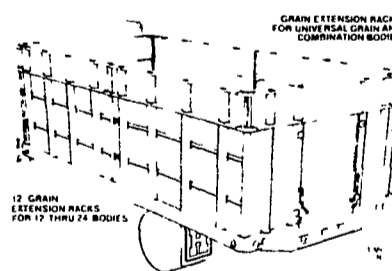

HART GRAIN EXTENSION RACKS
for Universal Grain and Combination Bodies

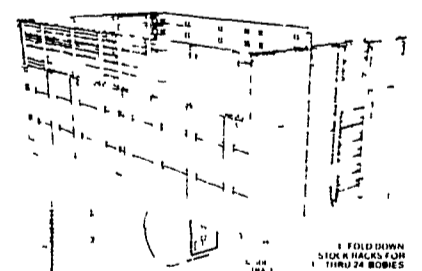

HART UNIVERSAL FOLD-DOWN STOCK RACKS
WITH LIVESTOCK DOOR

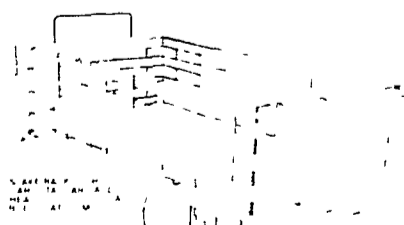

HART UNIVERSAL STAKE RACKS
Bolt on connections offer side rack arrangements

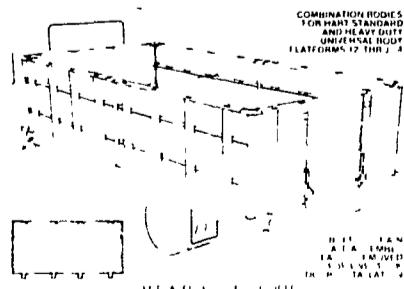

HART UNIVERSAL COMBINATION BODY
Bolt on Grain Gate assemblies easily Removable for livestock door in stallation

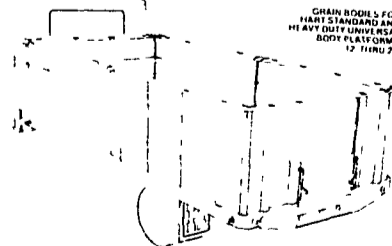

HART GRAIN BODY



COMPLETE SALES AND SERVICE CONTACT

RIPCO inc.
OXFORD PENNSYLVANIA
AIR-SYSTEMS

MAKE BULK HANDLING A BREEZE
(215) 932-9522 251 S. THIRD ST. OXFORD, PA. 19363