

# Farm Women Societies

## Society 4

Farm Women Society 4 recently entertained husbands and friends at a dinner meeting at the Harvest Drive Restaurant.

**GARBER OIL CO.**

**TEXACO**

**Fuel Chief HEATING OIL**

& OIL HEATING EQUIPMENT

**AIR CONDITIONING**

MOUNT JOY, PA.

Ph. 653-1821

Richard King of Mountville held devotions. E. Robert Nolt led the group singing.

Mrs. E. Robert Nolt, president, was presented with a bud vase and red rose in recognition of her birthday.

Entertainment was Gene Swords, Verna Lefever, Barbara Monyer and Dorothy Barsumian singing and playing seasonal numbers in operatic form.

The committee in charge of the affair was Mrs. Richard King, chairman, Mrs. Alvin Musser, Mrs. Robert Garber, Mrs. Charles Newcomer and Mrs. Mary Snyder.

## Society 11

Farm Women 11 held its

regular monthly meeting recently at Muddy Run Park. A covered dish picnic lunch was served.

The business meeting was called to order by Mrs. Ammon Huber, president. Devotions were conducted by Miss Mary Swarr.

General order of business was conducted by Mrs. Huber. Bills were ordered paid. Sunshine reports were given. Plans were made for the book committee to meet in the near future with Mrs. Andrew Burkins.

Mrs. Huber reported about the County Convention to be held at Lancaster School of the Bible the first Saturday in November. Members are requested to take or send articles for the bazaar table. Mrs. Mark Hatfield of Oregon will be the speaker in the afternoon.

The next meeting will be held October 25 at the home of Mrs. Mabel Kreider.

## Society 12

Farm Women Society 12 held a Harvest Sale during the September meeting, bringing in a total of \$26. At this meeting members also brought articles for Needlework Guild. The meeting was held at the home of Mrs. Willis Glick.

The October meeting will be a family night social at 6:30 p.m. October 20 at Shady Maple, the home of Mr. and Mrs. Chester Eshleman, Willow Street RD1. Each member is asked to bring a hot and cold dish. Punch and coffee will be provided. Families and their friends are all invited.

For directions to the Eshelman home, call Ethel Kendig, Millersville, 872-8139, or Mrs.

Willis Glick at 872-5114.

In November, a workshop will be held at Stauffer's of Kissel Hill. Anyone interested may call Mrs. LeMar Henry at 872-7513, Mrs. Glick, or Ethel Kendig. In order to have the workshop there must be 20 people. Any interested persons are welcome.

## Society 22

Farm Women Society 22 met Tuesday afternoon at the home of Mrs. Robert Houser. Mrs. Harold Ranck served as cohostess and led devotions.

After reminiscing about Halloween pranks of the past, slides were shown by Mrs. Willie Zedet. The slides were taken when she and her husband recently visited his homeland, Germany and Bavaria.

Several members are planning to make clothes which they will model when they compete in the fashion show sponsored by the County Convention of Farm Women November 3 at the Lancaster Bible College. The winner will compete with other county winners at the State Convention to be held in Harrisburg January 7 and 8, 1974.

The next meeting will be held at 1 p.m. November 13 at the Farm and Home Center. Mrs. Henry Hess and Mrs. William Weller will serve as hostesses. Mrs. John Hess will present a program on Christmas decorations.

## Society 27

Farm Women Society 27 met recently at the home of Mrs. Herbert Frey. Mrs. Lester Good served as cohostess. For devotions Mrs. Robert Kauffman read a passage from Romans 14.

Society 27 will help entertain guests at the Conestoga View Rest Home on October 18.

New officers elected at the meeting were: Mrs. Luke Brubaker, vice-president; Mrs. Harold Frey, corresponding secretary, and Mrs. Robert Fellenbaum, treasurer.

The activities for the evening

were the three different work projects. Following the Christmas theme, 48 decorated manilla envelopes and 40 decorated felt comb cases were completed for Appalachia. Fifty gaily decorated place mats were completed for a nursing home.

Roll call was answered by telling "A punishment I received in school". There were 27 members and one guest present.

The Society will take a bus trip to Peddler's Village on October 23.

## Needle Arts

By NANCY SEWELL

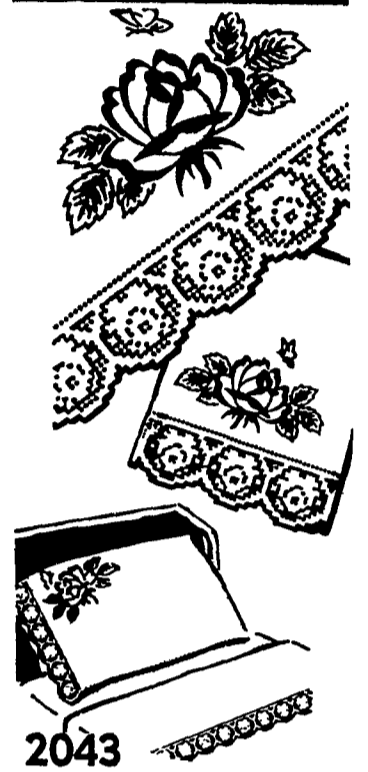

2043

### Lovely Linens

An exquisite filet border and elegant rose in embroidery make a lovely set of linens. Pattern No. 2043 has hot-iron transfer for 6 motifs; filet diagram and directions; color chart; full instructions.

TO ORDER, send 60 cents for each pattern with name, address with Zip code and pattern number to NEEDLE ARTS, P.O. Box 5251, Chicago, Ill. 60680.

## Andy's CATERING SERVICE

WE CATER ANYWHERE, INDOORS OR OUTDOORS  
2 LOCATIONS FOR BANQUETS



100 to 600 at the Farm & Home Center  
1388 Arcadia Rd., Lancaster  
Phone 392-4911

RECEPTIONS—BANQUETS  
ANNIVERSARY PARTIES  
PICNICS—BARBECUES—SALES MEETINGS

392-9319 IF NO ANSWER CALL 393 7641  
1106 MILLERSVILLE PK LANCASTER

## ATTENTION LOT OWNERS!

Join Paul's and Fight High Priced Housing

Paul's Can Deliver & Erect THIS  
Three Bedroom Home All For Only

**\$13,400**

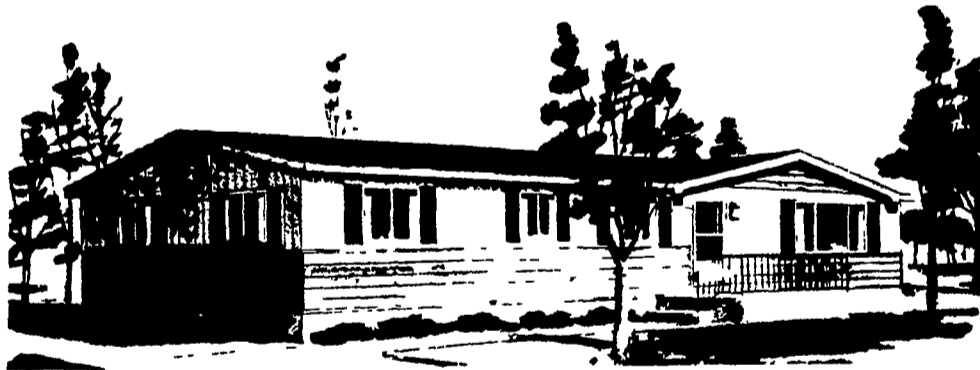

Gable optional at extra cost

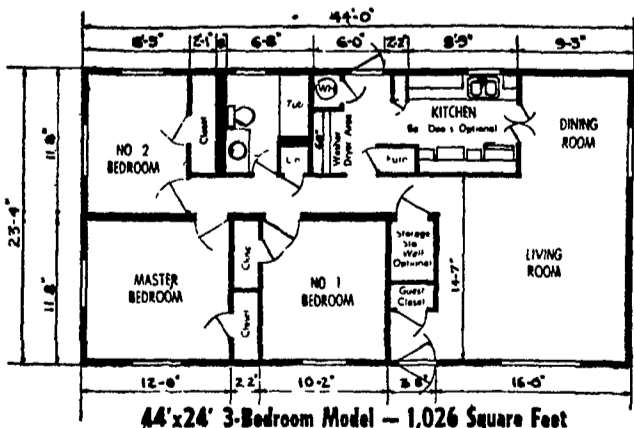

44' x 24' 3-Bedroom Model — 1,026 Square Feet

★ 1/4" Paneling through-out

★ Maintenance Free Exterior

**No down payment for qualified buyers**

Financing readily available for 15 years

**PAUL'S MOBILE HOMES, INC.**

W. Main St. (Rt. 230)

Mount Joy, Pa.

653-1476

## INSIST ON A POWERFUL EASY STARTING REMINGTON CHAIN SAW

MODEL  
**SL-4**  
AUTOMATIC  
OILER



Here's the one with more power and professional features than any other chain saw designed for non-professionals.

Big 17" cutting capacity lets you cut trees up to 34" in diameter

Powerful 59 cc engine capacity is ideal for cutting thick trees and hard wood

Fingertip starting — automatic rewind coil and pre-set trigger latch

Automatic oiling for added cutting efficiency

Quiet operation with new low-tone muffler

Precision balance, cushion grip handles

Exclusive 2-year warranty

Remington chain saw prices start at \$99.95

**GEHMAN BROS.**

1 Mile No. of Terre Hill on Rt. 897

East Earl RD1

Phone 215-445-6272