

Farm Women Societies

Society 29

Farm Women Society 29 met recently at the home of Mrs. Gerald Kreider, Quarryville RD1. Mrs. Kathryn Frey gave a demonstration on decoupage, demonstrating each step as she explained the technique. Following Mrs. Frey's talk, the hostess Mrs. Linda Kreider and cohostess Mrs. Sharon Heistand served refreshments. The business meeting followed.

The program committee was named for the coming year as follows: Mary Ellen Adamire, chairman; Sharon Heistand, Carolyn Newcomer, Janis Drager, Bonnie Becker and Shirley Garner.

Election of the offices of secretary and treasurer followed. New secretary is Lois Wells, and Mary Herr is treasurer.

The next meeting will be entertaining the Philhaven Hospital patients October 22. The Society

women are to meet at the Trust Company Bank in Elizabethtown at 6:15 p.m.

Society 30

Farm Women Society 30 elected Mrs. Reuben Leiset as president during a recent meeting. Serving with Mrs. Leiset will be Mrs. Dale Herr, vice-president; Mrs. Larry Weaver, secretary; Mrs. Duane Hostetter, treasurer, and Mrs. Wilmer Musser, song leader.

The next meeting of Society 30 will be held at 7:30 p.m. October 15 at the home of Mrs. James Byler, Gap RD2.

xxx

Boss: "Do you believe in life after death?"

Office boy: "Oh, yes sir."

Boss: Well, that's good, because after you took the day off to go to your uncle's funeral yesterday, he dropped in to see you."

MAKE MORE MONEY WITH

IM-PRUV-ALL

FERMENTABLE FEEDS

- | | |
|---------------------|----------------------------|
| No. 101 Corn Silage | No. G55 Hi-Moisture Grains |
| No. 202 Legumes | No. H 44 Haylage |
| No. 303 Grasses | No. LH77 Dry Hay |

You saw the proof at the Ag. Progress Show
For product or information call:

717-569-6042 717-733-4302
717-252-3114 215-932-3307

EASY TO HANDLE REMINGTON CHAIN SAW

MODEL
SL-9
AUTOMATIC
OILER



\$169⁹⁵

Here's a fully automatic Remington Chain Saw you can use to fell trees up to 30 inches in diameter. And it's ideal for trimming and pruning, cutting firewood, even building outdoor furniture.

Weights just 9* lbs. yet has powerful 46 cc displacement engine

Fingertip starting with automatic rewind starter and compression release

Low-tone muffler provides truly quiet operation

Automatic oiling delivers added cutting efficiency, long chain life.

Cushion grip handles provide extra cutting comfort

Exclusive 2-year warranty

\$179⁹⁵

with roller nose guide bar

*less bar and chain

Remington Chain Saw prices start at \$99.95

GEHMAN BROS.

SALES & SERVICE

1 Mi. North of Terre Hill on Rt. 897

East Earl R. D. 1

Phone 215-445-6272

Lebanon County New Cooperators

The Lebanon County Conservation District announces the following new cooperators:

Jeff Waltermeyer, Swatara Township, three acres; Alfred R. Brandt, N. Lebanon Township, 103 acres; J. Harold Heagy, S. Annville Township, 120 acres; H. Charles Whitworth, Heidelberg Township, 175 acres; Glen Trout, Bethel Township, 60 acres.

Dale E. Horst, Heidelberg Township, 51 acres; Robert E. Kreider, W. Cornwall Township, 130 acres; Larry J. Moyer, N. Annville Township, 99 acres; Mays Kurtz Jr, W. Cornwall Township, 86 acres; Mark Copenhaver, S. Annville Township, 124 acres.

Simon Gingrich, N. Cornwall Township, 120 acres; John Alger, S. Londonderry Township, 278 acres; Elvin L. Kreider, S. Londonderry Township, 128 acres; Clarence Forney Jr, N. Cornwall Township, 140 acres; Robert B. Weidler, S. Londonderry Township, 332 acres.

John Moyer, Millcreek Township, 88 acres; Mark H. Bomberger, S. Lebanon Township, 100 acres; Edward L. Shuey, Heidelberg Township, 12 acres; Harry C. Bomberger, N. Annville Township, 225 acres;

Allen Yeakel, Heidelberg Township, 15 acres; Simon D. Bucher, S. Annville and N. Londonderry Townships, 180 acres.

Harold Wampler, S. Annville Township, 93 acres; Ernest Wagner, S. Annville Township, 82 acres; Arthur Krall, S. Lebanon Township, 121 acres; Warren Hetrick, Jackson Township, 59 acres; Clyde E. Deck, Jackson Township, 126 acres; Landis E. Tice Jr, Heidelberg Township, 163 acres; Harold O. Gingrich, Bethel Township, 46 acres.

Try A Classified Ad!

Farm Women Calendar

Saturday, September 29

1:30 p.m. — Farm Women Society 5 meeting, St. Paul's United Church of Christ, Manheim.

2 p.m. — Farm Women Society 6 meeting, Green Tree Church.

Tuesday, October 2

Farm Women Society 23 meeting, Election of Officers; Berneda Greider, hostess.

Thursday, October 4

1:30 p.m. — Farm Women Society 17 meeting, Election of Officers.

1:30 p.m. — Farm Women Society 20 meeting.

Saturday, October 6

Farm Women Society 8 trip, Penn's Cave; leave from St. Mark's Church, Mount Joy, 7:30 a.m.

AVAILABLE NOW FOR FALL SEEDING

- CERT. ARTHUR WHEAT
- CERT. ARTHUR 71 WHEAT
- REDCOAT WHEAT
- CERT. BARSOY BARLEY
- BALBO RYE
- WINTER RYE (COVER CROP)
- TIMOTHY
- CERT. CLIMAX TIMOTHY
- REED'S CANARY GRASS
- HIGHLAND PASTURE MIXTURE
- TETRAPLOID PASTURE MIX FOR HORSES

P. L. ROHRER & BRO., INC.

SMOKETOWN, PA.

PH. 717-397-3539

ATTENTION LOT OWNERS!

Join Paul's and Fight High Priced Housing
Paul's Can Deliver & Erect THIS
Three Bedroom Home All For Only

\$13,400



Gable optional at extra cost

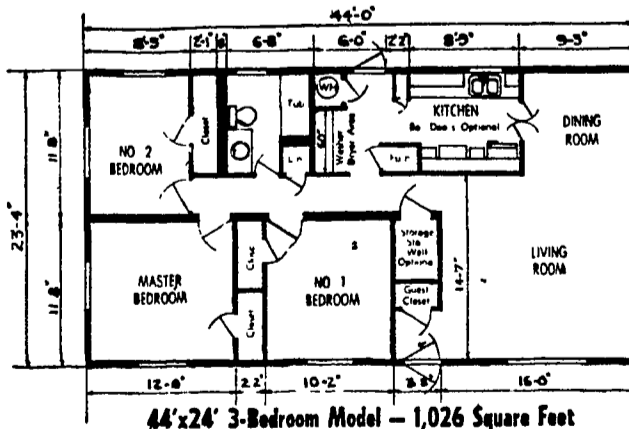

44'x24' 3-Bedroom Model — 1,026 Square Feet

★ 14 cu. ft. Refrigerator

★ 30" Gas Range

★ Curtains & Drapes

★ Storm Windows

★ Carpet in living room & dining room

★ 1/4" Paneling through-out

★ Maintenance Free Exterior

No down payment for qualified buyers

Financing readily available for 15 years

PAUL'S MOBILE HOMES, INC.

W. Main St. (Rt. 230)

Mount Joy, Pa.

653-1476