

# Lancaster Farming

## SECOND SECTION



THE 2-YEAR-OLD HOLSTEIN CLASS at the Farm Show this week in Harrisburg is headed by Robert

Kauffman's Penn Springs Bill Nancy. This was the only class headed by a Lancaster County Holstein Breeder. L. F. Photo

### SNOWMOBILES GALORE AT FARM SHOW

Harrisburg — This was the year of the snowmobile at the Pennsylvania Farm Show.

Take a gander in any direction at the 53rd Farm Show exhibit area where manufacturers and distributors display their products and you'll see the ubiquitous snowmobile.

It's an expensive "toy." Prices range from \$800 to \$2,000. Some come equipped with little trailers the family can ride in while Dad does the driving.

One distributor labeled the snowmobile the "farmer's toy" because the machine is used in winter when a farmer can enjoy it from afternoon milking until slumber time.

"The snowmobile doesn't interfere with plowing, planting, cultivating or harvesting," the distributor said.

Practical uses for the snowmobile, as far as farm life goes, include rounding up the cattle, inspecting fences and looking over acreage farmers seldom inspect during winter months.

Snowmobile fun isn't restricted to farmers. City folks can have a peck of fun by whooping it up on the machines at parks and golf courses.



HAULING AVAILABLE . . .  
 . . . ASK US

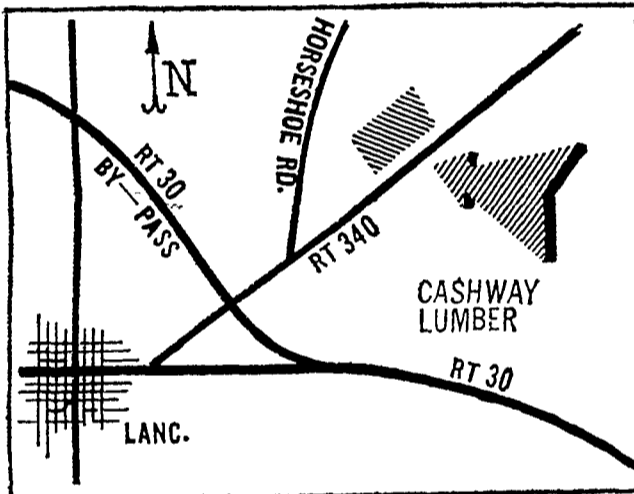

Amos H. Funk

### Funk Re-elected Conservation Dist. Chairman

Amos H. Funk, Millersville R1, was reelected recently to his 17th term as chairman of the Lancaster County Soil and Water Conservation District.

Also reelected were vice chairman Henry H. Hackman, Manheim R2 and secretary-treasurer Richard Hackenberger, Penn Manor Vo-Ag Teacher.

#### Protect Trees

If we get snow cover for any length of time this winter, I hope that owners of small fruit trees and ornamental shrubs will have the plants protected from rabbits and field mice; these rodents like to gnaw on the bark of the tree and can do considerable damage. There are several ways the trees can be protected against rodent injury. One way is to use aluminum foil or fine wire mesh and wrap around the trunk of the tree from the ground up at least 24 inches, also tree wrapping paper may be used to the same height. This distance is needed in case of deep snow for any length of time.

### WOOD 4x8 PANELING

	EACH
Hazelnut Lauan . . . . .	\$2.98
Tawney Okoume . . . . .	\$4.55
Highland Birch . . . . .	\$5.39
Classic Oak . . . . .	\$7.39
Rustic Walnut . . . . .	\$10.67
Rustic Cherry . . . . .	\$10.67
Rustic Elm . . . . .	\$7.49
Planked Okoume . . . . .	\$4.95
Champagne Okoume . . . . .	\$4.95
Natural Birch . . . . .	\$7.29
Spanish Oak . . . . .	\$5.89

### WHITE PINE MOULDINGS

Base 3" . . . . .	10 1/2c Lin. Ft.
Casing 2 1/4" . . . . .	8 1/2c Lin. Ft.
Stop 1 3/8" . . . . .	5c Lin. Ft.
Shoe 1/2x3/4" . . . . .	3 1/2c Lin. Ft.
Qtr. Round 1/2" . . . . .	3 1/2c Lin. Ft.
Qtr. Round 3/4" . . . . .	4c Lin. Ft.
Bed Moulding 1 3/4" . . . . .	7 1/2c Lin. Ft.
Shingle Moulding 1 5/8" . . . . .	7 1/2c Lin. Ft.
Brick Moulding 2" . . . . .	16c Lin. Ft.
Cove Moulding 3/4" . . . . .	4c Lin. Ft.
Outside Corner 1" . . . . .	9c Lin. Ft.

### RUBEROID ROOF SHINGLES

240 LB SELF SEALS . . . . .	\$7.40 sq
245 LB DOUBLE COVERAGE . . . . .	\$8.75 sq

### C.D. Ext. SHEATING Plywood

5/16 — 4x8 . . . . .	\$3.93 Ea.
3/8 — 4x8 . . . . .	\$4.25 Ea.
1/2 — 4x8 . . . . .	\$5.50 Ea.
5/8 — 4x8 . . . . .	\$6.84 Ea.
5/8 — 4x8 PT&S Underlay . . . . .	\$7.76 Ea.
3/4 — 4x8 . . . . .	\$7.80 Ea.

### ROLL ROOFING & FELT

50 LB. Smooth — 100' . . . . .	\$1.85
65 LB. Smooth — 100' . . . . .	\$2.20
90 LB. Mineralized — 100' . . . . .	\$2.95
15 LB. Felt — 432' Roll . . . . .	\$2.15

OPEN 7:30 to 5:30 MONDAY thru SATURDAY

PHONE 397-4829

Located 2 Miles East of Route 30 By-Pass on Route 340, Lancaster, Pa.