

**DID YOU KNOW** — On the average there are nearly one and one half acres of forest for every Pennsylvanian.

# PENAR®

Available at  
**ORGANIC PLANT  
FOOD CO.**

Groftown Rd.  
Next to Waterworks  
Ph. 392-4963 or 392-0374

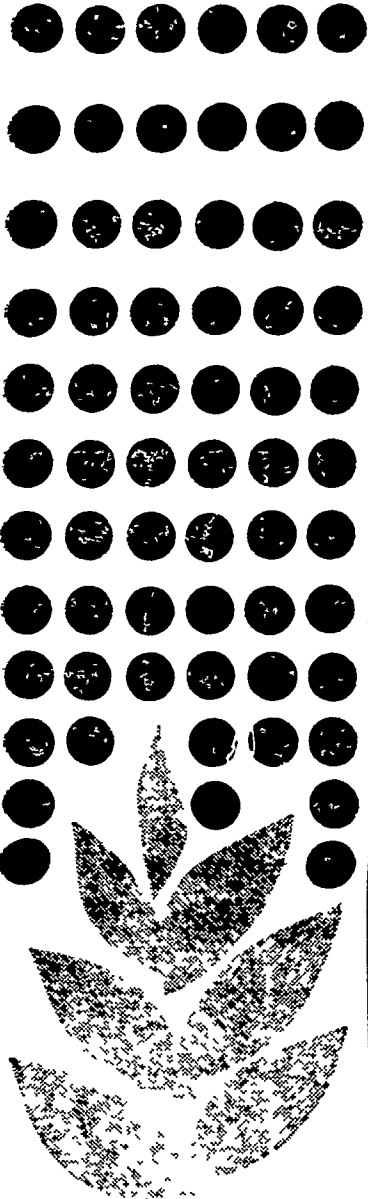

## PENAR controls tobacco suckers on contact within 45 minutes

1. Costs as little as \$5.00 per acre
2. Requires only one application, hand or mechanical
3. Produces more high value tobacco per acre
4. Doesn't affect leaf or plant growth

For a folder on details, write:



3 Penn Center, Phila., Pa. 19102  
309 Graham Bldg., Aurora, Ill. 60504

# PENAR

Available now at

**P. L. ROHRER & BRO.**  
SMOKETOWN, PA.  
Ph. 397-3539

## ● SWCD (Continued from Page 1)

Street". He offered a motion for increasing the prize money to \$35, \$25, and \$20 for the first three placings, respectively, and offering a premium of \$10 to all contestants which would partially cover their expenses. The board approved this move.

Another suggestion for improving interest in the contest was to work in closer cooperation with the nine vocational agriculture departments in the county, particularly to encourage young farmers to participate.

County agriculture teachers association president Lewis Ayers noted the teachers would cooperate in this effort next year. Ayers, chairman of this year's land judging contest — a new feature of the conservation field day — reported that he was a little disappointed that only 11 contestants had participated. The directors, however, noted this was a good turnout considering the event was a first effort.

### STATE PLOWING MEET

Directors voted to pay more liberal expenses for the coun-

ty plowing champion to compete in the upcoming state contest to be held in Somerset County. A mileage allowance of up to 25 cents, with actual expenses to be submitted by the contestant, was approved.

Representing the county this year will be Ivan Vost of Narvon R2, who won the championship by unseating last year's title holder Marvin Zimmerman of East Earl R1 in a close finish. In the 1966 state contest Zimmerman placed second. Third at the county level this year was Loren Zimmerman, also of East Earl R1.

### 4-H CONSERVATION CLUB SUPPORTS F&H CENTER

The Northern Lancaster County 4-H Conservation Club, led by SWCD director Aaron Z. Stauffer and associate director Leroy Pfautz, sold household products in an effort to collect money to support the current Farm & Home Foundation fund drive for its new Center.

Club vice president Dennis Martin, Stevens R1, presented the proceeds of the club's efforts — \$25 — to Amos Funk, SWCD chairman and a director in Farm & Home.

Although most of the two and a half hour session at the county court house was devoted

## NEPPCO Exhibit Space Sells Fast

Allied industry firms are showing keen interest in exhibiting at the 1967 NEPPCO Exposition, officials of the Northeastern Poultry Producers Council reported this week. "We've signed up nearly 85 percent of our normal space allotment already," Harry F. X. Stults, exposition manager said.

The big annual show moves into the Farm Show Building on October 10-11-12 with several acres of exhibits featuring the latest in poultry equipment, products and services, expert discussions of up-to-the-minute topics affecting the livelihood of egg and poultry producers, nationally-famous displays and a crowded schedule of activities.

"We've already leased 177

exhibit spaces totaling over 21,000 square feet, and between 10 and 15 percent of our exhibitors are brand-new to NEPPCO," Stults said. "They will be showing equipment and products never before displayed at the show, and many of the repeat exhibitors will have new items and displays as well."

Stults urged potential exhibitors to make their selections quickly from among the number of choice locations still available.

Among the educational displays will be an all-new Poultry and Egg Food Products exhibit on a wide range of processed and further-processed chicken, turkey, egg and game bird products. The nation's largest Market Egg Show, and a special fancy bird display, will also be featured.

The list of educational sessions this year includes expert talks on topics ranging from the handling of the pressing hazard of town zoning ordinances, the problem of who will be growing started pullets, a brand-new presentation on egg price-making factors in NEPCOland and an analysis of the industry's choice between the giant egg production complex and the owner-operated poultry farm.

ed to detailed planning and discussion in preparation for the annual state SWCD meeting to be hosted locally in November, directors also approved six new cooperator plans totaling 664 acres, plus plans involving Adamstown Borough and 10 acres of state forest lands.

## Use PENAR®

FOR TOBACCO SUCKER CONTROL

PENAR and other crop protection chemicals available thru your Armour dealers.

CALL 393-9949 or 872-5697 for Penar information.

**ARMOUR AGRICULTURAL  
CHEMICAL COMPANY**

P. O. Box 55, Millersville, Pa. 17551

### NEW DIMENSIONS IN DAIRYING

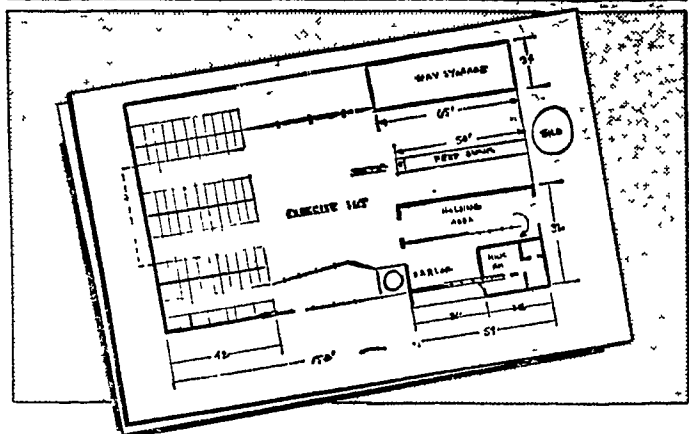

## DAIRY PLANNING



If you are planning to expand your dairy you'll be wise, smart and money ahead to call upon some expert help.

Babson Bros. Dairy Planning Service has available an experienced staff with factual data to help design, plan and build your new dairy whether it be for 50 or 5,000 cows.

Skilled draftsmen will create complete working drawings for any size dairy under any conditions. Take the drawings to your architect or, if you prefer, Babson Bros. Dairy Planning Service will work with your contractor to give you a turn-key installation.

NOW AVAILABLE THROUGH YOUR



DEALER

**B. Wilmer Martin**  
R. D. #1, Box 403A  
East Earl, Pa.  
Phone 215-445-5652

**Ralph B. Zeager**  
223 S. Church St.  
Quarryville, Pa.  
Phone 717-786-7225



## Cleans and Sanitizes Eggs in One Step!

New Wayne Breakthrough HD combines a heavy-duty cleaning detergent with a powerful disinfectant. Kills most bacteria, fungi, viruses and pleuropneumonia-like organisms on contact. Approved for washing and sanitizing shell eggs in plants supervised by U.S.D.A.

Also U.S.D.A. approved for dairy—bulk tanks, etc. Also fine for packing plants, livestock houses. No rinsing needed on most surfaces. Try this New working partner with Wayne Feeds.



Wayne Breakthrough HD



**MOUNTVILLE  
FEED SERVICE**  
R. D. 2, Columbia

**ROHRER'S MILL**  
R. D. 1, Ronks

**WHITE OAK MILL**  
R. D. 4, Manheim

**PARADISE SUPPLY**  
Paradise

**C. E. SAUDER & SONS**  
R. D. 1, East Earl

**HERSHEY BROS.**  
Reinholds

**POWL'S FEED SERVICE**  
R. D. 1, Quarryville  
R. D. 2, Peach Bottom

**GRUBB SUPPLY CO.**  
Elizabethtown

**HEISEY  
FARM SERVICE**  
Lawn and Bellaire

**MILLERSVILLE  
SUPPLY CO.**  
Millersville

**H. M. STAUFFER  
& SONS, INC.**  
Witmer

**DUTCHMAN FEED  
MILLS, INC.**  
R. D. 1, Stevens