

● **Rice With**
(From page 7)
eggs Makes 8 servings.

JET SALAD
1 cup cold cooked rice
1½ cups cottage cheese
(¾ pint)
3 green onions, chopped
1 teaspoon chopped parsley
1 cup French dressing
Lettuce
Paprika
Combine cooked rice, cottage cheese, green onions, & parsley. Mix with French dressing. Serve on lettuce leaf with a dash of paprika.

CRAB AND RICE SALAD
2 cups cooked rice
1 4-oz. can sliced mushrooms, drained
1 6½-oz. can crab meat, flaked (1½ cups)

2 tablespoons tarragon vinegar
½ teaspoon salt
1 teaspoon A-1 sauce
¼ teaspoon pepper
½ cup thinly sliced celery
¼ cup thinly sliced radishes
½ cup mayonnaise
Toss together rice, mushrooms, crab meat, vinegar, salt, A-1 sauce and pepper. Chill thoroughly. Add celery radishes, and mayonnaise; mix lightly with a fork.
Serve on crisp salad greens. If desired garnish with olive and cucumber slices. Makes 6 servings.

Mount Joy Co op Hears Reports

A total of 321 members and guests attended the annual banquet of the Mt. Joy Farmers Co-Operative Assoc., on Jan. 28 at Hostetter's Banquet Hall.

The meeting was in charge of Abner Risser, president. Richard Doremus entertained the group with music on the Hammond organ. Group

singing was led by John Henry Brubaker.

During the business meeting, Henry H. Hackman, R. D. 2, Manheim, and Amos Newcomer R. D. 1, Mt. Joy, were reelected directors, and J. Claytho Sangrey, R. D. 1, Lititz, was elected a new director for a term of three years.

S. A. Horton, manager, gave his report of the activities of the association during the past year. He stated that the co-operative had marketed 34,000,000 lbs. of milk during the past year, with the sales value of over \$2,000,000.

The Board of Directors met Feb 2nd, and elected the following officers for the ensuing year: Abner H. Risser, president; Henry H. Hackman, vice-president; Henry H. Eby, secretary-treasurer; Amos Newcomer, Asst. treasurer, and S. A. Horton, Manager and Asst. Secretary.

If you knew the number of girls, even grandmothers, who paddle around the house barefooted, you would be amused or shocked.

CHAIN SAW SERVICE CENTER
New & Used
Snavely's Farm Service
NEW HOLLAND EL 4-2214

MORE FOR YOUR MONEY!
with the **WAYNE** tail curler program

Provide proper nutrition at every stage of the life cycle—assure yourself of rapid, economical gains—get on the Wayne Way today!

We have the famous Wayne calf and pullet programs too!

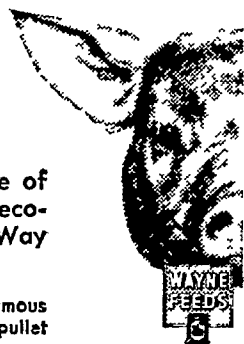

H. M. STAUFFER & SON'S, Inc.
Witmer - Ronks - Leola, Pa.

SUNSHINE FARM SUPPLY
Lititz, Pa.

LIME VALLEY MILLS
R.D. 1, Willow Street, Pa.

ROHRER'S MILL
R. D. 1, Ronks, Pa.

ROSS C. ULRICH, JR.
R.D. 2, Peach Bottom, Pa.

MILLERSVILLE SUPPLY CO.
Millersville, Pa.

ABERDEEN MILLS
R.D. 2, Elizabethtown, Pa.

70th Anniversary Bargains at Groff's—Feb. 11-12-13

GROFF'S HARDWARE
EXTENDS TO YOU A CORDIAL INVITATION TO PARTICIPATE IN THIS UNUSUAL EVENT
BPS COLOR SHOW
COLORCADE ON PARADE

Announcing
NEW AND IMPROVED



BPS LINGLO
DURABLE PROTECTIVE CLEAR COATING
DRIES IN 2 HOURS

A clear transparent coating for use on Woodwork • Cupboards • Table tops • Wood floors • Linoleum • Boats • Toys • Exterior doors • Lawn and porch furniture and many other interior and exterior surfaces. (RESISTANT TO ALCOHOL AND FRUIT JUICES)

SPECIAL OFFER
FOR A LIMITED TIME ONLY

PINT SIZE (REGULAR PRICE \$1.14) NOW \$0.97
QUART SIZE (REGULAR PRICE \$2.13) NOW \$1.79
GALLON SIZE (REGULAR PRICE \$6.65) NOW \$5.59

BRING THIS INVITATION TO OUR STORE AND RECEIVE A **FREE** USEFUL ITEM FOR YOUR HOME (until supply is exhausted) No obligation—no purchase necessary.

NAME _____
ADDRESS _____
CITY _____ STATE _____

BPS OUTSIDE PAINT

Regular \$7.25 **Special \$5.98** ORDER BEFORE FEBRUARY 12

ICE SKATES CLEARANCE

1/4 OFF

Ladies' Fig. Skates		Men's Fig. Skates		Savogram Products
Regular	Now	Regular	Now	UGL Products
\$ 8.99	\$ 7.27	\$ 9.44	\$ 7.77	Paint brushes
11.88	7.77	13.88	10.37	Sleds - Dolls
14.95	11.57	14.95	11.57	Toys
19.95	14.77	12.88 hockey	9.37	Boonton Ware
		Skateguards	77c a pair	Revere Ware
				Candlewik

GROFF'S HARDWARE

NEW HOLLAND - Open Thursday & Friday evenings - Ph. EL 4-0851

New Holland Bargain Days!

★
Thurs. - Fri. - Sat.
FEBRUARY 11-12-13

By The
New Holland Business Men's Assoc.

STANDARD EQUIPMENT, Inc. Big Spring DISCOUNT SALE

18% OFF

MIGHTY MOVE BARN CLEANER
EASY ALL COMFORT STALL
Designed and Built by Dairymen for Dairymen
SALE CLOSSES FEBRUARY 29, 1960
Delivery Taken February, March, or April

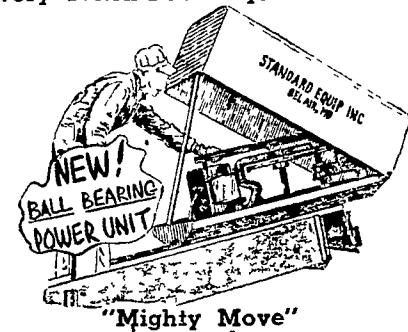

GLENN H. HERR

R. D. 1, MANHEIM Ph. Landisville TW 8-83

Attractive...

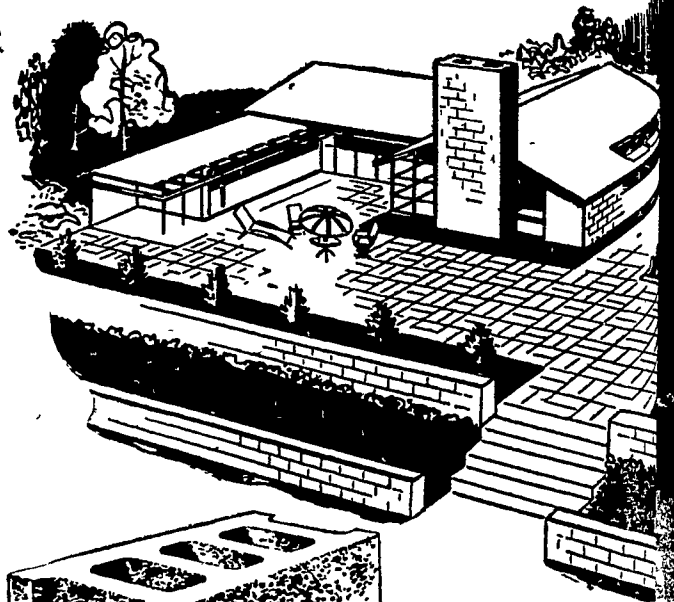

CONCRETE MASONRY

The modern building material for the modern home . . . concrete masonry gives you unlimited combinations of distinctive wall patterns that harmonize perfectly with contemporary and traditional home styles. A concrete masonry home reduces maintenance and upkeep . . . stays new looking longer, too. For quality block . . . precision masonry on Stearns equipment . . . see us today.

USE CONCRETE MASONRY FOR STRUCTURAL

nh NEW HOLLAND CONCRETE PRODUCTS
New Holland, Pa. EL gin 4-21