

CAMPAIGN FOR PENN STATE

Nine months ago the Campaign For Penn State Hazleton Campus began. The efforts of this campaign will go toward the funding of a new academic center. The new building will contain offices, classrooms, and an auditorium.

So far the campaign has raised \$575,000 in gifts and pledges. The final goal of \$1.5 million is proposed to be met in five years. This goal is only part of the

funding needed for the academic center to come to life. At least \$3.7 million will be required to construct this building. The campus is looking for funding to come from the university so that the requirements can be met.

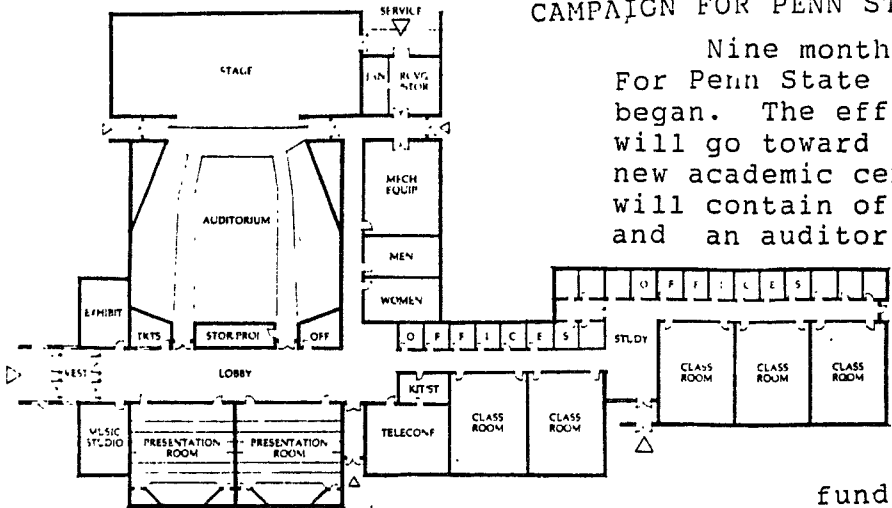

ROTC H-COMPANY GOES TO ABERDEEN
The following article outlines some of the highlights of the weekend.

by Arlene Austria

On the weekend of December 4, 5, and 6, the H-company of ROTC Hazleton went on an excursion to Aberdeen Proving grounds, Home of the Ordinance. Aberdeen is the center of developing, building, testing and repairing of most of all military weapons used by the Army.

Located in Aberdeen, MD, it is approximately a four hour drive from Hazleton. The company gathered at 17:00 hours on Friday night. The company was made up of 34 cadets, of which eight were women. Under the supervision of Captain Arthur and Sergeant Ramirez, H-Company was able to experience first-hand the life of a military person.

Cadet Commander Mike Close, 1st Sergeant Hare Date and 2nd Lieutenant Gina Orrico were the leaders of this excursion and under their leadership the company was able to learn in an organized fashion.

With increasing enrollment, there is a great need for more classroom space. There has also been an increase in faculty and the programs provided by the campus. With the construction of this new building, the needs of the campus will be met to enhance the university as a whole.

The trip began when we arrived at the base around 21:30 hours or 9:30 p.m. After we arrived, barrack assignments were made and lights out was at 12:00 a.m. The wake up call was at 5:30 a.m. Saturday morning and PT was at 6:00 a.m. followed by a 20 minute run.

At 7:00 a.m. breakfast was served and was followed by a tour of the base. The tour informed us of the many different types of arsenal weapons the army has in use and action. The soldiers stationed at Aberdeen learn about these weapons, how they work, and they must be able to repair these weapons as well as use them.

(continued on pg. 2)